

TCA SIDEWALK  
B11

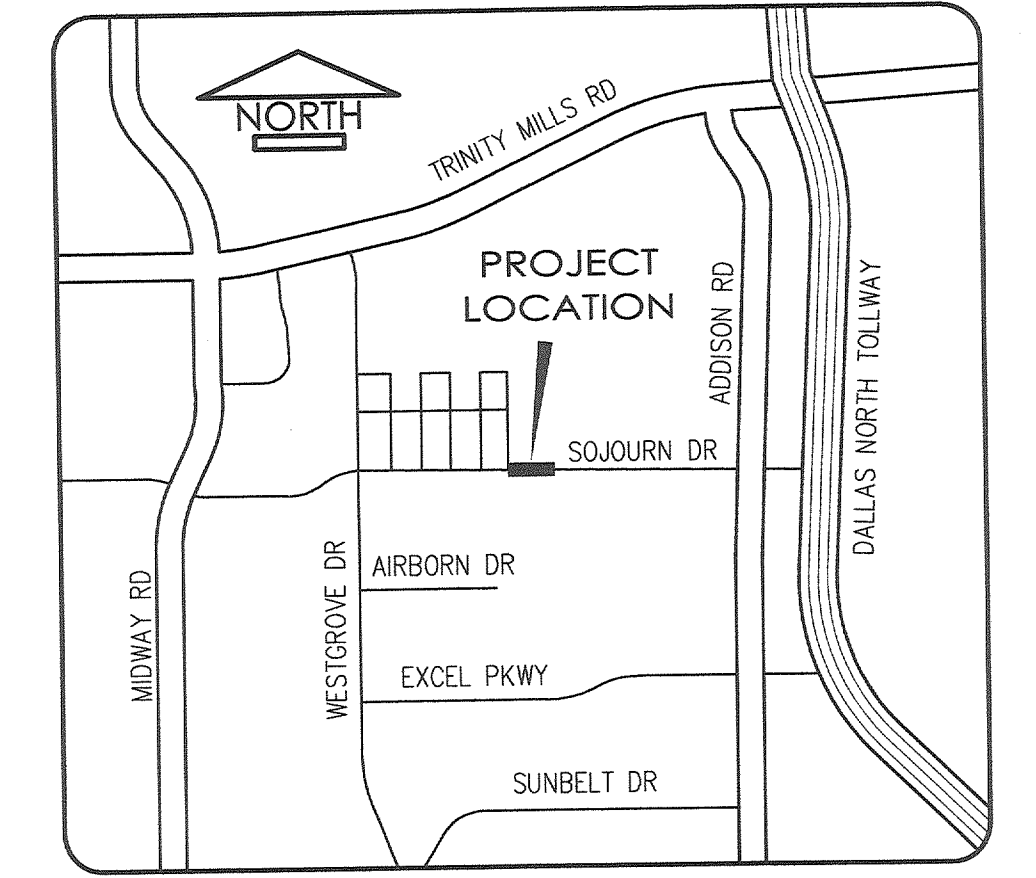
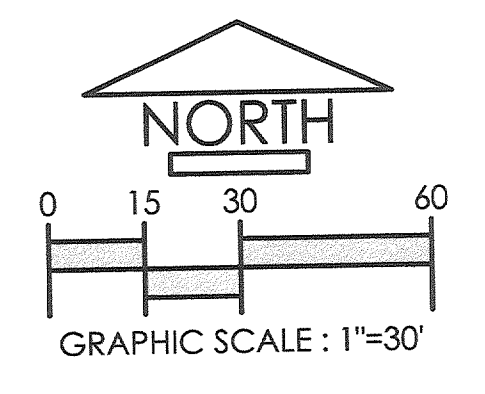
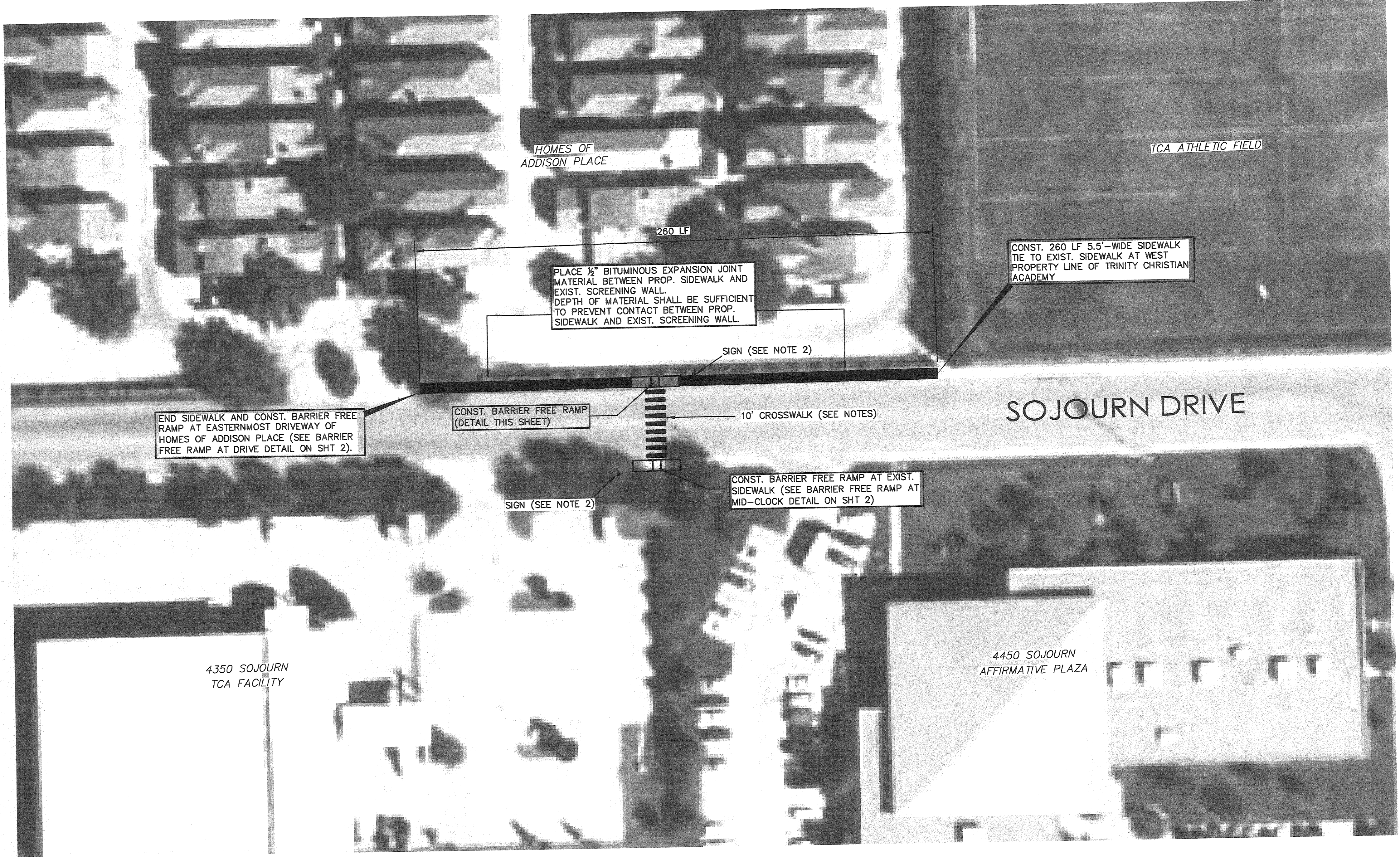

LOCATION MAP  
N.T.S.

END SIDEWALK AND CONST. BARRIER FREE RAMP AT EASTERNMOST DRIVEWAY OF HOMES OF ADDISON PLACE (SEE BARRIER FREE RAMP AT DRIVE DETAIL ON SHT 2).

CONST. BARRIER FREE RAMP (DETAIL THIS SHEET)

10' CROSSWALK (SEE NOTES)

CONST. BARRIER FREE RAMP AT EXIST. SIDEWALK (SEE BARRIER FREE RAMP AT MID-CLOCK DETAIL ON SHT 2)

4350 SOJOURN  
TCA FACILITY

4450 SOJOURN  
AFFIRMATIVE PLAZA



S1-1

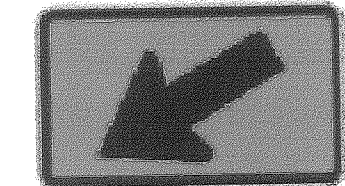

W16-7pR

APPROVED FOR CONSTRUCTION  
Town of Addison  
Public Works Department  
APPROVED BY: *CLAY BARRETT*  
DATE: *10-27-07*

All responsibility for the adequacy of these plans remains with the Engineer who prepared them. In approving these plans, the Town of Addison makes no representation of adequacy of the work of the Design Engineer.

GENERAL NOTES

1. A 10-FOOT WIDE CROSSWALK, MARKED WITH HIGH CONSPICUITY REFLECTIVE THERMOPLASTIC MARKINGS IN A LADDER CONFIGURATION CONSISTING OF 24" SOLID STRIPE, 24" GAP, 24" SOLID STRIPE.
2. AN S1-1 CROSSWALK WARNING SIGN WITH A W16-7pR PLAQUE IS TO BE PLACED AT LEAST 2 FEET OFF THE CURB IMMEDIATELY ADJACENT TO THE CROSSWALK.
3. SEE SIDEWALK AND RAMP DETAILS ON SHEET 2.

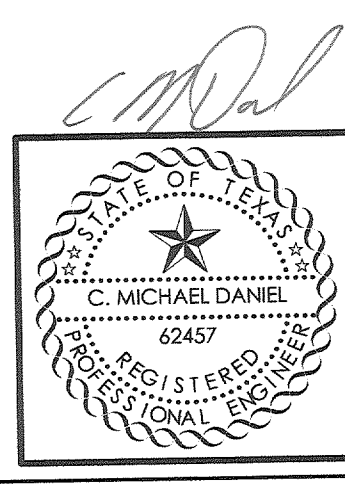

REVISIONS	DATE

**NDM**  
NATHAN D. MAIER  
CONSULTING ENGINEERS, INC.  
www.ndmce.com  
Two Northpark 8080 Park Lane Suite 600  
Dallas, Texas 75231 214.739.4741

**SIDEWALK CONSTRUCTION PLAN**  
TRINITY CHRISTIAN ACADEMY  
CITY OF ADDISON, DALLAS COUNTY, TEXAS

DESIGN	DRAWN	SCALE	DATE	NOTES
NDMCE	NDMCE	1" = 30'	SEP. 26, 2007	07076.A.PLD1

SHEET NO.	1
JOB NUMBER	07-08-076

9-27-07

TCA

B11



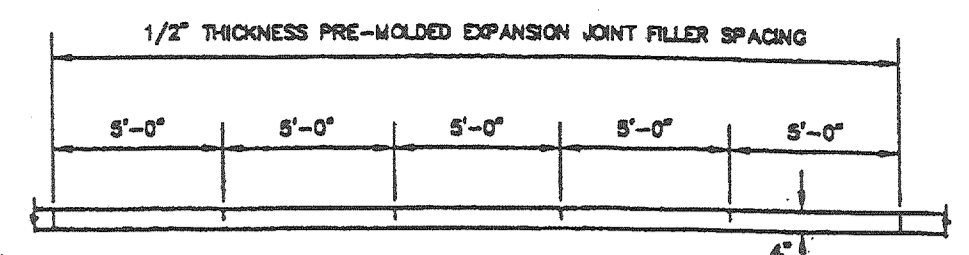

1/2" THICKNESS PRE-MOLDED EXPANSION JOINT FILLER SPACING  
5'-0" 5'-0" 5'-0" 5'-0" 5'-0"

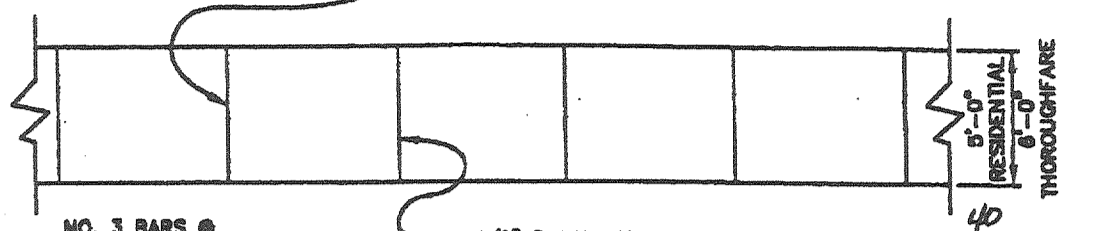

SIDEWALK MARKINGS SHALL BE GROOVED 3/8" DEEP ON 5' CENTERS  
NO. 3 BARS @ 18" C-C LONG 24" C-C TRANSVERSE  
1/2" EXPANSION JOINTS SHALL BE SPACED AT 24' INTERVALS OR AS OTHERWISE SPECIFIED AND JOINTS SHALL BE FILLED WITH PRE-MOLDED BITUMINOUS EXPANSION JOINT FILLER & WITH 5-3/8" DOWELS.

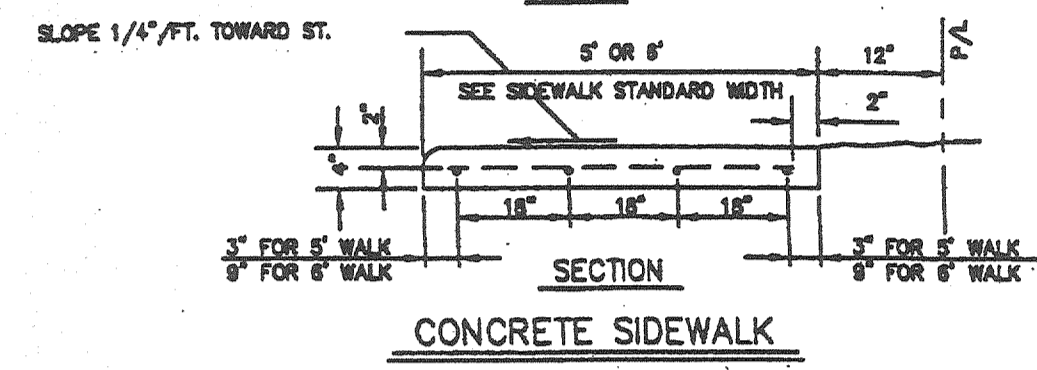

CONCRETE SIDEWALK

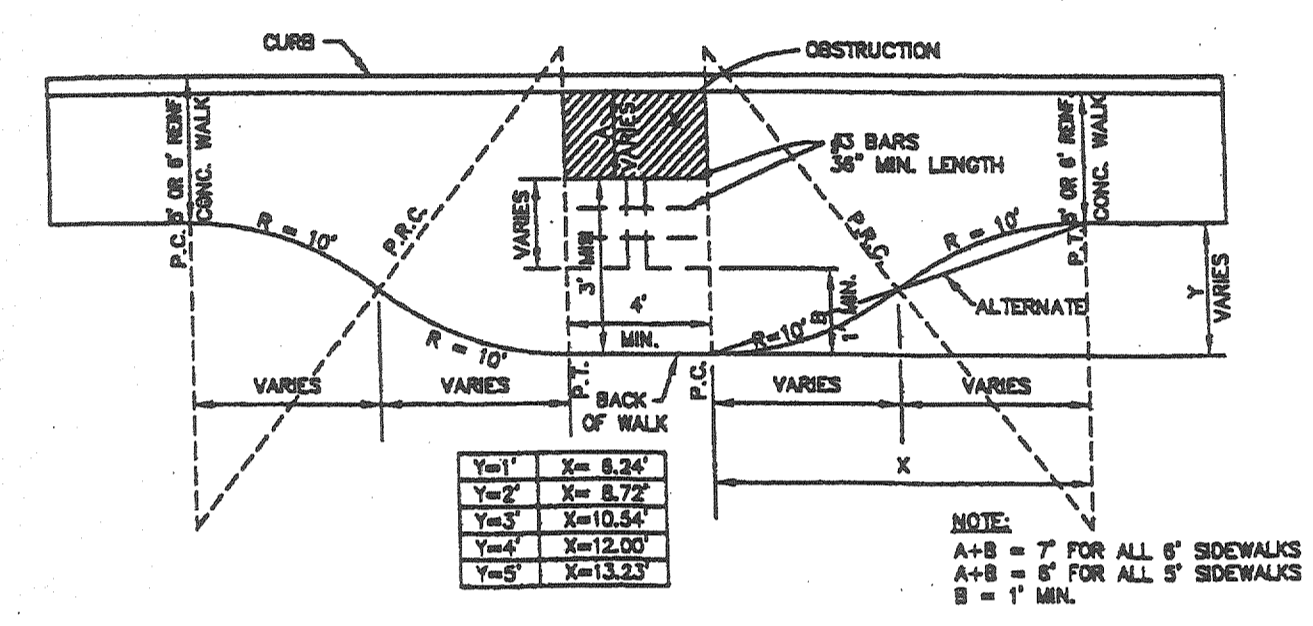

SIDEWALK WIDENING REQUIRED AROUND OBSTACLES IN SIDEWALK

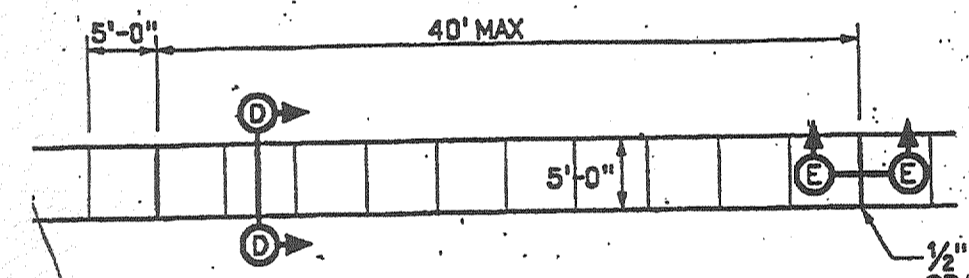

1/2" EXPANSION JOINTS SHALL BE SPACED AT MAX. 40' INTERVALS AND LINE UP WITH STREET EXPANSION JOINTS OR AS OTHERWISE SPECIFIED AND JOINTS SHALL BE FILLED WITH PRE-MOLDED BITUMINOUS EXPANSION JOINT FILLER.

NOTE: CONCRETE TO HAVE MINIMUM 4000 PSI COMPRESSIVE STRENGTH AT 28 DAYS AND MINIMUM CEMENT CONTENT OF 5 SACKS PER CUBIC YARD OF CONCRETE.

REINFORCED CONCRETE SIDEWALK - PLAN VIEW  
NOT TO SCALE

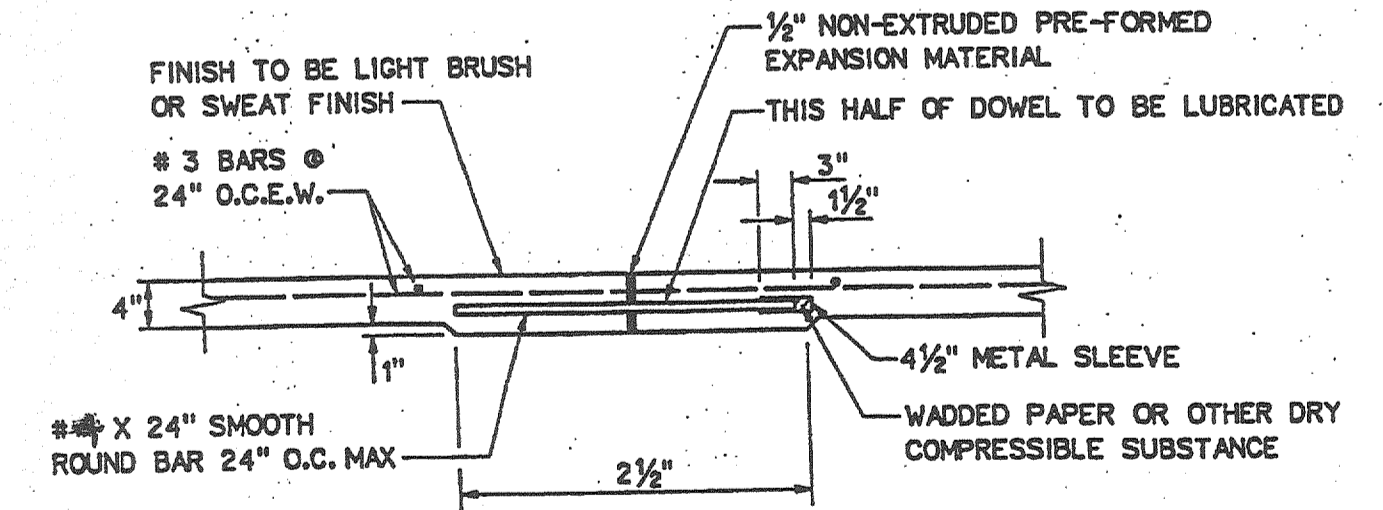

SECTION E-E EXPANSION JOINT DETAIL  
NOT TO SCALE

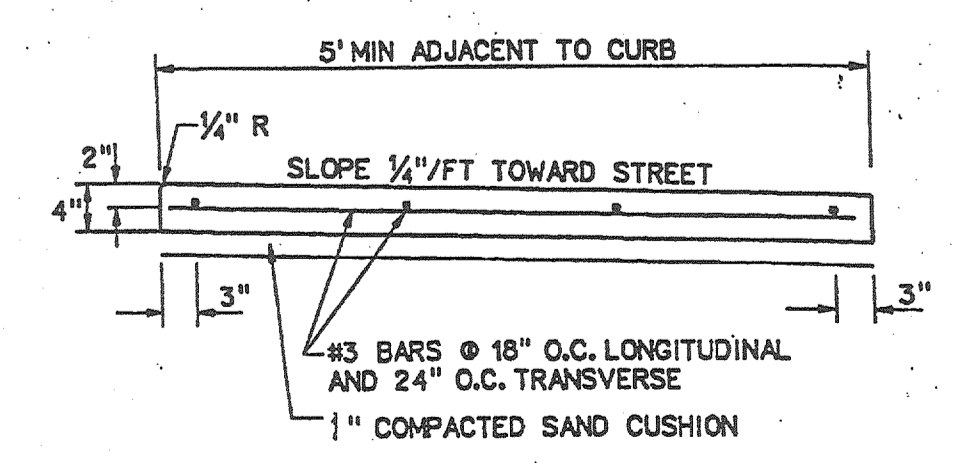

SECTION D-D

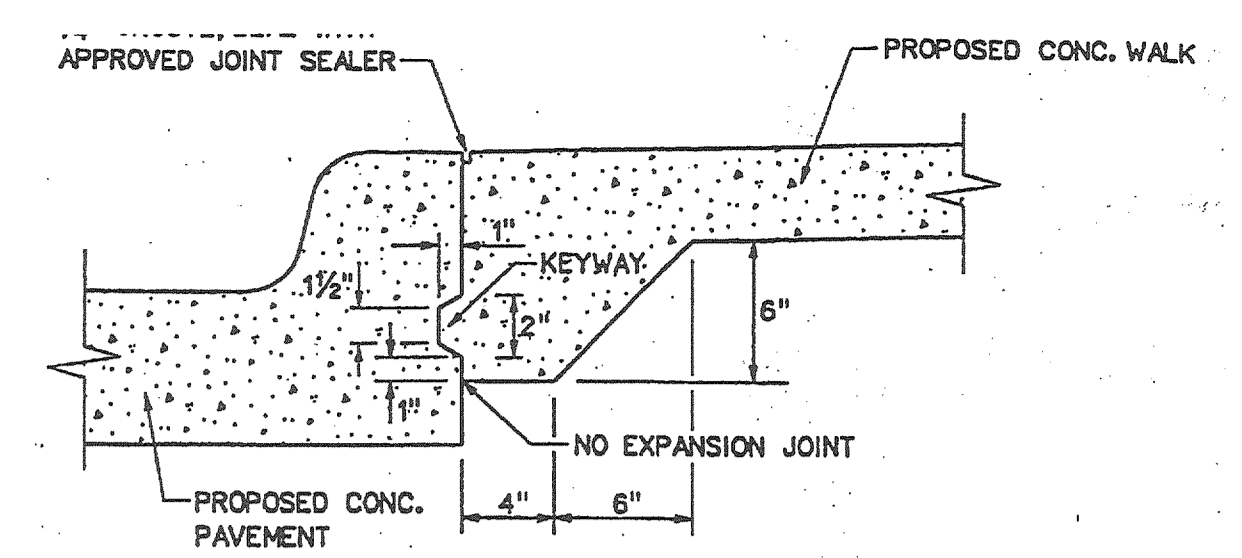

JOINT DETAIL FOR SIDEWALK ADJACENT TO PROPOSED PAVEMENT

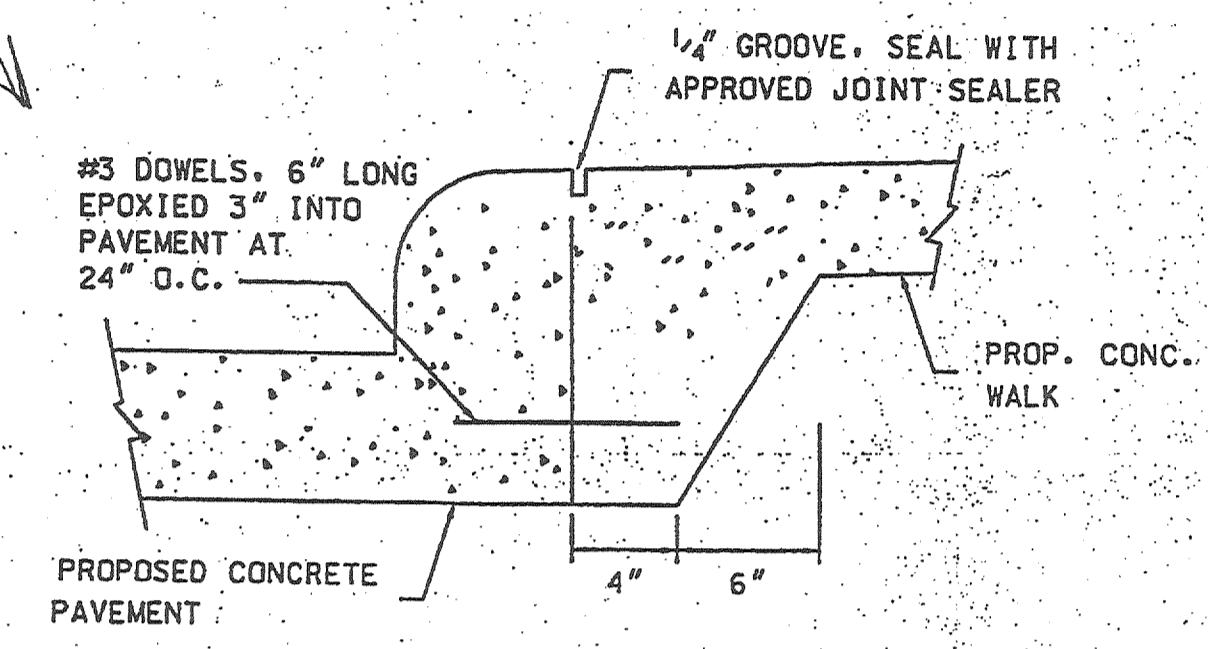

ALTERNATE JOINT DETAIL FOR SIDEWALK  
NOT TO SCALE

SIDEWALK NOTES:  
1. THE CONTRACTOR SHALL PROVIDE TOOLED JOINTS USING A JOINTING TOOL APPROVED BY THE ENGINEER.

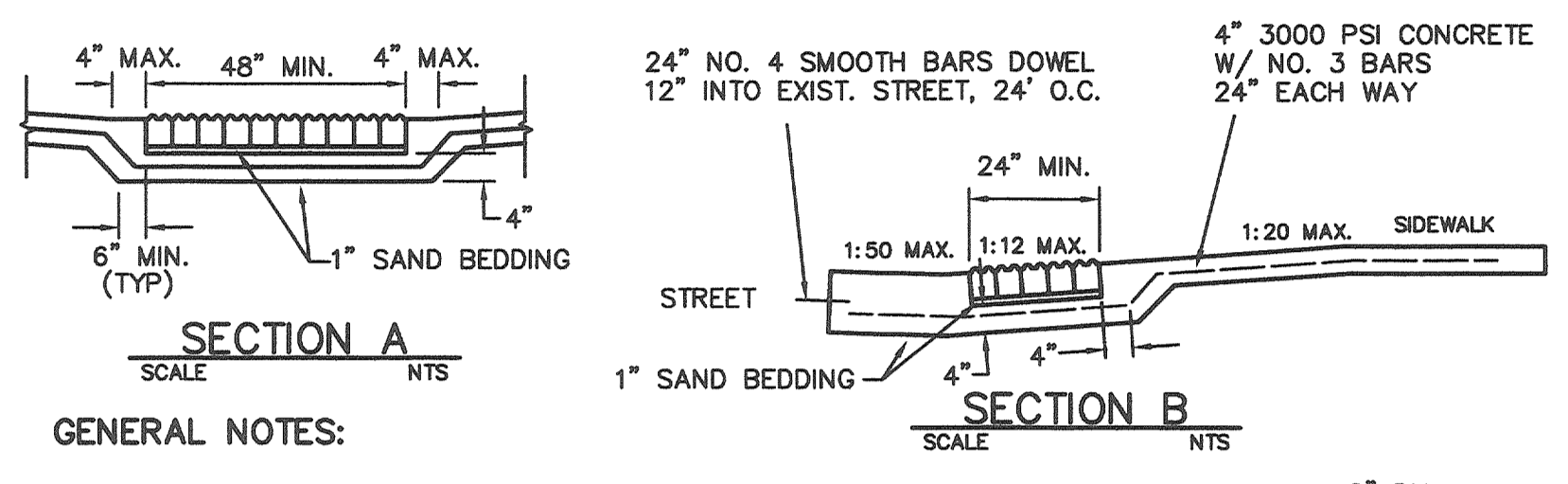
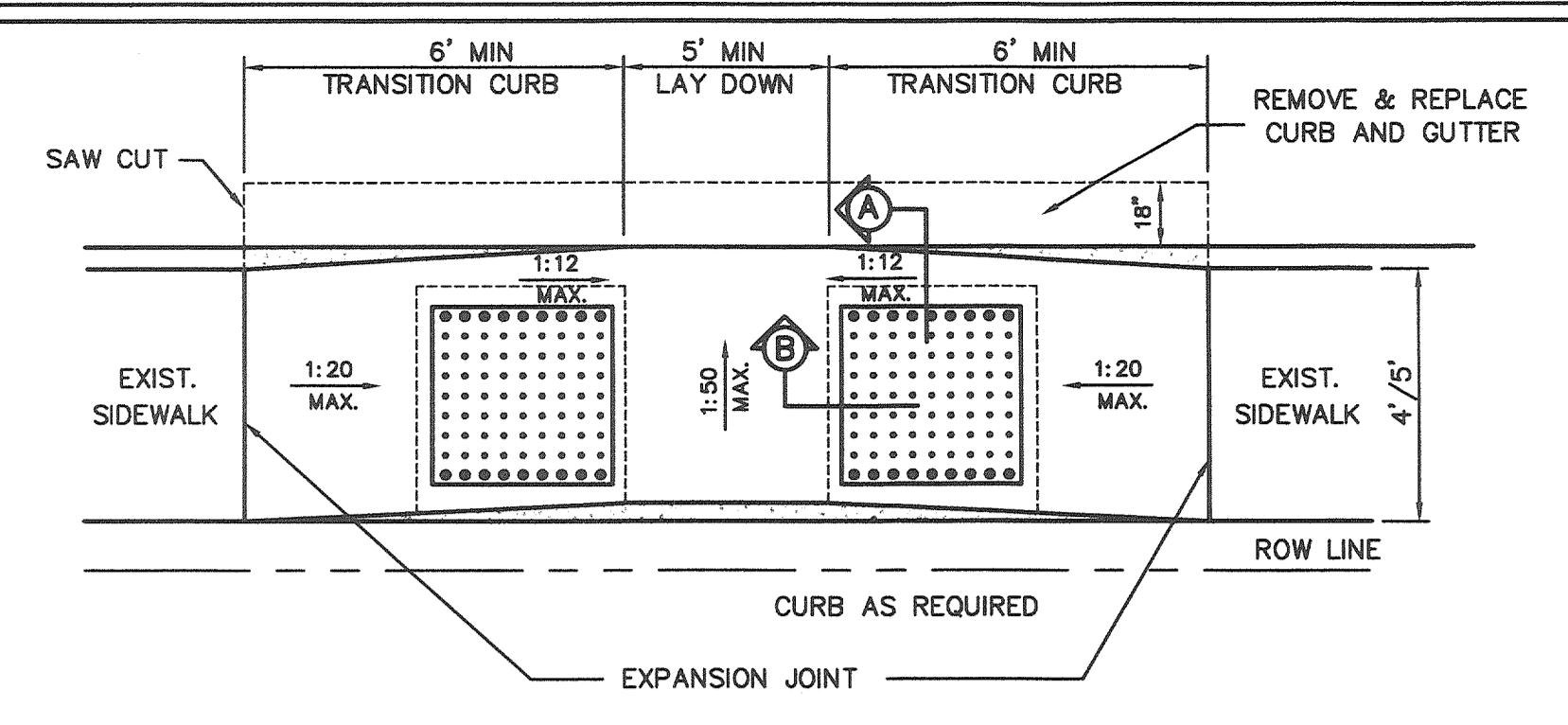

GENERAL NOTES:

1. THE TRUNCATED DOME PATTERN SHALL BE 24 INCHES IN DEPTH, EXTENDING THE FULL WIDTH OF THE RAMP.
2. THE TRUNCATED DOME PATTERN SHALL BEGIN 6 TO 8 INCHES BEHIND PROJECTED BACK-OF-CURB LINE AND SHALL BE AN INTEGRAL PART OF THE WALKING SURFACE.
3. DOMES SHALL BE ARRANGED ON A SQUARE GRID, ALIGNED PERPENDICULAR TO THE BACK-OF-CURB.
4. BARRIER FREE RAMPS SHALL BE CONSTRUCTED IN ACCORDANCE WITH ADA ACCESSIBILITY GUIDELINES.
5. THIS DETAIL TYPICAL FOR "RETROFITTED" RAMPS.
6. MINIMUM DIMENSIONS SHOWN FOR TRUNCATED PATTERN AREA SHALL BE CONSTRUCTED WITHOUT CUTTING ANY OF THE PATTERNED PAVERS. ACTUAL DIMENSIONS MAY BE LARGER THAN THOSE SHOWN.
7. DO NOT DOWEL INTO THE BACK OF CURBS.

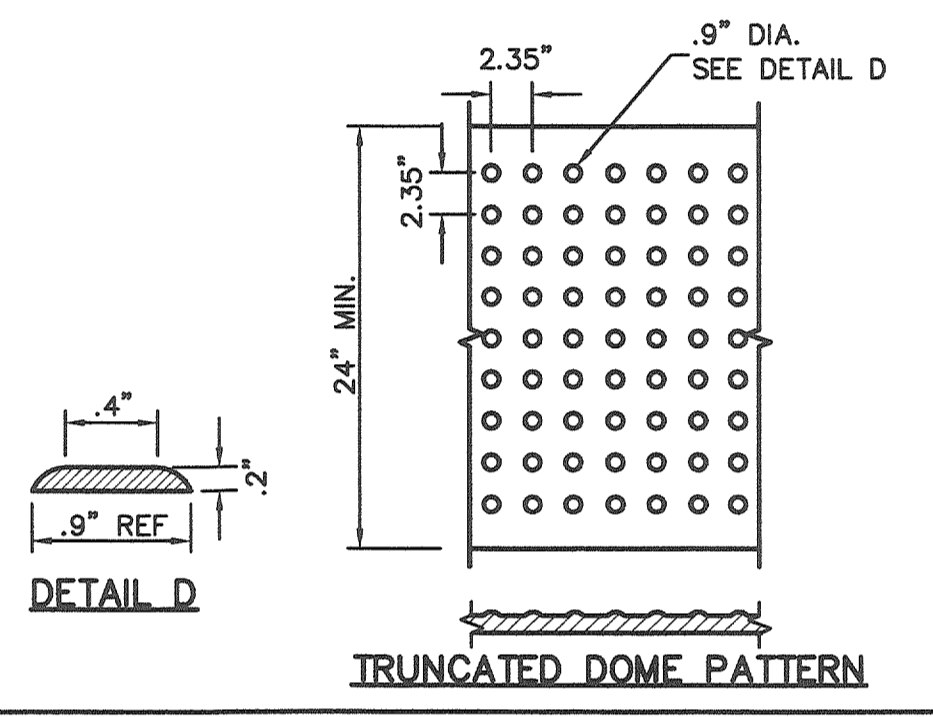

TRUNCATED DOME PATTERN

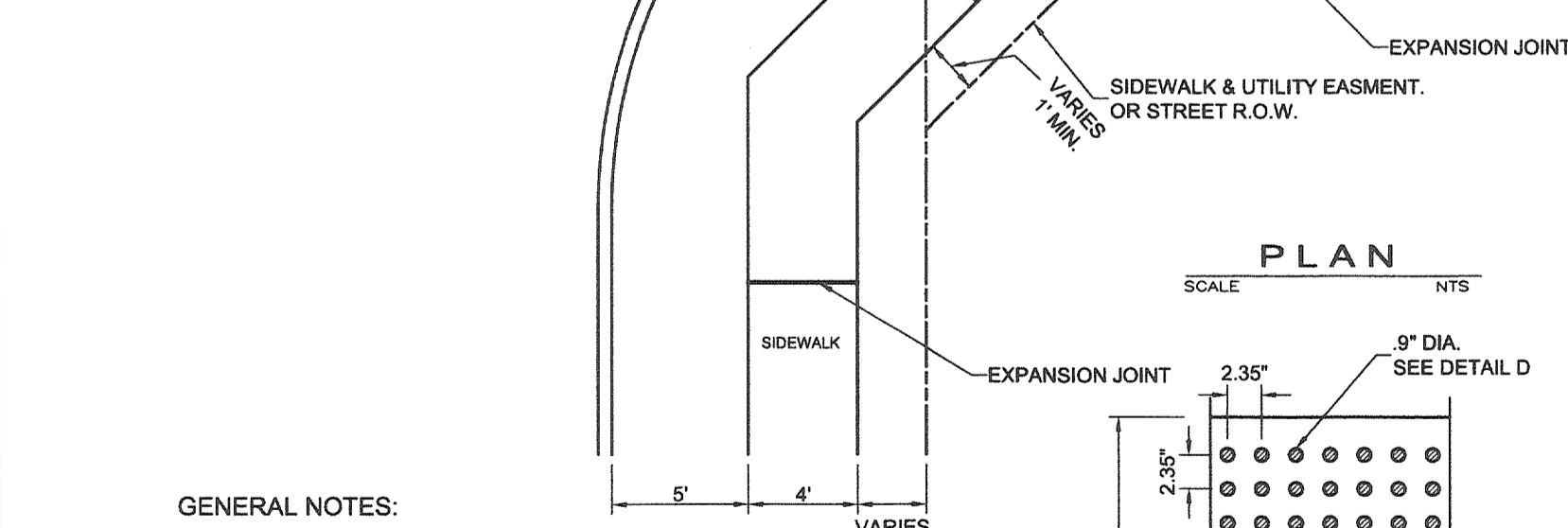
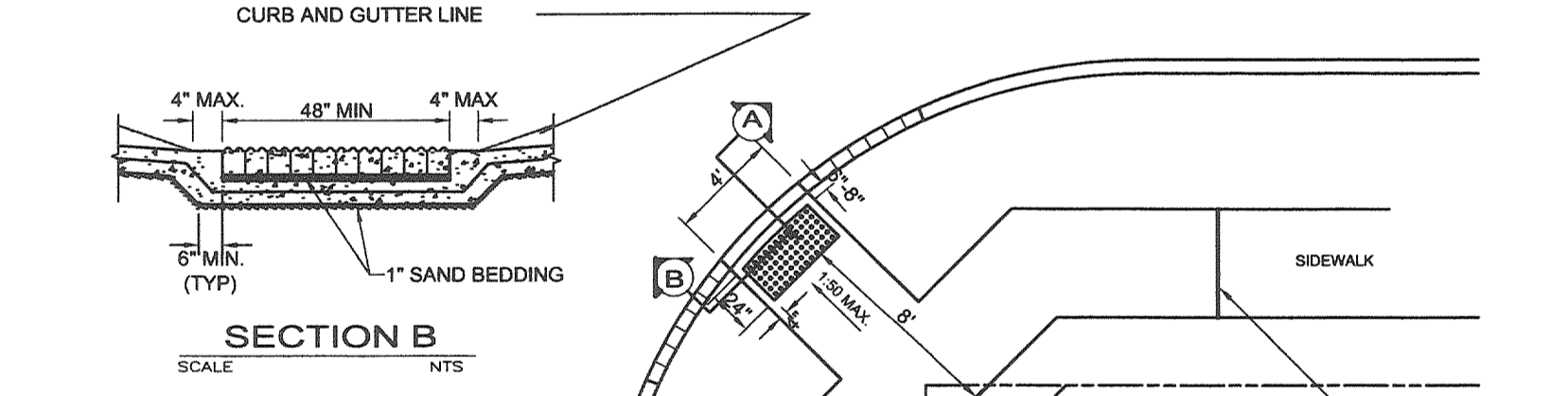
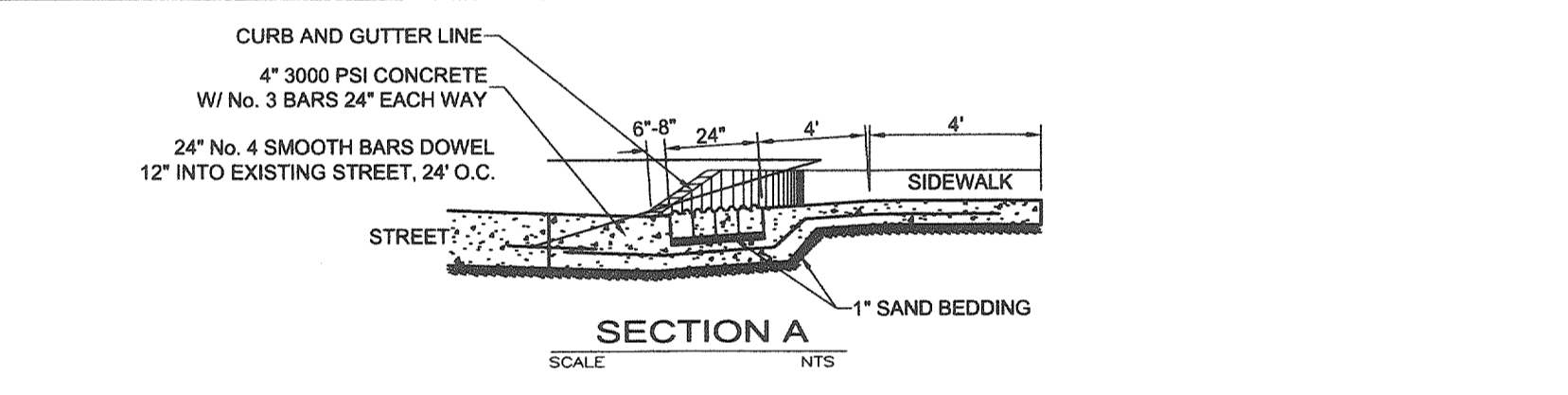

GENERAL NOTES:

1. THE TRUNCATED DOME PATTERN SHALL BE 24 INCHES IN DEPTH, EXTENDING THE FULL WIDTH OF THE RAMP.
2. THE TRUNCATED DOME PATTERN SHALL BEGIN 6 TO 8 INCHES BEHIND PROJECTED BACK-OF-CURB LINE AND SHALL BE AN INTEGRAL PART OF THE WALKING SURFACE.
3. DOMES SHALL BE ARRANGED ON A SQUARE GRID, ALIGNED PERPENDICULAR TO THE BACK-OF-CURB.
4. BARRIER FREE RAMPS SHALL BE CONSTRUCTED IN ACCORDANCE WITH ADA ACCESSIBILITY GUIDELINES.
5. THIS DETAIL TYPICAL FOR "RETROFITTED" RAMPS.
6. MINIMUM DIMENSIONS SHOWN FOR TRUNCATED PATTERN AREA SHALL BE CONSTRUCTED WITHOUT CUTTING ANY OF THE PATTERNED PAVERS. ACTUAL DIMENSIONS MAY BE LARGER THAN THOSE SHOWN.
7. DO NOT DOWEL INTO THE BACK OF CURBS.

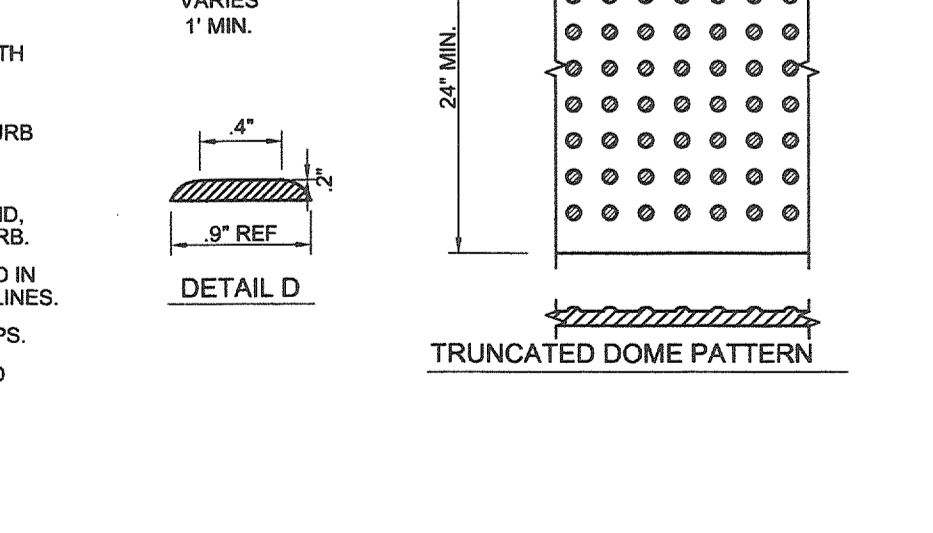

TRUNCATED DOME PATTERN

BARRIER FREE RAMP AT MID-BLOCK

BARRIER FREE RAMP AT DRIVE

APPROVED FOR CONSTRUCTION  
Town of Addison  
Public Works Department  
APPROVED BY: CLAY BARRETT  
DATE: 10-12-07

All responsibility for the adequacy of these plans remains with the Engineer who prepared them. In approving these plans, the Town of Addison makes no representation of adequacy of the work of the Design Engineer.

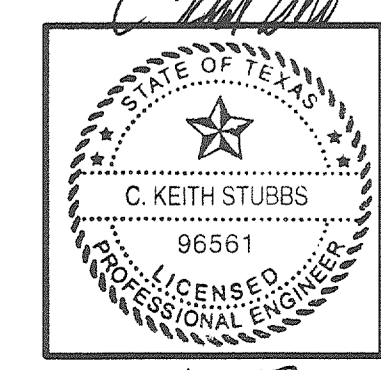

REVISIONS	DATE
CHANGED BARRIER FREE RAMP DETAIL AT ENTRY DRIVE	2007-10-11

**NDM**  
NATHAN D. MAIER  
CONSULTING ENGINEERS, INC.  
Two Northpark 8080 Park Lane Suite 600  
Dallas, Texas 75231 214.739.4741

DESIGN	DRAWN	SCALE	DATE	NOTES
NDMCE	NDMCE	1" = 30'	SEP. 26, 2007	07076.A.P101

SHEET NO.	JOB NUMBER
2	07-08-076

10-12-07