

TYPICAL HANGING SIGNAL INSTALLATIONS

Advance warning channelling devices are optional.

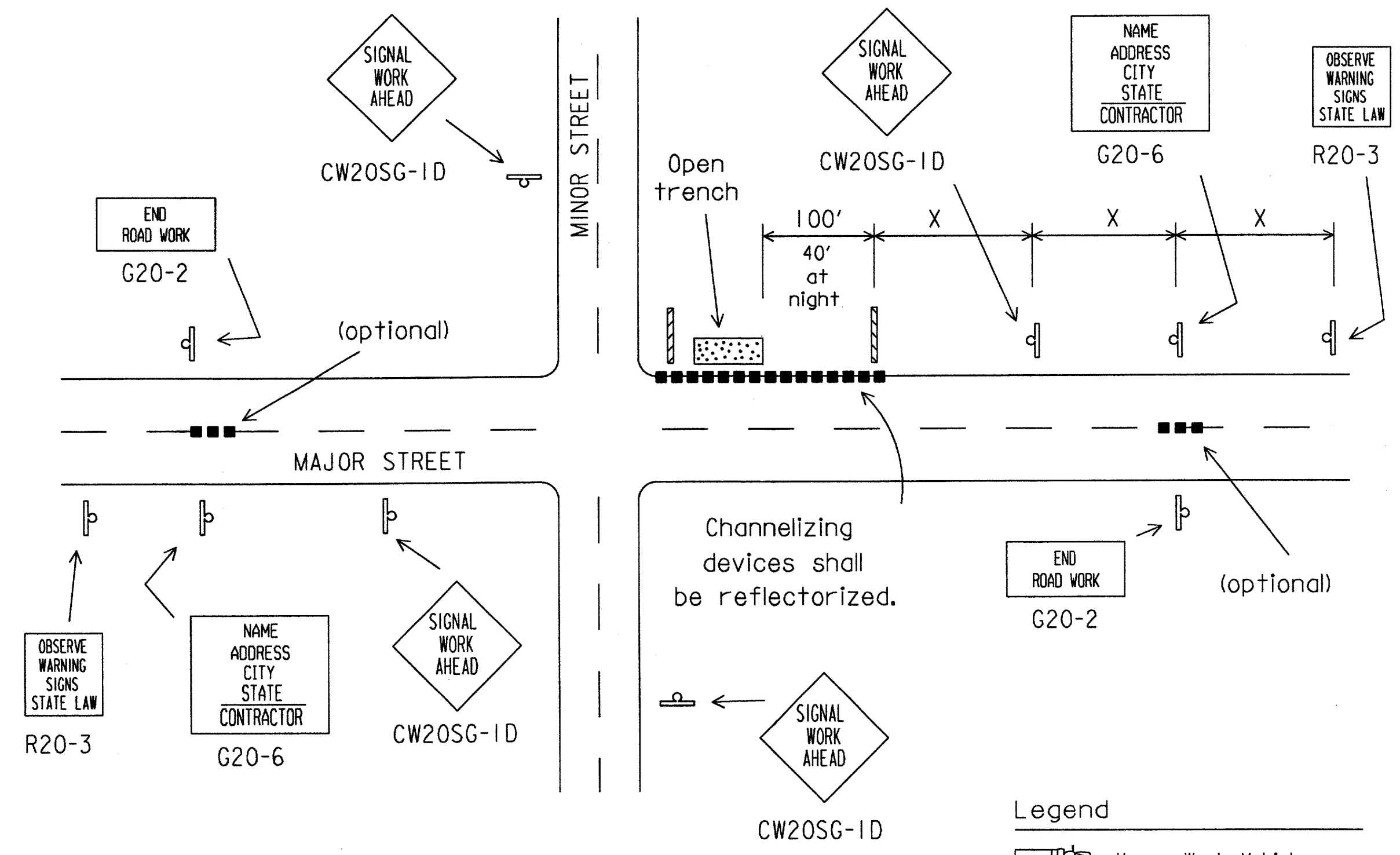

TYPICAL ADVANCE SIGNING

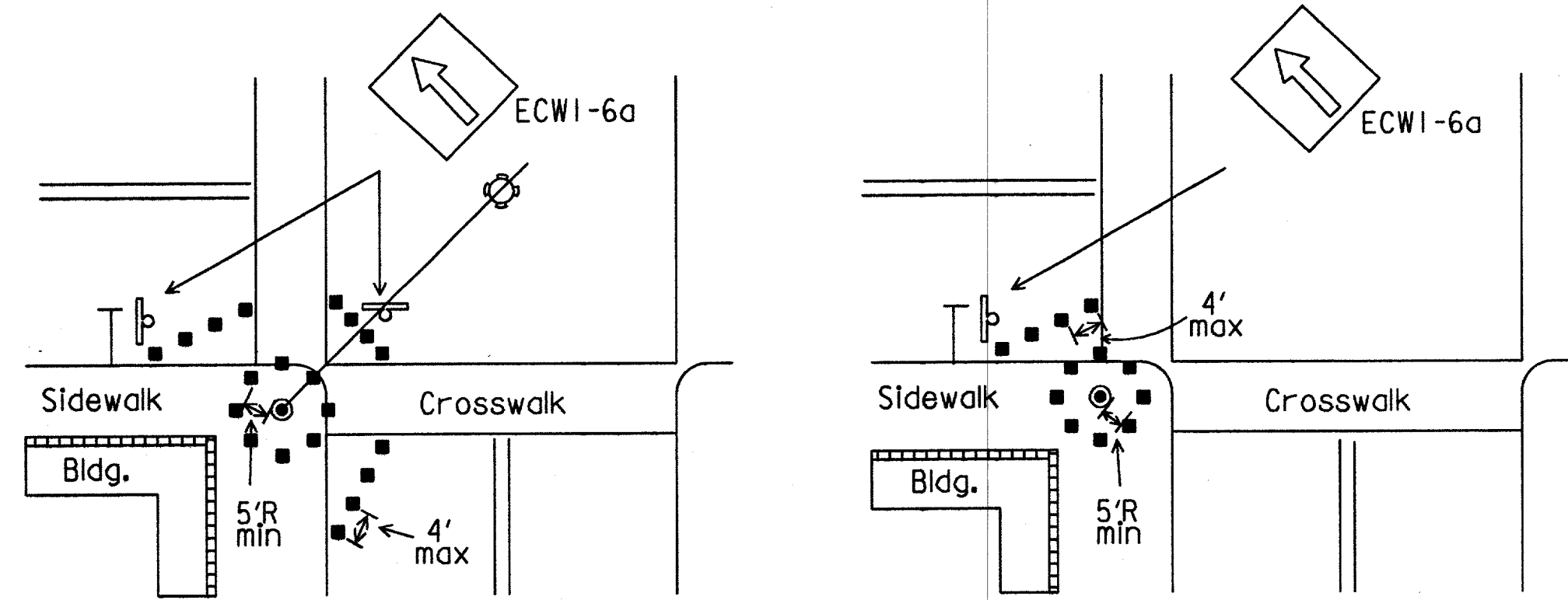

Channelling devices should not be placed closer than 5 foot radius (minimum) to signal poles.
 Parking may be eliminated by placing channelling devices in spaces.
 If pedestrian walkways are blocked, refer to TMUTCD.

TYPICAL RESTRICTED PEDESTRIAN MOVEMENTS

Typical channelling device is the 28" cone. Plastic drums may be used if approved by the Engineer. Metal drums shall NOT be used as a channelling device or sign support.
 For several closely adjoining projects, advance signing may not be required in advance of each intersection, but only in advance of the Intersections at the project limits. See details elsewhere in the plans for advance signing requirements.

Advance signs and barricades shall be in place when signal construction operations are in progress. The contractor may remove advance signs and barricades when no construction operations are underway if permitted elsewhere in the plans. Obstructions or hazards at the work area shall be clearly marked and delineated at all times.

All holes, trenches or other hazardous areas shall be adequately protected by barricades, lights or other protective devices. Trenches shall be covered or surrounded with orange plastic construction fence as directed by the Engineer.

Flagger and FCW20-7a sign may be required according to field conditions. Vehicles parked in roadway shall be equipped with two strobes. High level flags at corners of vehicle may also be used. Work operations that require work vehicle in traveled way 20 minutes or less may use cones, high level flags and strobes as advance warning devices. Cones should only be placed around vehicle. Flaggers may be used on high speed rural intersections.

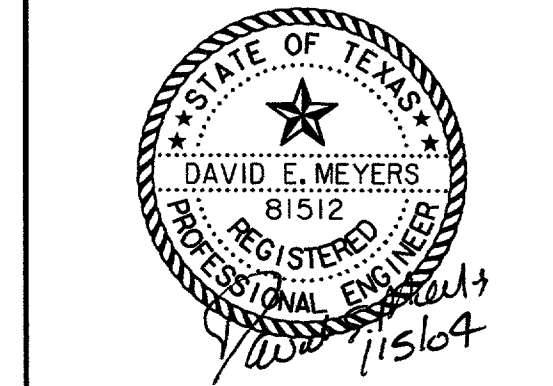

DATE	DESCRIPTION	REF NO.				
1/05/04	ISSUED FOR CONSTRUCTION					
11/07/03	ISSUED FOR BID					
TRAFFIC SIGNAL INSTALLATION TYPICAL DETAILS						
SPECTRUM DRIVE EXTENSION						
TOWN OF ADDISON, TEXAS						
<small>Hutt - Zolters, Inc. 3131 McKinney Ave., Suite 600, Dallas, TX 75204 Phone: (214) 871-3311 / Fax: (214) 871-0757</small>						
DESIGN	DRAWN	APPR.	SCALE	DATE	PROJECT NO.	NO.
HZI	HZI	DEM	NTS	NOV 2003	01-3220-01	66

H:\proj\01322001\dgn\322001TSD7.dgn
 Nov 20 10:42:28 2003
 FILENAME: 01322001.dgn
 PLOT: 01322001TSD7.dgn
 PLOTNO: 1
 PLOTSCALE: 1.0000
 PLOTUNIT: INCHES
 PLOTORIENT: LANDSCAPE
 PLOTSCALE: 1.0000
 PLOTUNIT: INCHES
 PLOTORIENT: LANDSCAPE