

NO.	DATE	REVISION	APPROV.
1			
2			
3			
4			
5			
6			

GRANTHAM & ASSOCIATES
F-005438

P. CHRISTOPHER ROBINSON
101252
REGISTERED PROFESSIONAL ENGINEER

THE SEAL APPEARING ON THIS DOCUMENT WAS AUTHORIZED BY P. CHRISTOPHER ROBINSON ON 10/19/2010. ALTERATION OF A SEALED DOCUMENT WITHOUT PROPER NOTIFICATION TO THE RESPONSIBLE ENGINEER IS AN OFFENSE UNDER THE TEXAS ENGINEERING PRACTICE ACT.

SPECTRUM DRIVE
SIDEWALK RECONSTRUCTION
REQUIRED FOR ADA COMPLIANCE

TOWN OF ADDISON

DATE: OCTOBER 2010
SCALE: 1"=5'
DRAWN BY: G&A
DESIGN: BRG
REVIEWED:
JOB NO: 1122-10
DWG: 1122SWPLAN03

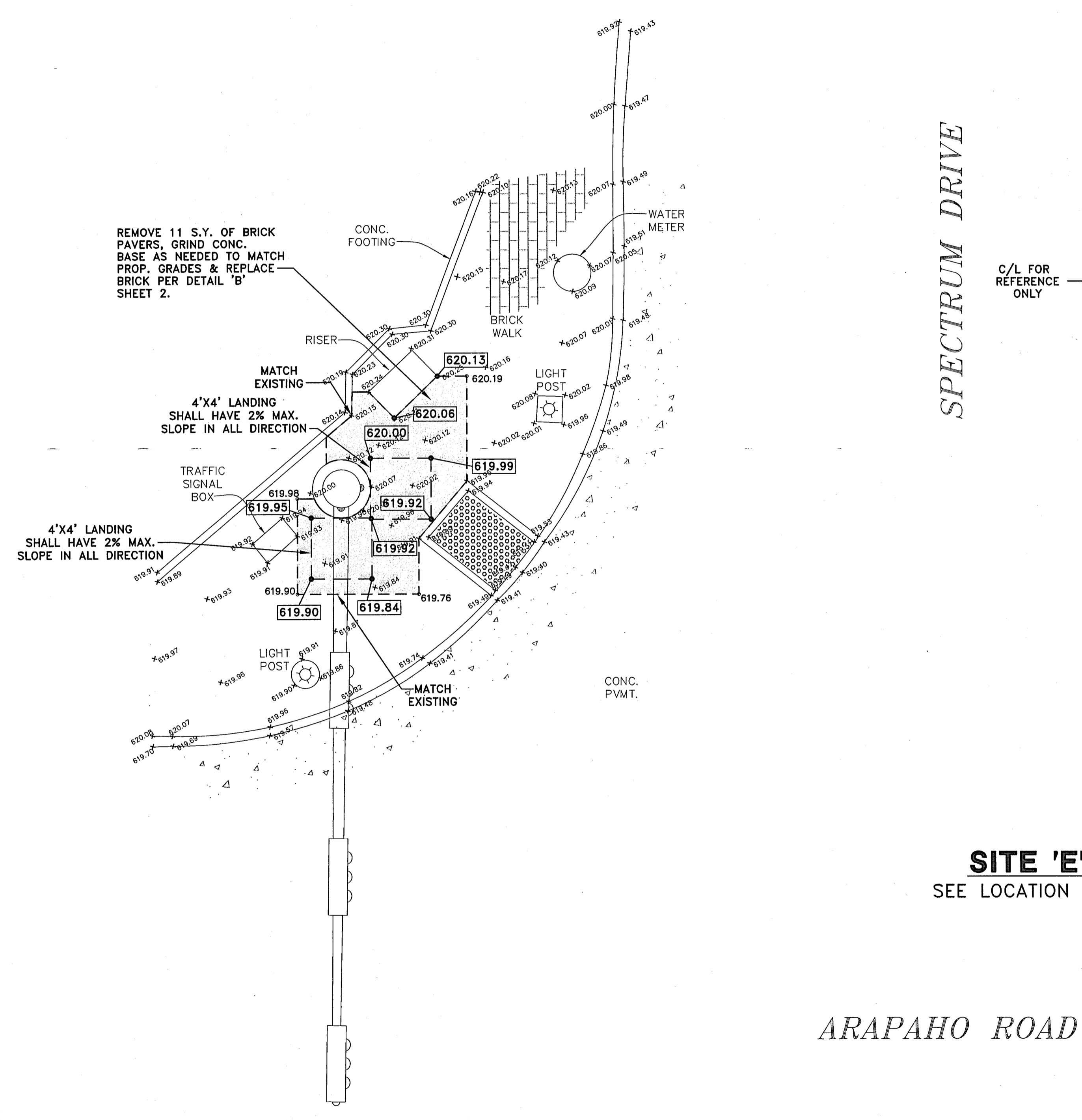

SPECTRUM DRIVE

C/L FOR REFERENCE ONLY

SITE 'E'
SEE LOCATION MAP

ARAPAHO ROAD

- LEGEND:**
- 619.84* EXISTING ELEVATION
 - 619.90° CALCULATED EXISTING ELEVATIONS
 - 619.90• PROPOSED ELEVATION

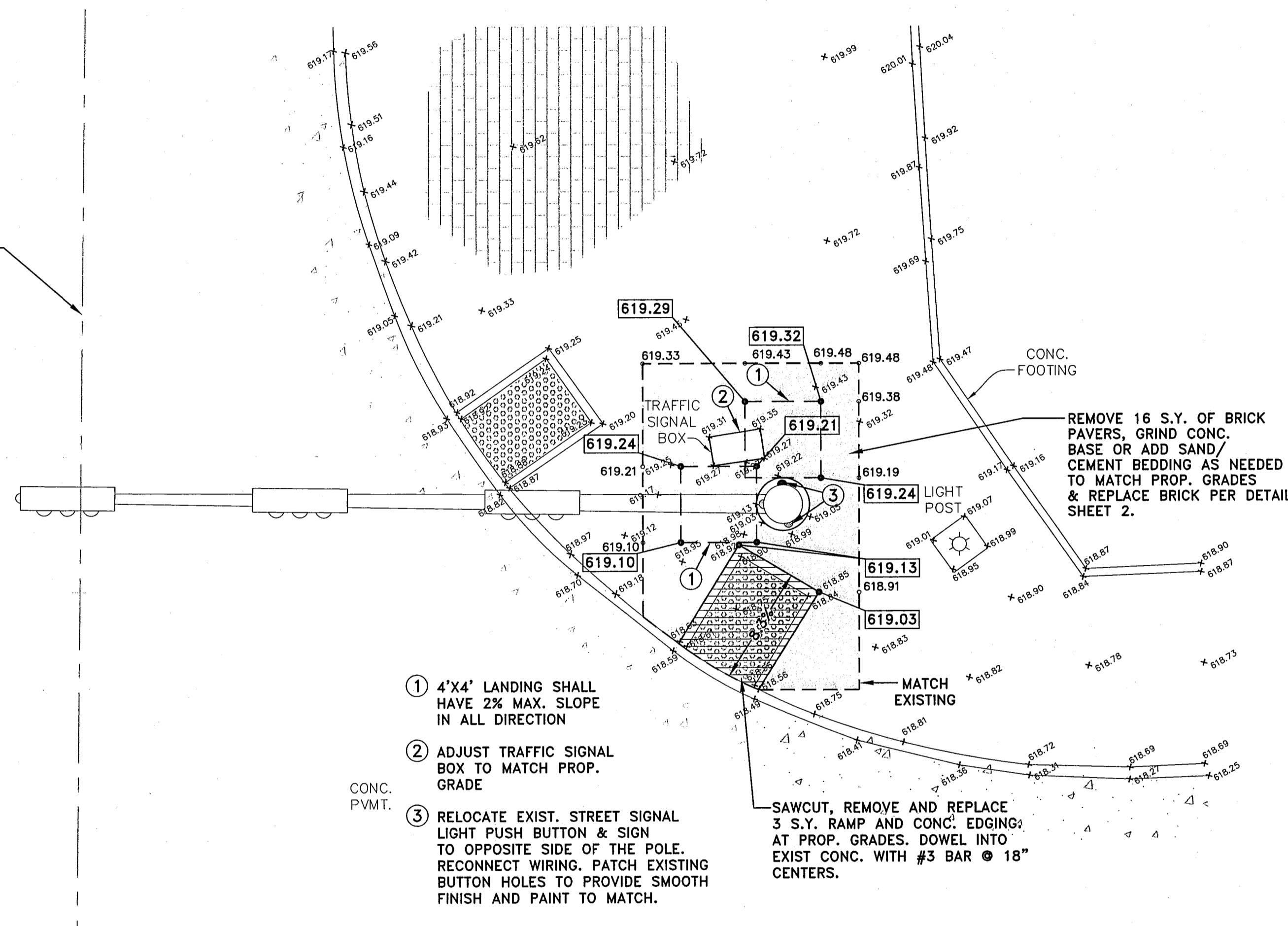

- ① 4'x4' LANDING SHALL HAVE 2% MAX. SLOPE IN ALL DIRECTION
- ② ADJUST TRAFFIC SIGNAL BOX TO MATCH PROP. GRADE
- ③ RELOCATE EXIST. STREET SIGNAL LIGHT PUSH BUTTON & SIGN TO OPPOSITE SIDE OF THE POLE. RECONNECT WIRING. PATCH EXISTING BUTTON HOLES TO PROVIDE SMOOTH FINISH AND PAINT TO MATCH.

SAWCUT, REMOVE AND REPLACE 3 S.Y. RAMP AND CONC. EDGING AT PROP. GRADES. DOWEL INTO EXIST. CONC. WITH #3 BAR @ 18" CENTERS.

NOTE:
1. CONTRACTOR SHALL CONFIRM MAXIMUM 2% CROSS SLOPE AFTER GRINDING IS COMPLETED, PRIOR TO INSTALLING BRICK PAVERS.

STA. 0+00.00