

Town of Addison

Lighting Master Plan - Spectrum Drive
January 19, 2004

Town of Addison
16801 Westgrove Drive
Addison, Texas 750001

Gensler

Architect
5430 LBJ Freeway
Suite 400
Dallas, Texas 75240
214.273.1500

SHEET INDEX
SCALE: N.T.S.

COVER	--
A1.00	KEY PLAN / OVERALL MASTER PLAN
A2.01	ENLARGED PLAN - PART 1
A2.02	ENLARGED PLAN - PART 2
A2.03	ENLARGED PLAN - PART 3
A2.04	ENLARGED PLAN - PART 4
A3.01	PHOTOMETRIC PLAN - PART 1
A3.02	PHOTOMETRIC PLAN - PART 2
A3.03	PHOTOMETRIC PLAN - PART 3
A3.04	PHOTOMETRIC PLAN - PART 4
A3.10	PHOTOMETRIC INFORMATION

Addison![®]

Gensler
5430 LBJ Freeway
Suite 400
Dallas TX 75240
Telephone 214.273.1500
Facsimile 214.273.1505

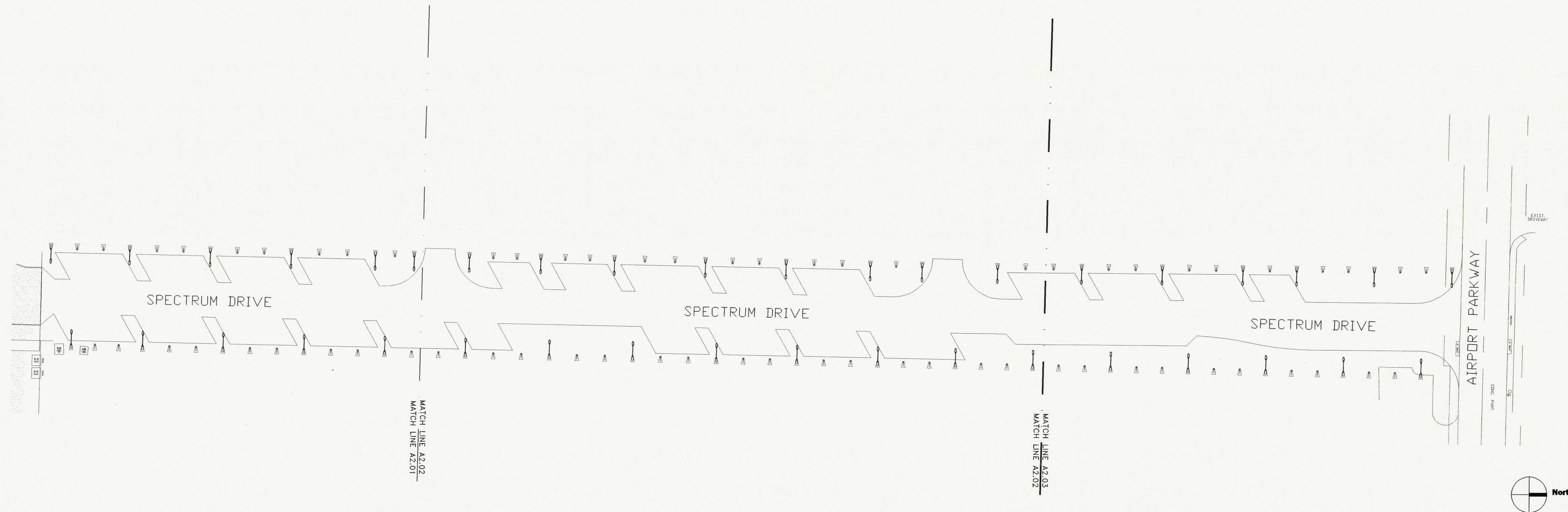

OVERALL STREET PLAN **01**
SCALE: 1" = 50'-0"

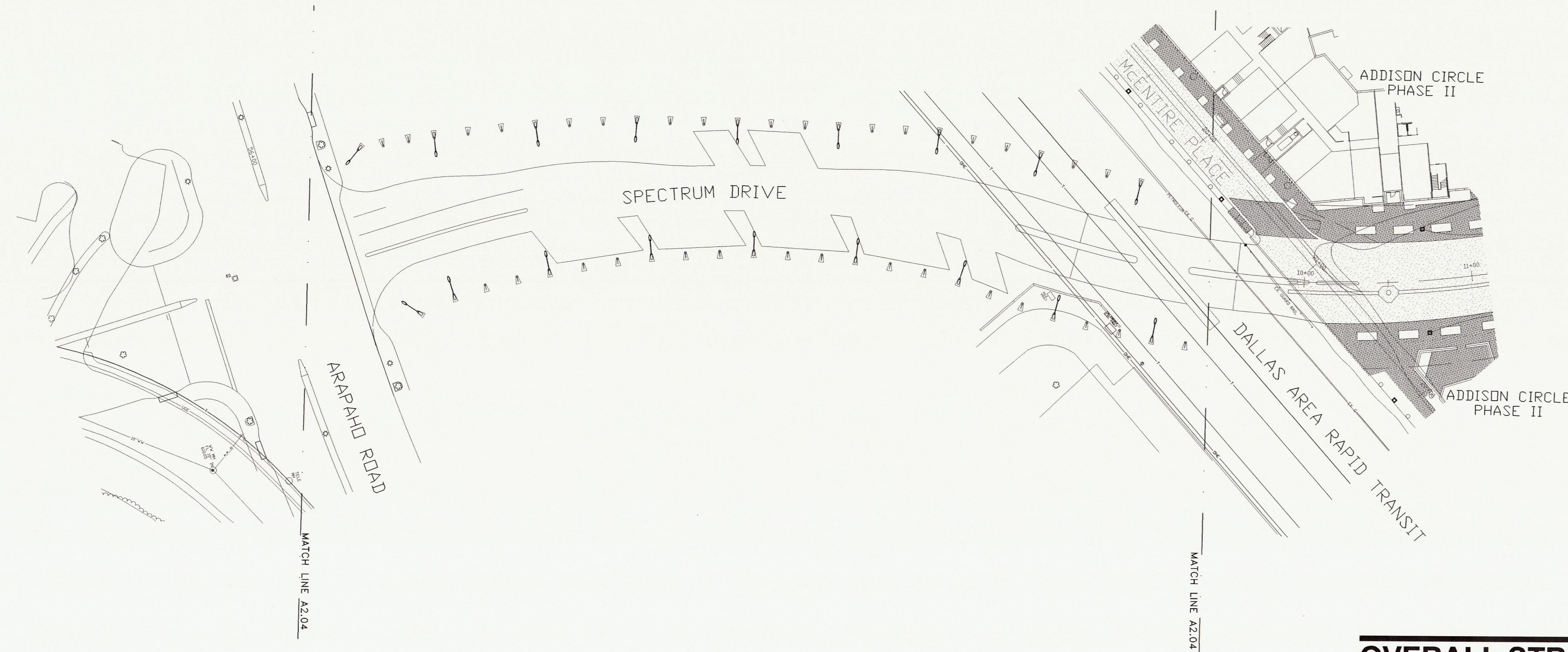

OVERALL STREET PLAN **02**
SCALE: 1" = 50'-0"

Issue	Date & Issue Description	By	Check
01	01/19/04 TOWN OFFICIALS REVIEW	RML	DB

Seal/Signature

Project Name
**TOWN OF ADDISON
LIGHTING MASTER PLAN - SPECTRUM DRIVE**

Project Number
27.3053.000

CAD File Name
K:27.3053.000/CAD/SHEETS/S-1-00.dwg

Description
LIGHTING PLAN
OVERALL MASTER PLAN

Scale

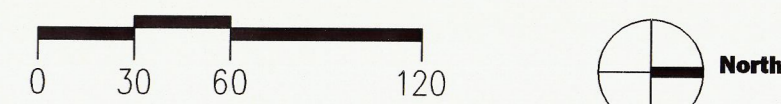

A1.00

©2003 Gensler

Addison!®

Gensler Dallas
 5430 LBJ Freeway
 Suite 400
 TX 75240
 Telephone 214.273.1500
 Facsimile 214.273.1505

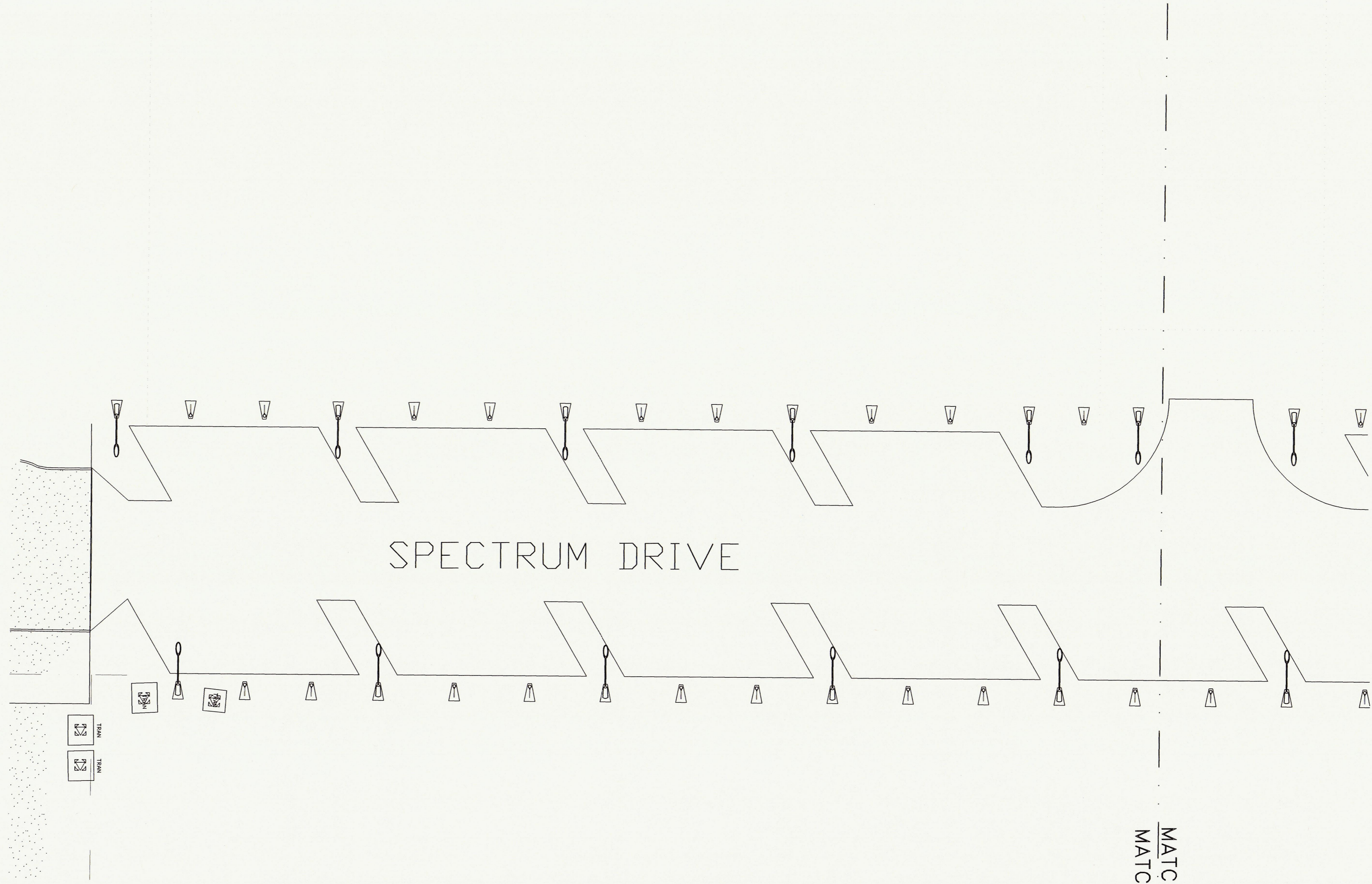

Issue	Date & Issue Description	By	Check
01	01/19/04 TOWN OFFICIALS REVIEW	RML	DB

Seal/Signature

Project Name
 TOWN OF ADDISON
 LIGHTING MASTER PLAN - SPECTRUM DRIVE

Project Number
 27.3053.000

CAD File Name
 K:27.3053.000/CAD/SHEETS/S-2-01.dwg

Description
 LIGHTING PLAN
 PART ONE

Scale

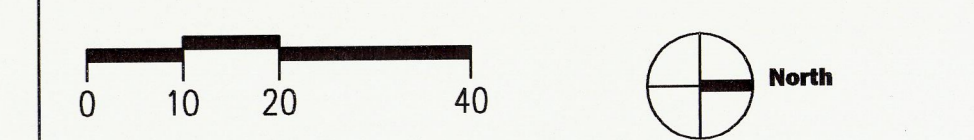

A2.01

© 2003 Gensler

Addison!®

Gensler
 5430 LBJ Freeway
 Suite 400
 Dallas TX 75240
 Telephone 214.273.1500
 Facsimile 214.273.1505

Issue	Date & Issue Description	By	Check
01	01/19/04 TOWN OFFICIALS REVIEW	RML	DB

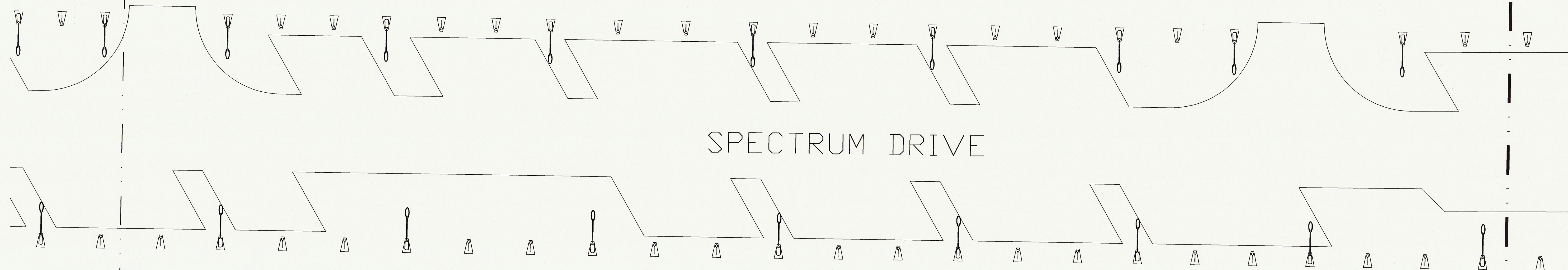

MATCH LINE A2.02
 MATCH LINE A2.01

MATCH LINE A2.03
 MATCH LINE A2.02

Project Name
 TOWN OF ADDISON
 LIGHTING MASTER PLAN - SPECTRUM DRIVE

Project Number
 27.3053.000

CAD File Name
 K: 27.3053.000/CAD/SHEETS/S-2-02.dwg

Description
 LIGHTING PLAN
 PART TWO

Scale

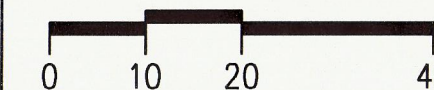

A2.02

ENLARGED PLAN - PART 2
 SCALE: 1" = 20'-0"

01

©2003 Gensler

Addison!®

Gensler
 5430 LBJ Freeway
 Suite 400
 Dallas TX 75240
 Telephone 214.273.1500
 Facsimile 214.273.1505



MATCH LINE A2.03
 MATCH LINE A2.02

Issue	Date & Issue Description	By	Check
01	01/19/04 TOWN OFFICIALS REVIEW	RML	DB

Seal/Signature

Project Name
**TOWN OF ADDISON
 LIGHTING MASTER PLAN - SPECTRUM DRIVE**

Project Number
27.3053.000

CAD File Name
 K: 27.3053.000/CAD/SHEETS/S-2-03.dwg

Description
 LIGHTING PLAN
 PART THREE

Scale

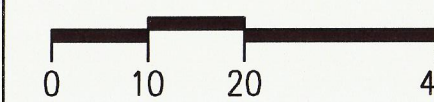

A2.03

ENLARGED PLAN - PART 3
 SCALE: 1" = 20'-0"

01

©2003 Gensler

Addison!®

5430 LBJ Freeway
 Suite 400
 Dallas TX 75240
 Telephone 214.273.1500
 Facsimile 214.273.1505

Gensler

Issue	Date & Issue Description	By	Check
01	01/13/04 TOWN OFFICIALS REVIEW	RML	DB

Seal/Signature

Project Name
 TOWN OF ADDISON
 LIGHTING MASTER PLAN - SPECTRUM DRIVE

Project Number
 27.3053.000

CAD File Name
 K:27.3053.000/CAD/SHEETS/S-2-04.dwg

Description
 LIGHTING PLAN
 PART FOUR

Scale

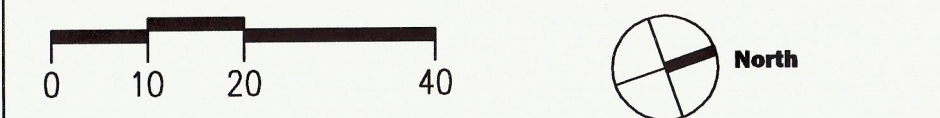

A2.04

©2003 Gensler

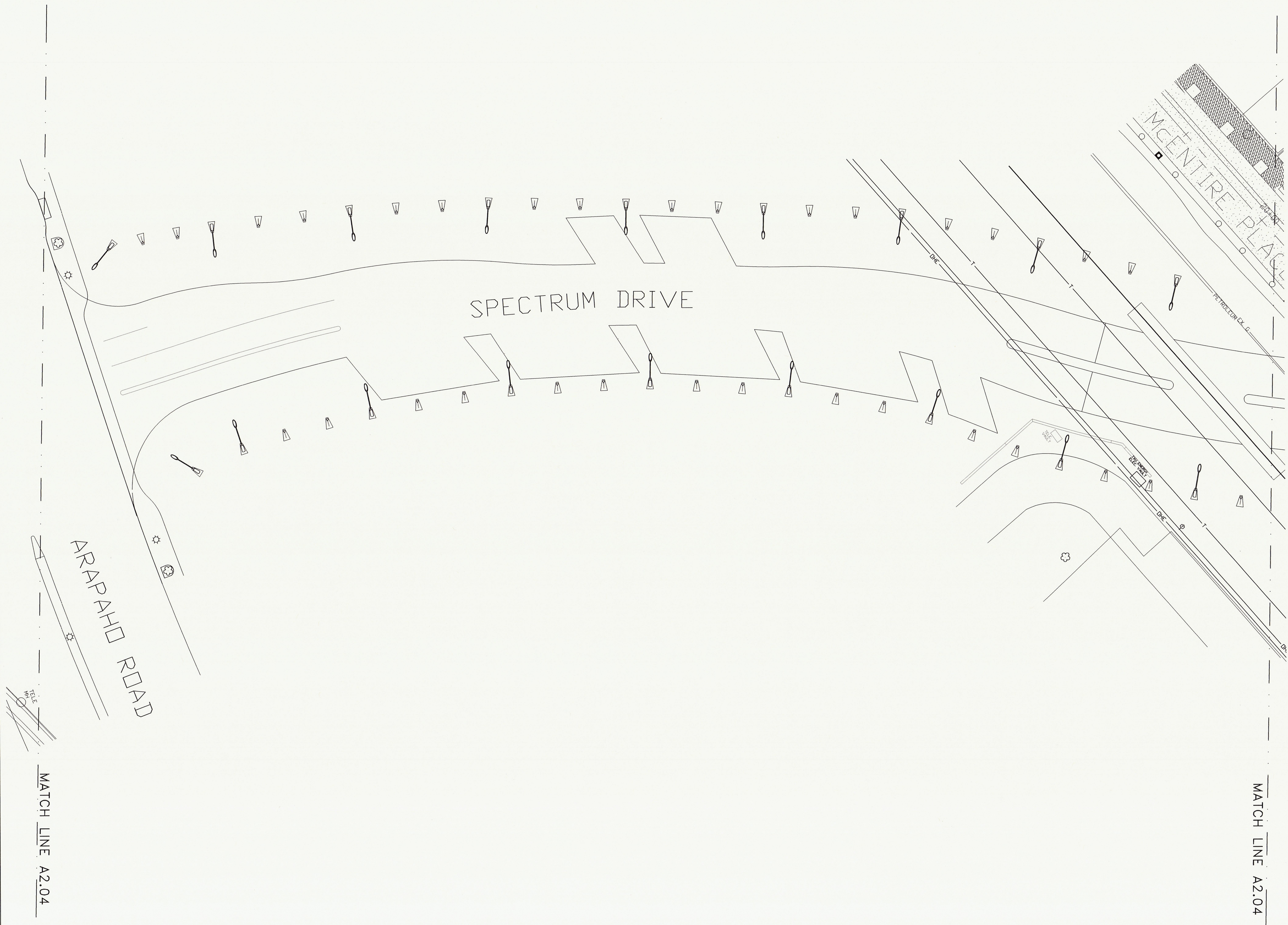

ENLARGED PLAN - PART 4
 SCALE: 1" = 20'-0"

01

MATCH LINE A2.04

MATCH LINE A2.04



Gensler
 5430 LBJ Freeway
 Suite 400
 Dallas TX 75240
 Telephone 214.273.1500
 Facsimile 214.273.1505

Issue	Date & Issue Description	By	Check
01	01/19/04 TOWN OFFICIALS REVIEW	RML	DB

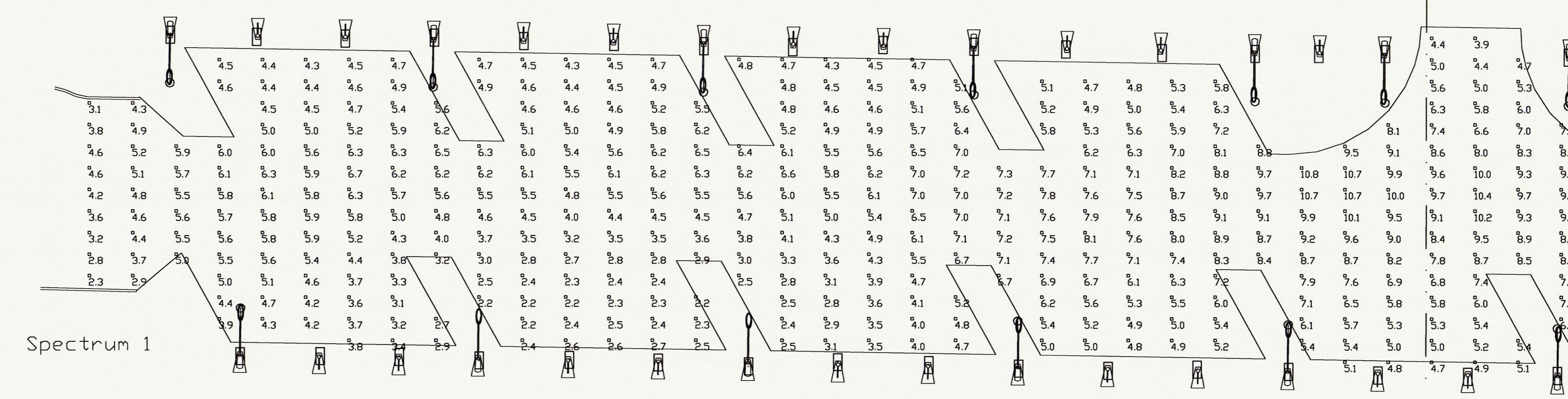

MATCH LINE A3.02
MATCH LINE A3.01

Project Name
TOWN OF ADDISON
LIGHTING MASTER PLAN - SPECTRUM DRIVE

Project Number
27.3053.000

CAD File Name
K: 27.3053.000/CAD/SHEETS/S-3-01.dwg

Description
PHOTOMETRIC PLAN
PART 1

Scale

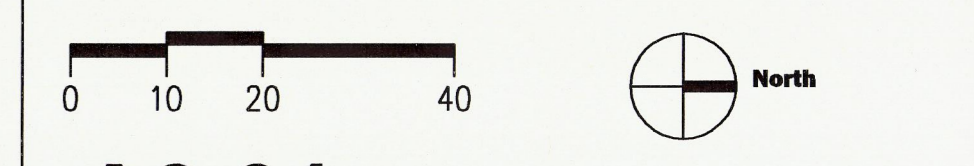

A3.01



5430 LBJ Freeway
 Suite 400
 Dallas TX 75240
 Telephone 214.273.1500
 Facsimile 214.273.1505

Gensler

Issue	Date & Issue Description	By	Check
01	01/19/04 TOWN OFFICIALS REVIEW	RML	DB

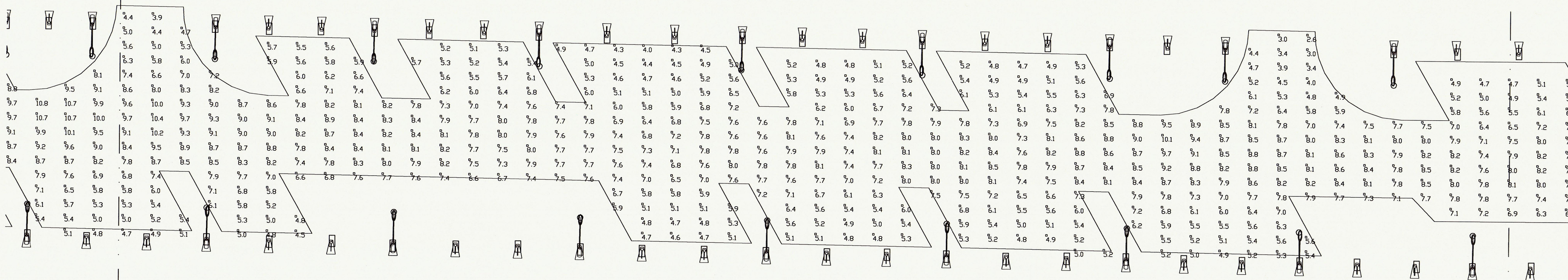

MATCH LINE A3.02
MATCH LINE A3.01

MATCH LINE A3.03
MATCH LINE A3.02

Seal/Signature

Project Name
**TOWN OF ADDISON
 LIGHTING MASTER PLAN - SPECTRUM DRIVE**

Project Number
27.3053.000
 CAD File Name
 K:27.3053.000/CAD/SHEETS/S-3-03.dwg

Description
 PHOTOMETRIC PLAN
 PART 3

Scale

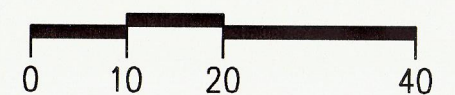

A3.03

PHOTOMETRIC PLAN - PART 3
 SCALE: N.T.S.

01

©2003 Gensler

Addison!

Gensler
 5430 LBJ Freeway
 Suite 400
 Dallas, TX 75240
 Telephone 214.273.1500
 Facsimile 214.273.1505

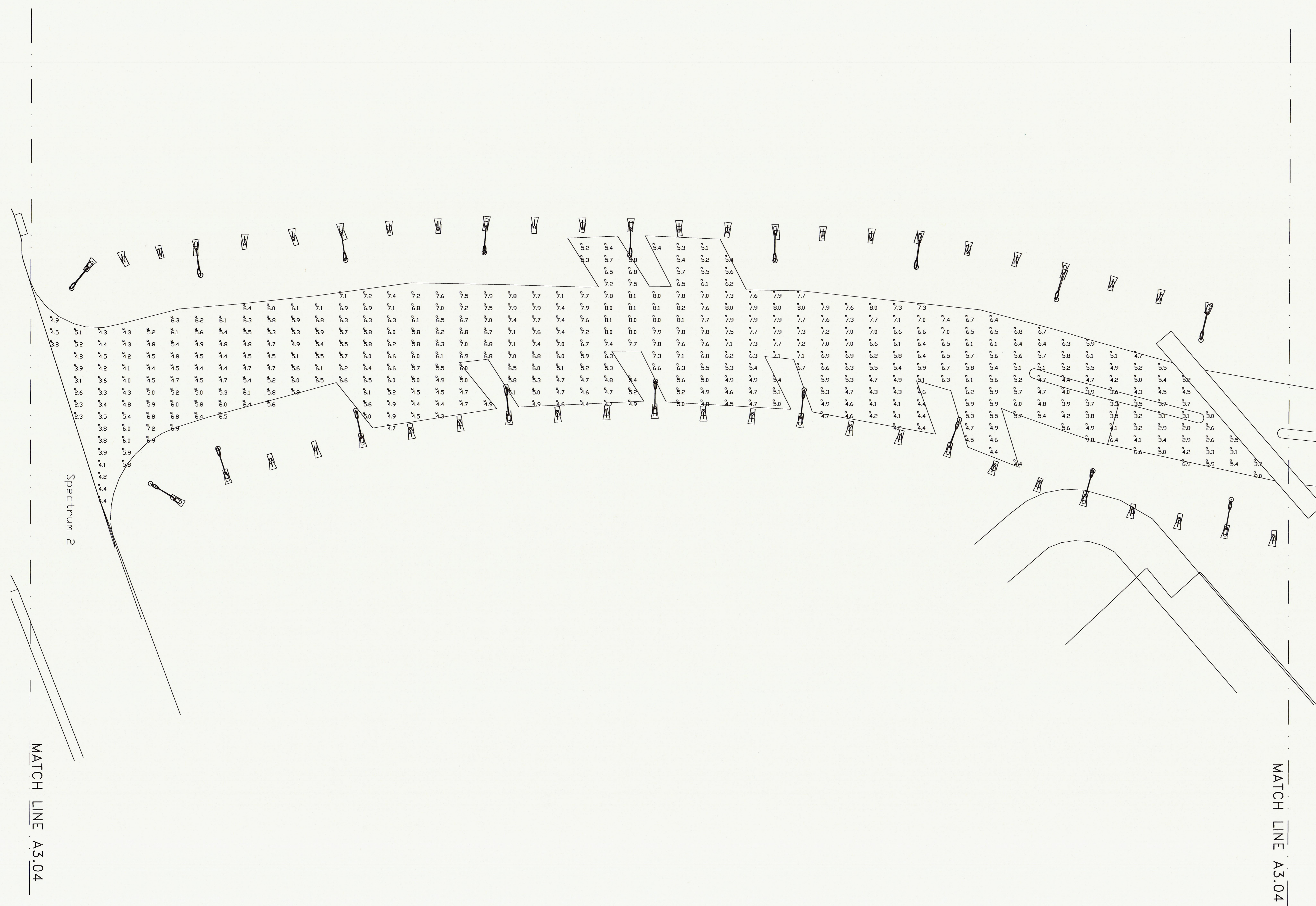

Issue	Date & Issue Description	By	Check
01	01/19/04 TOWN OFFICIALS REVIEW	RML	DB

Seal/Signature _____

Project Name
**TOWN OF ADDISON
 LIGHTING MASTER PLAN - SPECTRUM DRIVE**

Project Number
27.3053.000

CAD File Name
 K: 27.3053.000/CAD/SHEETS/S-3-04.dwg

Description
 PHOTOMETRIC PLAN
 PART 4

Scale

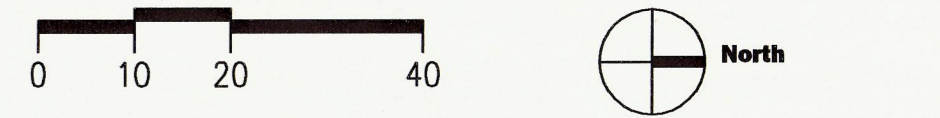

A3.04

© 2003 Gensler

MATCH LINE A3.04

MATCH LINE A3.04

PHOTOMETRIC PLAN - PART 4 **01**
 SCALE: N.T.S.

File name : 4206_Spectrum_001.DWG

Luminaire Schedule								
Project: All Projects								
Symbol	Qty	Label	Arrangement	Lumens	LLF	Description	Arm	Filename
	54	Hestia X	SINGLE	32000	0.720	HSX-400MH-SC2	11	210692.IES
	152	Residential	SINGLE	6600	0.720	70MH-T6	0	8000153.IES

Numeric Summary							
Project: All Projects							
Label	CalcType	Units	Avg	Max	Min	Avg/Min	Max/Min
Spectrum 1	Illuminance	Fc	6.41	10.8	2.2	2.91	4.91
Spectrum 2	Illuminance	Fc	5.74	9.8	2.3	2.50	4.26

Luminaire Location Summary						
Project: All Projects						
SeqNo	Label	X	Y	Z	Orient	Tilt
1	Hestia X	71.8	681.9	35.75	270	0
2	Residential	71.9	682	14	90	0
3	Residential	88.1	607.6	14	270	0
4	Hestia X	88.2	607.7	35.75	90	0
5	Residential	91.9	681.5	14	270	0
6	Residential	106.6	607.6	14	90	0
7	Residential	112.4	681.1	14	270	0
8	Residential	124.8	607.4	14	90	0
9	Hestia X	132.6	680.9	35.75	270	0
10	Residential	132.9	681.3	14	90	0
11	Residential	143.3	606.6	14	270	0
12	Residential	153.6	680.5	14	270	0
13	Residential	164.1	606.7	14	90	0
14	Residential	174.4	680.3	14	270	0
15	Residential	184.6	606.1	14	90	0
16	Hestia X	195	679.7	35.75	270	0
17	Residential	195.1	679.3	14	90	0
18	Residential	205.5	605.2	14	270	0
19	Residential	215.7	679.1	14	270	0
20	Residential	226.1	606.2	14	90	0
21	Residential	236.5	679.6	14	270	0
22	Residential	247.1	605.5	14	90	0
23	Hestia X	257.5	679.1	35.75	270	0
24	Residential	257.5	679.2	14	90	0
25	Residential	267.8	228.2	14	53.647	0
26	Hestia X	267.9	227.8	35.75	230.553	0
27	Hestia X	267.7	604.7	35.75	90	0
28	Residential	267.9	604.7	14	270	0
29	Residential	278.8	678.6	14	270	0
30	Residential	283	230.4	14	295.78	0
31	Residential	288.6	604.2	14	90	0
32	Residential	297.7	233.6	14	287.241	0
33	Residential	301	677.8	14	270	0
34	Hestia X	303.2	132.5	35.75	150.133	0
35	Residential	304	131.7	14	330.524	0
36	Residential	309.1	604.5	14	90	0
37	Residential	312.3	234.7	14	92.526	0
38	Hestia X	312.6	235.5	35.75	279.574	0
39	Hestia X	322.5	677.6	35.75	270	0
40	Residential	322.5	677.6	14	90	0
41	Hestia X	324.8	142	35.75	106.26	0
42	Residential	325.1	142	14	286.557	0
43	Hestia X	330.2	603.9	35.75	90	0
44	Residential	330.3	604	14	270	0
45	Residential	332.4	237.4	14	277.989	0
46	Residential	337.2	677.6	14	270	0
47	Residential	343.6	148.4	14	109.25	0
48	Residential	350.9	603.2	14	90	0
49	Hestia X	352.5	677.3	35.75	270	0
50	Residential	352.6	677.6	14	90	0
51	Residential	353.5	239	14	289.385	0
52	Residential	361.9	153.6	14	109.026	0
53	Residential	371.6	602.9	14	90	0
54	Hestia X	372.8	241.7	35.75	279.767	0
55	Residential	373.6	241.2	14	111.523	0
56	Residential	381.3	156.9	14	281.31	0
57	Hestia X	381.4	157.6	35.75	102.907	0
58	Residential	392.8	243.1	14	284.036	0
59	Hestia X	392.4	603	35.75	90	0
60	Residential	392.4	603.1	14	270	0
61	Hestia X	394.9	676.6	35.75	270	0
62	Residential	394.9	676.8	14	90	0
63	Residential	401.7	160.9	14	101.842	0
64	Residential	413.1	243.9	14	267.207	0
65	Residential	413.6	676.2	14	270	0
66	Residential	414.1	602.4	14	90	0
67	Residential	422	164.1	14	94.514	0
68	Residential	431.5	676.2	14	270	0
69	Residential	432.7	245	14	78.977	0
70	Hestia X	432.8	245	35.75	266.424	0
71	Residential	435.8	602.8	14	90	0
72	Residential	442.4	166.1	14	276.34	0
73	Hestia X	442.4	167.4	35.75	96.45	0
74	Hestia X	449.9	676.1	35.75	270	0
75	Residential	450.1	675.8	14	90	0

SeqNo	Label	X	Y	Z	Orient	Tilt
76	Residential	452.7	243.9	14	271.736	0
77	Residential	456.9	601.3	14	270	0
78	Hestia X	457.2	601.9	35.75	90	0
79	Residential	462.7	167.9	14	98.746	0
80	Residential	469	675.2	14	270	0
81	Residential	472.8	244.4	14	261.764	0
82	Residential	478.7	601.1	14	90	0
83	Residential	483.1	168.3	14	92.386	0
84	Residential	487.8	675.2	14	270	0
85	Residential	492.8	244.5	14	86.775	0
86	Hestia X	492.9	243.9	35.75	267.745	0
87	Residential	500.2	601.3	14	90	0
88	Residential	502.9	169	14	272.121	0
89	Hestia X	502.9	169.4	35.75	88.29	0
90	Residential	507	674.8	14	90	0
91	Hestia X	507.3	674.8	35.75	270	0
92	Residential	513	242.8	14	277.989	0
93	Hestia X	521.8	600.4	35.75	90	0
94	Residential	521.9	600.4	14	270	0
95	Residential	523.1	168.1	14	93.576	0
96	Residential	530.7	674	14	270	0
97	Residential	533	242.3	14	260.628	0
98	Residential	543.5	166.9	14	82.405	0
99	Residential	543.2	600	14	90	0
100	Hestia X	553	241.5	35.75	269.157	0
101	Residential	553.6	241.2	14	95.029	0
102	Residential	554	673.9	14	270	0
103	Residential	563.7	165	14	262.235	0
104	Hestia X	563.7	165.8	35.75	82.648	0
105	Residential	564.7	599.8	14	90	0
106	Residential	572.5	240.7	14	267.371	0
107	Hestia X	577.2	673.9	35.75	270	0
108	Residential	577.5	674.1	14	90	0
109	Residential	584.3	161.8	14	78.69	0
110	Residential	586.1	599.5	14	270	0
111	Hestia X	586.5	599.8	35.75	90	0
112	Residential	592.6	239.8	14	265.101	0
113	Residential	598.3	673.2	14	270	0
114	Residential	605.2	158	14	74.291	0
115	Residential	607.2	599.2	14	90	0
116	Residential	612.1	239.6	14	72.332	0
117	Hestia X	613.1	238.7	35.75	261.733	0
118	Residential	619.1	672.9	14	270	0
119	Residential	625.4	152.8	14	254.279	0
120	Hestia X	625.5	154.1	35.75	68.344	0
121	Residential	628.1	599.2	14	90	0
122	Residential	632.9	234.7	14	258.015	0
123	Residential	639.8	672.7	14	90	0
124	Hestia X	639.9	672.5	35.75	270	0
125	Residential	644.3	145.1	14	73.78	0
126	Residential	648.6	598.7	14	270	0
127	Hestia X	648.7	599	35.75	90	0
128	Residential	652.6	230	14	251.94	0
129	Residential	661.6	672.2	14	270	0
130	Residential	662.7	138.1	14	67.659	0
131	Residential	669.2	598	14	90	0
132	Residential	672.8	224.9	14	67.788	0
133	Hestia X	673	224.8	35.75	252.621	0
134	Residential	681.8	132.6	14	255.964	0
135	Hestia X	682	132.5	14	73.94	0
136	Residential	683.3	671.9	14	270	0
137	Residential	690.4	598.2	14	90	0
138	Residential	692.5	220	14	255.194	0
139	Residential	701.6	127.3	14	80.87	0
140	Residential	704.8	672.4	14	90	0
141	Hestia X	704.9	671.7	35.75	270	0
142	Residential	710.9	598.1	14	270	0
143	Hestia X	711.2	597.8	35.75	90	0
144	Residential	712.4	214.6	14	257.989	0
145	Residential	721	123.3	14	76.76	0
146	Residential	724.6	671.2	14	270	0
147	Residential	730.9	597.6	14	90	0
148	Hestia X	732.5	208.1	35.75	255.842	0
149	Residential	733	210.3	14	65.002	0

SeqNo	Label	X	Y	Z	Orient	Tilt
150	Residential	740.5	118.6	14	255.964	0
151	Hestia X	740.7	120.3	14	80.159	0
152	Hestia X	744.8	671	35.75	270	0
153	Residential	744.8	671.4	14	90	0
154	Residential	751.1	597.1	14	90	0
155	Residential	760.4	116.2	14	90	0
156	Hestia X	770.8	596.8	35.75	90	0
157	Residential	771.1	597.1	14	270	0
158	Residential	790.9	596.8	14	90	0
159	Residential	803.1	670.6	14	90	0
160	Hestia X	803.2	670	35.75	270	0
161	Residential	811.6	596.2	14	90	0
162	Residential	825.3	669.9	14	270	0
163	Residential	830.9	595.5	14	270	0
164	Hestia X	831	596	35.75	90	0
165	Residential	846.6	670.2	14	270	0
166	Residential	851.3	595.8	14	90	0
167	Hestia X	868.3	669.7	35.75	270	0
168	Residential	868.3	670.4	14	90	0
169	Residential	870.9	595.7	14	90	0
170	Residential	888.9	670.2	14	270	0
171	Residential	890.9	595	14	270	0
172	Hestia X	891.1	595	35.75	90	0
173	Residential	909.8	669.9	14	270	0
174	Residential	911.1	594.5	14	90	0
175	Hestia X	930.6	670.1	35.75	270	0
176	Residential	930.8	669.9	14	90	0
177	Residential	931.1	594	14	90	0
178	Hestia X	951.1	593.9	35.75	90	0
179	Residential	951.3	594	14	270	0
180	Residential	951.6	670.2	14	270	0
181	Residential	970.9	593.5	14	90	0
182	Residential	972.1	669.9	14	270	0
183	Residential	991.1	593.3	14	90	0