

**LEGEND**

⊕	FIRE HYDRANT
⊕	POWER POLE
⊕	LIGHT STANDARD
⊕	WATER METER
⊕	WATER VALVE
⊕	CLEANOUT
⊕	MANHOLE
⊕	GAS METER
⊕	TELEPHONE BOX
⊕	TV BOX
⊕	FLAG POLE
---	PROPERTY LINE
---	O.H. POWER LINES
---	FENCE

**GENERAL NOTES:**

1. ALL WORK SHALL BE IN ACCORDANCE WITH THE "STANDARD SPECIFICATIONS FOR PUBLIC WORKS CONSTRUCTION" AS PUBLISHED BY THE NORTH CENTRAL TEXAS COUNCIL OF GOVERNMENTS.
2. ALL WORK SHALL CONFORM TO ALL APPLICABLE LOCAL, STATE AND FEDERAL REQUIREMENTS.
3. CONTRACTOR SHALL CONTACT ALL PUBLIC UTILITY COMPANIES FOR LINE LOCATION 48 HOURS PRIOR TO BEGINNING CONSTRUCTION.
4. CONTRACTOR SHALL LIMIT CONSTRUCTION ACTIVITIES SO AS TO NOT DISRUPT THE NORMAL USE OF THE ATHLETIC FACILITY. AREAS USED FOR CONSTRUCTION, MATERIAL STORAGE, AND EQUIPMENT ACCESS MUST BE APPROVED BY THE OWNER AND/OR ENGINEER PRIOR TO BEGINNING WORK.
5. WORK HOURS SHALL BE LIMITED TO BETWEEN 8:00 A.M. AND 5:00 P.M., MONDAY THROUGH FRIDAY UNLESS PRIOR WRITTEN APPROVAL IS OBTAINED FROM THE OWNER.
6. CONTRACTOR SHALL KEEP THE CONSTRUCTION AREA(S) AND CLEAN AT ALL TIMES THROUGHOUT THE DURATION OF THE PROJECT. ALL CONSTRUCTION AREAS SHALL BE ADEQUATELY BARRICADED AND LIGHTED TO INSURE THE PUBLIC SAFETY.

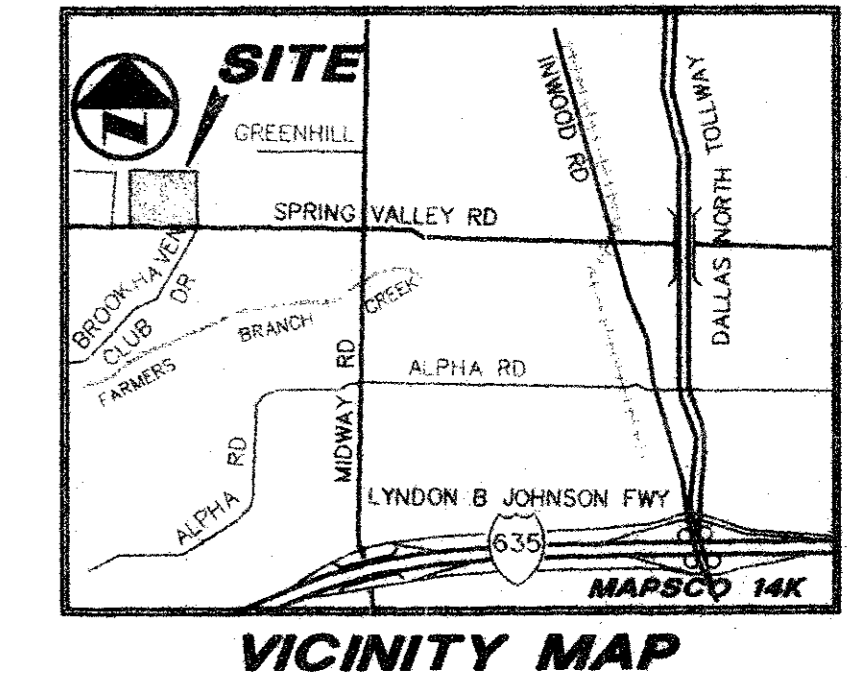

**BENCH MARKS:**

B.M. #1	40g NAIL IN POWER POLE.	ELEV. 583.50
B.M. #2	40g NAIL IN POWER POLE ON SOUTH SIDE SPRING VALLEY NEAR SOUTHEAST CORNER TRACT.	ELEV. 585.83



<b>PACHECO KOCH</b> Consulting Engineers, Inc.		9401 LBJ Freeway, Suite 300 Dallas, Texas 75248 (214) 285-3081	
<b>SANITARY SEWER PLAN</b>			
SANITARY SEWER IMPROVEMENTS LOOS ATHLETIC CENTER DALLAS INDEPENDENT SCHOOL DISTRICT <b>TOWN OF ADDISON, TEXAS</b>			
DESIGN	DRAWN	DATE	SCALE
MAP	CAH	OCT 1992	1" = 40'
FILE	NO.		
		<b>1 OF 2</b>	

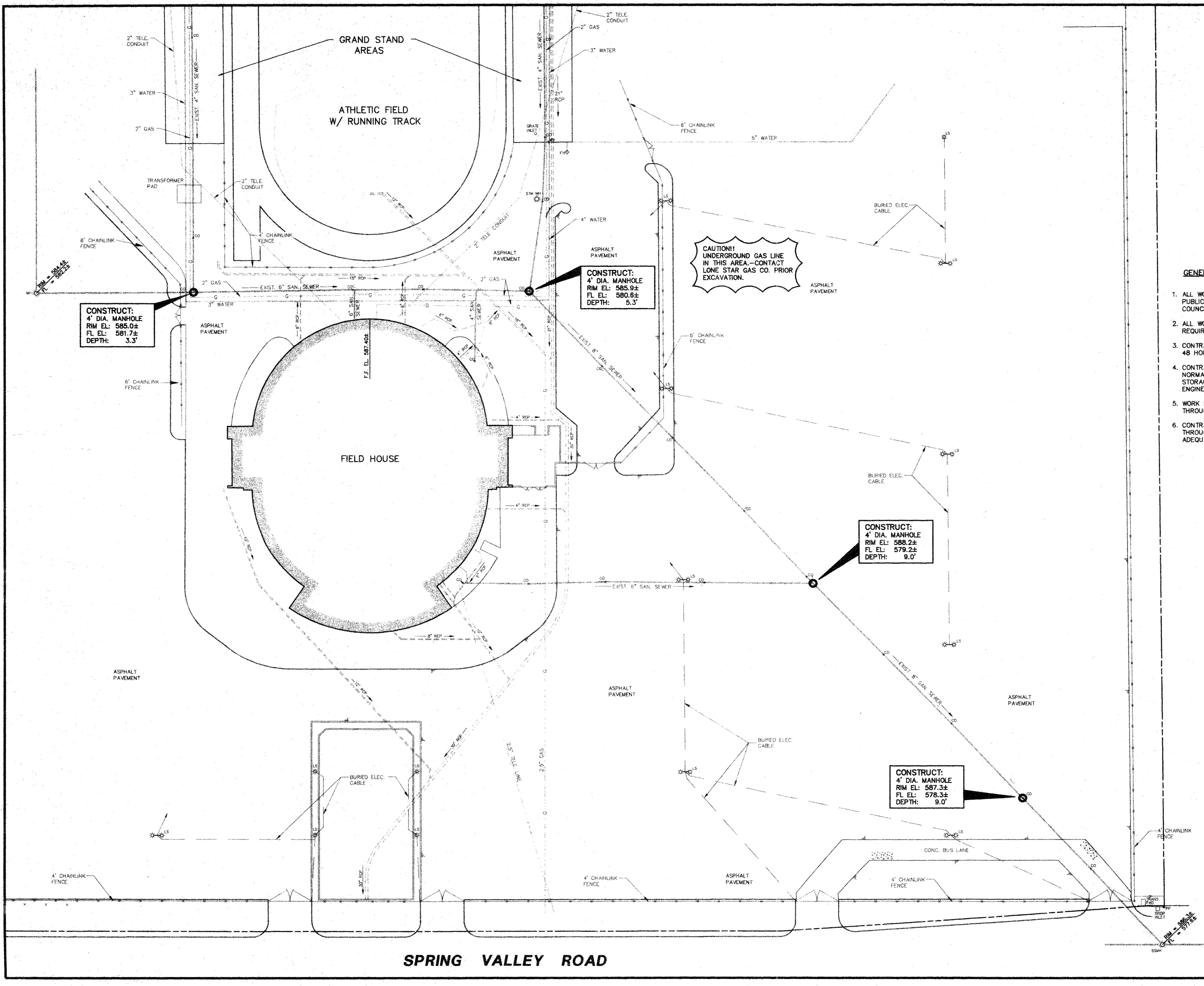

**CONSTRUCT:**  
4" DIA. MANHOLE  
RIM EL: 585.9±  
FL EL: 580.6±  
DEPTH: 5.3'

**CAUTION!!**  
UNDERGROUND GAS LINE  
IN THIS AREA—CONTACT  
LONE STAR GAS CO. PRIOR  
EXCAVATION.

**CONSTRUCT:**  
4" DIA. MANHOLE  
RIM EL: 588.2±  
FL EL: 579.2±  
DEPTH: 9.0'

**CONSTRUCT:**  
4" DIA. MANHOLE  
RIM EL: 587.3±  
FL EL: 578.3±  
DEPTH: 9.0'

**SPRING VALLEY ROAD**