

**LEGEND**

B	BOLLARD	TR	TRAFFIC SIGN
EM	ELECTRIC METER	IRS	1/2" IRON ROD
PP	POWER POLE	W	W/PAACHECO KOCH" CAP SET
LS	LIGHT STANDARD	(C.M.)	CONTROLLING MONUMENT
WM	WATER METER	---	PROPERTY LINE
WV	WATER VALVE	---	FENCE
ICV	IRRIGATION CONTROL VALVE	EL 613	EXIST CONTOUR
CS	CLEANOUT	EL 612.39	EXIST SPOT ELEVATION
MH	MANHOLE	EL 612.39	EXIST TOP OF CURB ELEVATION
TSC	TRAFFIC SIGNAL CONTROL	EL 612.39	EXIST GUTTER ELEVATION
TSP	TRAFFIC SIGNAL POLE	EL 612.39	PROPOSED CONTOUR
TEB	TELEPHONE BOX	EL 612.39	PROPOSED TOP OF CURB ELEVATION
FL	FLOOD LIGHT	EL 612.39	PROPOSED GUTTER ELEVATION
FP	FLAG POLE	EL 612.39	PROPOSED SPOT ELEVATION
		---	PROPOSED DRAINAGE FLOW DIRECTION

- GRADING AND DRAINAGE GENERAL NOTES**
- REFER TO GEOTECHNICAL REPORT FOR REQUIREMENTS REGARDING FILL COMPACTION AND MOISTURE CONTENT.
  - UNLESS NOTED, ALL FILL IS TO BE COMPACTED TO A MINIMUM OF 95% STANDARD PROCTOR DENSITY WITHIN 3% OF OPTIMUM MOISTURE CONTENT. FILL TO BE PLACED IN A MAXIMUM OF 6" LIFTS.
  - SIDEWALKS AND ACCESSIBLE ROUTES SHALL HAVE A SLOPE NO GREATER THAN 5% AND A CROSS FALL NO GREATER THAN 2% UNLESS NOTED OTHERWISE.
  - GRADING OF ALL HANDICAPPED SPACES AND ROUTES TO CONFORM TO STATE, LOCAL AND FEDERAL GUIDELINES.
  - UNLESS NOTED, STORM DRAIN LINES MAY BE OF THE FOLLOWING MATERIALS:  
 A. ADS N-12  
 B. ADS N-12  
 C. HANCOCK H-10  
 AND INSTALLED IN ACCORDANCE WITH MANUFACTURER'S SPECIFICATIONS.
  - UNLESS NOTED, GRATE INLET TO BE "AMERICAN INDUSTRIAL PRE-CAST PRODUCTS, INC." PRECAST GRATE BASIN, SIZED AS SHOWN, OF APPROVED EQUAL.
  - FINAL PAVING, CURB AND SIDEWALK ELEVATIONS WILL BE PLACED AT PLUS OR MINUS 0.03 FOOT.
  - REFER TO LANDSCAPE SPECIFICATION FOR SEEDING AND SOODING REQUIREMENTS.
  - ANY CONCRETE, ROCK OR MATERIAL DEEMED UNSUITABLE FOR SUBGRADE, BY ENGINEER, SHALL BE DISPOSED OF OFFSITE AT CONTRACTOR'S EXPENSE.
  - TRENCH BACKFILL MATERIAL SHALL CONFORM TO THE REQUIREMENTS OF NCTCOG ITEM 6.2.10, AND SHALL BE MECHANICALLY COMPACTED IN ACCORDANCE WITH NCTCOG ITEM 6.2.9 TO A MINIMUM OF 95% STANDARD PROCTOR DENSITY UNLESS OTHERWISE SHOWN ON THESE PLANS OR STATED IN THE STANDARD TOWN SPECIFICATIONS.
  - EMBEDMENT SHALL CONFORM TO THE REQUIREMENTS OF NCTCOG ITEM 6.2.9 UNLESS OTHERWISE SHOWN ON THESE PLANS OR STATED IN THE STANDARD TOWN SPECIFICATIONS.
  - A ROUND MANHOLE COVER MEETING TOWN SPECIFICATIONS SHALL BE PLACED IN ALL INLET TOPS. THE MANHOLE COVER SHALL BE PLACED NEAR THE OUTLET PIPE.
  - ALL CONCRETE FOR INLETS AND DRAINAGE STRUCTURES SHALL CONFORM TO NCTCOG ITEM 7.4.5, CLASS "A" UNLESS OTHERWISE SHOWN ON THESE PLANS OR STATED IN STANDARD TOWN SPECIFICATIONS.
  - CRUSHED STONE BEDDING OR APPROVED EQUAL SHALL BE PROVIDED BY THE CONTRACTOR WHEN ROCK IS ENCOUNTERED IN TRENCHES. THERE SHALL BE NO ADDITIONAL PAY ITEM OF THE CRUSHED STONE BEDDING.
  - IF REQUIRED DUE TO CONSTRUCTION, POWER POLES TO BE BRACED OR RELOCATED AT CONTRACTOR'S EXPENSE.
  - CONTRACTOR TO PROVIDE DETAILS OF EXCAVATION PROCEDURES PRIOR TO CONSTRUCTION.

**BENCH MARK LIST**

CITY BM	DESCRIPTION	ELEVATION
BM# 1	"I" CUT SET ON THE NORTHWEST CORNER OF A Y-INLET ON THE NORTH SIDE OF SPRING VALLEY ROAD, 9' WEST OF THE SOUTHEAST CORNER OF THE SITE.	ELEV=584.57
BM# 2	"I" CUT SET ON THE SOUTHWEST CORNER OF THE CONCRETE BASE OF A LIGHT STANDARD, 236" SOUTH OF THE NORTH PROPERTY LINE AND 40" WEST OF THE EAST PROPERTY LINE.	ELEV=585.61
BM# 3	"I" CUT SET ON THE NORTH CURB OF SIDNEY DRIVE, NEAR THE NORTHWEST CORNER OF THE INTERSECTION OF SIDNEY DRIVE AND WOODWAY DRIVE.	ELEV=598.84
BM# 4	"I" CUT SET ON AN INLET BOX ON THE SOUTH SIDE OF SPRING VALLEY ROAD, 220" EAST OF WOODWAY DRIVE.	ELEV=582.06
		ELEV=583.14

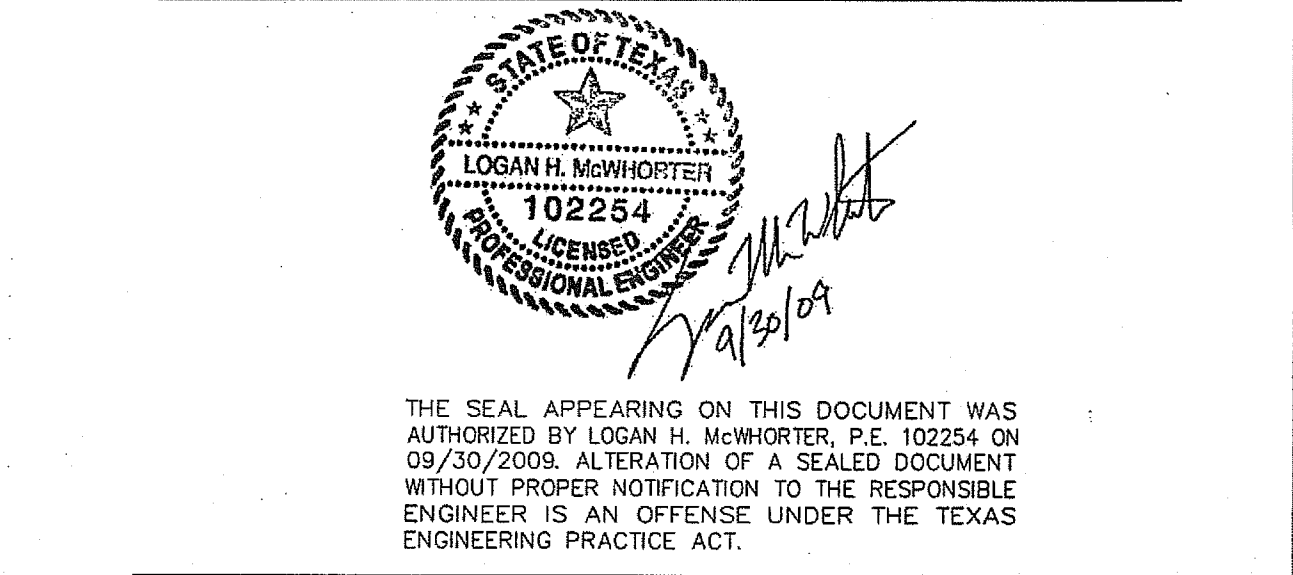

NO.	DATE	REVISION

**Pacheco Koch Consulting Engineers**  
 8350 N. CENTRAL EXPWY., SUITE 1000 DALLAS, TX. 75206 972.236.3031

**GRADING AND DRAINAGE PLAN**  
**ALFRED J. LOOS SWIMMING POOL**  
**MECHANICAL YARD ADDITION**  
**3815 SPRING VALLEY ROAD**  
**TOWN OF ADDISON, DALLAS COUNTY, TEXAS**

DESIGN	DRAWN	DATE	SCALE	NOTES	FILE	NO.
LHM/JEM	JHB	AUG 2009	1"=20'			<b>C1.1</b>

PIPE DIAMETER (INCHES)	TRENCH WIDTH (FEET)
15	3.0
18	3.4
21	3.8
24	4.1
27	4.5
33	5.2
36	5.6
42	6.3
48	7.0
54	7.8
60	8.5
66	9.2
72	10.0
78	10.7
84	11.4
90	12.1
96	12.9

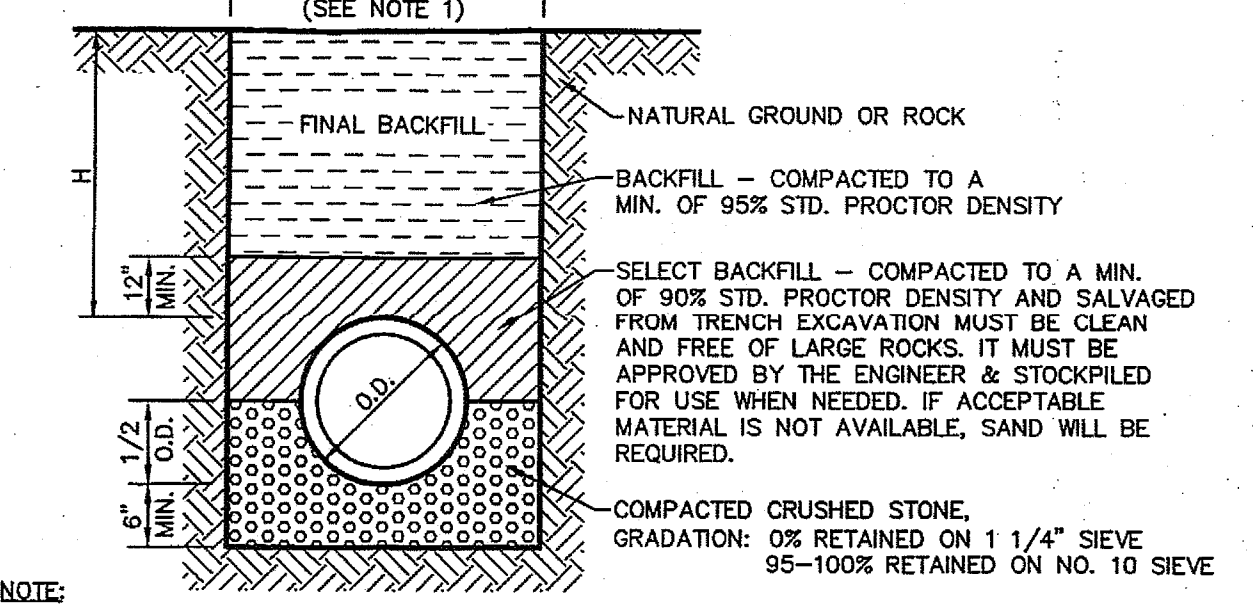

**CLASS III REINFORCED CONCRETE PIPE EMBEDMENT**  
 1 NOT TO SCALE

**SHADOWOOD APARTMENTS 2**  
 (VOL. 77112, PG. 2198)  
 CNC-SWAGAT THREE LIMITED PARTNERSHIP  
 (VOL. 2004225, PG. 5593)

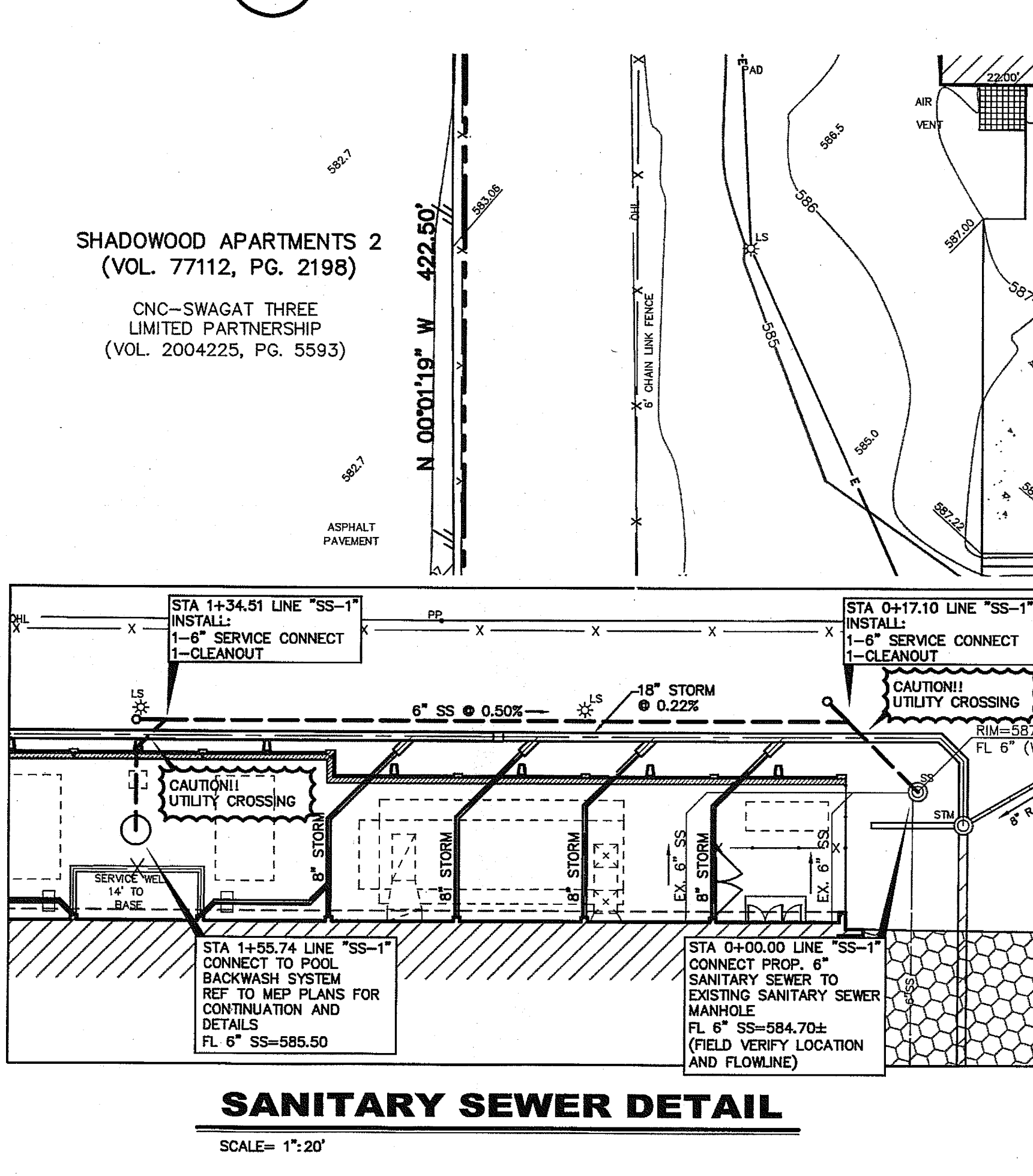

**NOTE: CONTRACTOR TO FIELD VERIFY LOCATION OF ROOF DRAINS IN AREA AND COORDINATE RELOCATION WITH MEP AND CIVIL ENGINEERS PRIOR TO CONSTRUCTION.**

**NOTE: CONTRACTOR TO FIELD VERIFY LOCATION OF EXISTING UTILITIES IN AREA AND COORDINATE RELOCATION WITH MEP AND CIVIL ENGINEERS PRIOR TO CONSTRUCTION.**

**TWO-STORY MASONRY**  
 ALFRED J. LOOS SWIMMING CENTER

**40.650 ACRES**  
 (1,770,692 SF)  
 DALLAS INDEPENDENT SCHOOL DISTRICT  
 (VOL. 124, PG. 644)  
 (FILED: SEPTEMBER 8, 1963)

REVISIONS:  
 No. Date

**ALFRED J. LOOS SWIMMING CENTER RENOVATIONS**  
**DALLAS INDEPENDENT SCHOOL DISTRICT**

KEYPLAN:

BID PACKAGE 79	ORG #849
BID PACKAGE 79	ORG #849
JOB NO:	0903
DATE:	September 30, 2009
BACKGROUND	
C1.1	