

Record Set 5/9/85
 B.M.# 3 R.R. Spike On P.P., North Spring Valley Rd.
 Sta. 35+83 65' Lt. E.
 Elev. 583.50

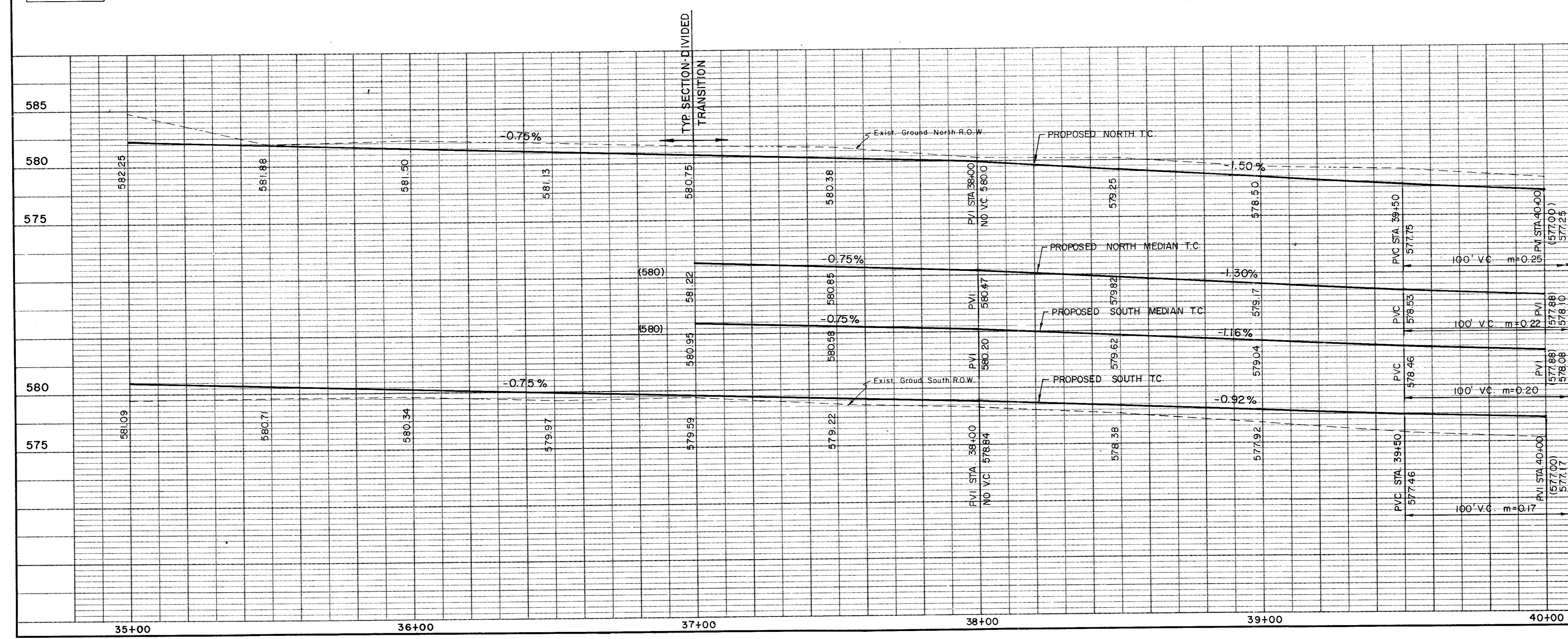

1		4" Gas Relocated		R.B.	7/1/82
NO.	REVISION	BY	DATE		
CITY OF ADDISON DALLAS COUNTY, TEXAS SPRING VALLEY ROAD Sta. 35+00 to Sta. 40+00 PAVING GINN, INC. Consulting Engineers - Dallas, Texas					
DESIGNED - G.F. H.J.	DRAWN - S.M. G.F.	DATE -	FILE - J-178		
APPROVED - H.W.G.	CHECKED - H.B.J.	SCALE - H = 1" = 20' / V = 1" = 5'	SHEET //	OF	