

Record Drawing 4/10/85  
 NOTE: ALL RADII ARE 10' R. UNLESS OTHERWISE NOTED

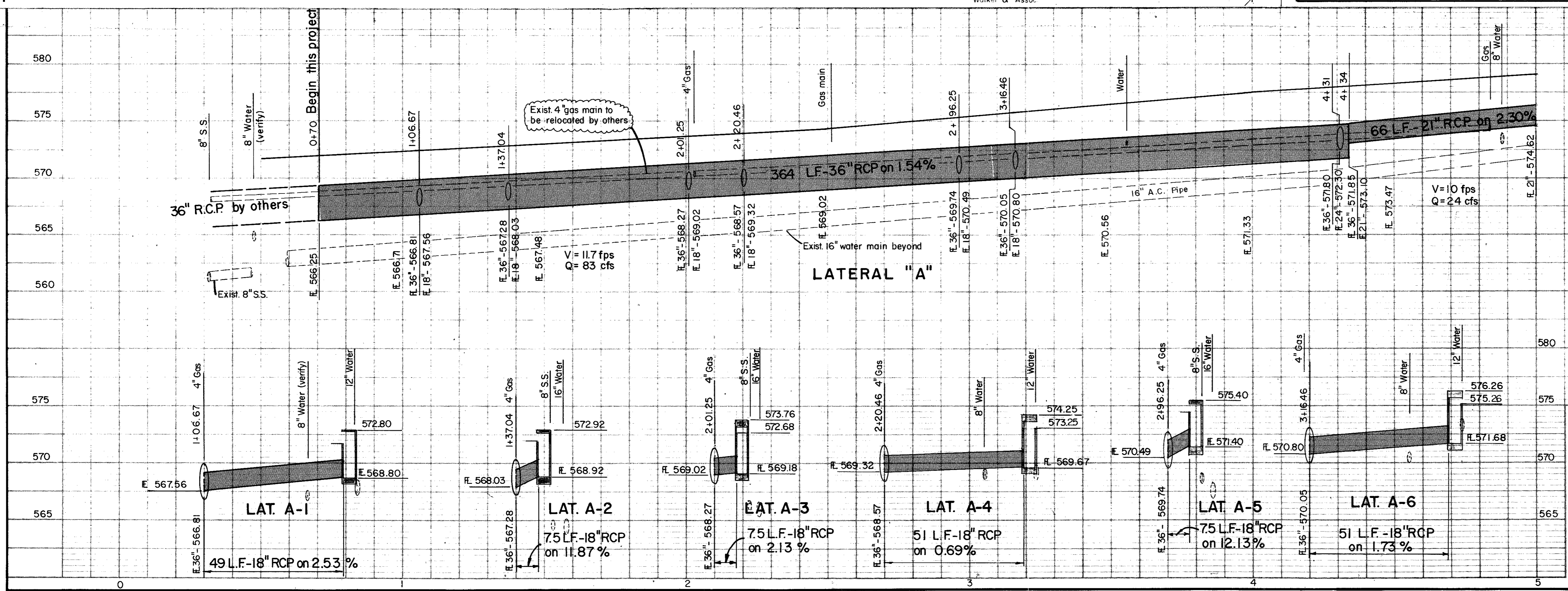

NOTE: (Typical ALL sheets)  
 CONTRACTOR SHALL EXPOSE AND VERIFY ELEVATION OF EXISTING UTILITIES PRIOR TO LOWERING OR ADJUSTMENT and SHALL NOTIFY ENGINEER, IN WRITING, OF DISCREPANCIES W/ ELEVATIONS AS INDICATED ON PLAN.

LAT. A-7  
 14 L.F. 24" RCP on 10.36%

No.	Revision	By	Date
CITY OF ADDISON DALLAS COUNTY, TEXAS <b>SPRING VALLEY ROAD</b>			
<b>DRAINAGE - STA. 0+00 to STA. 5+00</b>			
<b>GINN, INC.</b>			
Consulting Engineers Dallas, Texas			
Designed - GF	Drawn - GF	Date -	Job No. - J-178
Approved - HWG	Checked - HBJ	Scale - 1"=20'H, 1"=5'V.	Sheet 18 of