

North Dallas Assoc., Ltd.

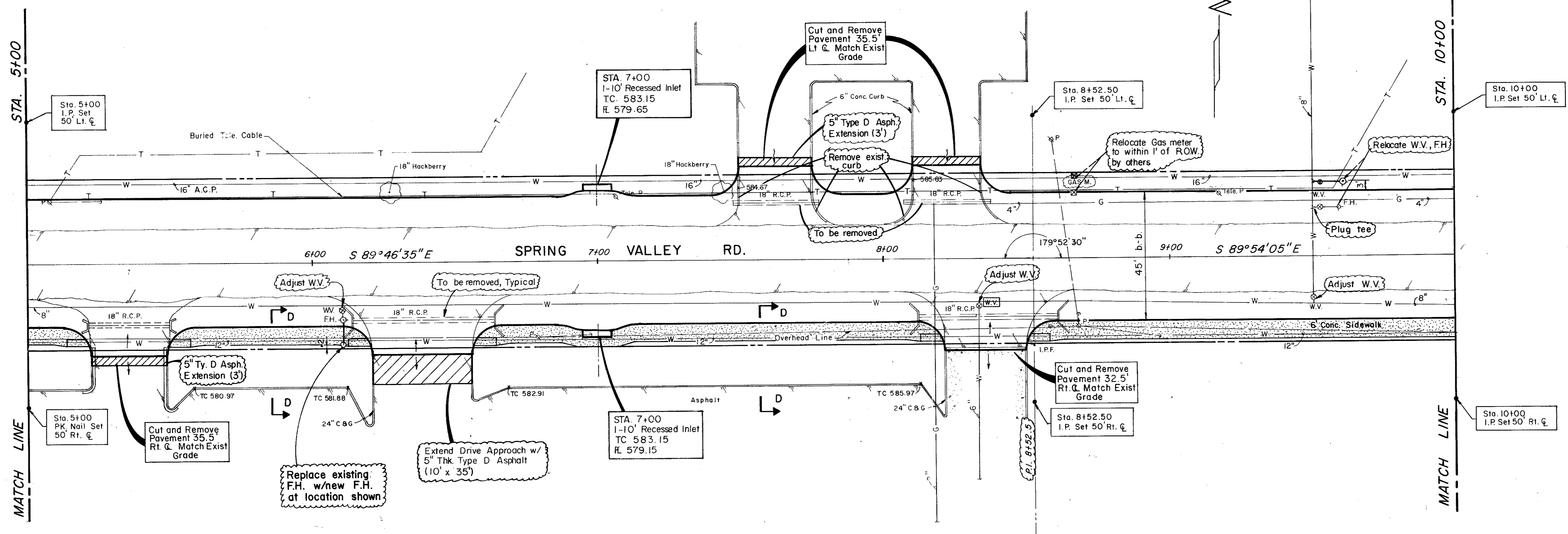

Greenhouse Village Properties, Ltd.

Elvin Levenson

FOR SECTION D-D, SEE SHT. 4

NOTE: ALL RADII ARE 10' R. UNLESS OTHERWISE NOTED

Record Set 5/9/85

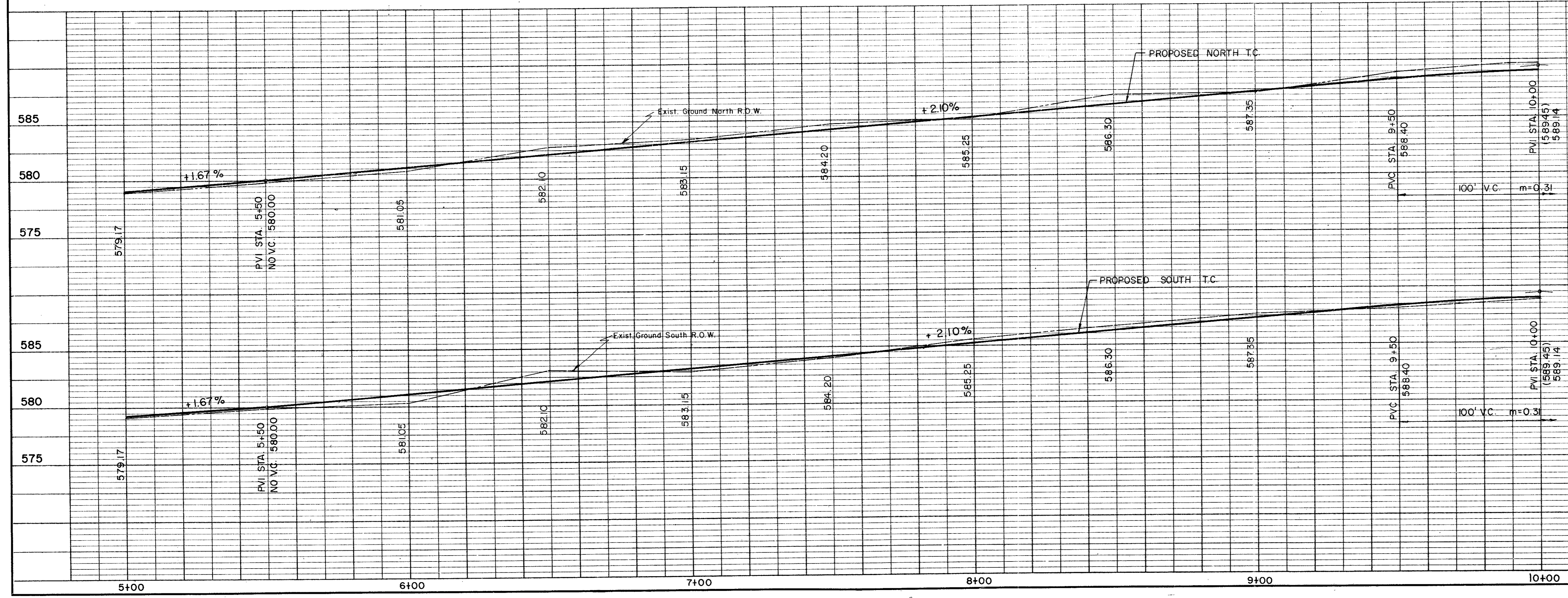

NO.	REVISION	BY	DATE
CITY OF ADDISON DALLAS COUNTY, TEXAS SPRING VALLEY ROAD Sta. 5+00 to Sta. 10+00 PAVING GINN, INC. Consulting Engineers - Dallas, Texas			
DESIGNED - H.J.F.	DRAWN - S.M./G.F.	DATE -	FILE J-178
APPROVED - H.W.G.	CHECKED - G.F.	SCALE - H=1"=20' V=1"=5'	SHEET 5 OF

Spring Valley