

INLET, See next sheet for details

NOTE: FOR DIMENSIONS AND DETAILS THIS AREA SEE SHEET 8B

Robert S. Folsom

Kelly Investments, Inc.

Record Drawing 4/10/85

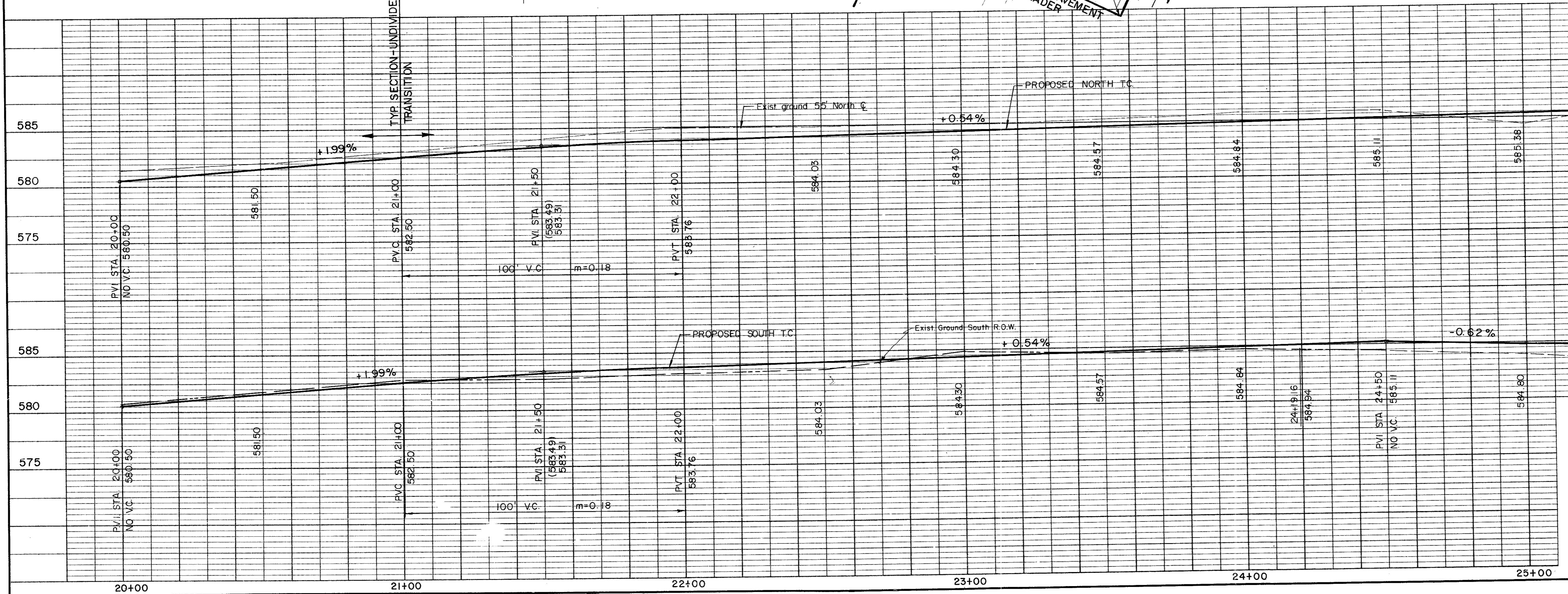

NO.	REVISION	BY	DATE
CITY OF ADDISON DALLAS COUNTY, TEXAS <b>SPRING VALLEY ROAD</b> Sta. 20+00 to Sta. 25+00 <b>PAVING</b> <b>GINN, INC.</b> Consulting Engineers - Dallas, Texas			
DESIGNED - H.J.G.F.	DRAWN - SM/G.F.	DATE -	FILE - J-178
APPROVED - H.W.G.	CHECKED - G.F.	SCALE - H=1"=20'/V=1"=5'	SHEET 8A OF