

B.M. #4 R.R. Spike On 14" Elm North Spring Valley Rd.
 Sta. 45+50, 83' Lt. ϕ
 Elev. 582.38

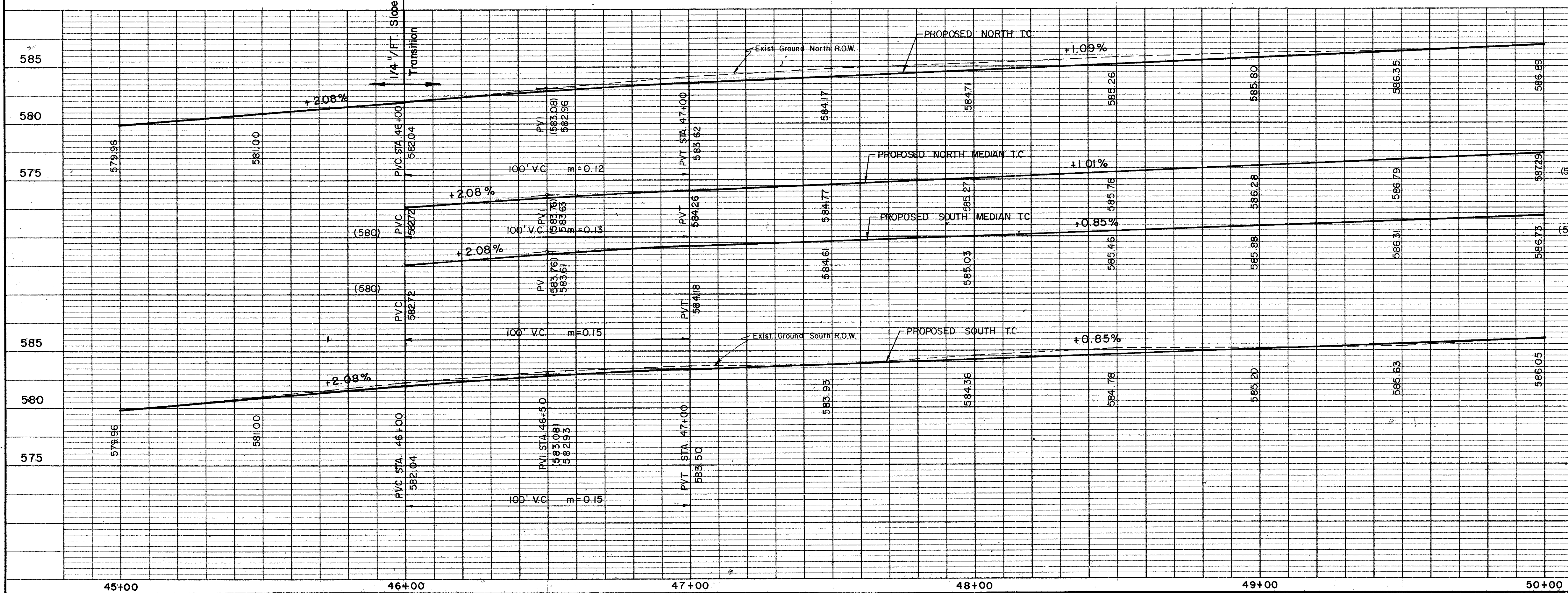

1 4" Gas Relocated

NO.	REVISION	BY	DATE
		RP	7/9/82

CITY OF ADDISON
 DALLAS COUNTY, TEXAS
SPRING VALLEY ROAD
 Sta. 45+00 to Sta. 50+00
PAVING
GINN, INC.
 Consulting Engineers Dallas, Texas

DESIGNED-GF HJ DRAWN-SM GF DATE- FILE J-178
 APPROVED-H.W.G. CHECKED-HJ SCALE-H=1"=20' V=1"=5' SHEET 13 OF