

NOTE: FOR DIMENSIONS AND DETAILS THIS AREA SEE SHEET 8B

Robert S. Folsom

Kelly Investments, Inc.

For continuation of conc. sidewalk see sht. 8B.

INLET. See next sheet for details

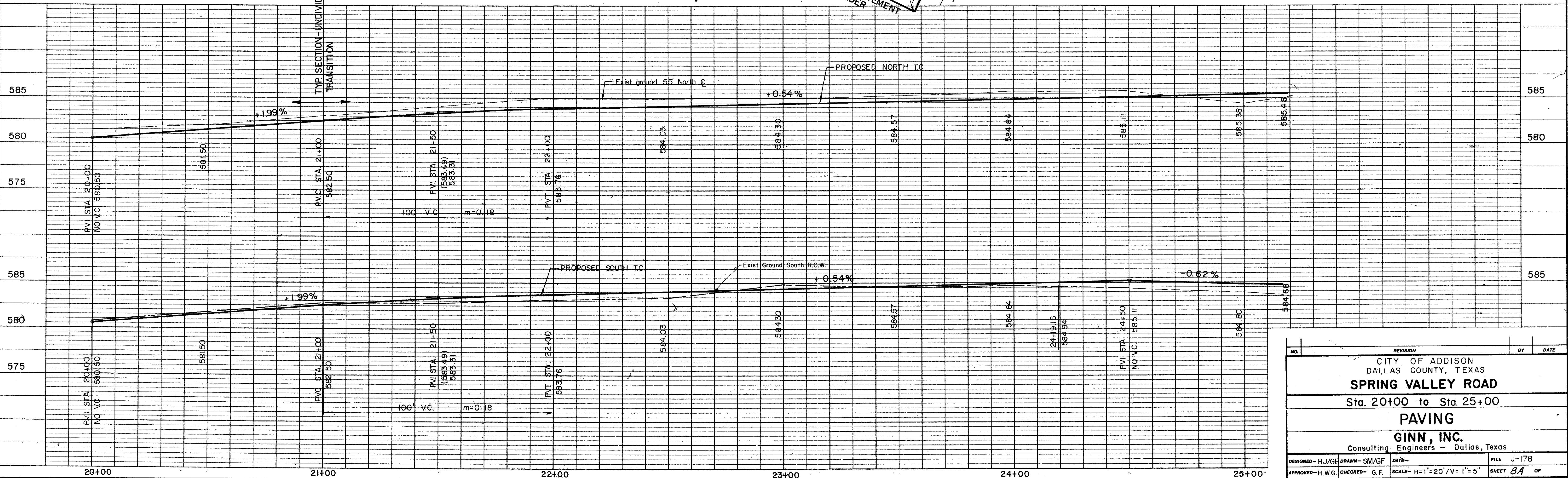

NO.	REVISION	BY	DATE
CITY OF ADDISON DALLAS COUNTY, TEXAS SPRING VALLEY ROAD Sta. 20+00 to Sta. 25+00 PAVING GINN, INC. Consulting Engineers - Dallas, Texas			
DESIGNED - H.J./G.F.	DRAWN - SM/G.F.	DATE -	FILE J-178
APPROVED - H.W.G.	CHECKED - G.F.	SCALE - H=1"=20'/V=1"=5'	SHEET 8A OF