

USER: rh2104  
OFFICE: RCH  
PROJECT: 21530  
FILE: 21530-COVER.dgn  
TIME: 5:46:52 PM  
DATE: 3/11/2010

Ready for  
paving & located  
8-16-2010

# PLANS FOR THE CONSTRUCTION OF SPRING VALLEY ROAD WIDENING FROM WOODWAY TO VITRUVIAN WAY INCLUDING PLANS FOR VITRUVIAN WAY PHASE 1

*Addison!*

PUBLIC WORKS # 2010-05  
AND  
PUBLIC WORKS # 2010-02  
AUGUST 2010

*GTAS*

- JOE CHOW  
MAYOR
- ROGER MELLOW  
NEIL RESNIK  
BLAKE CLEMENS  
DON DASEKE  
KIMBERLY LAY  
BIANCA NOBLE  
COUNCIL MEMBERS
- RON WHITEHEAD  
CITY MANAGER
- NANCY CLINE, P.E.  
DIRECTOR OF PUBLIC WORKS
- CLAY BARNETT, P.E.  
TOWN ENGINEER
- LEA DUNN  
DEPUTY CITY MANAGER

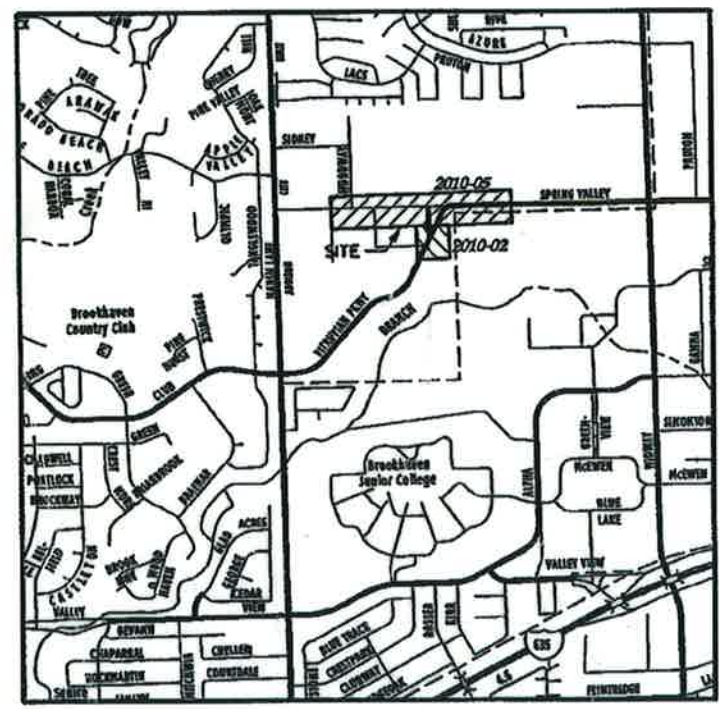

VICINITY MAP  
NOT TO SCALE

**HALFF**  
 1201 NORTH BOWSER ROAD  
 RICHARDSON, TEXAS 75081-2275  
 TEL (214) 346-8200  
 FAX (214) 739-0095

90% SUBMITTAL