

*Revised 8-11-2010
John Whitehead*

PLANS FOR THE CONSTRUCTION OF
SPRING VALLEY ROAD WIDENING
FROM WOODWAY TO VITRUVIAN WAY
INCLUDING PLANS FOR VITRUVIAN WAY PHASE 1

**ATMDS
GAS LINE
CONST.**

PUBLIC WORKS # 2010-05
AND
PUBLIC WORKS # 2010-02
AUGUST 2010

Addison!

- JOE CHOW
MAYOR
- ROGER MELLOW
- NEIL RESNIK
- BLAKE CLEMENS
- DON DASEKE
- KIMBERLY LAY
- BIANCA NOBLE
- COUNCIL MEMBERS
- RON WHITEHEAD
CITY MANAGER
- NANCY CLINE, P.E.
DIRECTOR OF PUBLIC WORKS
- CLAY BARNETT, P.E.
TOWN ENGINEER
- LEA DUNN
DEPUTY CITY MANAGER

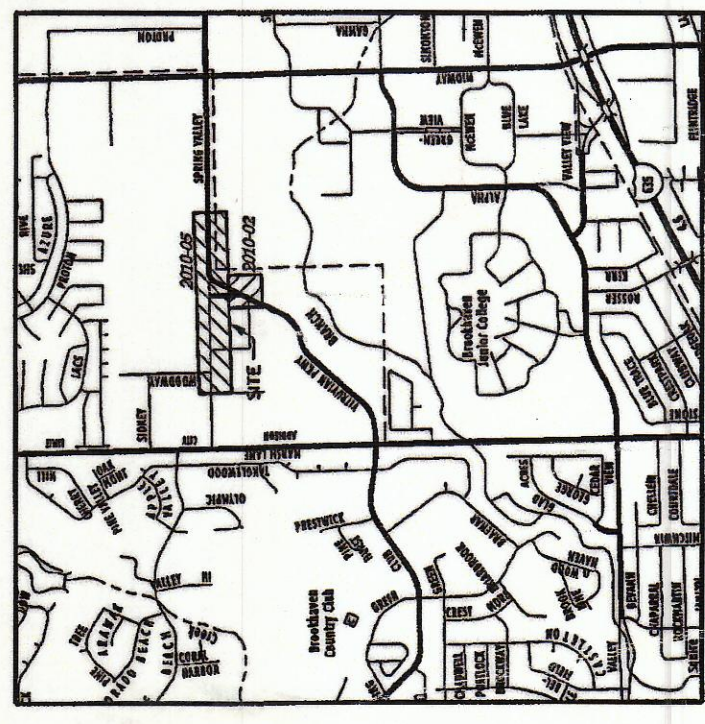

VICINITY MAP
NOT TO SCALE

HALFF
1201 NORTH BOWSER ROAD
RICHARDSON, TEXAS 75081-2275
TEL (214) 346-6200
FAX (214) 739-0095

90% SUBMITTAL

1/16/11 JPD