

# AS-BUILT

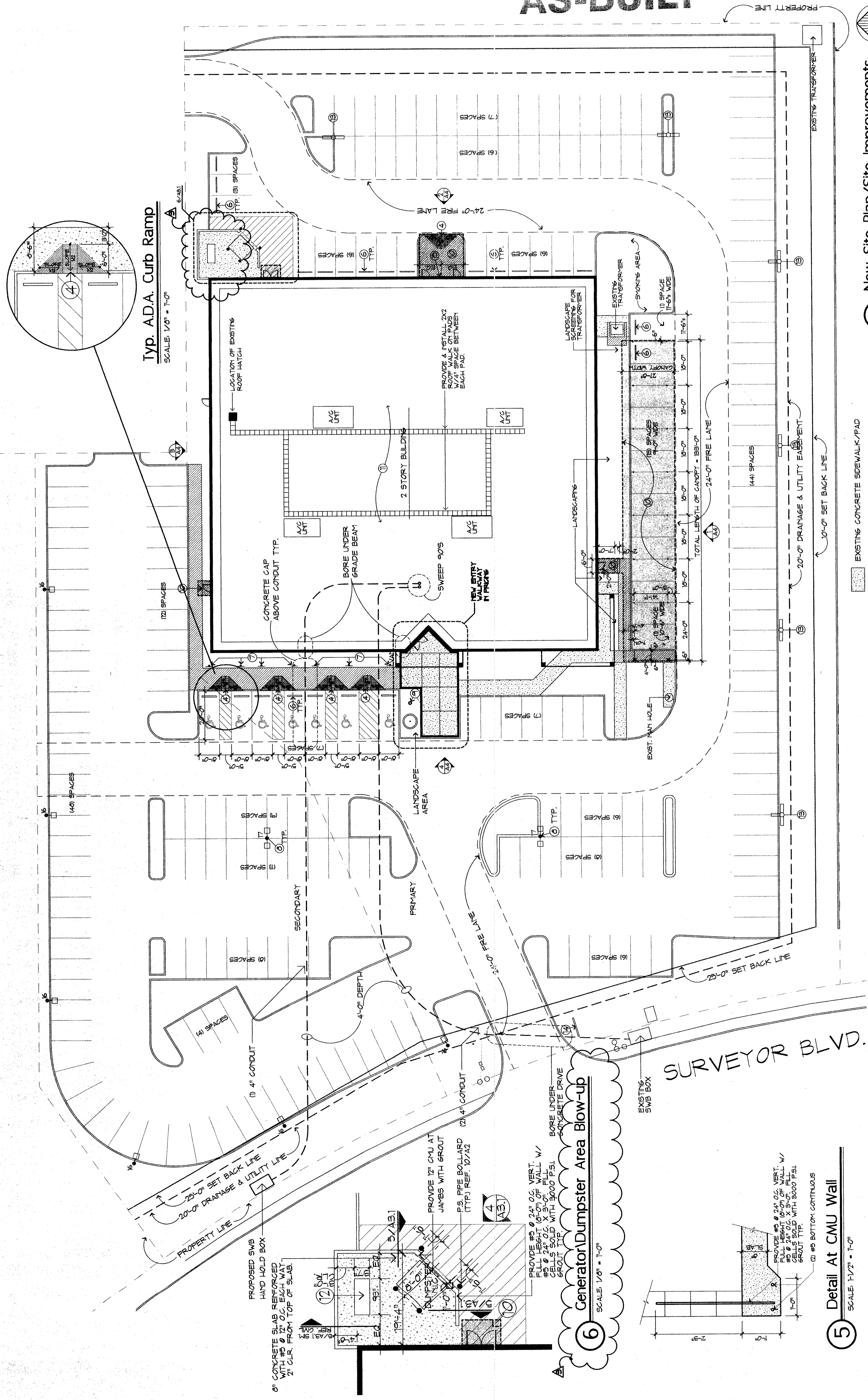

**1 New Site Plan/ Site Improvements**  
 SCALE: 1/8" = 1'-0"  
 PLAN NORTH  
 NOTE: ALL PARKING SPACES ARE 8'-6" X 17'-0" UNO.  
 STANDARD PARKING SPACES = 226  
 HANDICAP PARKING SPACES = 7  
 TOTAL PARKING SPACES = 733

REVISIONS	DATE	DESCRIPTION
0	12/11/97	REFERENCE DETAIL 7 ON SHEET A2 FOR NEW POLE BASE DETAIL.
9	2/16/98	PROVIDE & INSTALL 8" FLAG POLE. REFERENCE DETAIL 8 A2 FOR NEW FLAG POLE DETAIL.
10	3/18/98 (3/24/98)	NEW COVERED CANOPY, REFERENCE EXTERIOR GENERAL NOTE NO. 9 ON SHEET A4.
11	4/1/98	PROVIDE PATCHING AND REPAIRING OF EXISTING ROOFING AS REQUIRED ALONG THE PERIMETER OF THE BUILDING.
12		INSTALL NEW GENERATOR FOR BUILDING LOCATED ON CONCRETE PAD AS REQUIRED. PROVIDE NEW CONCRETE PAD WITH 300' DOOR AT THE SIDE. PROVIDE PROPER SERVICE CLEARANCE PER CITY REQUIREMENTS.
13		INSTALL SALVAGED LIGHT POLES AS SHOWN. PROVIDE NEW POLE BASE AS REQD. PER 7/A2. INSTALL NEW WIRING AS REQD. & REPAIR FRESH PAINT.
14		EXISTING EXTERIOR SIGNAGE TO REMAIN. FINAL DESIGN TO BE ISSUED AT A LATER DATE.
15		PROVIDE NEW BRASS AT BACK OF BUILDING. MOUNT EXTERIOR WALL MOUNT SIGN AT 60" MIN. CLEAR FROM TOP OF DRIVE SURFACE TO THE BOTTOM OF SIGN. REFERENCE 4/A3 FOR DETAIL.

EXISTING SITE PLAN/DENNO PLAN GENERAL NOTES	BY SYMBOL	THIS SHEET
1		REFERENCE SHEET AS FOR EXISTING SITE PLAN LAYOUT.
2		REFERENCE CIVIL DRAWINGS FOR INFORMATION ON NEW SITE LAYOUT, CURB CUTS, CONCRETE PAVING, ETC.
3		REFERENCE MEP DRAWINGS AND ELECTRICAL REQUIREMENTS FOR THE NEW SITE LAYOUT, LIGHT POLES, ETC.
4		NEW RAMP - PROVIDE GROOVES IN RAMP - SAWCUT 1/4" CONCRETE FIBER 1" x 1" x 1" APART WITH LIGHT BRUSHED CONCRETE FINISH.
5		MOIST EXISTING FERTIGATION PER NEW SITE LAYOUT. REF. IRRIGATION SHEET C2.
6		PROVIDE 6" LOTS CONCRETE WHEELSTOPS - DOWEL INTO NEW PAVING WITH NO. 4 REINFORCED STEEL BARS. 2" DOWEL - 1" x 1" x 1" LID WITH WHEEL STOP.
7		PROVIDE NEW ACCESSIBLE PARKING SPACES. MOUNT SALVAGED STEEL POST SET INTO 10" CONCRETE PERIS. MOUNT SIGN AT 60" MIN. CLEAR FROM THE TOP OF DRIVE SURFACE TO THE BOTTOM OF THE SIGN. REF. 2/A5 AND 3/A5 FOR DETAILS.

EXISTING CONCRETE SIDEWALK/PAD  
 NEW CONCRETE SIDEWALK/PAD

