

ACAD Rel 18.0s (LMS Tech) User: ppm File: N:\elec\EL-ADD-PL-SITE.dwg
 [ADD08459] [DINSRV2] N:\elec\EL-ADD-PL-SITE.dwg LAYOUT: EL-ADD-PL-SITE
 Jun 18, 2011 4:03pm PLS: 1 TWST: CUALLIFRESE.COM
 REFERENCES: N:\elec\Boss\JMM-STAMP.dwg N:\Standards\34BORDER.DWG N:\NIP\Boss\CV-LUTL-PL-EST-ADDISON.dwg 95784.dwg

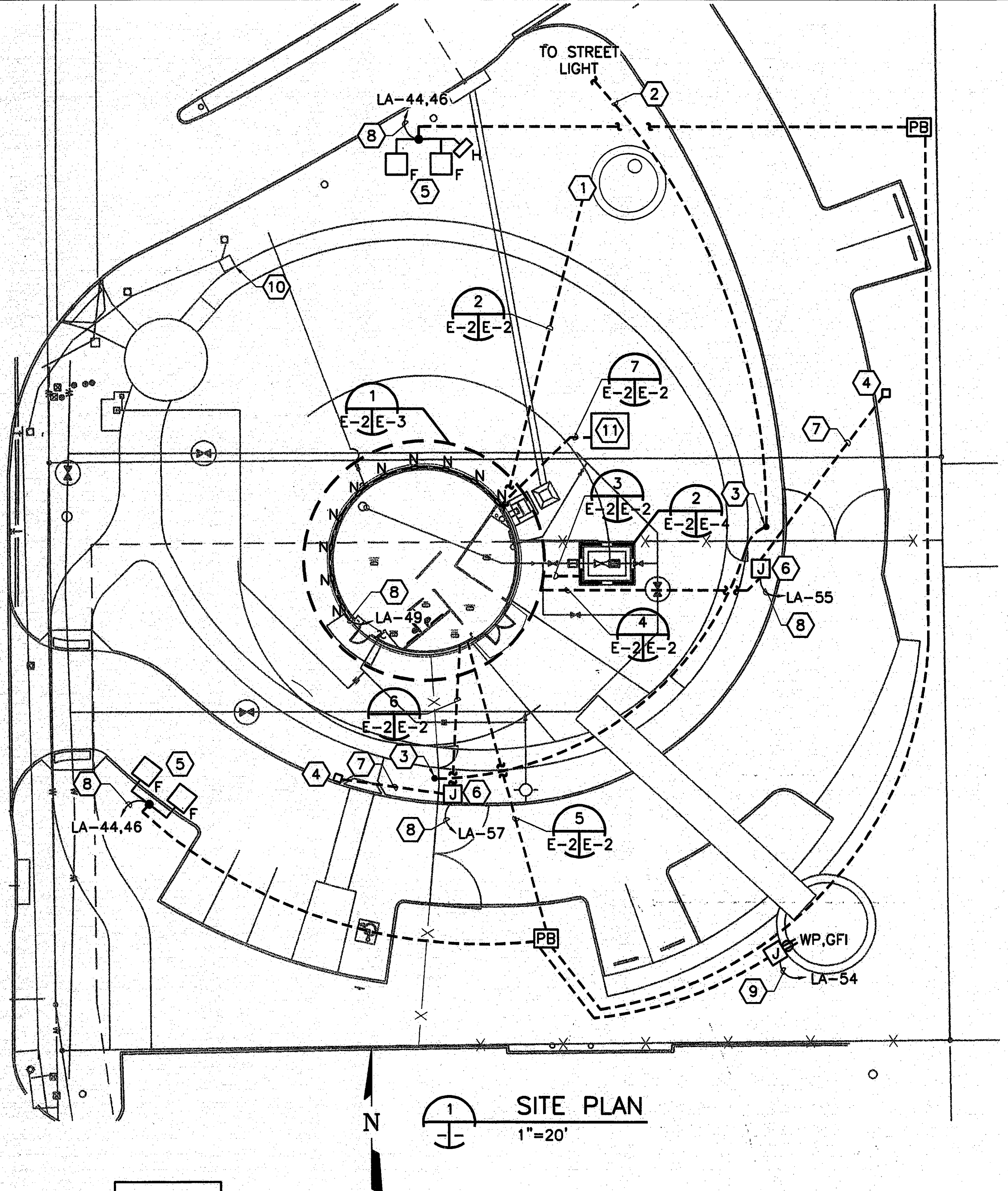

SITE PLAN
1"=20'

GENERAL NOTES:

- CONTRACTOR SHALL COORDINATE POWER WITH UTILITY COMPANY. ALL COORDINATION WITH THE UTILITY COMPANY SHALL BE ROUTED THROUGH THE TOWN OF ADDISON.
- THE DEMONSTRATION TURBINE WILL HAVE TEMPORARY POWER FROM THE UTILITY COMPANY. CONTRACTOR SHALL BE RESPONSIBLE TO PROVIDE PERMANENT POWER TO THE DEMONSTRATION UNIT.

NOTES BY SYMBOL "⬡"

- DEMONSTRATION WIND TURBINE WILL BE INSTALLED UNDER SEPARATE CONTRACT. CONTRACTOR SHALL MAKE ALL EFFORTS TO AVOID DAMAGE TO WIND TURBINE AND EQUIPMENT.
- PROVIDE 1" PVC CONDUIT TO THE NEAREST STREET LIGHT. CONTRACTOR SHALL COORDINATE WITH UTILITY COMPANY.
- CONTRACTOR SHALL INSTALL LIGHT POLES BASES AS SHOWN ON DETAIL 213-30/E-11. CONTRACTOR SHALL INSTALL LIGHT POLE PROVIDED BY THE TOWN. CONTRACTOR SHALL PROVIDE 1" PVC CONDUIT TO CONNECT WITH STREET LIGHTS ON ARAPAHO ROAD.
- PROVIDE ACCESS CONTROL SYSTEM CARD READER.
- CONTRACTOR SHALL PROVIDE SHIELDS ON LIGHT FIXTURES AND ADJUST SHIELDS TO PREVENT SHOOTING LIGHT PAST THE BOWL.
- RE: 5/E-10 FOR GATE OPERATORS AND INSTALLATION DETAILS.
- PROVIDE 1"C. FOR ACCESS CARD READER.
- PROVIDE 2 #10, #10G., 1"C.
- PROVIDE 2 #12, #12G., 1"C.
- LOCATION OF ELECTRIC VAULT THAT MIGHT POWER LIGHTS. CONTRACTOR SHALL FIELD VERIFY.
- TRANSFORMER PAD LOCATION SHALL BE COORDINATED WITH UTILITY COMPANY. CONTRACTOR SHALL COORDINATE ALL TRENCH WORK, ELBOWS, CONDUIT, CONCRETE WORK, AND INSPECTIONS REQUIRED WITH UTILITY COMPANY.

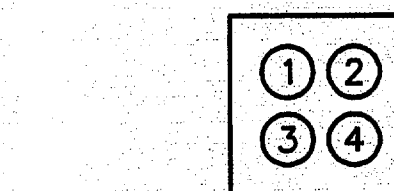
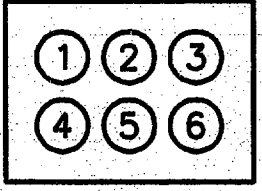

1	BRK-011C	2"C.
2	COMM-11C	2"RGS
3	INV-11P	2"RGS
4	LA-47	2"C.

1	LA-48 LA-53 LA-51	2"C.
2	PIT-01C PIT-02C	2"RGS
3	VLV-01C VLTH-01C	2"C.
4	SPARE	2"C.
5	SPARE	2"C.
6	SPARE	2"C.

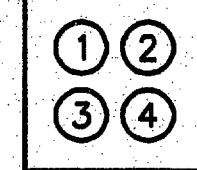

1	LA-55	2"C.
2	SPARE	2"C.
3	SPARE	2"C.
4	SPARE	2"C.

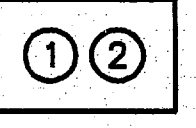

1	LA-44,46 LA-54	2"C.
2	SPARE	2"C.

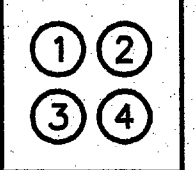

1	LA-57	2"C.
2	SPARE	2"C.
3	SPARE	2"C.
4	SPARE	2"C.

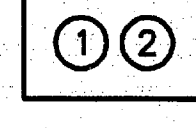

1	UTIL-01P	3"C.
2	UTIL-01P	3"C.

DUCT BANK DETAIL
NOT TO SCALE

DUCT BANK DETAIL
NOT TO SCALE

DUCT BANK DETAIL
NOT TO SCALE

DUCT BANK DETAIL
NOT TO SCALE

DUCT BANK DETAIL
NOT TO SCALE

DUCT BANK DETAIL
NOT TO SCALE

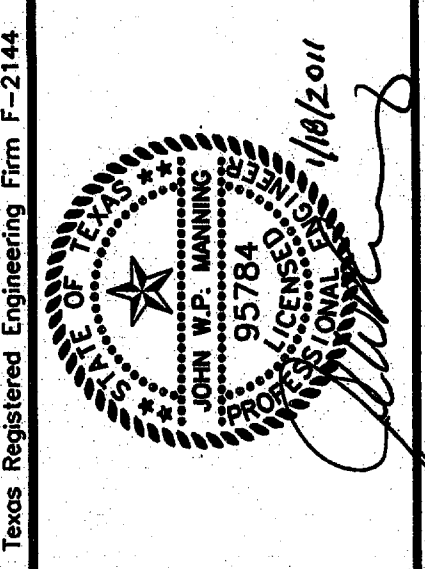
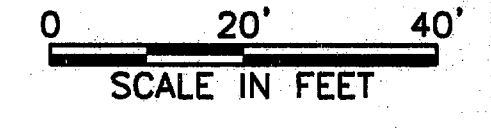

FREESE & NICHOLS
2220 San Jacinto Blvd., Suite 330
Denton, Texas 76205-7589
Phone - (940) 387-4600
Fax - (940) 387-4677

TOWN OF ADDISON, TEXAS
SURVEYOR 1.5 MG EST
ELECTRICAL
SITE PLAN

NO. ISSUE	BY	DATE	FOR JOB NO.
			ADD08459
		DATE 01/18/11	DESIGNED JMM
		DRAWN JAF	CHECKED JNH
		FILE NAME	EL-ADD-PL-SITE.dwg

Bar is one inch on original drawing. If not one inch on this sheet, adjust scale.

SHEET **E-2**
SEQ.