

WATER VALVE
RIM=596.58
T/N=593.95

SURVEYOR BOULEVARD

ARAPAHO ROAD

SURVEYOR BOULEVARD

WATER VALVE
RIM=595.78
T/N=591.34

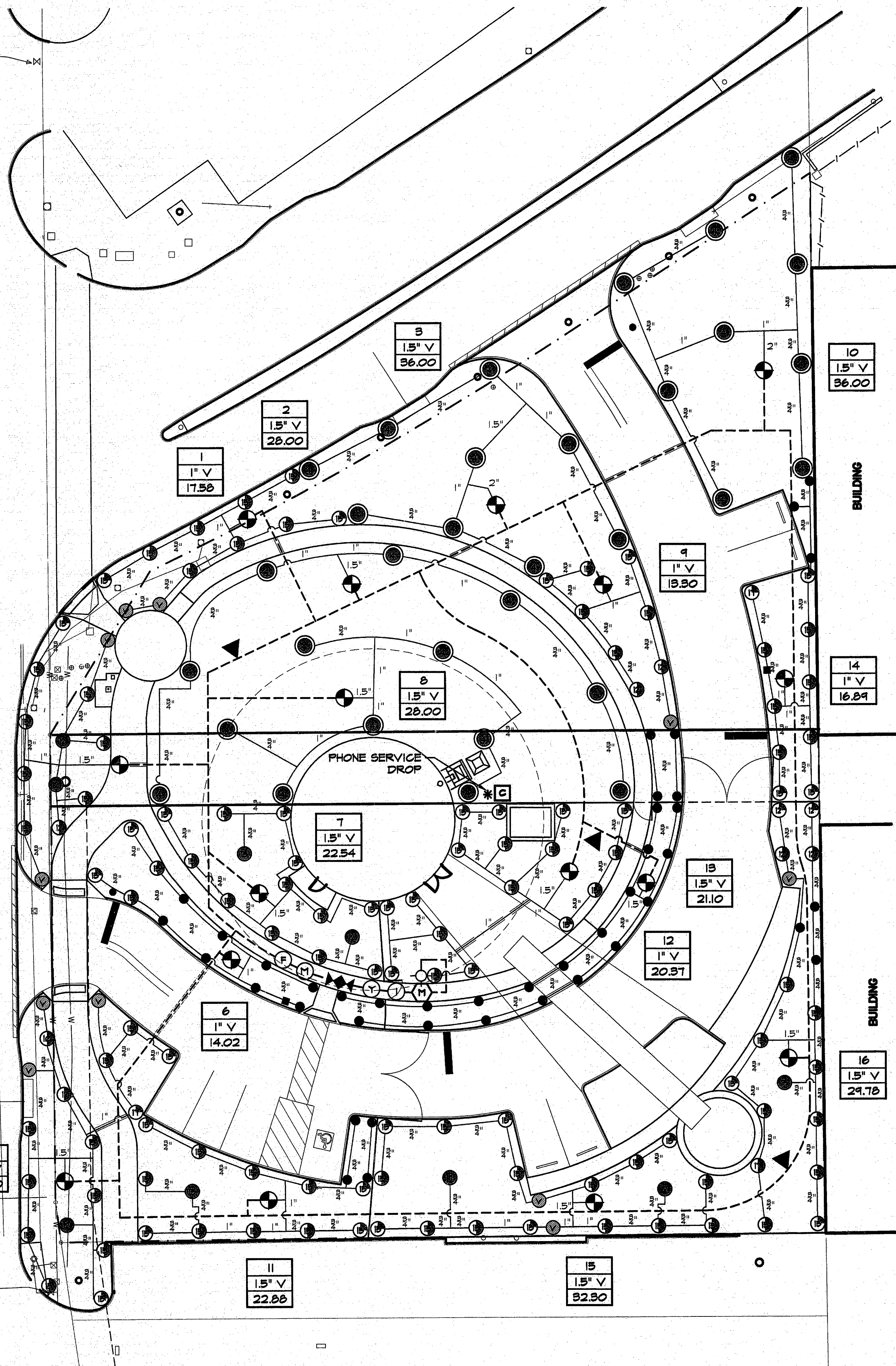

NOTES:

- 001 VALVES & PIPING SHOWN IN PAVING FOR CLARITY ONLY. INSTALL IN ADJACENT LANDSCAPE AREA.
- 002 ALL LATERAL LINES ARE 3/4" CLASS 200 PVC UNLESS OTHERWISE NOTED ON PLAN.
- 003 SLEEVES INTENDED FOR THE 2" MAIN LINE ARE TO BE TWO-FOUR INCH SLEEVES SIDE BY SIDE, AND ARE TO BE NO MORE THAN A DEPTH OF TWO FEET BELOW GRADE.

NOTES CONT'D:

- 004 SLEEVE INTENDED FOR LATERAL LINES ARE TO BE ONE FOUR INCH SLEEVE AND ARE TO BE NO MORE THAN A DEPTH OF TWO FEET BELOW GRADE.
- 005 THE GENERAL CONTRACTOR TO BE LIABLE FOR IRRIGATION SLEEVES.
- * 48 HOURS BEFORE IRRIGATION CONSTRUCTION BEGINS, INSTALLERS MUST CALL (800) DIG-TESS.

IRRIGATION LEGEND AND SCHEDULE

SYM	DESCRIPTION	MANUFACTURER	MODEL	SIZE / NOZZLE	NOTES
[C]	AUTOMATIC CONTROLLER	IRRITROL	RAIN-MASTER	N/A	FEDERAL MOUNT, STAINLESS STEEL. INSTALL PER MANUFACTURER'S STANDARDS. IN ADDITION, INSTALL WIRELESS RAIN FREEZE SENSOR AND FLOW SENSOR.
[R]	REMOTE CONTROL VALVE	IRRITROL	200 B SERIES	Refer to Plan for Size	INSTALL PER DETAIL IN 10" ROUND BOX w/ 1/2" GRAVEL FILL.
[S]	LAWN SPRAY HEAD	RAINBIRD	MFR NOZZLES 1804 BODIES	AS SHOWN ON PLAN	INSTALL PER DETAIL w/ 30 PSI AT BASE OF HEAD
[V]	LAWN SPRAY HEAD (VAN)	RAINBIRD	MFR NOZZLES (VAN) 1804 BODIES	VARIES	INSTALL PER DETAIL w/ 30 PSI AT BASE OF HEAD
[C]	4" POP UP CORNER STRIP	RAINBIRD	15' STRIP SERIES	15'-RCS 15'-LCS	INSTALL PER DETAIL w/ 30 PSI AT BASE OF HEAD
[C]	4" POP UP SIDE STRIP	RAINBIRD	15' STRIP SERIES	15'-SST	INSTALL PER DETAIL w/ 30 PSI AT BASE OF HEAD
[R]	ROTARY SPRAY HEAD	HUNTER	1-20 ULTRA	1/4" NOZZLE	INSTALL PER DETAIL w/ 40 PSI AT BASE OF HEAD.
[M]	WATER METER	----	PER CITY	1.5"	INSTALLED BY GENERAL CONTRACTOR
[D]	DOUBLE CHECK VALVE	Febco	850-BV Series	1.5"	FURNISH AND INSTALL PER LOCAL CODE BY LICENSED IRRIGATION CONTRACTOR
[I]	ISOLATION VALVE	LASCO/SPEARS	1T-113	1.5"	INSTALL PER DETAIL IN STANDARD RECTANGLE BOX w/ 1/2" GRAVEL FILL.
[Y]	WYE STRAINER	Febco	650	1.5"	INSTALL PER DETAIL IN STANDARD RECTANGLE BOX w/ 1/2" GRAVEL FILL.
[M]	MASTER VALVE	IRRITROL	200 B SERIES	1.5"	INSTALL PER DETAIL IN STANDARD RECTANGLE BOX w/ 1/2" GRAVEL FILL.
[F]	FLOW METER	HUNTER	FLOW-CLICK-200	2"	INSTALL PER DETAIL IN STANDARD RECTANGLE BOX w/ 1/2" GRAVEL FILL.
[S]	IRRIGATION SLEEVE	----	SCH. 40 w/ 1/2 GA. FULL WIRE IN SLEEVE	Refer to Plan for Size	DRIVEWAY SLEEVES INSTALLED BY GENERAL CONTRACTOR. SIDEWALK SLEEVES INSTALLED BY IRRIGATION CONTRACTOR.
[M]	IRRIGATION MAIN LINE	----	SCH. 40 PVC	2"	16" INSTALLATION DEPTH
[L]	IRRIGATION LATERAL LINE	----	CLASS 200	Refer to Plan for Size	12" INSTALLATION DEPTH
[Q]	QUICK-COUPLER VALVE	CHAMPION	GVC-100VL	1"	INSTALL PER DETAIL IN 10" INCH DIAMETER VALVE BOX. ROUT AND PAINT "GVC" ON LID.
[K]	QUICK-COUPLER KEY	CHAMPION	CK-100	1"	FURNISH THREE (3) TO OWNER
[H]	HOSE SWIVEL	CHAMPION	GCS-2	1"	FURNISH THREE (3) TO OWNER

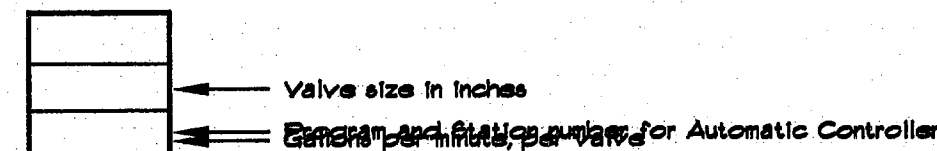

HYDRAULIC CALCULATION NOTES:

Ten days prior to commencing work, verify static pressure. If static pressure is less than 60 psi do not start work until notified in writing to proceed by Owner. If Contractor proceeds with work without authorization from Owner, the Contractor shall be financially responsible to correct, modify or repair any items or materials that may be required to provide a fully functioning and operational irrigation system in compliance with the plans and specifications. Hydraulic calculations for this system are based on the static pressure as stated above. The static pressure shown is an assumed pressure, a pressure measured at the site, or an estimated pressure provided by the county of city.

HYDRAULIC CALCULATIONS FROM ZONE #10

ITEM	SIZE	PSI	NOTES
MAXIMUM GPM ESTIMATED - 3130 GPM			FITTING LOSS ACCOUNTED BY ADDING 10% TO FLOW SHOWN IN MANIF. NOZZLE CHART.
SERVICE	2"	0.34	TYPE "K" COPPER 20 LN. FT. (36.00 GPM)
WATER METER	1.5"	2.10	(36.00 GPM)
BALL VALVE	1.5"	1.00	(36.00 GPM)
WYE FILTER	1.5"	0.30	(36.00 GPM)
BACKFLOW PREVENTER	1.5"	4.00	(36.00 GPM)
MASTER VALVE	1.5"	1.10	(36.00 GPM)
MAIN LINE	2"	2.05	55 LN. FT. 36.00 GPM
STATION VALVE (10)	1.5"	1.10	36.00 GPM
ZONE		2.15	36.00 GPM
CRITICAL HEAD 'A'		40.00	
TOTAL LOSS		56.14	
ASSUMED STATIC PRESSURE		65.00	
PRESSURE DIFFERENTIAL		-8.26	

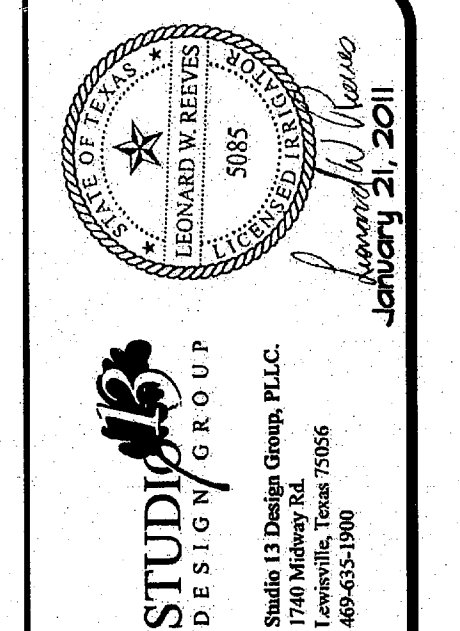
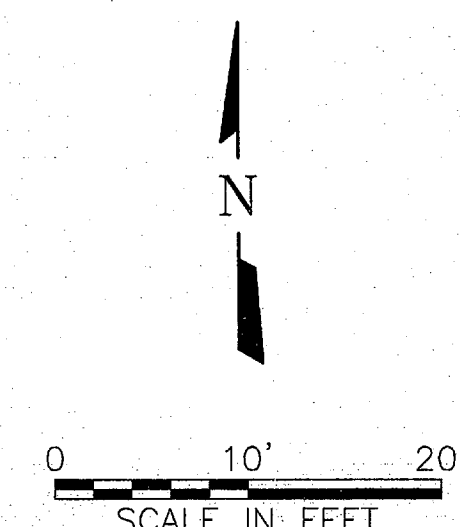

FREESE & NICHOLS
DESIGN GROUP
Studio 13 Design Group, P.L.L.C.
1740 Midway Rd.
Denton, Texas 76205-7858
Phone: (817) 387-4500
Fax: (817) 387-4077

TOWN OF ADDISON, TEXAS
SURVEYOR 1.5 MG EST.

IRRIGATION PLAN

NO.	ISSUE	REVISION PER TOWN OF ADDISON COMMENTS	DATE	BY	DATE	DESIGNED	DRAWN	CHECKED	FILE NAME
1	1		1-10-11	CU	01/21/11	LWR	LWR	LWR	FNI002-IR.dwg

Bar is one inch on original drawing. If not one inch on this sheet, adjust scale.

VERIFY SCALE

IR-1