



Signing Date: 02-28-01

dietz engineering
 811 e. plano parkway
 suite 109
 plano, texas 75074
 voice: 972 633-8867
 fax: 972 633-1327

Drawn By: LL
 Checked By: RDD

Revisions:
 No. Date Description

TRINITY CHRISTIAN ACADEMY
 EXISTING SITE DEMOLITION
 PLAN VIEW
 for the
 City of Addison, Texas



NORTH

24"x36" Scale: 1" = 20'

11"x17" Scale: 1" = 40'

Vertical Scale: NA

Project Number:

Issue Date: 28 FEB 2001

Sheet Title:
DEMOLITION PLAN

Sheet No.:

C1.02

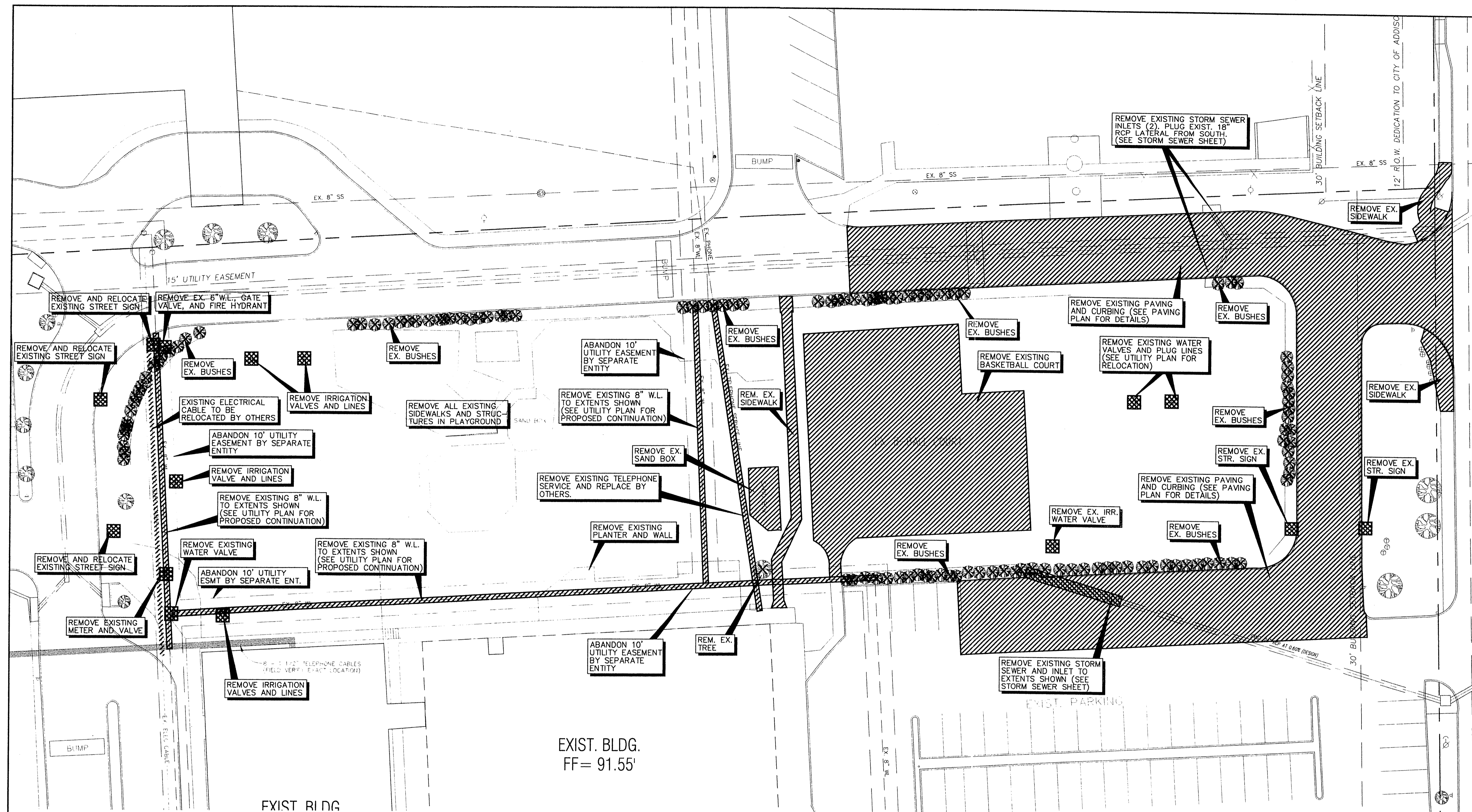

LEGEND			
+ETP600.0	EX. TOP OF PVMT.	⊕	WATER VALVE
+ETG600.0	EX. TOP OF GRND.	⊗	UTILITY BOX
+ETC600.0	EX. TOP OF CURB	⊙	WOOD BOLLARD
+600.0	FIN. FLR. SPOT ELEV.	⊙	GAS METER
TP600.0	TOP OF PAVEMENT	⊙	CURB INLET
TC600.0	TOP OF CONCRETE	⊙	GRATE INLET
TG600.0	TOP OF GROUND	⊙	FIRE HYDRANT
[600.0]	TOP OF CURB	⊙	WATER METER
-650-	PROP. GRADE LINE	⊙	STORM/SS MANHOLE
-FF-	EX. GRADE LINE	⊙	TREE
↑	FINISHED FLOOR	⊙	LIGHT POLE
⊙	GUY WIRE ANCHOR	⊙	SIGNAL POLE
⊙	POWER POLE	⊙	SIGNAL PULL BOX
⊙	STREET/CABLE SIGN		

WARNING !!!
 FIELD VERIFY EXISTING UNDERGROUND
 UTILITY LOCATIONS PRIOR TO
 CONSTRUCTION OR EXCAVATION.