

**GENERAL GRADING AND DRAINAGE NOTES**

1. ALL CONSTRUCTION TO BE IN ACCORDANCE WITH THESE PLANS AND TOWN OF ADDISON STANDARDS AND SPECIFICATIONS.
2. PRIOR TO STARTING CONSTRUCTION, THE CONTRACTOR SHALL MAKE CERTAIN THAT ALL REQUIRED PERMITS AND APPROVALS HAVE BEEN OBTAINED. NO CONSTRUCTION OR FABRICATION SHALL BEGIN UNTIL THE CONTRACTOR HAS RECEIVED AND THOROUGHLY REVIEWED ALL PLANS AND OTHER DOCUMENTS APPROVED BY ALL OF THE PERMITTING AUTHORITIES.
3. ALL WORK SHALL BE PERFORMED IN ACCORDANCE WITH THESE PLANS AND SPECIFICATIONS AND THE REQUIREMENTS AND STANDARDS OF THE LOCAL GOVERNING AUTHORITY.
4. IN THE EVENT AN ITEM IS NOT COVERED IN THE TOWN OF ADDISON SPECIFICATIONS, THE TOWN OF ADDISON ENGINEER'S DECISION SHALL APPLY.
5. BARRICADING, TRAFFIC CONTROL, AND PROJECT SIGNS SHALL CONFORM TO "STATE DEPARTMENT OF HIGHWAYS AND PUBLIC TRANSPORTATION BARRICADING AND CONSTRUCTION STANDARDS".
6. THE GENERAL CONTRACTOR AND ALL SUB-CONTRACTORS SHALL VERIFY THE SUITABILITY OF ALL EXISTING AND PROPOSED SITE CONDITIONS INCLUDING GRADES AND DIMENSIONS BEFORE COMMENCEMENT OF ANY CONSTRUCTION. IN THE EVENT OF ANY CONFLICT AND PRIOR TO COMMENCEMENT OF ANY CONSTRUCTION, IMMEDIATELY NOTIFY ENGINEER. MINOR ADJUSTMENTS OF FINISH GRADE TO ACCOMPLISH SPOT DRAINAGE ARE ACCEPTABLE. IF NECESSARY, UPON PRIOR APPROVAL OF ENGINEER, PAVING INSTALLED SHALL FLUSH OUT AT ANY JUNCTURE WITH EXISTING PAVING.
7. THE LOCATIONS OF UNDERGROUND UTILITIES SHOWN ON THIS PLAN ARE BASED ON FIELD SURVEYS AND LOCAL UTILITY COMPANY RECORDS. IT SHALL BE THE CONTRACTOR'S FULL RESPONSIBILITY TO CONTACT THE VARIOUS UTILITY COMPANIES TO LOCATE THEIR UTILITIES PRIOR TO STARTING CONSTRUCTION.
8. CONTRACTOR SHALL VERIFY ALL EXISTING INVERTS AND RIM ELEVATIONS PRIOR TO CONSTRUCTION.
9. ALL PROPOSED CONTOURS ARE APPROXIMATE. PROPOSED SPOT ELEVATIONS AND DESIGNATED GRADIENT ARE TO BE USED IN THE EVENT OF ANY DISCREPANCIES.
10. IT IS THE CONTRACTOR'S RESPONSIBILITY TO LOCATE AND/OR ESTABLISH A BENCHMARK (BASE UPON EXISTING CONDITION SHOWN ON THIS PLAN) PRIOR TO CONSTRUCTION.

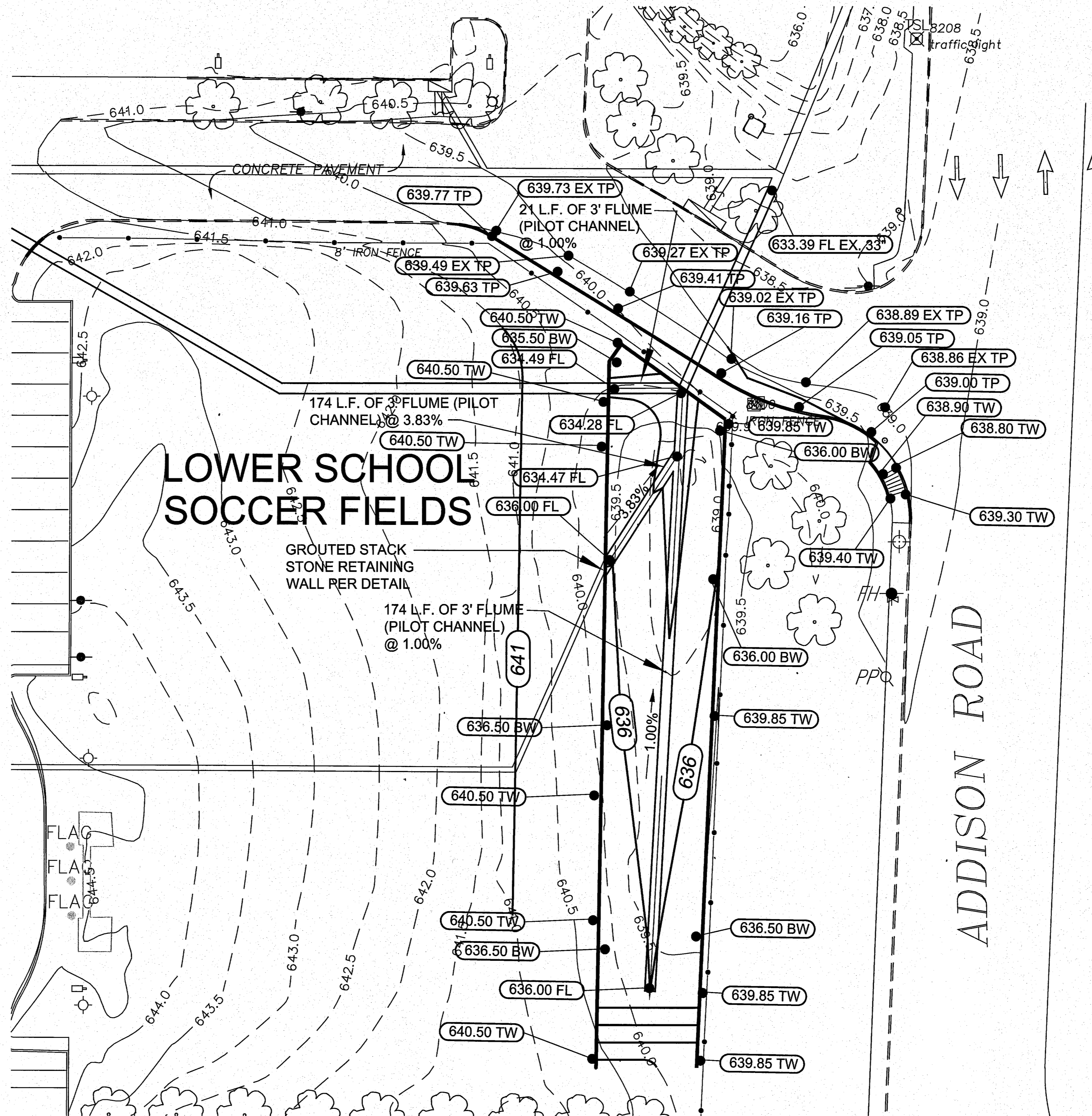

NOTE: SLOPE PROPOSED TURN LANE 2% TOWARDS EXISTING PAVEMENT AS INDICATED BY SPOT ELEVATIONS.

**BENCHMARK:**  
TOWN OF ADDISON BENCHMARK 6, BRASS DISC SETON TOP OF EXISTING INLET, LOCATED ON THE EAST SIDE OF ADDISON ROAD, DIRECTLY EAST OF THE LOWER SCHOOL PLAYGROUNDS.  
ELEV. = 639.88'

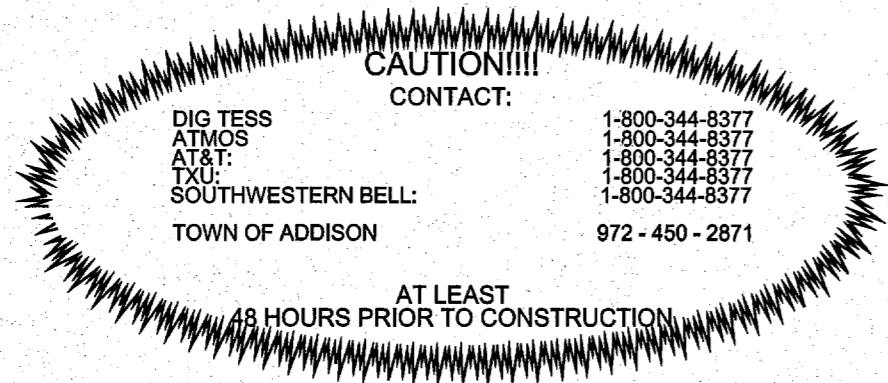

**GLENN ENGINEERING**



FAX 972-717-2176  
IRVING, TEXAS 75062

PHONE 972-717-9151  
105 DECKER COURT-SUITE 910

T.P.E. FIRM  
#FF-303

TRINITY CHRISTIAN ACADEMY  
DRAINAGE & DRIVE  
IMPROVEMENTS NEAR  
THE UPPER SCHOOL

**GRADING  
PLAN**

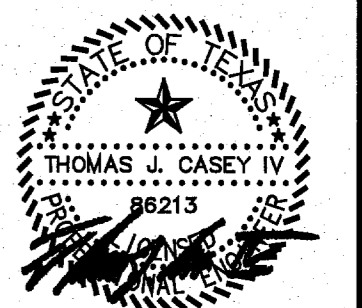

THE SEAL APPEARING ON THIS DOCUMENT WAS AUTHORIZED BY THOMAS J. CASSEY IV, P.E. 88215, ON JULY 8, 2010.

Issue Dates:  
Review: June 23, 2010  
Comments: June 30, 2010  
Comments: July 2, 2010  
Comments: July 8, 2010

Construction:  
Scale: AS NOTED  
Drawn By: TJC  
Checked By: CMA  
Project No.: 10 - 599.150

Sheet 4  
of 15