

EXISTING CONDITIONS

Scale: 1" = 20'
 Verify Exist. Conditions
 Prior To Beginning
 Construction.

SECTION Y-Y
 No Scale

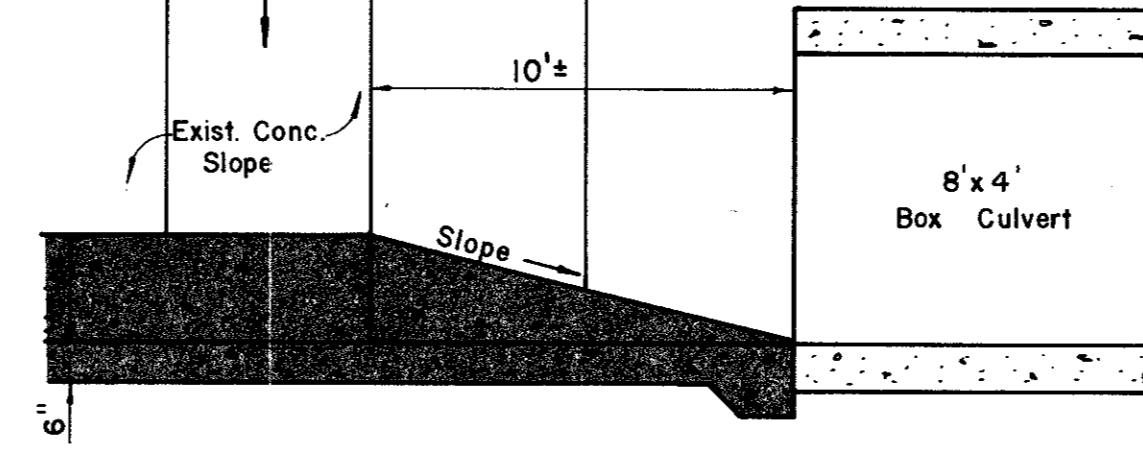

**SECTION X-X
 DETAIL AT BOX CULVERT**
 Scale: 3/8" = 1'

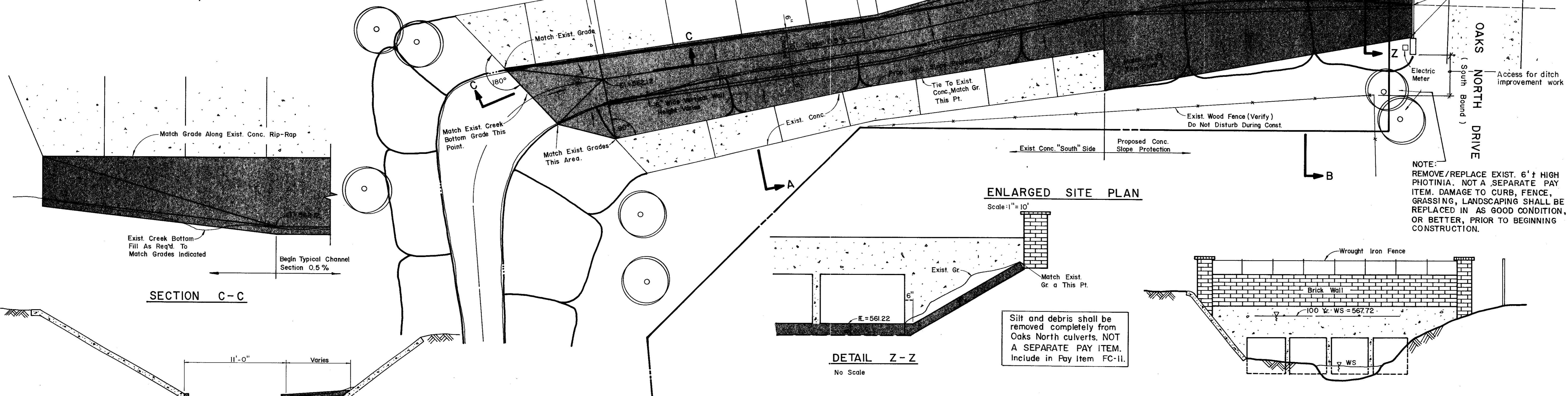
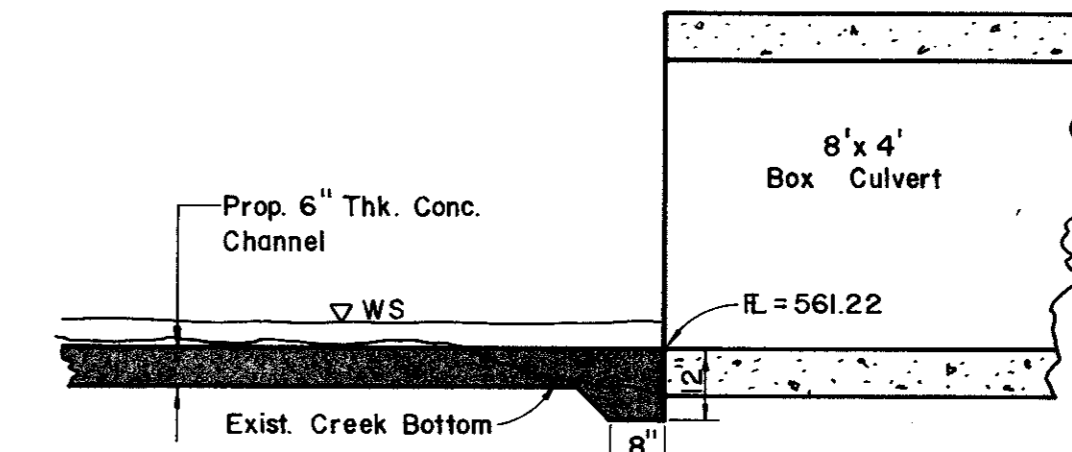

ENLARGED SITE PLAN

Scale: 1" = 10'

NOTE:
 REMOVE/REPLACE EXIST. 6'± HIGH
 PHOTINIA. NOT A SEPARATE PAY
 ITEM. DAMAGE TO CURB, FENCE,
 GRASSING, LANDSCAPING SHALL BE
 REPLACED IN AS GOOD CONDITION,
 OR BETTER, PRIOR TO BEGINNING
 CONSTRUCTION.

SECTION C-C

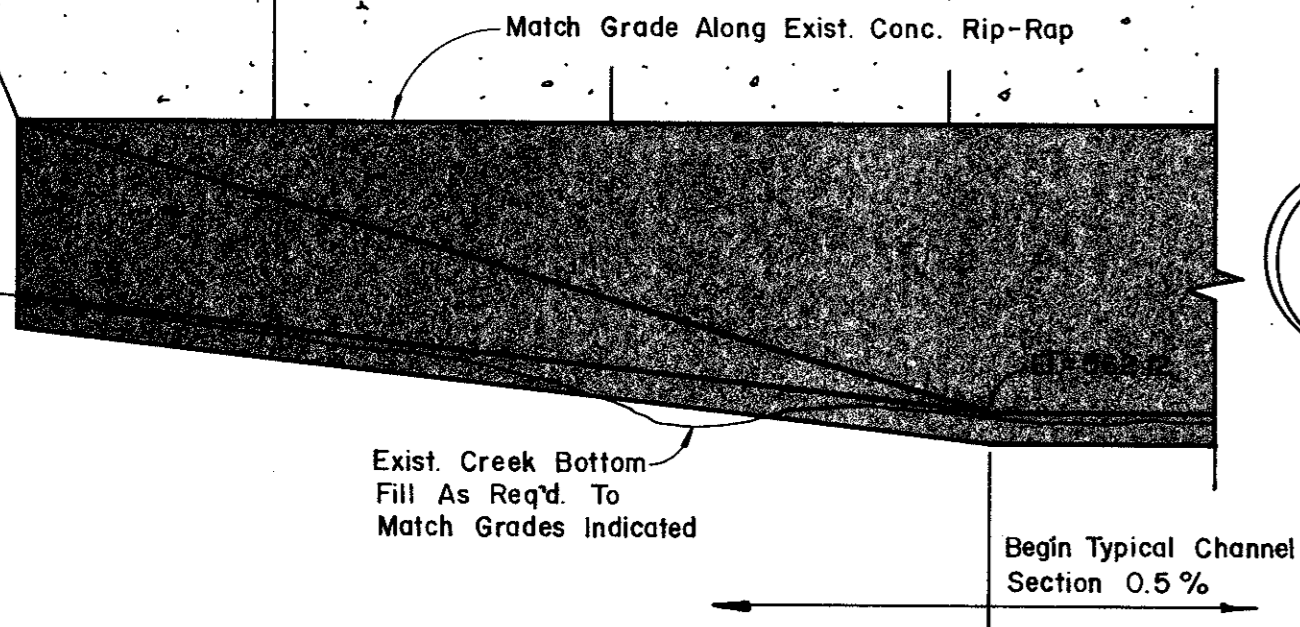

DETAIL Z-Z
 No Scale

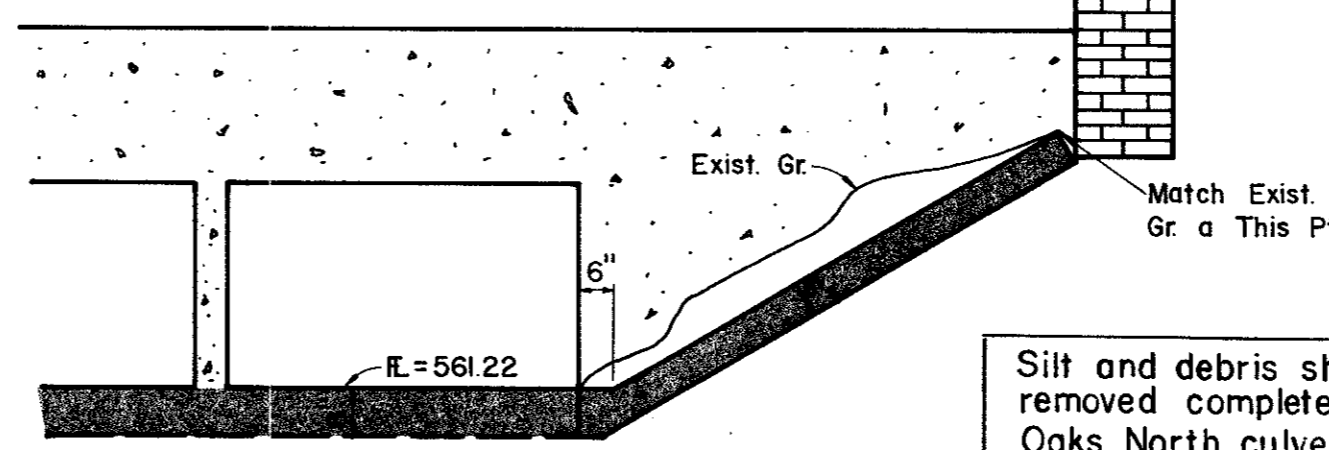

Silt and debris shall be
 removed completely from
 Oaks North culverts. NOT
 A SEPARATE PAY ITEM.
 Include in Pay Item FC-II.

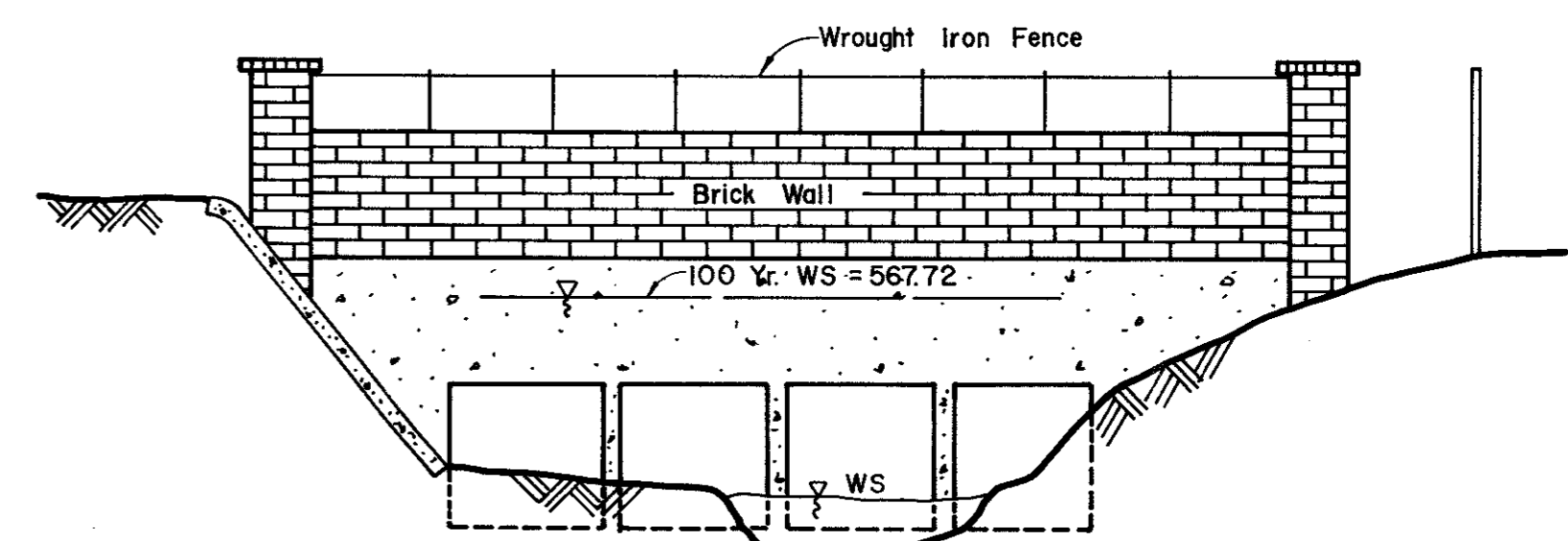

EXIST. ELEVATION @ OAKS NORTH DRIVE

(Looking East) (For Ref. Only)

No Scale

SECTION A-A

Scale: 1" = 5'

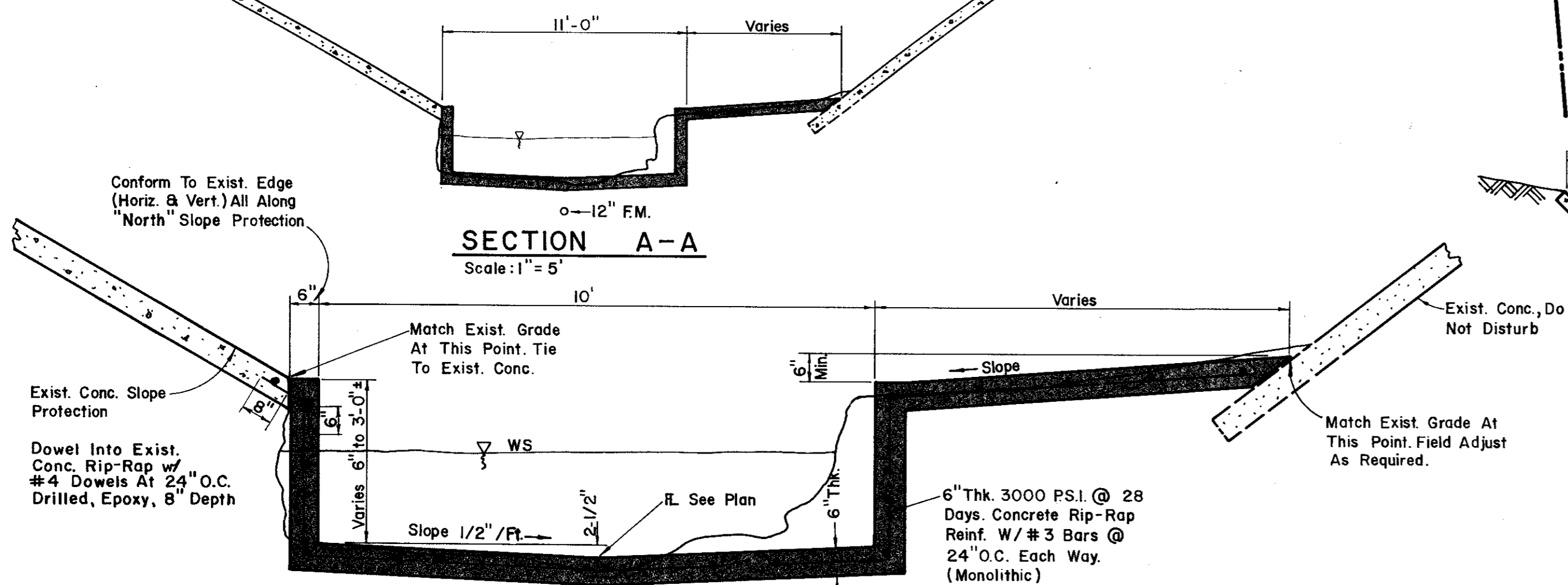

TYPICAL CHANNEL SECTION DETAIL

Scale: 1/2" = 1'-0"

SECTION B-B

No Scale

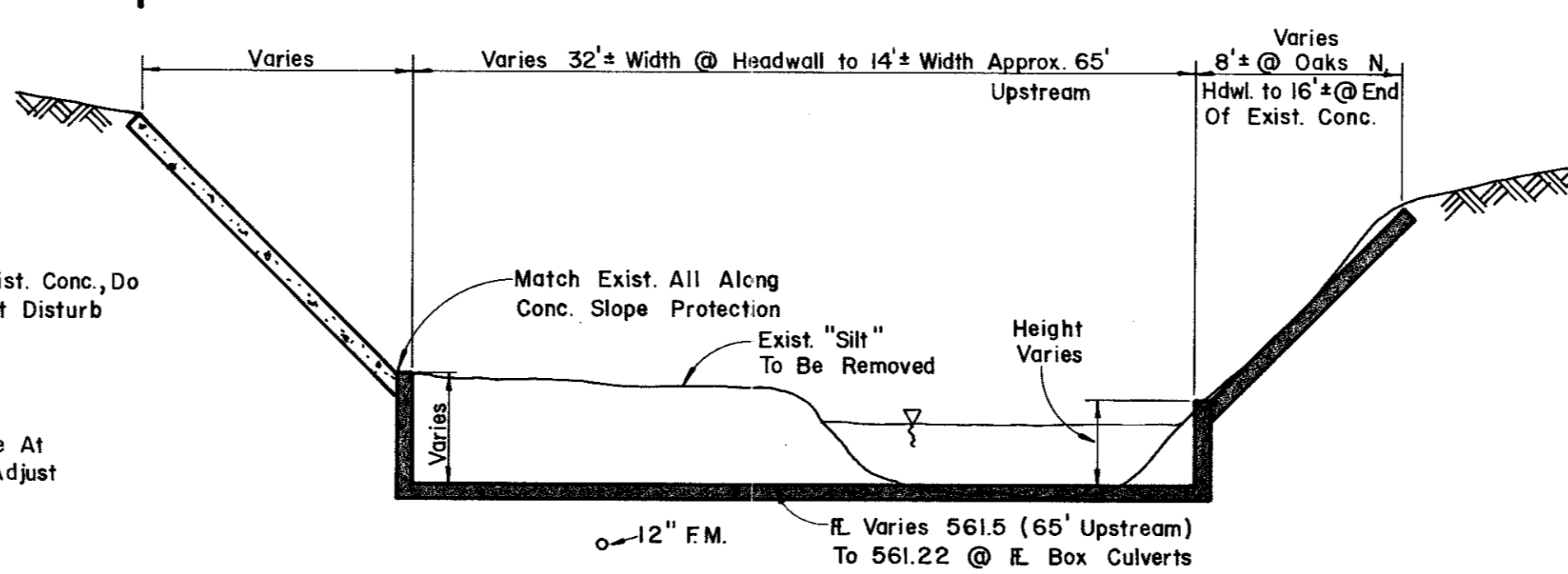

- NOTE:
1. Provide 3/4" Exp. Joints at 40' Maximum Spacing. Use Redwood Material.
 2. Provide Construction Joints Max. 10' Spacing Each Way in All Conc.

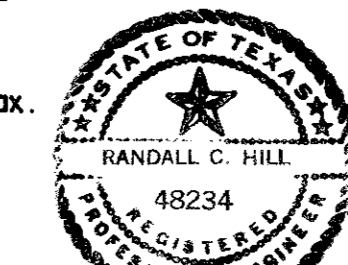

(ALT-1)

1-20-89

ADD ALTERNATE NO. 1

Revision	By	Date
TOWN OF ADDISON DALLAS COUNTY, TEXAS CREEK SYSTEM IMPROVEMENTS TOWN HALL/OAKS NORTH DRIVE DITCH IMPROVEMENTS GINN, INC. Consulting Engineers Dallas, Texas		
Designed - AGF	Drawn - CL	Date - DEC. 1988
Approved - HWG	Checked - RCH	Scale - AS NOTED
Job No. - 369		Sheet 21 of 23