

- RESTORATION:**
- 1) CONTRACTOR SHALL RESTORE ALL AREAS DISTURBED BY CONSTRUCTION. ALL COMPACTED EARTH SHALL BE TILLED TO A DEPTH OF SIX INCHES.
  - 2) THE AREA ON THE NORTH SIDE OF THE CHANNEL, THE CONTRACTOR SHALL FURNISH, PLACE AND ESTABLISH SOLID SOD. SOLID SOD SHALL BE LAID END TO END, SIDE TO SIDE AND ROLLED. SOLID SOD SHALL BE FESCUE. SOLID SOD SHALL BE PLACED TO THE TOP OF BANK.
  - 3) THE AREA FROM THE TOP OF BANK TO THE TOP OF GABIONS AND THE AREA ON THE SOUTH SIDE OF THE CHANNEL SHALL HAVE A LAYER OF JUTE PLACED AND PINNED ON 12 FOOT CENTERS (MAXIMUM). JUTE SHALL BE C-JUTE EROSION CONTROL GEOTEXTILE, AS MANUFACTURED BY CONTECH OR EQUAL.

TOWN OF ADDISON  
TOWN HALL

SCALE: 1"=10'

RUGGERI'S RESTAURANT

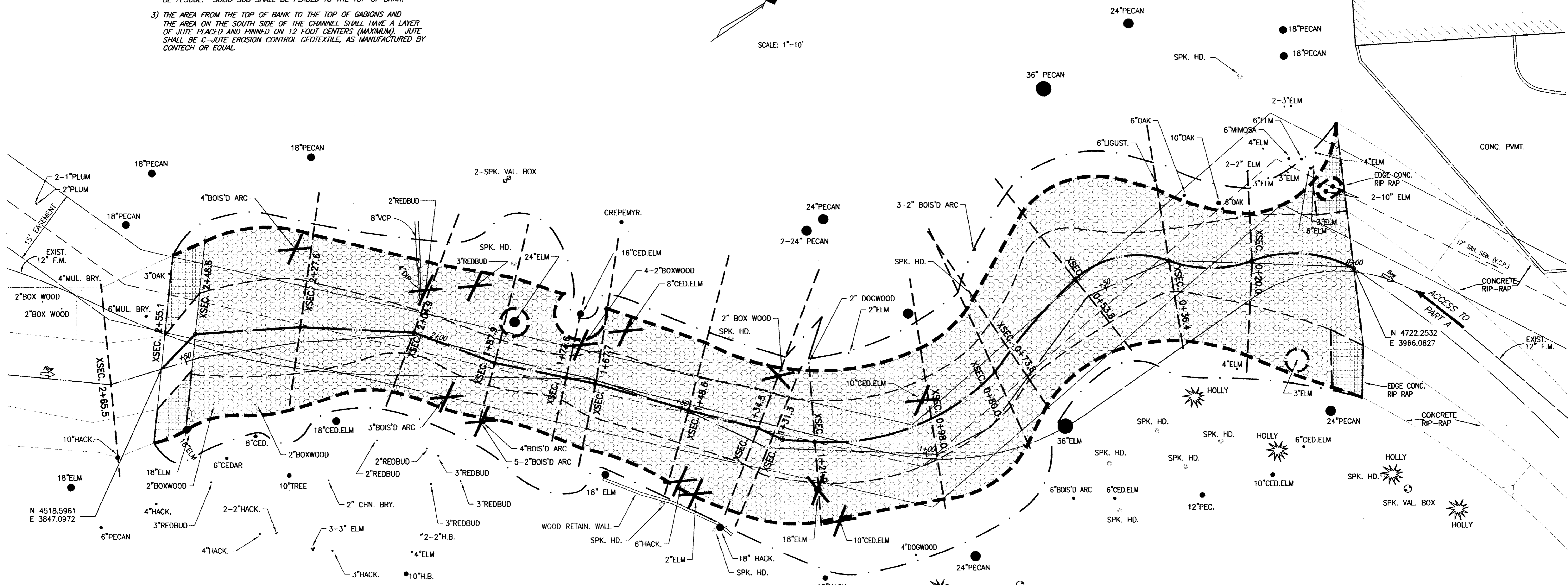

**LEGEND**

- TREE WELL
- TREE REMOVAL & DISPOSAL
- TOP GABION (INSIDE FACE)
- CONSTRUCTION LIMITS
- BOTTOM OF GABIONS
- PROPOSED C OF CHANNEL
- EXISTING C OF CHANNEL
- PROPOSED GABIONS
- PROPOSED GABION TOE WALL TRANSITION

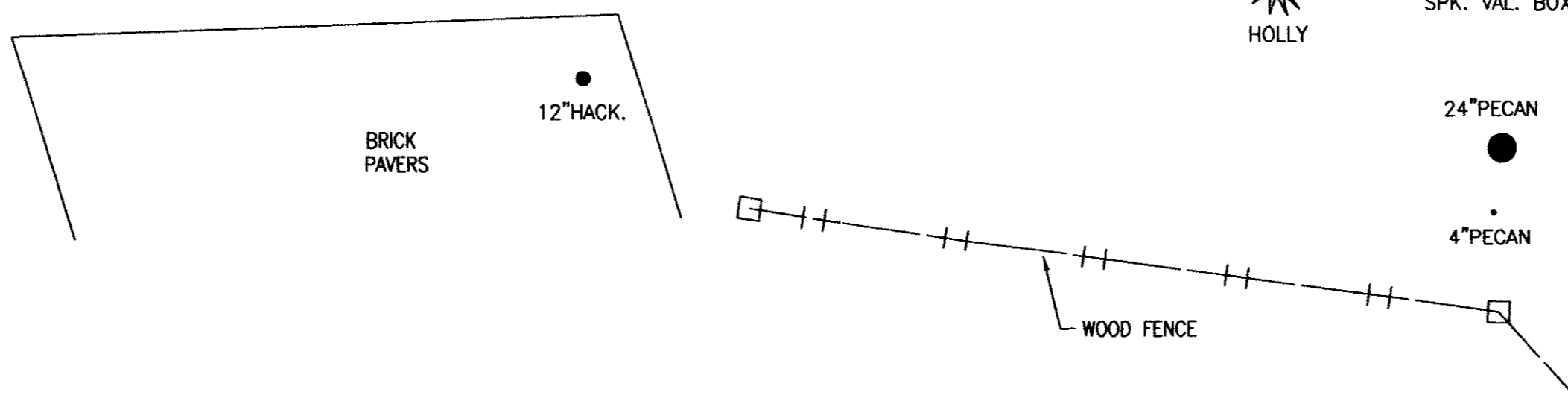

These plans and related specifications were prepared for construction of this specific project only. Reuse of these documents is not permitted without written authorization of Shimek, Jacobs & Finklea, L.L.P.

**TOWN OF ADDISON, TEXAS**  
**TOWNHALL STREAM BANK EROSION PROTECTION PLAN (PART A)**

**SHIMEK, JACOBS & FINKLEA, L.L.P.**  
CONSULTING ENGINEERS  
Dallas, Texas

THESE DOCUMENTS ARE FOR BIDDING, CONSTRUCTION, AND PERMIT PURPOSES.  
*John W. Bullhoff*  
DATE: 10/31/97

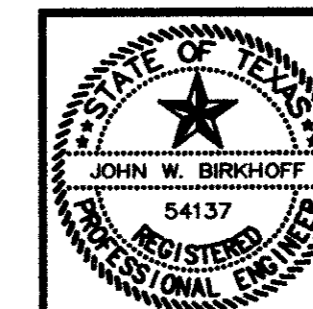

DESIGNED BY: M.H.	PROJECT: 97151	SHEET NO. 2
DRAWN BY: R.J.L.	DATE: OCTOBER, 1997	OF 9 SHEETS