

N 88°00'50" E 240.17'

N 01°59'10" W 162.88'

N 87°56'32" E 20.00'

N 33°11'00" E 280.32'

S 02°03'28" E 219.32'

S 88°00'50" W 356.82'

LEGEND

- B. BOLLARD
- EM ELECTRIC METER
- PP POWER POLE
- LS LIGHT STANDARD
- WM WATER METER
- WV WATER VALVE
- ICV IRRIGATION CONTROL VALVE
- FH FIRE HYDRANT
- CQ CLEANOUT
- MH MANHOLE
- TSC TRAFFIC SIGNAL CONTROL
- TSP TRAFFIC SIGNAL POLE
- TELE TELEPHONE BOX
- FL FLOOD LIGHT
- FP FLAG POLE
- TRF TRAFFIC SIGN
- IR 1/2-INCH IRON ROD
- IRS W/PACHECO KOCH CAP SET
- (C.M.) CONTROLLING MONUMENT
- PROPERTY LINE
- FENCE
- 613 EXIST CONTOUR
- TC 612.39 EXIST TOP OF CURB ELEVATION
- G 611.92 EXIST GUTTER ELEVATION
- EL 612.39 EXIST SPOT ELEVATION
- 655 PROPOSED CONTOUR
- TC 614.5 PROPOSED TOP OF CURB ELEVATION
- G 614.0 PROPOSED GUTTER ELEVATION
- EL 614.5 PROPOSED SPOT ELEVATION
- PROPOSED DRAINAGE FLOW DIRECTION
- PROPOSED DRAINAGE DIVIDE
- 12 WATERSHED DESIGNATION NUMBER
- 3.2 EXPECTED Q<sub>10</sub> IN CUBIC FEET PER SECOND

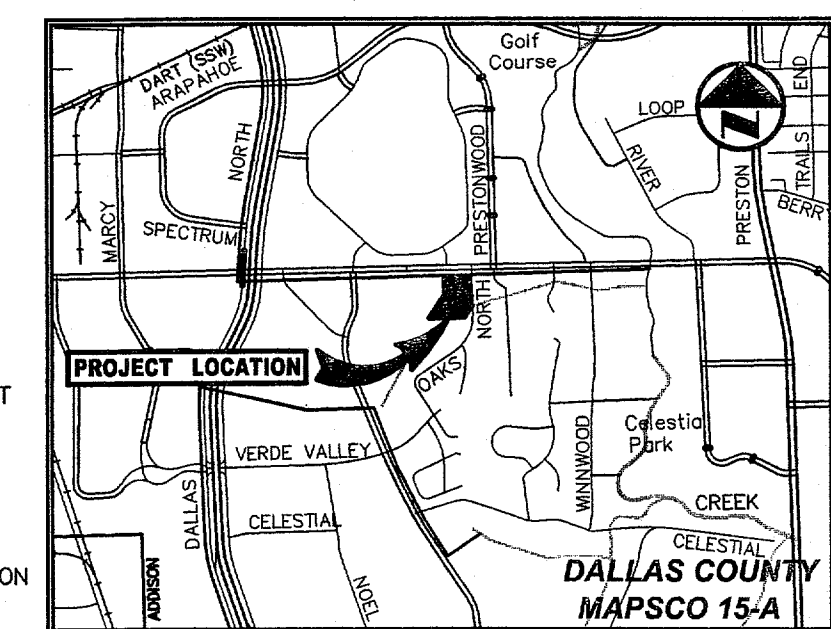
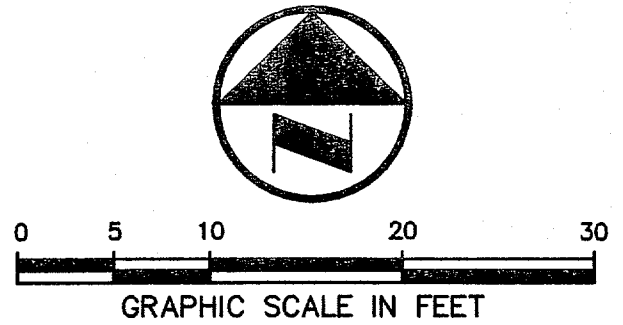

GRADING AND DRAINAGE GENERAL NOTES

1. REFER TO GEOTECHNICAL REPORT FOR REQUIREMENTS REGARDING FILL COMPACTION AND MOISTURE CONTENT.
2. UNLESS NOTED, ALL FILL IS TO BE COMPACTED TO A MINIMUM OF 95% STANDARD PROCTOR DENSITY WITHIN 3% OF OPTIMUM MOISTURE CONTENT. FILL TO BE PLACED IN A MAXIMUM OF 6" LIFTS.
3. SIDEWALKS AND ACCESSIBLE ROUTES SHALL HAVE A SLOPE NO GREATER THAN 5% AND A CROSS FALL NO GREATER THAN 2% UNLESS NOTED OTHERWISE.
4. GRADING OF ALL HANDICAPPED SPACES AND ROUTES TO CONFORM TO STATE, LOCAL AND FEDERAL GUIDELINES.
5. UNLESS NOTED, STORM DRAIN LINES MAY BE OF THE FOLLOWING MATERIALS:
  - A. RCP C-76, CLASS III
  - B. ADS N-12
  - C. HANCOR HI-Q
 AND INSTALLED IN ACCORDANCE WITH MANUFACTURER'S SPECIFICATIONS.
6. UNLESS NOTED, GRATE INLET TO BE "AMERICAN INDUSTRIAL PRE-CAST PRODUCTS, INC." PRECAST CATCH BASIN, SIZED AS SHOWN, OF APPROVED EQUAL.
7. FINAL PAVING, CURB AND SIDEWALK ELEVATIONS WILL BE PLACED AT PLUS OR MINUS 0.03 FOOT.
8. REFER TO LANDSCAPE SPECIFICATION FOR SEEDING AND SOODING REQUIREMENTS.
9. ANY CONCRETE, ROCK OR MATERIAL DEEMED UNSUITABLE FOR SUBGRADE, BY ENGINEER, SHALL BE DISPOSED OF OFFSITE AT CONTRACTOR'S EXPENSE.
10. TRENCH BACKFILL MATERIAL SHALL CONFORM TO THE REQUIREMENTS OF NCTCOG ITEM 6.2.10. AND SHALL BE MECHANICALLY COMPACTED IN ACCORDANCE WITH NCTCOG ITEM 6.2.9 TO A MINIMUM OF 95% STANDARD PROCTOR DENSITY UNLESS OTHERWISE SHOWN ON THESE PLANS OR STATED IN THE STANDARD CITY SPECIFICATIONS.
11. EMBEDMENT SHALL CONFORM TO THE REQUIREMENTS OF NCTCOG ITEM 6.2.9 UNLESS OTHERWISE SHOWN ON THESE PLANS OR STATED IN THE STANDARD CITY SPECIFICATIONS.
12. A ROUND MANHOLE COVER MEETING CITY SPECIFICATIONS SHALL BE PLACED IN ALL INLET TOPS. THE MANHOLE COVER SHALL BE PLACED NEAR THE OUTLET PIPE.
13. ALL CONCRETE FOR INLETS AND DRAINAGE STRUCTURES SHALL CONFORM TO NCTCOG ITEM 7.4.5, CLASS "A" UNLESS OTHERWISE SHOWN ON THESE PLANS OR STATED IN STANDARD CITY SPECIFICATIONS.
14. CRUSHED STONE BEDDING OR APPROVED EQUAL SHALL BE PROVIDED BY THE CONTRACTOR WHEN ROCK IS ENCOUNTERED IN TRENCHES. THERE SHALL BE NO ADDITIONAL PAY ITEM OF THE CRUSHED STONE BEDDING.
15. IF REQUIRED DUE TO CONSTRUCTION, POWER POLES TO BE BRACED OR RELOCATED AT CONTRACTORS EXPENSE.

OAK NORTH DRIVE  
(A VARIABLE WIDTH RIGHT-OF-WAY)

SEE ARCH PLANS FOR BUILDING MODS

EFF=100.00

ONE STORY MASONRY BUILDING

EFF=98.00

EXISTING 2 FT. SLAB DROP

BENCH MARK LIST

BM#1 TOP OF FINISHED FLOOR AT REAR OF BUILDING WITH # 5330 ON DOOR.  
ASSUMED ELEV = 100.00

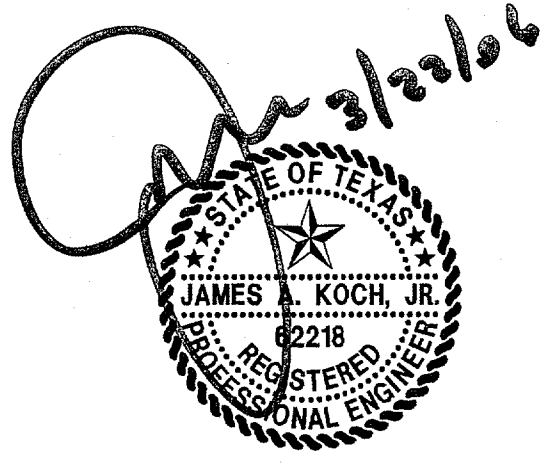

THE SEAL APPEARING ON THIS DOCUMENT WAS AUTHORIZED BY JAMES A. KOCH, JR., P.E. 02218 ON 03/22/2006. ALTERATION OF A SEALED DOCUMENT WITHOUT PROPER NOTIFICATION TO THE RESPONSIBLE ENGINEER IS AN OFFENSE UNDER THE TEXAS ENGINEERING PRACTICE ACT.

NO.	DATE	REVISION				
<b>Pacheco Koch Consulting Engineers</b> 8350 N. CENTRAL EXPWY. SUITE 1000 DALLAS, TX. 75206 972.235.3031						
<b>GRADING &amp; DRAINAGE PLAN</b> <b>ADDISON TOWN HALL CENTER</b> <b>TRACT 2</b> <b>LAKE FOREST ADDITION</b> <b>TOWN OF ADDISON, TEXAS</b>						
DESIGN	DRAWN	DATE	SCALE	NOTES	FILE	NO.
KFW	KFW	JAN 2006	1"=20'			<b>C4.1</b>

ADDISON TOWN HALL CENTER

KWHTIS 3:07PM 03/21/2006 2721-05.439.DWG