

# CONSTRUCTION PLANS FOR ADDISON TOWN HALL CENTER LAKE FOREST ADDITION TRACT 2

1.7748 ACRES  
TOWN OF ADDISON, DALLAS COUNTY, TEXAS

FOR

**HODGES & ASSOCIATES** architecture planning  
Architecture P.L.L.C.  
13842 Omega Dallas, Texas 75244-4514  
phone: 972 387-1000 fax: 972 980-1129  
www.hodgesusa.com

OWNER/DEVELOPER

BELTWAY COMMERCIAL REAL ESTATE  
15280 ADDISON ROAD  
ADDISON, TX 75001  
972-661-1011

PREPARED BY

**Pacheco Koch**  
Consulting Engineers  
8350 N. CENTRAL EXPWY., SUITE 1000 PH. 972.235.3031  
DALLAS, TEXAS 75206 FAX 972.235.9544

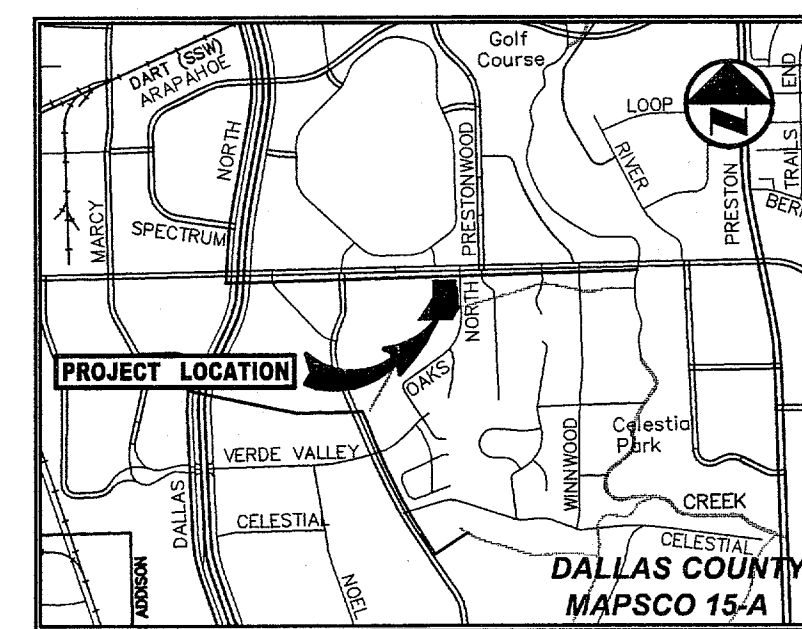

**VICINITY MAP**  
(NOT TO SCALE)

### DRAWING SHEET INDEX

SHEET	DESCRIPTION
C1.1	DEMOLITION PLAN
C2.1	DIMENSIONAL CONTROL PLAN
C3.1	SANITARY SEWER PLAN
C4.1	GRADING & DRAINAGE PLAN
C5.1	PAVING PLAN
C5.2	PAVING DETAILS
C6.1	EROSION CONTROL PLAN
LP1.01	LANDSCAPE PLAN
IR1.01	IRRIGATION PLAN & DETAILS

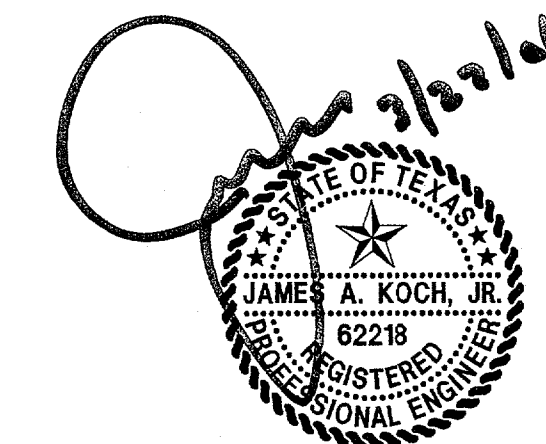

THE SEAL APPEARING ON THIS DOCUMENT WAS AUTHORIZED BY JAMES A. KOCH, JR., P.E. 62218 ON 03/22/2006. ALTERATION OF A SEALED DOCUMENT WITHOUT PROPER NOTIFICATION TO THE RESPONSIBLE ENGINEER IS AN OFFENSE UNDER THE TEXAS ENGINEERING PRACTICE ACT.

B4-3

03/06

5330 BELT LINE

ADDISON TOWN HALL CENTER

B4-3

KWHITS  
03/21/2006 - 3:08PM  
M: DWG-2721-05-439.DWG