

N 88°00'50" E 240.17'

N 01°55'10" W 129.79'

N 37°11'00" E 200.32'

N 87°56'32" E 20.00'

S 02°03'28" E 219.32'

S 33°11'00" W 123.17'

S 88°00'50" W 356.82'

- LEGEND**
- B. BOLLARD
 - EM ⊙ ELECTRIC METER
 - PP. POWER POLE
 - LS. LIGHT STANDARD
 - WM. WATER METER
 - WV. WATER VALVE
 - ICV. IRRIGATION CONTROL VALVE
 - FH. FIRE HYDRANT
 - CO. CLEANOUT
 - MH. MANHOLE
 - TSC. TRAFFIC SIGNAL CONTROL
 - TSP. TRAFFIC SIGNAL POLE
 - TE. TELEPHONE BOX
 - FL. FLOOD LIGHT
 - FP. FLAG POLE
 - SIG. TRAFFIC SIGN
 - IRS. 1/2-INCH IRON ROD
 - (C.M.) W/PACHECO KOCH CAP SET
 - PROPERTY LINE
 - - - FENCE

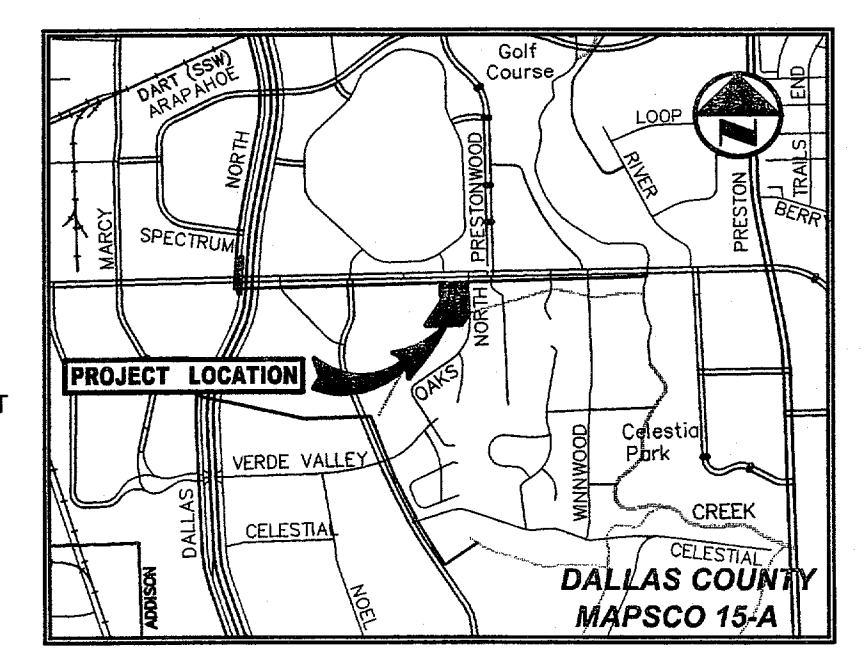
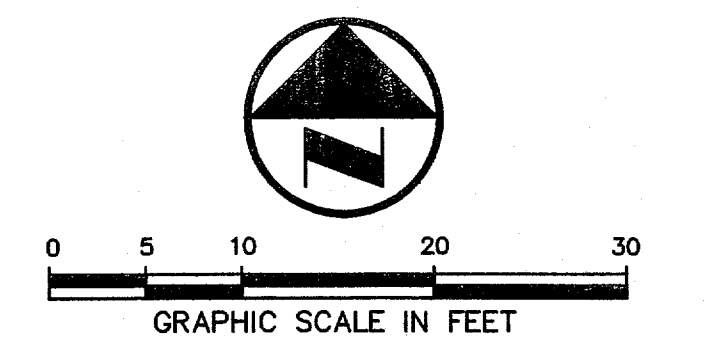

VICINITY MAP (NOT TO SCALE)

GENERAL NOTES

1. ALL WORK, UNLESS OTHERWISE NOTED, SHALL CONFORM TO THE STANDARD SPECIFICATIONS FOR PUBLIC WORKS CONSTRUCTION, ISSUED BY THE NORTH CENTRAL TEXAS COUNCIL OF GOVERNMENT, AND TOWN OF ADDISON STANDARD CONSTRUCTION SPECIFICATIONS.
2. PRIOR TO ANY CONSTRUCTION, THE CONTRACTOR SHALL BE FAMILIAR WITH THE PLANS INCLUDING ALL NOTES, THE STANDARD SPECIFICATIONS FOR PUBLIC WORKS CONSTRUCTION NORTH CENTRAL TEXAS AND THE CITY STANDARDS FOR CONSTRUCTION AND ANY OTHER APPLICABLE STANDARD AND SPECIFICATIONS RELEVANT TO THE PROPER COMPLETION OF THE WORK SPECIFIED. FAILURE ON THE PART OF THE CONTRACTOR TO BE FAMILIAR WITH ALL STANDARDS AND SPECIFICATION PERTAINING TO THIS WORK SHALL IN NO WAY RELIEVE THE CONTRACTOR OF RESPONSIBILITY OF PERFORMING THE WORK IN ACCORDANCE WITH ALL SUCH APPLICABLE STANDARDS AND SPECIFICATIONS.
3. THE HORIZONTAL AND VERTICAL LOCATIONS OF EXISTING SUBSURFACE UTILITIES HAVE BEEN DETERMINED FROM DATA RECORDED BY OTHERS. CONTRACTOR SHALL VERIFY THAT NECESSARY CROSSING CLEARANCES BETWEEN EXISTING AND PROPOSED UTILITIES EXIST PRIOR TO CONSTRUCTION OF ANY SUCH CROSSING. IT WILL BE THE RESPONSIBILITY OF THE CONTRACTOR TO PROTECT ALL UTILITIES IN THE CONSTRUCTION OF THIS PROJECT. CONTRACTOR TO VERIFY SIZE AND LOCATION OF ALL UTILITIES PRIOR TO CONSTRUCTION.
4. IT WILL BE THE RESPONSIBILITY OF THE CONTRACTOR TO PROTECT ALL MANHOLES, CLEANOUTS, VALVE BOXES, FIRE HYDRANTS, ETC. THEY MUST BE ADJUSTED TO PROPER LINE AND GRADE BY THE CONTRACTOR PRIOR TO AND AFTER THE PLACING OF PERMANENT PAVING AND GRADING. UTILITIES MUST BE MAINTAINED TO PROPER LINE AND GRADE DURING THE CONSTRUCTION OF THE PAVING FOR THIS DEVELOPMENT.
5.
 - 5.1 PROTECT AND MAINTAIN ROADWAY TRAFFIC THROUGHOUT THE PROJECT, PROVIDING A MINIMUM OF ONE (1) LANE OPEN IN EACH DIRECTION;
 - 5.2 PROVIDE AND MAINTAIN INTERIM ACCESS FROM ROADWAYS CURRENTLY IN USE TO ALL DRIVEWAYS AND INTERSECTING STREETS OR ALLEYS;
 - 5.3 MAINTAIN NORMAL PROJECT DRAINAGE UNTIL NEW DRAINAGE FACILITIES ARE FUNCTIONAL, INCLUDING, WHERE NECESSARY, INTERIM REPLACEMENT OF EXISTING DRAINAGE STRUCTURES REMOVED FOR CONSTRUCTION OF NEW DRAINAGE FACILITIES.
 - 5.4 MAINTAIN ALL WORK AND MATERIAL STORAGE AREAS IN ORDERLY CONDITION, FREE OF DEBRIS AND WASTE; ON COMPLETION OF CONSTRUCTION, CLEAN UP THE PROJECT AND ADJACENT AFFECTED AREAS TO ACCEPTABLE CONDITION, ALL AS PROVIDED IN THE GENERAL CONDITIONS.
6. PRIOR TO COMMENCEMENT OF CONSTRUCTION, BONDS AND THREE-WAY CONTRACTS SHALL BE SUBMITTED TO THE CITY AS REQUIRED.
7. THE CONTRACTOR IS RESPONSIBLE FOR COMPLIANCE WITH ALL FEDERAL, STATE AND LOCAL REGULATIONS REGARDING TRENCH SAFETY.
8. REFER TO ARCHITECTURAL AND STRUCTURAL PLANS TO VERIFY ALL BUILDING DIMENSIONS.
9. REFER TO ARCHITECTURAL PLANS FOR DETAILED BUILDING ENTRANCE LAYOUTS, RAMPS, LANDSCAPE AND SIDEWALKS.
10. BARRICADING AND PROJECT SIGNS SHALL CONFORM TO TEXAS DEPARTMENT OF TRANSPORTATION MANUAL OF UNIFORM TRAFFIC CONTROL DEVICES AND LATEST UPDATES.

OAK NORTH DRIVE
(A VARIABLE WIDTH RIGHT-OF-WAY)

SEE ARCH PLANS FOR BUILDING MODS

EFF=100.00

EXISTING 2 FT. SLAB DROP

EFF=98.00

ONE STORY MASONRY BUILDING

LANDSCAPE PLANS FOR DETAILS LPA.0 & IRI.01

ALL DIMENSIONS ARE TO BACK-OF-CURB UNLESS OTHERWISE NOTED.

BENCH MARK LIST

BM#1 TOP OF FINISHED FLOOR AT REAR OF BUILDING WITH # 5330 ON DOOR.
ASSUMED ELEV = 100.00

NO.	DATE	REVISION

Pacheco Koch Consulting Engineers
8350 N. CENTRAL EXPWY. SUITE 1000 DALLAS, TX. 75206 972.235.3031

DIMENSIONAL CONTROL PLAN
ADDISON TOWN HALL CENTER
TRACT 2
LAKE FOREST ADDITION
TOWN OF ADDISON, TEXAS

DESIGN	DRAWN	DATE	SCALE	NOTES	FILE	NO.
KFW	KFW	JAN 2006	1"=20'			C2.1

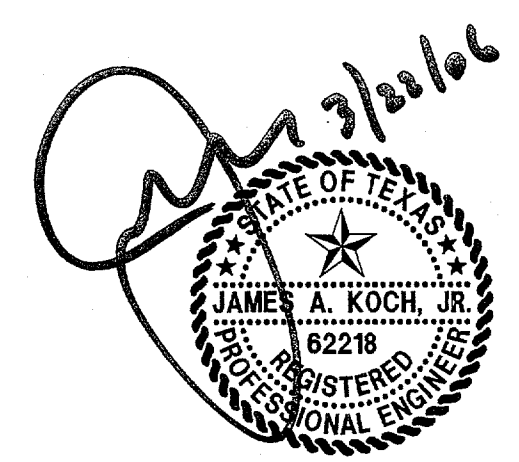

THE SEAL APPEARING ON THIS DOCUMENT WAS AUTHORIZED BY JAMES A. KOCH, JR. P.E. 62218 ON 03/22/2006. ALTERATION OF A SEALED DOCUMENT WITHOUT PROPER NOTIFICATION TO THE RESPONSIBLE ENGINEER IS AN OFFENSE UNDER THE TEXAS ENGINEERING PRACTICE ACT.

KWHITS
 03/21/2006 3:06PM
 M: \\DWG-27\2721-05.439\DWG\2721-05-439CV.DWG

ADDISON TOWN HALL CENTER