

N 88°00'50" E 240.17'

N 01°59'10" W 192.68'

N 33°11'00" E 280.32'

N 87°56'32" E 20.00'

S 02°03'28" E 219.32'

S 88°00'50" W 356.82'

- LEGEND**
- B. BOLLARD
 - EM_φ ELECTRIC METER
 - PP. POWER POLE
 - LS. LIGHT STANDARD
 - WM. WATER METER
 - WV. WATER VALVE
 - ICV. IRRIGATION CONTROL VALVE
 - FH. FIRE HYDRANT
 - CL. CLEANOUT
 - MH. MANHOLE
 - TSC. TRAFFIC SIGNAL CONTROL
 - TSP. TRAFFIC SIGNAL POLE
 - TELE. TELEPHONE BOX
 - FL. FLOOD LIGHT
 - FP. FLAG POLE
 - SIG. TRAFFIC SIGN
 - IRS. 1/2-INCH IRON ROD
 - (C.M.) W/PACHECO KOCH" CAP SET
 - PROPERTY LINE
 - FENCE

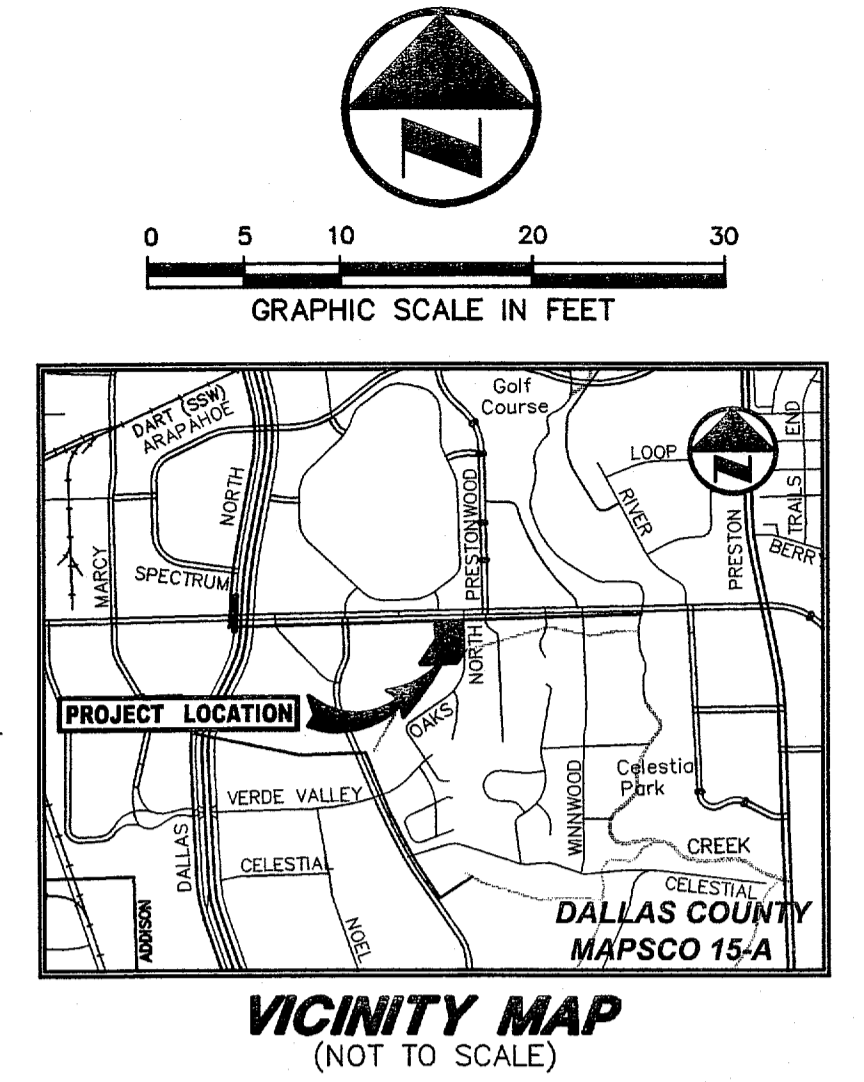

WATER AND SANITARY SEWER GENERAL NOTES

1. UNLESS OTHERWISE NOTED, ALL CONCRETE SHALL BE CLASS "A", (3000 PSI).
2. ALL DOMESTIC WATER MAINS SHALL BE PVC C900, DR 18, CLASS 150. ALL FIRE SERVICE WATER MAINS SHALL BE PVC C900, DR14, CLASS 200.
3. WATER AND SANITARY SEWER SERVICES SHALL MEET PLUMBING CODE REQUIREMENTS.
4. ALL WATER MAINS UNLESS OTHERWISE NOTED SHALL HAVE A MINIMUM COVER OF 48" BELOW FINISHED GRADE.
5. SANITARY SEWER PIPE SHALL BE PVC SDR-35.
6. WHEN WATER MAINS AND SANITARY SEWERS ARE INSTALLED, THEY SHALL BE INSTALLED NO CLOSER TO EACH OTHER THAN NINE FEET IN ALL DIRECTIONS AND PARALLEL LINES MUST BE INSTALLED IN SEPARATE TRENCHES, WHERE THE NINE FOOT SEPARATION DISTANCE CANNOT BE ACHIEVED, THE FOLLOWING GUIDELINES SHALL APPLY:
 - (A) WHERE A SANITARY SEWER PARALLELS A WATERLINE, THE SEWER SHALL BE CONSTRUCTED OF CAST IRON, DUCTILE IRON OR PVC MEETING ASTM SPECIFICATIONS WITH A PRESSURE RATING FOR BOTH THE PIPE AND JOINTS OF 150 PSI. THE VERTICAL SEPARATION SHALL BE A MINIMUM OF TWO FEET BETWEEN OUTSIDE DIAMETERS AND THE HORIZONTAL SEPARATION SHALL BE A MINIMUM OF FOUR FEET BETWEEN OUTSIDE DIAMETERS. THE SEWER SHALL BE LOCATED BELOW THE WATERLINE.
 - (B) WHERE A SANITARY SEWER CROSSES A WATERLINE AND THE SEWER IS CONSTRUCTED OF CAST IRON, DUCTILE IRON OR PVC WITH A MINIMUM PRESSURE RATING OF 150 PSI, AN ABSOLUTE MINIMUM DISTANCE OF SIX INCHES BETWEEN OUTSIDE DIAMETERS SHALL BE MAINTAINED. IN ADDITION, THE SEWER SHALL BE LOCATED BELOW THE WATERLINE WHERE POSSIBLE AND ONE LENGTH OF THE SEWER PIPE MUST BE CENTERED ON THE WATERLINE.
 - (C) WHERE A SEWER CROSSES UNDER A WATERLINE AND THE SEWER IS CONSTRUCTED OF ABS TRUSS PIPE, SIMILAR SEMI-RIGID PLASTIC COMPOSITE PIPE, CLAY PIPE OR CONCRETE PIPE WITH GASKETED JOINTS, A MINIMUM TWO FOOT SEPARATION DISTANCE SHALL BE MAINTAINED. IN ADDITION, THE SEWER SHALL BE LOCATED BELOW THE WATERLINE WHERE POSSIBLE AND ONE LENGTH OF THE SEWER PIPE MUST BE CENTERED ON THE WATERLINE.
 - (D) WHERE A SEWER CROSSES OVER A WATERLINE ALL PORTIONS OF THE SEWER WITHIN NINE FEET OF THE WATERLINE SHALL BE CONSTRUCTED OF CAST IRON, DUCTILE IRON OR PVC PIPE WITH A PRESSURE RATING OF AT LEAST 150 PSI USING APPROPRIATE ADAPTERS. IN LIEU OF THIS PROCEDURE, THE NEW CONVEYANCE MAY BE ENCASED IN A JOINT OF 150 PSI PRESSURE CLASS PIPE AT LEAST 18 FEET LONG AND TWO NOMINAL SIZES LARGER THAN THE NEW CONVEYANCE. THE SPACE AROUND THE CARRIER PIPE SHALL BE SUPPORTED AT FIVE FEET INTERVALS WITH SPACERS OR BE FILLED TO THE SPRING LINE WITH WASHED SAND. THE ENCASEMENT PIPE SHOULD BE CENTERED ON THE CROSSING AND BOTH ENDS SEALED WITH CEMENT GROUT OR MANUFACTURED SEAL.
 - (E) THE SEWER NEED NOT BE DISTURBED WHERE A NEW WATERLINE IS TO BE INSTALLED PARALLEL TO AN EXISTING SEWER THAT SHOWS NO EVIDENCE OF LEAKAGE AND THE WATERLINE IS INSTALLED ABOVE THE SEWER A MINIMUM OF TWO FEET VERTICALLY AND FOUR FEET HORIZONTALLY. SHOULD EXCAVATION FOR THE WATERLINE PRODUCE EVIDENCE THAT THE SEWER IS LEAKING, THE SEWER MUST BE REPAIRED OR REPLACED AS DESCRIBED IN SUBPARAGRAPHS (A) OR (D) OF THIS PARAGRAPH.
 - (F) THE SEWER NEED NOT BE DISTURBED WHERE A NEW WATERLINE IS TO CROSS OVER (BY TWO FEET OR MORE) EXISTING SEWER SHOWING NO EVIDENCE OF LEAKAGE. SHOULD EXCAVATION FOR THE WATERLINE PRODUCE EVIDENCE THAT THE SEWER IS LEAKING, THEN THE SEWER MUST BE REPAIRED OR REPLACED AS DESCRIBED IN SUBSECTIONS (C) OR (D).
7. CONTRACTOR TO VERIFY ALL EXISTING SEWER FLOW LINES BEFORE BEGINNING CONSTRUCTION.
8. CONTRACTOR SHALL TIE A 1" WIDE PIECE OF RED PLASTIC FLAGGING TO THE END OF SEWER SERVICE AND SHALL LEAVE A MINIMUM OF 36" OF FLAGGING EXPOSED AFTER BACKFILL. AFTER CURB AND PAVING IS COMPLETED, CONTRACTOR SHALL MARK THE LOCATION OF THE SEWER SERVICE ON THE CURB OF ALLEY IN ACCORDANCE WITH THE STANDARD CITY SPECIFICATIONS.
9. ALL SANITARY SEWER LINES SHALL BE TESTED IN ACCORDANCE WITH THE STANDARD CITY SPECIFICATIONS.
10. THE UTILITY CONTRACTOR SHALL INSTALL THE WATER SERVICES TO A POINT (2) FEET BACK OF THE CURB LINE AT A DEPTH OF 12 INCHES. THE METER BOX SHALL BE FURNISHED AND INSTALLED BY THE CONTRACTOR. AFTER THE PAVING CONTRACTOR HAS COMPLETED THE FINE GRADING BEHIND THE CURB, EACH SERVICE LOCATION WILL BE MARKED ON THE CURB, WITH A BLUE LETTER "W" BY THE UTILITY CONTRACTOR AND TIED TO PROPERTY CORNERS ON THE "RECORD DRAWINGS".
11. ALL METER BOXES SHALL BE LOCATED IN NON-TRAFFIC AREAS.
12. UTILITY TRENCHES SHALL BE BACKFILLED WITH MATERIAL MEETING NCTCOG ITEM 6.2.10 AND MECHANICALLY COMPACTED IN 8" LIFTS TO THE TOP OF THE SUBGRADE TO A MINIMUM OF 95% STANDARD PROCTOR DENSITY.
13. VALVE BOXED SHALL BE FURNISHED AND SET ON EACH GATE VALVE. AFTER THE FINAL CLEAN-UP AND ALIGNMENT HAS BEEN COMPLETED, THE CONTRACTOR (UTILITY) SHALL POUR A CONCRETE BLOCK 24"x24"x8" AROUND ALL VALVE BOX TOPS WHICH SHALL BE LEVEL WITH THE FINISHED GRADES.
14. IF REQUIRED DUE TO CONSTRUCTION, POWER POLES TO BE BRACED OR RELOCATED AT CONTRACTORS EXPENSE.

OAK NORTH DRIVE
(A VARIABLE WIDTH RIGHT-OF-WAY)

SEE ARCH PLANS FOR BUILDING MODS

EFF=100.00

EXISTING 2 FT. SLAB DROP

EFF=98.00

ONE STORY MASONRY BUILDING

STA. 14+06.00 W-1
INSTALL:
1-8" DOUBLE CLEANOUT END
5.0' FROM FACE OF BUILDING
MATCH EX FL FROM BUILDING
CONTRACTOR TO FIELD VERIFY EX FLOWLINE

STA. 0+07.07 W-1
INSTALL:
1-8" 45° WYE
12 L.F. 6" WASTEWATER PIPE
1-6" CLEANOUT
FL 6" @ WYE = 88.64
FL @ C.O. = 88.88

STA. 0+50.50 W-1
INSTALL:
1-6" CLEANOUT

STA. 0+00.00 W-1
CONNECT TO EX 8" SS MAIN
INSTALL:
1-8"x6" 45° WYE
FL 8" @ WYE = 88.42
FL 6" @ WYE = 88.50
CONTRACTOR TO FIELD VERIFY

ADJUST CLEANOUT
CO = ±98.00

ADJUST MANHOLE RIM
RIM = ±95.35

BENCH MARK LIST

BM#1 TOP OF FINISHED FLOOR AT REAR OF BUILDING WITH # 5330 ON DOOR.
ASSUMED ELEV = 100.00

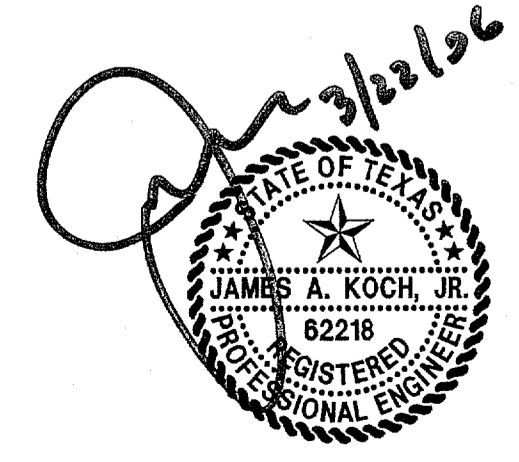

THE SEAL APPEARING ON THIS DOCUMENT WAS AUTHORIZED BY JAMES A. KOCH, JR., P.E. 82218 ON 03/23/2006. ALTERATION OF A SEALED DOCUMENT WITHOUT PROPER NOTIFICATION TO THE RESPONSIBLE ENGINEER IS AN OFFENSE UNDER THE TEXAS ENGINEERING PRACTICE ACT.

NO.	DATE	REVISION				
<p>Pacheco Koch Consulting Engineers 8350 N. CENTRAL EXPWY. SUITE 1000 DALLAS, TX. 75206 972.235.3031</p>						
<p>SANITARY SEWER PLAN ADDISON TOWN HALL CENTER TRACT 2 LAKE FOREST ADDITION TOWN OF ADDISON, TEXAS</p>						
DESIGN	DRAWN	DATE	SCALE	NOTES	FILE	NO.
KFW	KFW	JAN 2006	1"=20'			C3.1

KWHITS 03/21/2006 3:07PM
 M: DWG-27-2721-05-439 DWG:2721-05-439CV.DWG