

SCALE IN FEET: 1"=40'

NOTE: ALL DIMENSIONS ARE FROM FACE OF CURB TO FACE OF CURB

LEGEND

| | |
|-----|----------------|
| ⊕ | FIRE HYDRANT |
| ⊕ | POWER POLE |
| ⊕ | LIGHT STANDARD |
| ⊕ | WATER METER |
| ⊕ | WATER VALVE |
| ⊕ | CLEANOUT |
| ⊕ | MANHOLE |
| ⊕ | GAS METER |
| --- | PROPERTY LINE |

CURVE DATA TABLE

| CURVE | RADIUS | DELTA | LENGTH | TANGENT | CHORD | BEARING |
|-------|--------|------------|--------|---------|--------|---------------|
| C1 | 150.00 | 44°06'24" | 100.07 | 52.66 | 97.62 | S 21°30'32" E |
| C2 | 50.00 | 38°58'05" | 33.30 | 17.33 | 32.74 | S 21°30'32" E |
| C3 | 50.00 | 38°58'05" | 34.01 | 17.69 | 33.30 | S 19°17'15" E |
| C4 | 50.00 | 80°43'23" | 79.17 | 50.64 | 71.16 | S 42°09'53" E |
| C5 | 50.00 | 80°43'23" | 77.91 | 49.37 | 70.26 | N 45°00'12" E |
| C6 | 50.00 | 90°00'00" | 78.54 | 50.00 | 70.71 | N 44°48'12" E |
| C7 | 50.00 | 19°23'04" | 16.92 | 8.54 | 16.84 | N 80°06'40" E |
| C8 | 150.00 | 89°23'04" | 76.01 | 38.73 | 70.26 | N 80°06'40" E |
| C9 | 50.00 | 47°27'08" | 41.34 | 21.83 | 40.17 | N 22°42'42" W |
| C10 | 150.00 | 24°48'11" | 56.28 | 28.59 | 55.54 | N 52°57'50" W |
| C11 | 50.00 | 29°40'18" | 25.89 | 13.24 | 25.61 | N 53°31'48" W |
| C12 | 50.00 | 85°51'57" | 74.93 | 45.52 | 88.11 | N 43°07'46" W |
| C13 | 50.00 | 116°54'41" | 102.02 | 81.45 | 85.22 | N 58°15'32" E |
| C14 | 100.00 | 60°31'00" | 105.10 | 59.59 | 100.31 | N 68°35'19" E |
| C15 | 50.00 | 123°50'17" | 107.78 | 84.96 | 88.09 | S 61°45'09" E |
| C16 | 50.00 | 56°16'51" | 49.11 | 26.74 | 47.16 | S 28°06'26" E |
| C17 | 50.00 | 58°43'31" | 49.29 | 27.05 | 47.50 | S 27°02'28" E |
| C18 | 150.00 | 40°50'07" | 102.12 | 52.86 | 104.86 | S 21°00'14" W |

- NOTES BY SYMBOL**
- ① INDICATES 6" CONCRETE CURB
 - ② INDICATES 18" CONCRETE CURB
 - ③ INDICATES PROPOSED STOP SIGN INSTALL AS PER CITY OF ADDISON STANDARDS
 - ④ INDICATES BARRIER FREE RAMP

NOTE: SEE GRADING PLAN FOR PARKING STALL GRADES.

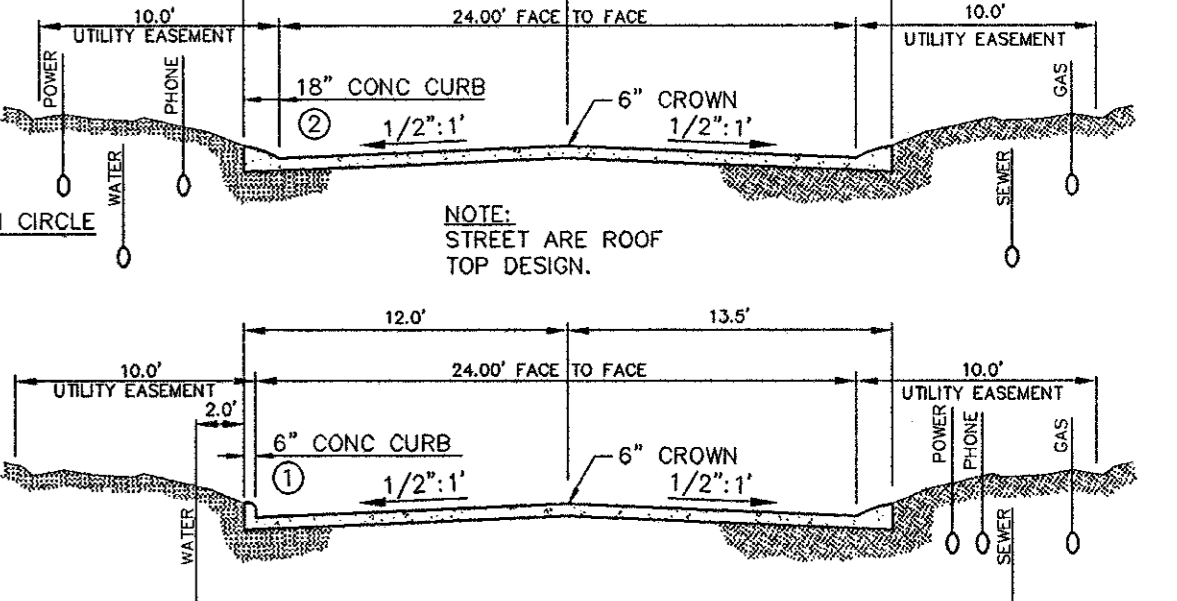

TYPICAL UTILITY SECTIONS

- NOTES:
- BEARING SYSTEM BASED ON THE FINAL PLAN OF THE MIDWAY SQUARE ADDITION VOL. 93252 PG. 3095.
 - LOTS # 64,65,66 AND 67 ARE COMMON AREAS
 - FACE OF GARAGE DOORS SHALL BE LOCATED A MINIMUM OF 17 FEET FROM THE EDGE OF STREET PAVEMENT
 - NO FENCES OR BUILDINGS SHALL BE ALLOWED WITHIN 10 FEET OF THE BACK OF CURB OR IN INDICATED VISIBILITY AREAS
 - SEE DETAIL SHEET FOR GENERAL NOTES, STANDARD DETAILS, EROSION CONTROL DETAILS & POLLUTION CONTROL NOTES.

NOTE: ALL DIMENSIONS ARE FROM FACE OF CURB TO FACE OF CURB

RECORD DRAWING

THIS DRAWING HAS BEEN REVISED TO REFLECT CONSTRUCTION RECORDS MAINTAINED AND PROVIDED BY THE CONTRACTOR FOR THIS PROJECT.

CONTRACTOR: THE HUBBLE GROUP
DATE REVISED: 11/10/98

CONTRACTOR TO TAKE STEPS AS NECESSARY TO PROTECT EXISTING TREES AND ROOT SYSTEMS SHOWN ON THIS PLAN TO THE FULLEST EXTENT POSSIBLE, UNLESS TREES THAT ARE MARKED FOR REMOVAL MAINTAIN EXISTING GRADE AS CLOSE AS POSSIBLE UNDER DRIP LINE

- BENCHMARK LIST**
- "□" CUT ON TOP OF CURB IN FRONT OF FIRE HYDRANT ON NORTH SIDE OF BELTWAY DRIVE, 160± FEET EAST OF CENTERLINE OF LA GRANDE DRIVE. EL = 629.57
 - "□" CUT ON TOP OF CURB ON NORTH WEST CORNER OF PARKING LOT AT 14833 MIDWAY ROAD. EL = 630.53
 - "□" CUT ON TOP OF CURB OF SOUTHWEST CORNER OF PARKING LOT AT 14833 MIDWAY ROAD. EL = 628.75

- NOTES:**
- PAVERS TO BE INCLUDED IN PROJECT PER DETAIL. FINAL LAYOUT TO BE DETERMINED ON LANDSCAPE PLANS. CONTRACTOR TO PROVIDE UNIT PRICE FOR PAVEMENT INSTALLATION.
 - SEE PAVING PLAN FOR SIGN LOCATIONS.

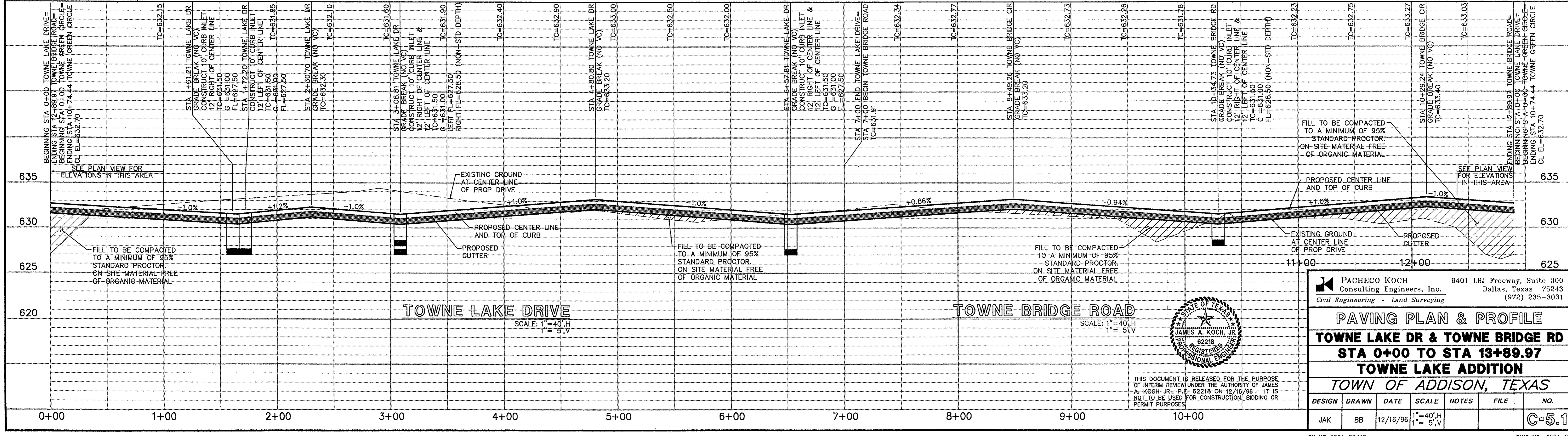

PACHECO KOCH Consulting Engineers, Inc. 9401 LBJ Freeway, Suite 300 Dallas, Texas 75243 (972) 235-3031

PAVING PLAN & PROFILE
TOWNE LAKE DR & TOWNE BRIDGE RD
STA 0+00 TO STA 13+89.97
TOWNE LAKE ADDITION
TOWN OF ADDISON, TEXAS

| DESIGN | DRAWN | DATE | SCALE | NOTES | FILE | NO. |
|--------|-------|----------|-----------------------|-------|------|-------|
| JAK | BB | 12/16/96 | 1"=40', H 1"=5', V | | | C-5.1 |

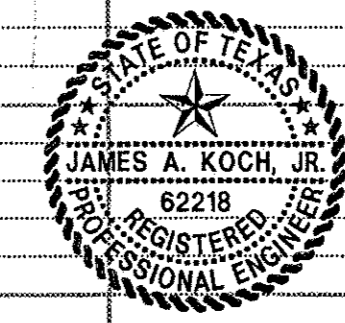

THIS DOCUMENT IS RELEASED FOR THE PURPOSE OF INTERIM REVIEW UNDER THE AUTHORITY OF JAMES A. KOCH, JR., P.E. 62218 ON 12/16/96. IT IS NOT TO BE USED FOR CONSTRUCTION, BIDDING OR PERMIT PURPOSES.