

**1 DRIVEWAY APPROACH**  
NOT TO SCALE

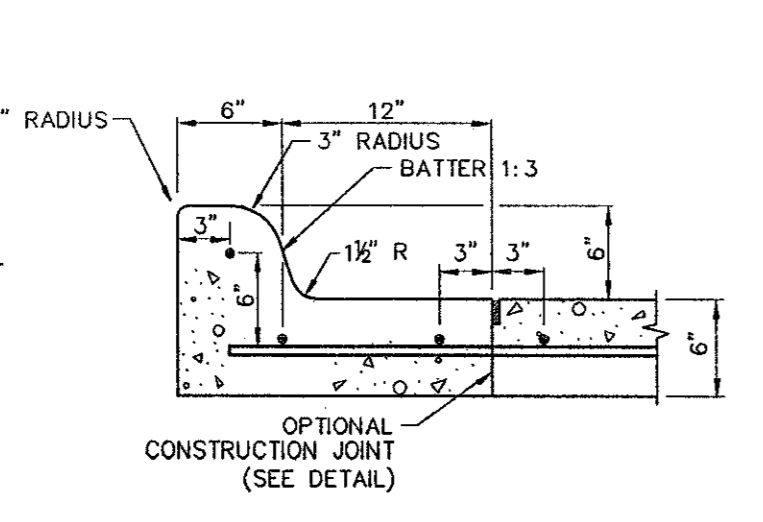

**2 6\"/>**

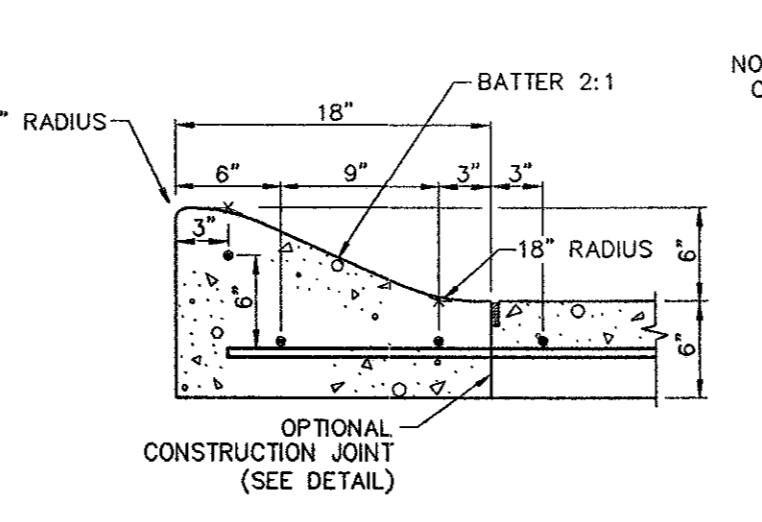

**3 18\"/>**

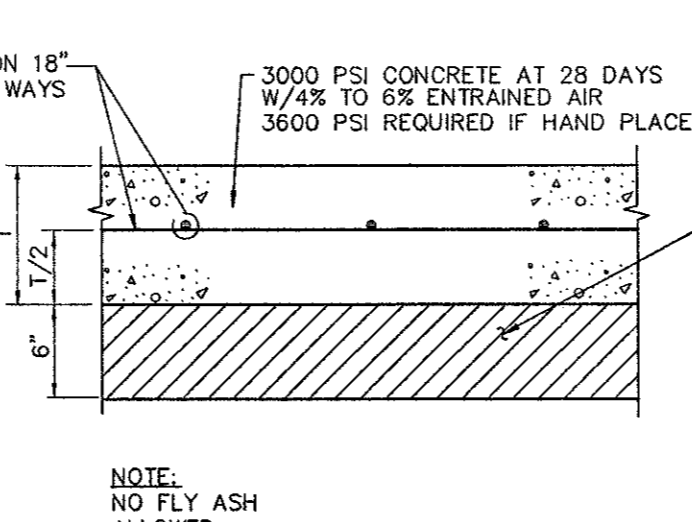

**4 PAVEMENT SECTION**  
NOT TO SCALE

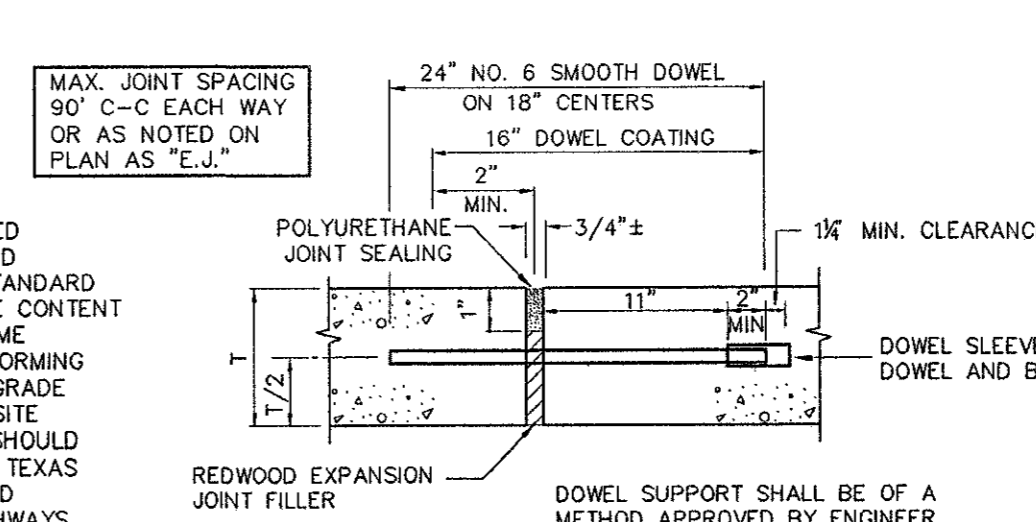

**5 EXPANSION JOINT**  
NOT TO SCALE

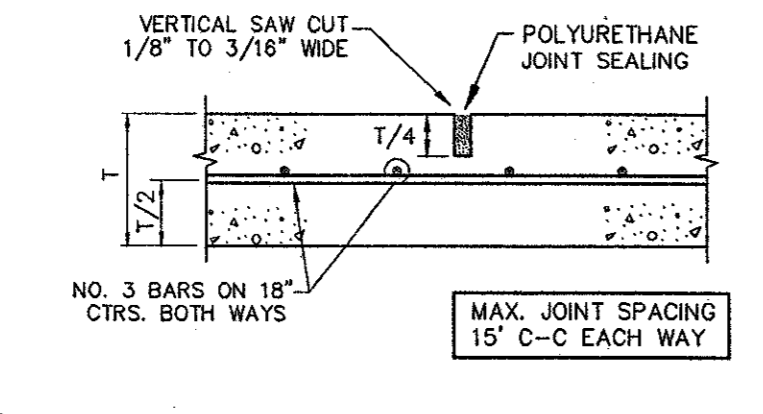

**6 SAWED DUMMY JOINT**  
NOT TO SCALE

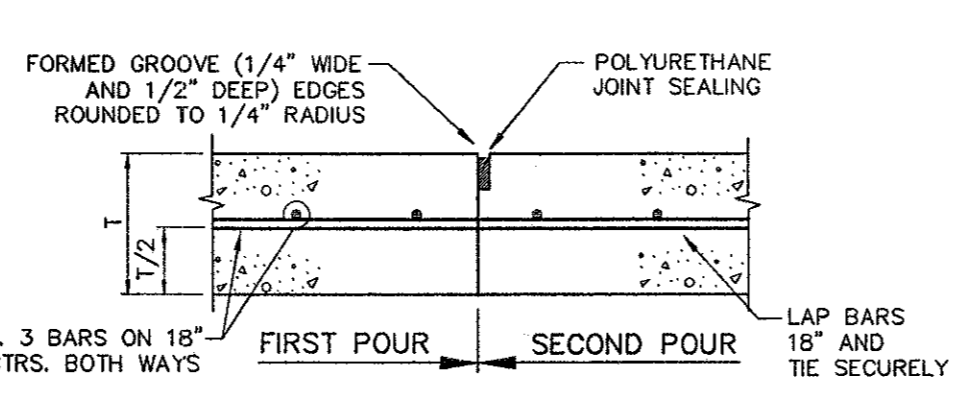

**7 CONSTRUCTION JOINT**  
NOT TO SCALE

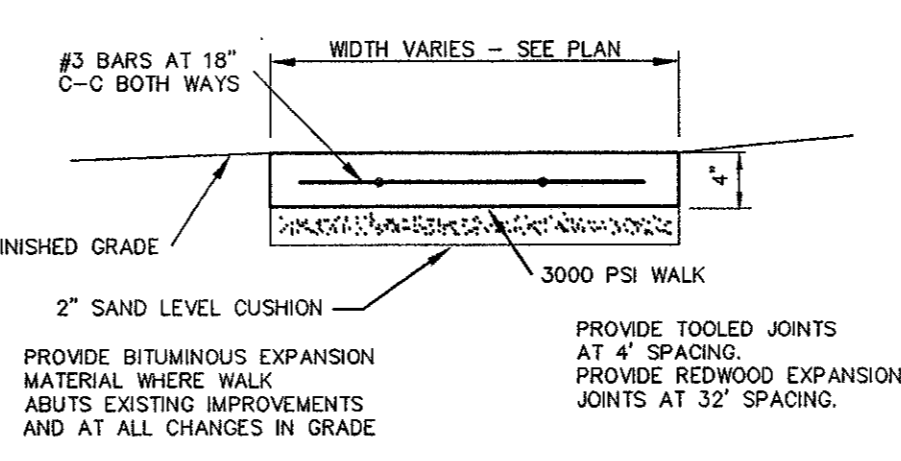

**8 CONCRETE WALK**  
NOT TO SCALE

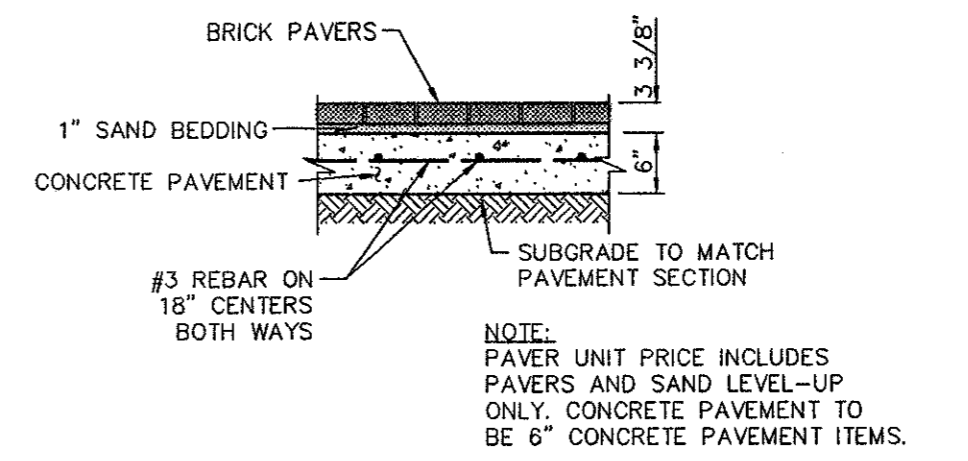

**9 BRICK PAVER SECTION**  
NOT TO SCALE

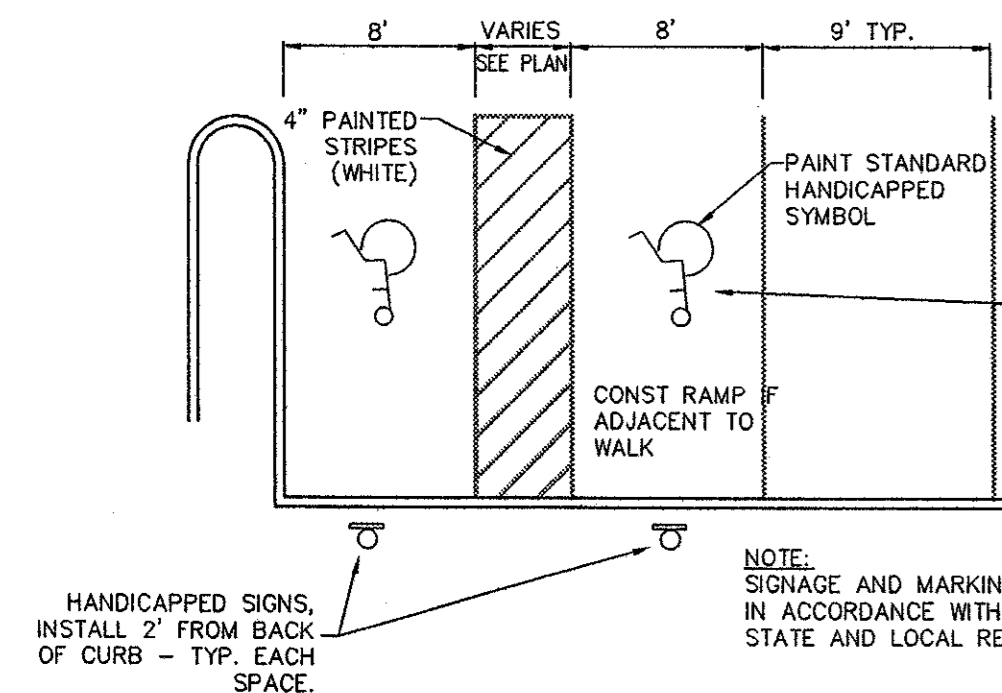

**10 HANDICAPPED PARKING LAYOUT**

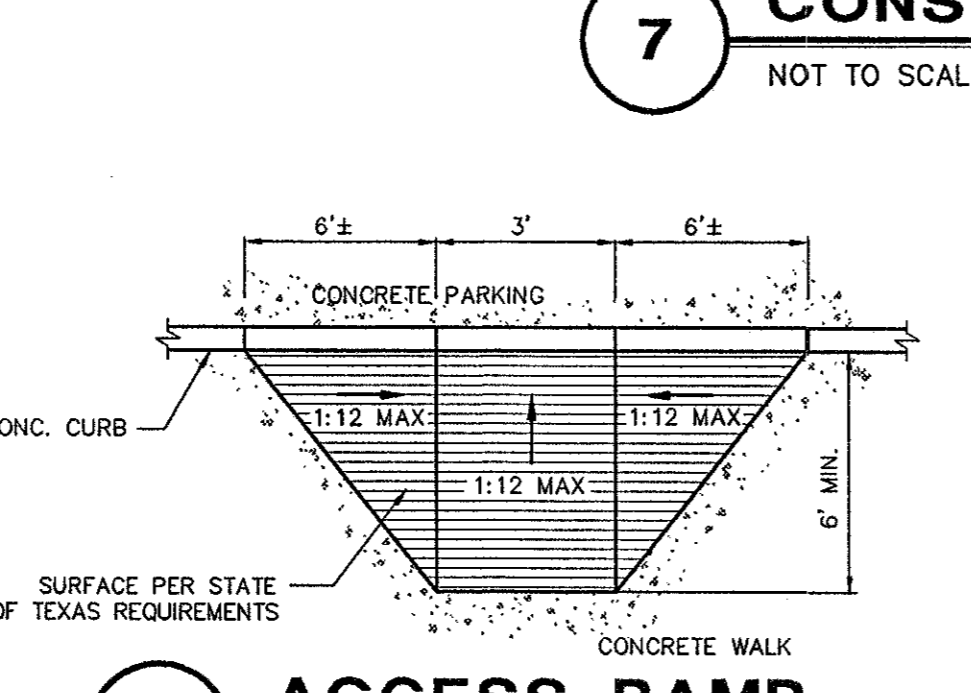

**11 ACCESS RAMP**  
NOT TO SCALE

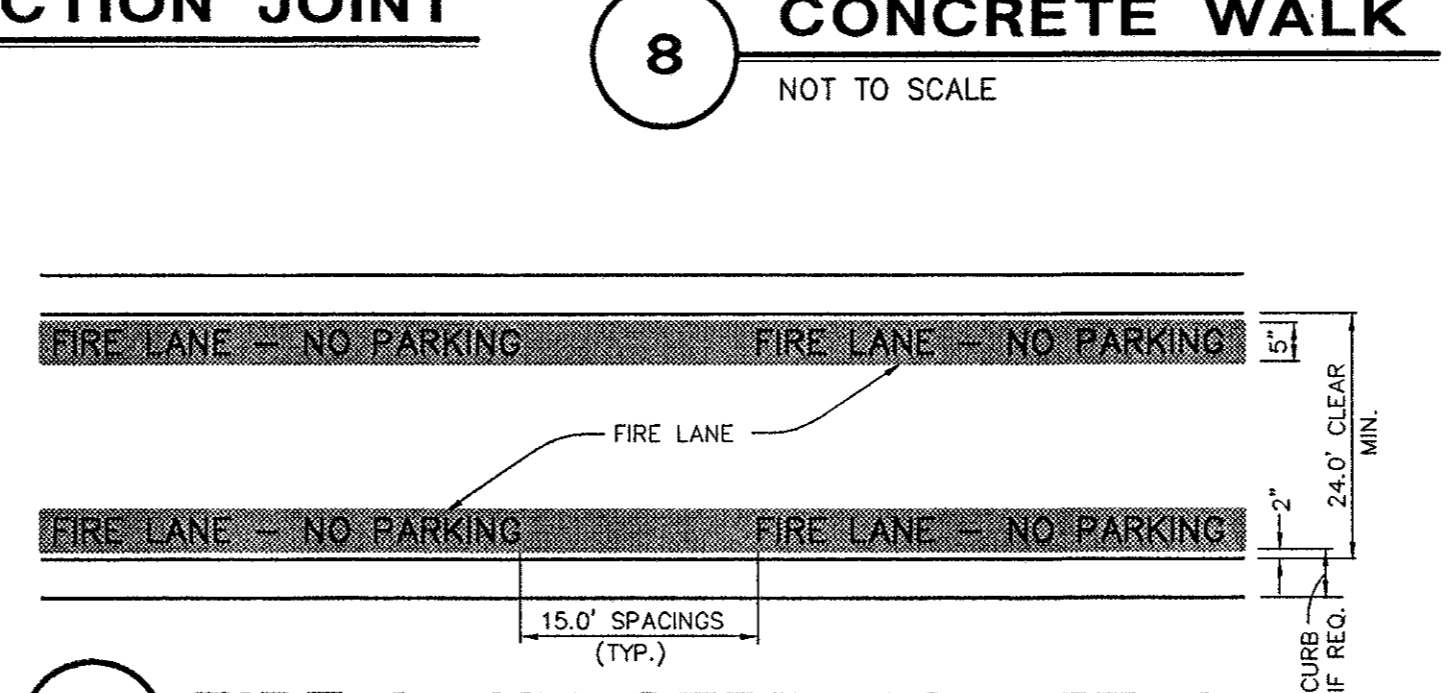

**12 FIRE LANE STRIPING DETAIL**

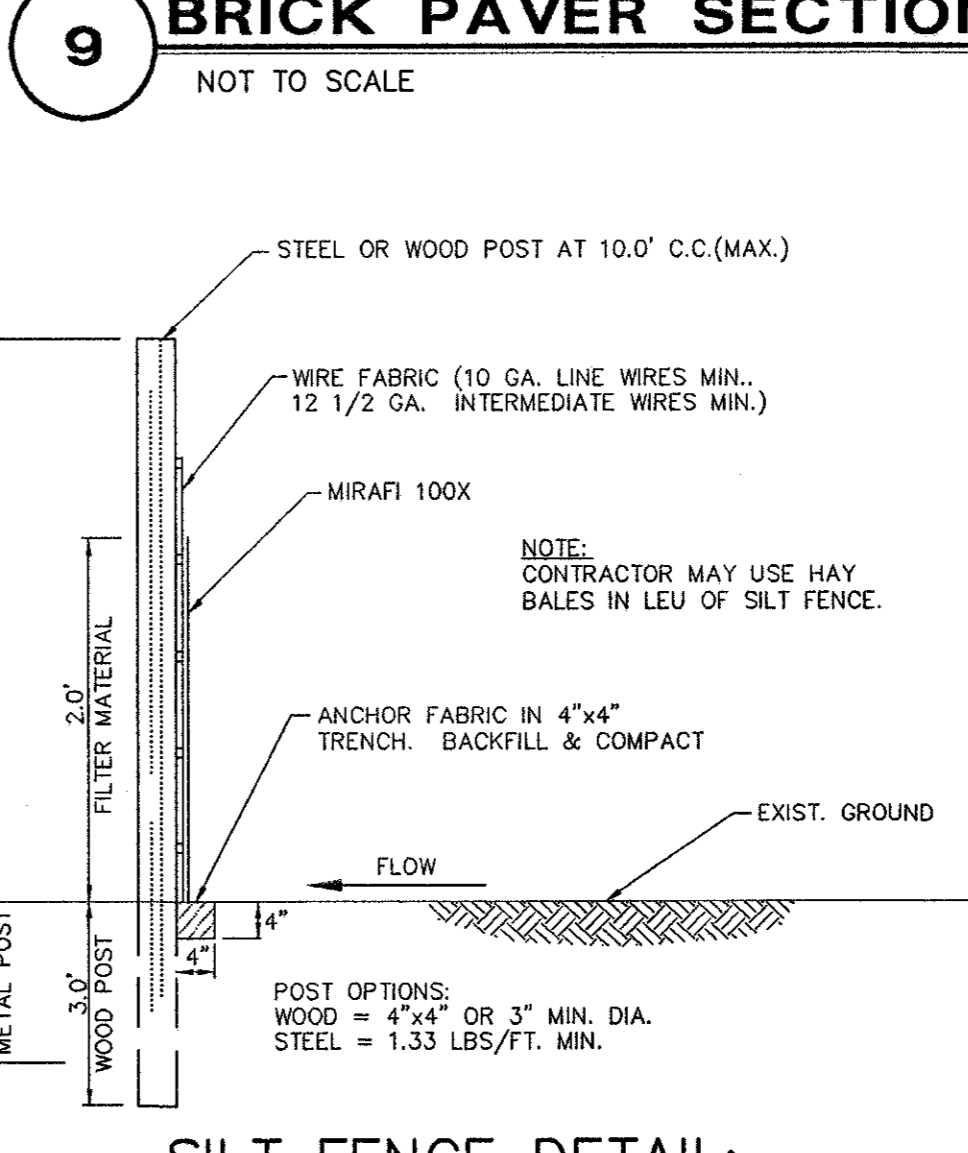

**SILT FENCE DETAIL:**  
TYPICAL TEMPORARY FILTER FABRIC WITHOUT WIRE FABRIC  
N.T.S.

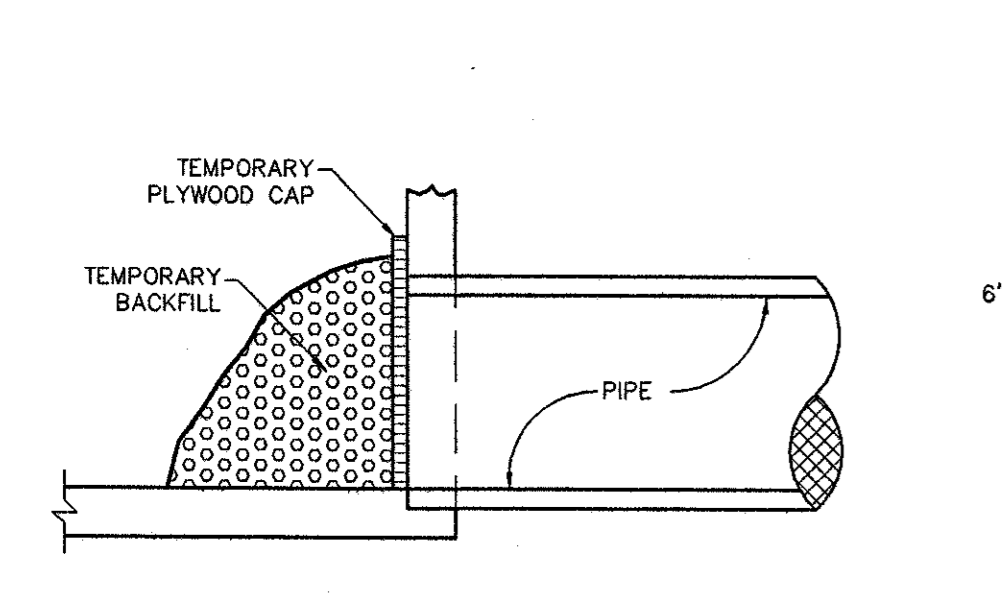

**PHASE ONE CURB INLET PROTECTION**  
N.T.S.

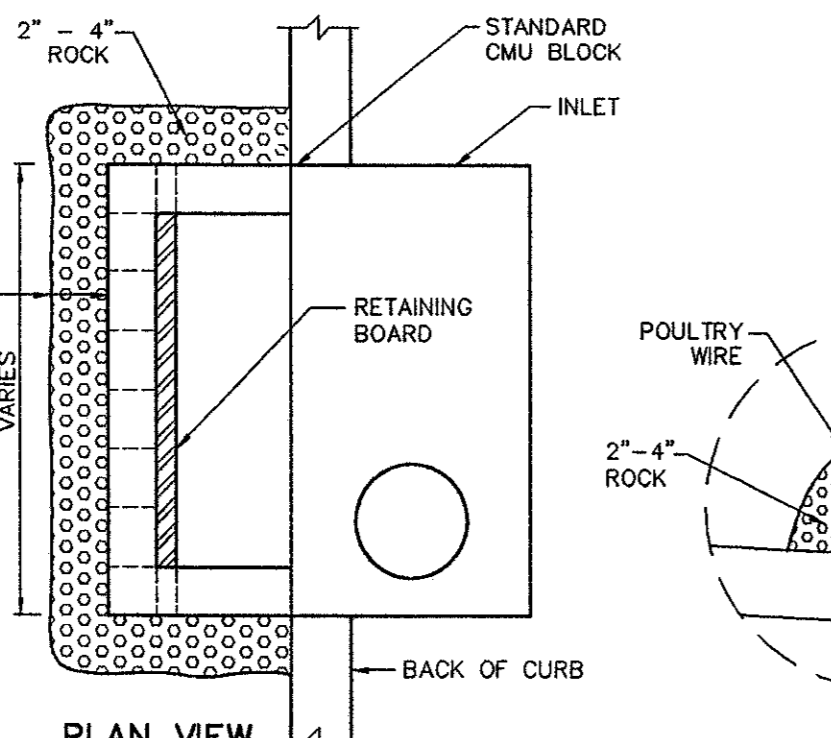

**PHASE TWO CURB INLET PROTECTION**  
N.T.S.

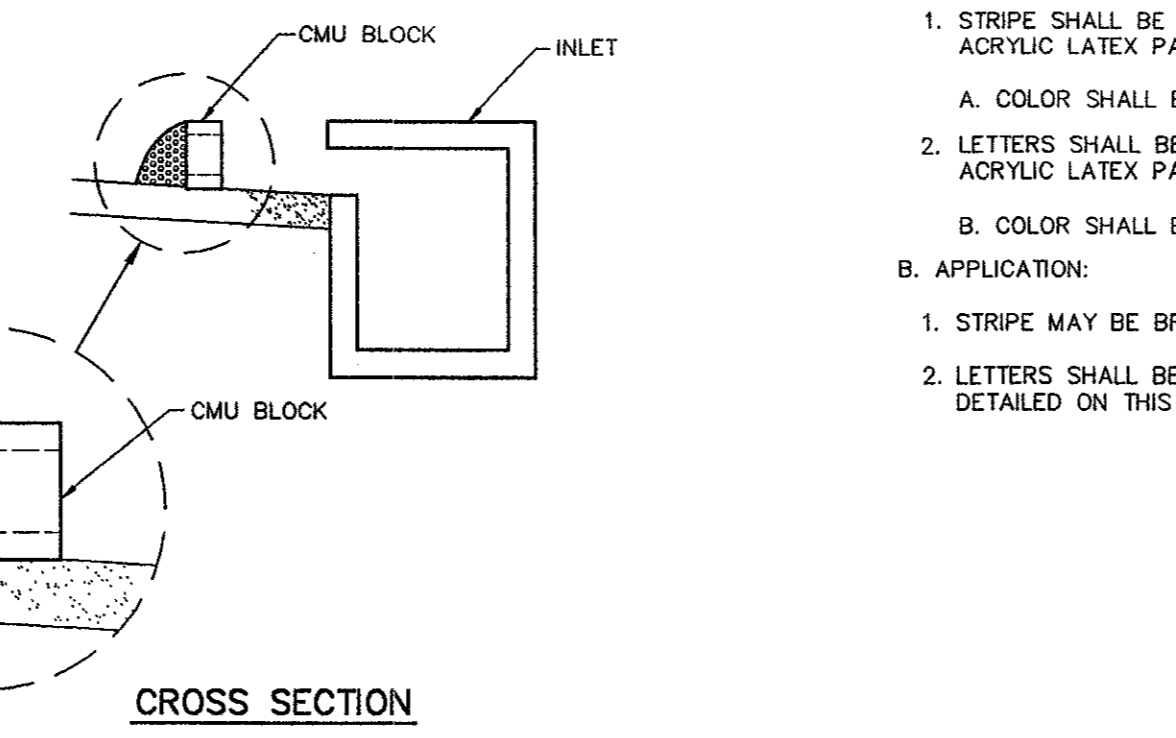

**ALTERNATE 1 CURB INLET PROTECTION**  
N.T.S.

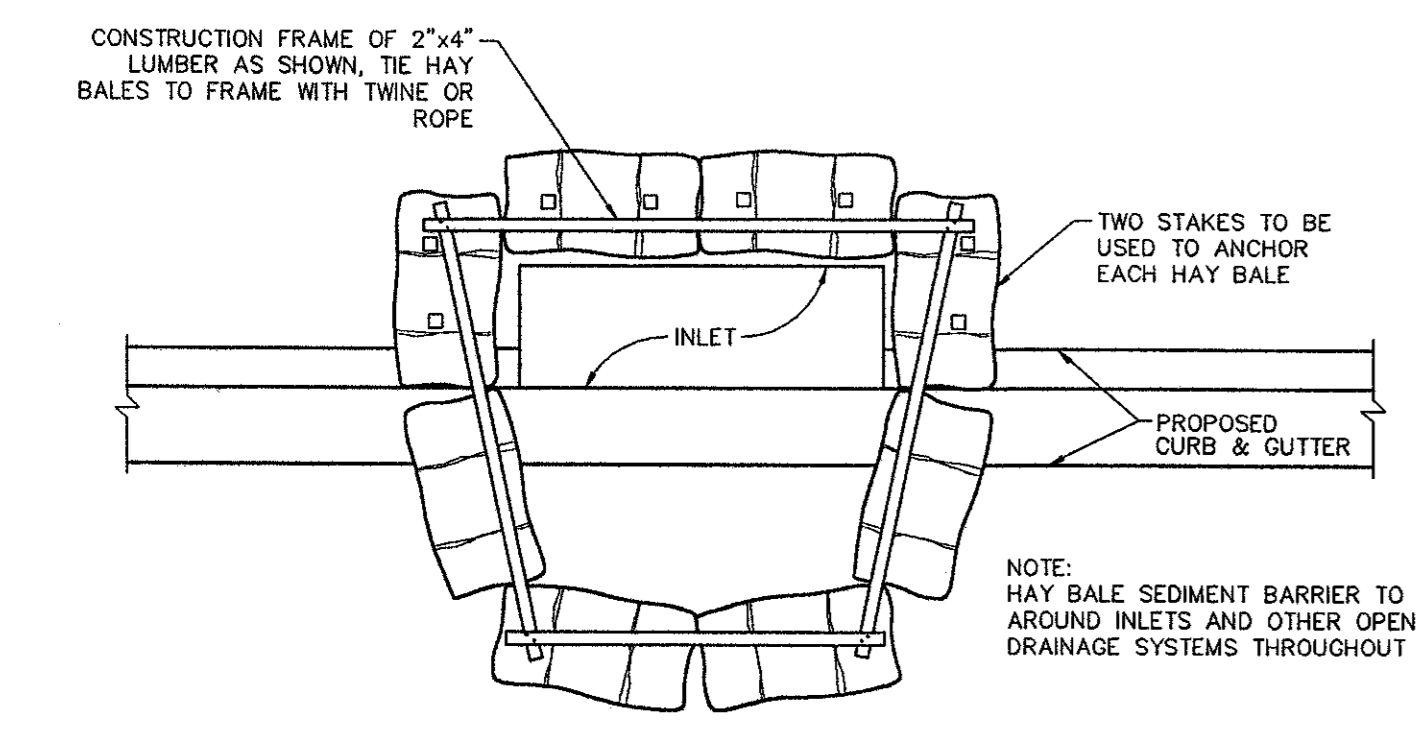

**ALTERNATE 2 CURB INLET PROTECTION**  
N.T.S.

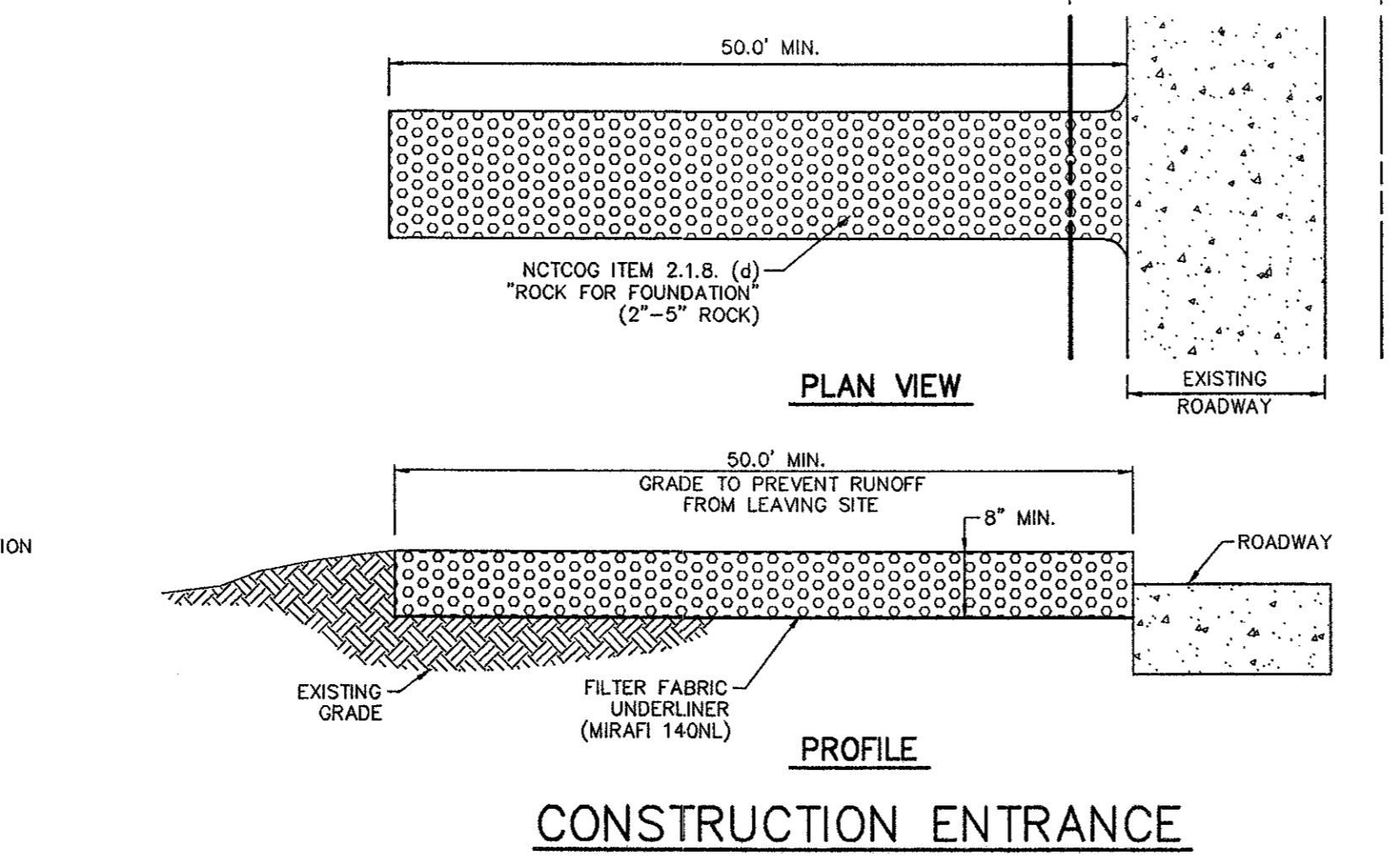

**CONSTRUCTION ENTRANCE**  
N.T.S.

**LIGHT TRAFFIC (PARKING AREAS)**  
PORTLAND CEMENT CONCRETE T = 5"  
LIME STABILIZED SUBGRADE T = 6"

**HEAVY TRAFFIC (FIRELANES)**  
PORTLAND CEMENT CONCRETE T = 6"  
LIME STABILIZED SUBGRADE T = 6"

**MAX. JOINT SPACING**  
90' C-C EACH WAY  
OR AS NOTED ON PLAN AS "E.U."

**24\"/>**

**PAVING AND DRAINAGE GENERAL NOTES**

- ALL WORK, UNLESS OTHERWISE NOTED, SHALL CONFORM TO THE STANDARD SPECIFICATIONS FOR PUBLIC WORKS CONSTRUCTION, ISSUED BY THE NORTH CENTRAL TEXAS COUNCIL OF GOVERNMENTS, AND TOWN OF ADDISON STANDARD CONSTRUCTION SPECIFICATIONS.
- UNLESS OTHERWISE NOTED, ALL CONCRETE SHALL BE CLASS "A", (3000 PSI).
- THE HORIZONTAL AND VERTICAL LOCATIONS OF EXISTING SUBSURFACE UTILITIES HAVE BEEN DETERMINED FROM DATA RECORDED BY OTHERS. CONTRACTOR SHALL VERIFY THAT NECESSARY CROSSING CLEARANCES BETWEEN EXISTING AND PROPOSED UTILITIES EXIST PRIOR TO CONSTRUCTION OF ANY SUCH CROSSING. IT WILL BE THE RESPONSIBILITY OF THE CONTRACTOR TO PROTECT ALL PUBLIC UTILITIES IN THE CONSTRUCTION OF THIS PROJECT.
- CONTRACTOR SHALL MAINTAIN ONE SET OF "RECORD DRAWINGS" ON SITE WHICH WILL BE SUBMITTED TO OWNER OR ENGINEER UPON COMPLETION OF THE PROJECT. RECORD DRAWINGS SHALL INDICATE THE LOCATION OF ALL SUBTERRANEAN UTILITY IMPROVEMENTS, AND INDICATE TIES TO ALL MANHOLES, CULVERTS, INLETS, JUNCTION BOXES, ETC.
- THE CONTRACTOR IS RESPONSIBLE FOR COMPLIANCE WITH ALL FEDERAL, STATE AND LOCAL REGULATIONS REGARDING TRENCH SAFETY.
- STORM DRAIN LINES MAY BE OF THE FOLLOWING:
  - RCP C-76, CLASS III (RCP ONLY UNDER PAVEMENT)
  - ADS N-12 (DO NOT USE UNDER PAVEMENT)
  - HANCOR HI-Q (DO NOT USE UNDER PAVEMENT)
 INSTALLED IN ACCORDANCE WITH MANUFACTURER'S RECOMMENDATIONS.
- BARRICADING AND PROJECT SIGNS SHALL CONFORM TO STATE DEPARTMENT OF HIGHWAYS AND PUBLIC TRANSPORTATION BARRICADING AND CONSTRUCTION STANDARDS.
- PRIOR TO COMMENCEMENT OF CONSTRUCTION, BONDS AND THREE-WAY CONTRACTS SHALL BE SUBMITTED TO THE CITY AS REQUIRED.
- CONCRETE PAVEMENT PLACED BY A PAVING MACHINE SHALL BE AT LEAST 3000 PSI. PAVEMENT HAND POURED SHALL BE AT LEAST 3600 PSI. NO FL ASH ALLOWED IN MIX DESIGN, WHICH MUST BE SUBMITTED FOR TOWN'S APPROVAL.
- DEPTH OF SAWED AND CONSTRUCTION JOINTS SHOULD BE ONE-FOURTH OF PAVEMENT THICKNESS.
- ALL CURB INLETS AND MANHOLES SHALL BE CAST IN PLACE. CATCH BASINS MAY BE PRE-CAST.
- LINER FOR POND SHOULD CONSIST OF AT LEAST TWO NINE INCH (2-9") THICK COMPACTED LIFTS OF NEAR SURFACE CLAY FREE OF ROCK PARTICLES. EACH LIFT SHOULD BE INDIVIDUALLY COMPACTED TO A DENSITY EQUIVALENT OR HIGHER THAN 95 PERCENT OF THE STANDARD PROCTOR DENSITY AT A MOISTURE CONTENT HIGHER THAN OPTIMUM.

**WATER AND SANITARY SEWER GENERAL NOTES**

- ALL WORK, UNLESS OTHERWISE NOTED, SHALL CONFORM TO THE STANDARD SPECIFICATIONS FOR PUBLIC WORKS CONSTRUCTION, ISSUED BY THE NORTH CENTRAL TEXAS COUNCIL OF GOVERNMENTS, AND TOWN OF ADDISON STANDARD CONSTRUCTION SPECIFICATIONS.
- UNLESS OTHERWISE NOTED, ALL CONCRETE SHALL BE CLASS "A", (3000 PSI).
- THE HORIZONTAL AND VERTICAL LOCATIONS OF EXISTING SUBSURFACE UTILITIES HAVE BEEN DETERMINED FROM DATA RECORDED BY OTHERS. CONTRACTOR SHALL VERIFY THAT NECESSARY CROSSING CLEARANCES BETWEEN EXISTING AND PROPOSED UTILITIES EXIST PRIOR TO CONSTRUCTION OF ANY SUCH CROSSING. IT WILL BE THE RESPONSIBILITY OF THE CONTRACTOR TO PROTECT ALL PUBLIC UTILITIES IN THE CONSTRUCTION OF THIS PROJECT.
- CONTRACTOR SHALL MAINTAIN ONE SET OF "RECORD DRAWINGS" ON SITE WHICH WILL BE SUBMITTED TO OWNER OR ENGINEER UPON COMPLETION OF THE PROJECT. RECORD DRAWINGS SHALL INDICATE THE LOCATION OF ALL SUBTERRANEAN UTILITY IMPROVEMENTS, AND INDICATE TIES TO ALL MANHOLES, CULVERTS, INLETS, JUNCTION BOXES, ETC.
- ALL WATER MAINS SHALL BE PVC C-900, OR DR 18, CLASS 150.
- ALL WATER MAINS UNLESS OTHERWISE NOTED SHALL HAVE A MINIMUM COVER OF 48" BELOW FINISHED GRADE.
- SANITARY SEWER PIPE SHALL BE ASTM 2241 OR PVC C-900.
- THE CONTRACTOR IS RESPONSIBLE FOR COMPLIANCE WITH ALL FEDERAL, STATE AND LOCAL REGULATIONS REGARDING TRENCH SAFETY.
- BARRICADING AND PROJECT SIGNS SHALL CONFORM TO "STATE DEPARTMENT OF HIGHWAYS AND PUBLIC TRANSPORTATION BARRICADING AND CONSTRUCTION STANDARDS."
- PRIOR TO COMMENCEMENT OF CONSTRUCTION, BONDS AND THREE-WAY CONTRACTS SHALL BE SUBMITTED TO THE CITY AS REQUIRED.
- WHERE A SANITARY SEWER PARALLELS A WATERLINE, THE SEWER SHALL BE CONSTRUCTED AS ASTM 2241 OR PVC C-900 SPECIFICATIONS WITH A PRESSURE RATING FOR BOTH THE PIPE AND JOINTS OF 150 PSI. THE VERTICAL SEPARATION SHALL BE MINIMUM OF TWO FEET BETWEEN OUTSIDE DIAMETERS AND THE HORIZONTAL SEPARATION SHALL BE A MINIMUM OF FOUR FEET BETWEEN OUTSIDE DIAMETERS. THE SEWER SHALL BE LOCATED BELOW THE WATERLINE.
- VALVES SHALL BE RESILIENT SEAT.

**POLLUTION CONTROL GENERAL NOTES**

- THIS PLAN HAS BEEN PREPARED TO PROVIDE MEANS TO PREVENT OR MINIMIZE POLLUTION OF STORM WATER.
- THE CONSTRUCTION ACTIVITY INCLUDED IN THIS PLAN WILL INCLUDE:
  - CLEARING AND GRUBBING
  - ROUGH GRADING
  - FINAL GRADING
  - UTILITY INSTALLATION
  - PAVEMENT INSTALLATION
  - BUILDING CONSTRUCTION
- THE TOTAL ESTIMATED LAND AREA TO BE DISTURBED IS 6.5 ACRE.
- THE ESTIMATED RUNOFF COEFFICIENT UPON COMPLETION OF THE PROJECT IS 0.80%.
- THE STORM WATER EXITING THE SITE IS COLLECTED IN AN EXISTING DRAINAGE SYSTEM MAINTAINED BY THE TOWN OF ADDISON, TEXAS.
- THE SOILS ON THE SITE ARE GENERALLY EXPANSIVE CLAYS.
- THE CONTRACTOR SHALL PROVIDE EROSION PROTECTION AROUND THE WORK AREA PERIMETER AND AT ALL INLET MOUTHS DURING CONSTRUCTION.
- THE CONTRACTOR WILL REMOVE ALL EXCESS SOIL FROM CONSTRUCTION VEHICLES PRIOR TO EXITING THE SITE.
- ALL DISTURBED AREAS WHICH WILL NOT BE RE-DISTURBED FOR A MINIMUM OF 21 DAYS MUST BE STABILIZED BY THE CONTRACTOR TO CONTROL EROSION.
- THE CONTRACTOR SHALL UNDERTAKE PROPER METHODS TO REDUCE DUST GENERATION FROM THE SITE.
- THE CONTRACTOR MUST COMPLY WITH FEDERAL, STATE AND LOCAL REGULATIONS REGARDING SEDIMENT AND EROSION CONTROL.
- A COPY OF THIS PLAN MUST BE KEPT AT THE CONSTRUCTION FACILITY DURING THE ENTIRE CONSTRUCTION PERIOD.

**RECORD DRAWING**

THIS DRAWING HAS BEEN REVISED TO REFLECT CONSTRUCTION RECORDS MAINTAINED AND PROVIDED BY THE CONTRACTOR FOR THIS PROJECT.

CONTRACTOR: THE HUBBLE GROUP  
DATE REVISED: 11/10/98



THIS DOCUMENT IS FOR THE PURPOSE OF INTERIM REVIEW UNDER THE AUTHORITY OF JAMES A. KOCH JR., P.E. 62218 ON 12/16/96. IT IS NOT TO BE USED FOR CONSTRUCTION, BIDDING OR PERMIT PURPOSES.

**PACHECO KOCH Consulting Engineers, Inc.** 9401 LBJ Freeway, Suite 300 Dallas, Texas 75243  
Civil Engineering • Land Surveying (972) 235-3031

**DETAIL SHEET**

**TOWNE LAKE ADDITION**

**THOMAS L. CHENOWETH SURVEY**

**ABSTRACT No. 273**

**TOWN OF ADDISON, TEXAS**

DESIGN	DRAWN	DATE	SCALE	NOTES	FILE	NO.
JAK	BB	12/16/96	1"=40'			C-6.1

PK NO: 1664-96.112 DWG NO: 1664-96.112