

VILLAGE ON THE PARKWAY

5100 BELT LINE ROAD

Addison, Texas 75254

McInnish Engineering, PLLC
 10601 FM 2225, Suite 8-128
 Addison, TX 75001
 Dallas: 214.613.0591

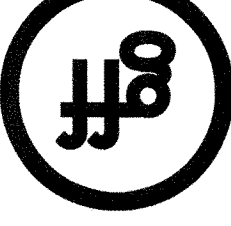

Good Fulton & Farrell Architects
 2808 Fairmount Street
 Dallas, Texas 75201
 214.303.1500/Fax
 214.303.1512/Fax
 www.gff.com
 © Good Fulton & Farrell 2009

No.	Date	Item	Revisions
1	06.14.12	Addendum #2	
2	08.17.12	ASI #1	
3			
4			
5			
6			
7			
8			
9			
10			
11			
12			
13			
14			
15			
16			
17			
18			
19			
20			
21			
22			
23			
24			
25			
26			
27			
28			
29			
30			
31			
32			
33			
34			
35			
36			
37			
38			
39			
40			
41			
42			
43			
44			
45			
46			
47			
48			
49			
50			

BBM
 Drawn
BBM
 Checked
BBM
 Approved

FLOOR PLAN - NORTH
PLUMBING

Project No. 11013.03
 Date 05.25.12
 Last Revision 08.17.12
P2.01

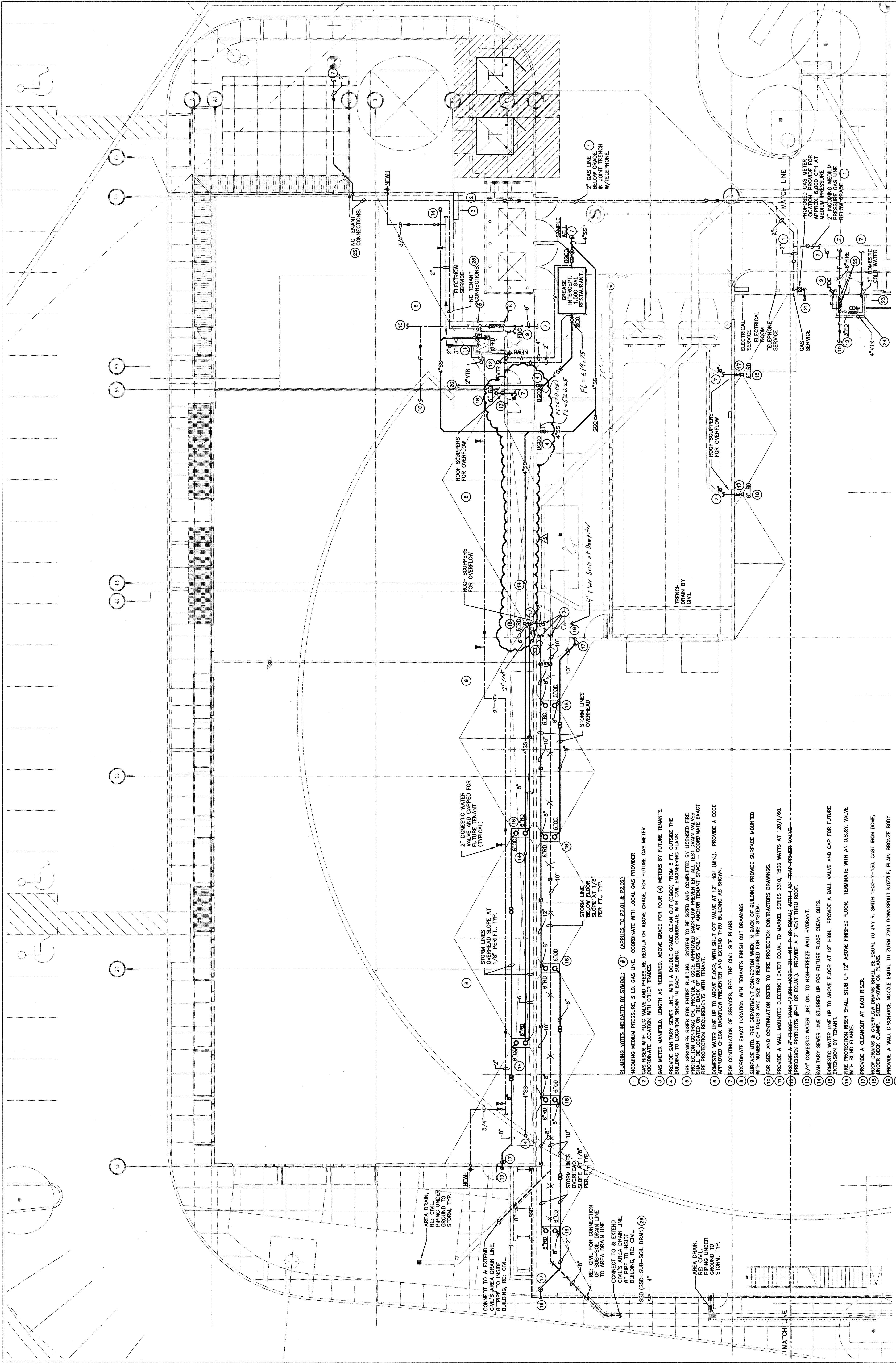

- PLUMBING NOTES INDICATED BY SYMBOL:**
- (1) INCOMING MEDIUM PRESSURE, 5 LB. GAS LINE. COORDINATE WITH LOCAL GAS PROVIDER.
 - (2) GAS RISER WITH FLOOR VALVE AND PRESSURE REGULATOR ABOVE GRADE, FOR FUTURE GAS METER.
 - (3) GAS METER MANIFOLD, LENGTH AS REQUIRED, ABOVE GRADE FOR FOUR (4) METERS BY FUTURE TENANTS.
 - (4) PROVIDE SANITARY SEWER LINE WITH A DOUBLE GRADE CLEAN OUT (DGO) FROM 5 FT. OUTSIDE THE BUILDING TO LOCATION SHOWN IN EACH BUILDING. COORDINATE WITH CIVIL ENGINEERING PLANS.
 - (5) FIRE SPRINKLER RISER FOR ENTIRE BUILDING. SYSTEM TO BE SIZED AND COMPLETED BY LICENSED FIRE UNDERWRITER'S REQUIREMENTS. PROVIDE STANDARD RETAIL COVERAGE OF ONE SPRINKLER HEAD PER EVERY APPROXIMATE 1500 SQ. FT. OF FLOOR AREA. PROVIDE A 2" VENT THRU ROOF.
 - (6) DOMESTIC WATER LINE UP TO ABOVE FLOOR, WITH SHUT OFF VALVE AT 12" HIGH (MIN.). PROVIDE A CODE APPROVED CHECK BACKFLOW PREVENTER AND EXTEND THRU BUILDING AS SHOWN.
 - (7) FOR CONTINUATION OF SERVICES, REF. THE CIVIL SITE PLANS.
 - (8) COORDINATE EXACT LOCATION WITH TENANT'S FINISH OUT DRAWINGS.
 - (9) SURFACE MTD. FIRE DEPARTMENT CONNECTION WHEN IN BACK OF BUILDING. PROVIDE SURFACE MOUNTED WITH NUMBER OF INLETS AND SIZE AS REQUIRED FOR THIS SYSTEM.
 - (10) FOR SIZE AND CONTINUATION REFER TO FIRE PROTECTION CONTRACTOR'S DRAWINGS.
 - (11) PROVIDE A WALL MOUNTED ELECTRIC HEATER EQUAL TO MARKEL SERIES 3310, 1500 WATTS AT 120V/150.
 - (12) PROVIDE A 3" FLOOR DRAIN (2" DIA. W/ 1/2" SLOPE) WITH 1/2" RAMP-PRIMER VALVE.
 - (13) 3/4" DOMESTIC WATER LINE DN. TO NON-FREEZE WALL HYDRANT.
 - (14) SANITARY SEWER LINE STUBBED UP FOR FUTURE FLOOR CLEAN OUTS.
 - (15) DOMESTIC WATER LINE UP TO ABOVE FLOOR AT 12" HIGH. PROVIDE A BALL VALVE AND CAP FOR FUTURE EXTENSION BY TENANT.
 - (16) FIRE PROTECTION RISER SHALL STUB UP 12" ABOVE FINISHED FLOOR. TERMINATE WITH AN O.S.M.Y. VALVE WITH BLIND FLANGE.
 - (17) PROVIDE A CLEANOUT AT EACH RISER.
 - (18) ROOF DRAIN & OVERFLOW DRAINS SHALL BE EQUAL TO JAY R. SMITH 1800-1-150, CAST IRON DONE UNDER DECK CLAMP. SIZES SHOWN ON PLANS.
 - (19) PROVIDE A WALL DISCHARGE NOZZLE EQUAL TO ZURN Z199 DOWNSPOUT NOZZLE, PLAIN BRONZE BODY.
 - (20) CAP AND MARK THE END OF GREASE WASTE LINE FOR FUTURE CONNECTION.
 - (21) VALVE AND CAP 2" MEDIUM PRESSURE GAS LINE FOR FUTURE EXTENSION BY THE TENANT.
 - (22) FIRE SPRINKLER RISER FOR WHOLE FOODS. SYSTEM TO BE SIZED AND DESIGNED BY A LICENSED FIRE UNDERWRITER'S REQUIREMENTS. PROVIDE STANDARD RETAIL COVERAGE OF ONE SPRINKLER HEAD PER EVERY APPROXIMATE 1500 SQ. FT. OF FLOOR AREA. PROVIDE A 2" VENT THRU ROOF.
 - (23) PROVIDE A PERFORATED SUB-SOIL DRAIN LINE ON THE WEST PERIMETER OF THE WHOLE FOODS BUILDING. PROVIDE A PERFORATED SUB-SOIL DRAIN LINE ON THE EAST PERIMETER OF THE WHOLE FOODS BUILDING. PROVIDE A PERFORATED SUB-SOIL DRAIN LINE ON THE SOUTH PERIMETER OF THE WHOLE FOODS BUILDING. PROVIDE A PERFORATED SUB-SOIL DRAIN LINE ON THE NORTH PERIMETER OF THE WHOLE FOODS BUILDING. MATERIAL SHALL BE SIMILAR TO 3/4" RIVER ROCK - VERIFY WITH GEOTECH REPORT. INSTALL SUB-SOIL PIPE PER MANUFACTURER'S RECOMMENDATIONS.
 - (24) VALVE AND CAP DOMESTIC WATER LINES FOR EXTENSION BY TENANT. LABEL PIPE CLEARLY AND ON 3 FT. CENTERS. WARNING - NO TENANT CONNECTIONS TO THIS LINE.
 - (25) INCOMING WATER SERVICE. TENANTS SHALL NOT CONNECT TO THIS LINE. LABEL PIPE CLEARLY AND ON 3 FT. CENTERS.
 - (26) PROVIDE A PERFORATED SUB-SOIL DRAIN LINE ON THE WEST PERIMETER OF THE WHOLE FOODS BUILDING. PROVIDE A PERFORATED SUB-SOIL DRAIN LINE ON THE EAST PERIMETER OF THE WHOLE FOODS BUILDING. PROVIDE A PERFORATED SUB-SOIL DRAIN LINE ON THE SOUTH PERIMETER OF THE WHOLE FOODS BUILDING. PROVIDE A PERFORATED SUB-SOIL DRAIN LINE ON THE NORTH PERIMETER OF THE WHOLE FOODS BUILDING. MATERIAL SHALL BE SIMILAR TO 3/4" RIVER ROCK - VERIFY WITH GEOTECH REPORT. INSTALL SUB-SOIL PIPE PER MANUFACTURER'S RECOMMENDATIONS.

AS-BUILT DRAWINGS
 7-19-13

1 FLOOR PLAN - NORTH - PLUMBING
 SCALE: 1/8"=1'-0"



NORTH