

IRRIGATION LEGEND

NO.	DESCRIPTION	SY.	NO.	DESCRIPTION
1	RANDED 1/2" FILL CIRCLE	30	7	075 FULL CIRCLE
2	RANDED 3/4" FILL CIRCLE	31	8	1/2" FULL CIRCLE
3	RANDED 1" FILL CIRCLE	32	9	3/4" FULL CIRCLE
4	POE. - NEW PIPES FOR IRRIGATION PER CIVIL ENGINEER'S PLAN			
5	POE. - NEW PIPES FOR IRRIGATION PER CIVIL ENGINEER'S PLAN			
6	POE. - NEW PIPES FOR IRRIGATION PER CIVIL ENGINEER'S PLAN			
7	POE. - NEW PIPES FOR IRRIGATION PER CIVIL ENGINEER'S PLAN			
8	POE. - NEW PIPES FOR IRRIGATION PER CIVIL ENGINEER'S PLAN			
9	POE. - NEW PIPES FOR IRRIGATION PER CIVIL ENGINEER'S PLAN			
10	POE. - NEW PIPES FOR IRRIGATION PER CIVIL ENGINEER'S PLAN			
11	POE. - NEW PIPES FOR IRRIGATION PER CIVIL ENGINEER'S PLAN			
12	POE. - NEW PIPES FOR IRRIGATION PER CIVIL ENGINEER'S PLAN			
13	POE. - NEW PIPES FOR IRRIGATION PER CIVIL ENGINEER'S PLAN			
14	POE. - NEW PIPES FOR IRRIGATION PER CIVIL ENGINEER'S PLAN			
15	POE. - NEW PIPES FOR IRRIGATION PER CIVIL ENGINEER'S PLAN			
16	POE. - NEW PIPES FOR IRRIGATION PER CIVIL ENGINEER'S PLAN			
17	POE. - NEW PIPES FOR IRRIGATION PER CIVIL ENGINEER'S PLAN			
18	POE. - NEW PIPES FOR IRRIGATION PER CIVIL ENGINEER'S PLAN			
19	POE. - NEW PIPES FOR IRRIGATION PER CIVIL ENGINEER'S PLAN			
20	POE. - NEW PIPES FOR IRRIGATION PER CIVIL ENGINEER'S PLAN			
21	POE. - NEW PIPES FOR IRRIGATION PER CIVIL ENGINEER'S PLAN			
22	POE. - NEW PIPES FOR IRRIGATION PER CIVIL ENGINEER'S PLAN			
23	POE. - NEW PIPES FOR IRRIGATION PER CIVIL ENGINEER'S PLAN			
24	POE. - NEW PIPES FOR IRRIGATION PER CIVIL ENGINEER'S PLAN			
25	POE. - NEW PIPES FOR IRRIGATION PER CIVIL ENGINEER'S PLAN			
26	POE. - NEW PIPES FOR IRRIGATION PER CIVIL ENGINEER'S PLAN			
27	POE. - NEW PIPES FOR IRRIGATION PER CIVIL ENGINEER'S PLAN			
28	POE. - NEW PIPES FOR IRRIGATION PER CIVIL ENGINEER'S PLAN			
29	POE. - NEW PIPES FOR IRRIGATION PER CIVIL ENGINEER'S PLAN			
30	POE. - NEW PIPES FOR IRRIGATION PER CIVIL ENGINEER'S PLAN			

IRRIGATION NOTES

1. 120 VOLT ELECTRICAL POWER OUTLETS FOR CONTROLLERS TO BE PROVIDED BY OTHERS. CONTRACTOR TO BE RESPONSIBLE FOR MAKING HOOP-UP FROM OUTLETS TO CONTROLLERS.
2. ALL WIRE FROM CONTROLLERS TO ELECTRIC VALVES TO BE COPPER. BURNISHED COPPER OR COPPER ALLOY SHALL BE USED. PROVIDE MIN. OF 1" COVER.
3. PROVIDE MIN. 1/2" COVER OVER ALL MAIN LINE PIPING AND 1" COVER OVER ALL LATERAL LINE PIPING.
4. ALL PIPE UNDER PAVED AREAS TO BE PVC SCH. 40. INSTALL PRIOR TO PAVING.
5. THIS DESIGN IS DISCREETIVE. EQUIPMENT SHOWN IN PAVED AREAS IS NEAREST PLANTED AREA WHERE POSSIBLE.
6. CONTRACTOR SHALL FLUSH ALL LINES AND ADJUST ALL HEADS FOR BEST PERFORMANCE AND TO PREVENT OVERSPRAY ONTO WALKS DRIVES AND BUILDINGS AS MUCH AS POSSIBLE. THIS SHALL INCLUDE THE SPRINKLER HEADS. THE BEST DESIGN SHALL BE USED TO FIT BESTING SITE CONDITIONS.
7. INSTALL ALL EQUIPMENT AS SHOWN IN DETAILS.
8. SYSTEM DESIGN IS BASED ON PRESSURES AND GALLONAGES INDICATED AT POINTS OF CONNECTION.
9. DO NOT UNLATERLY INSTALL THE SYSTEM AS DESIGNED WHEN IT IS DETERMINED THAT THERE ARE NOT SUFFICIENT SLOPES OR OTHER CONDITIONS EXIST THAT WOULD NOT ALLOW FOR SUCH CONDITIONS. CONTRACTOR SHALL BRING THIS TO THE ATTENTION OF THE OWNER'S AUTHORIZED REPRESENTATIVE. OTHERWISE, THE IRRIGATION CONTRACTOR SHALL BE RESPONSIBLE FOR ANY AND ALL REVISIONS.
10. FINAL LOCATION OF AUTOMATIC CONTROLLER TO BE DETERMINED BY OWNER'S AUTHORIZED REPRESENTATIVE AND/OR LANDSCAPE ARCHITECT.
11. THE SYSTEM SHALL BE FULLY GUARANTEED FOR A PERIOD OF ONE YEAR. ANY DEFECTIVE MATERIAL OR WORKMANSHIP SHALL BE REPLACED OR CORRECTED BY THE IRRIGATION CONTRACTOR AT NO COST TO THE OWNER.
12. CONTRACTOR TO BE RESPONSIBLE FOR ROBBET CONTROL OF DRIP SYSTEM DURING INSTALLATION AND MAINTENANCE PERIOD.
13. CONTRACTOR IS TO ADJUST IRRIGATION TO WHERE LIGHTING FIXTURES AND OTHER UTILITIES OCCURRED IN FIELD.

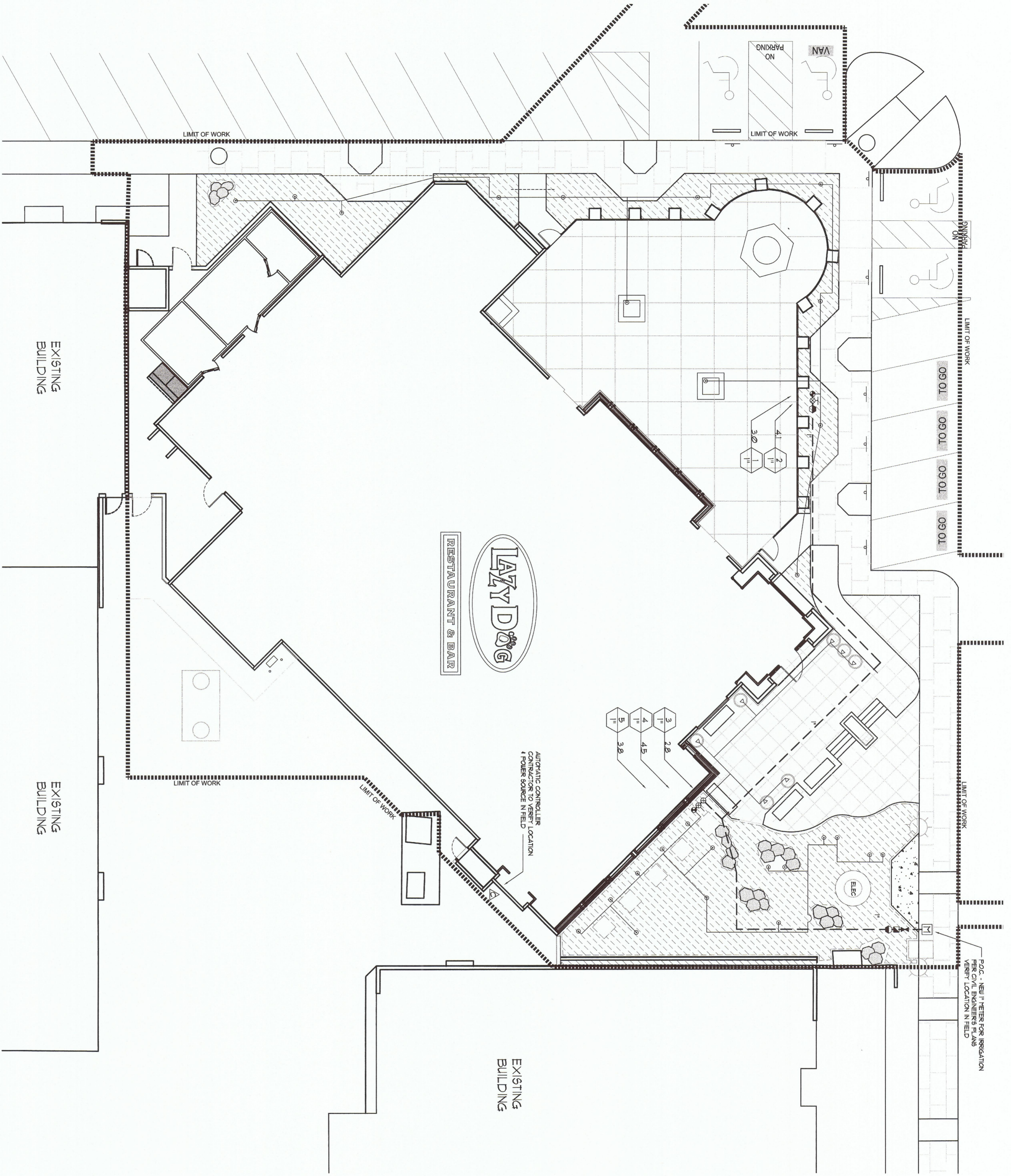

Approved for Constriction
 Town of Addison Parks Dept.
 12.17.14

NORTH
 SCALE: 1/8"=1'-0"
 Drawn By: NS
 Checked By: SSA
 Sheet Number: L-1