

Curve No.	Δ	R	T	L
1	00°09'04"	1014.93'	134'	2.68'
2	01°41'33"	1014.93'	150'	30.0'
3	01°41'38"	1014.93'	150'	30.0'
4	10°01'23"	1014.93'	89.0'	177.55'
5	01°19'14"	1080.93'	12.05'	20.91'
6	10°01'26"	1080.93'	94.80'	189.11'
7	09°02'01"	1144.03'	90.41'	180.44'
8	20°33'32"	100'	10.10'	15.81'
9	20°19'43"	5.0'	6.03'	7.85'
10	BUILT TO MATCH EXIST. C.416			
11	180°00'00"	2.5'	—	7.86'
12	113°03'30"	5.0'	7.56'	9.87'
13	89°43'53"	5.0'	4.98'	7.83'
14	89°37'25"	7.0'	6.95'	10.95'
15	90°22'40"	7.0'	7.05'	11.04'
16	90°16'38"	5.0'	5.02'	7.88'
17	66°28'40"	2.5'	1.64'	2.90'
18	90°00'00"	5.0'	5.0'	7.85'
19	90°00'00"	16.0'	16.0'	25.13'
20	90°00'00"	4.0'	4.0'	6.28'
21	138°03'20"	5.0'	13.06'	12.05'
22	99°14'42"	5.0'	5.88'	8.66'
23	90°00'00"	7.0'	7.0'	11.00'
24	360°00'00"	19.5'	—	122.52'
25	131°57'00"	16.0'	35.80'	36.85'
26	138°03'20"	16.0'	41.74'	38.55'
27	180°00'00"	19.5'	—	61.26'
28	41°57'00"	7.0'	2.68'	5.13'
29	41°57'00"	9.0'	3.45'	6.59'
30	90°28'00"	20.0'	20.0'	31.42'
31	18°33'00"	116.5'	19.03'	37.72'
32	90°00'00"	3.0'	3.0'	4.71'
33	138°03'20"	7.0'	18.26'	16.87'
34	180°00'00"	4.0'	—	12.56'
35	90°00'00"	2.5'	2.5'	3.93'
36	113°31'20"	4.0'	6.10'	7.93'
37	180°00'00"	5.0'	—	15.71'
38	180°00'00"	9.0'	—	28.27'
39	180°00'00"	6.0'	—	18.85'
40	63°20'11"	16.0'	9.87'	17.49'

\* Note: Curve number refer to curves data for curves on this sheet only. Do not use curve data shown in this table for sheets 15 or 16.

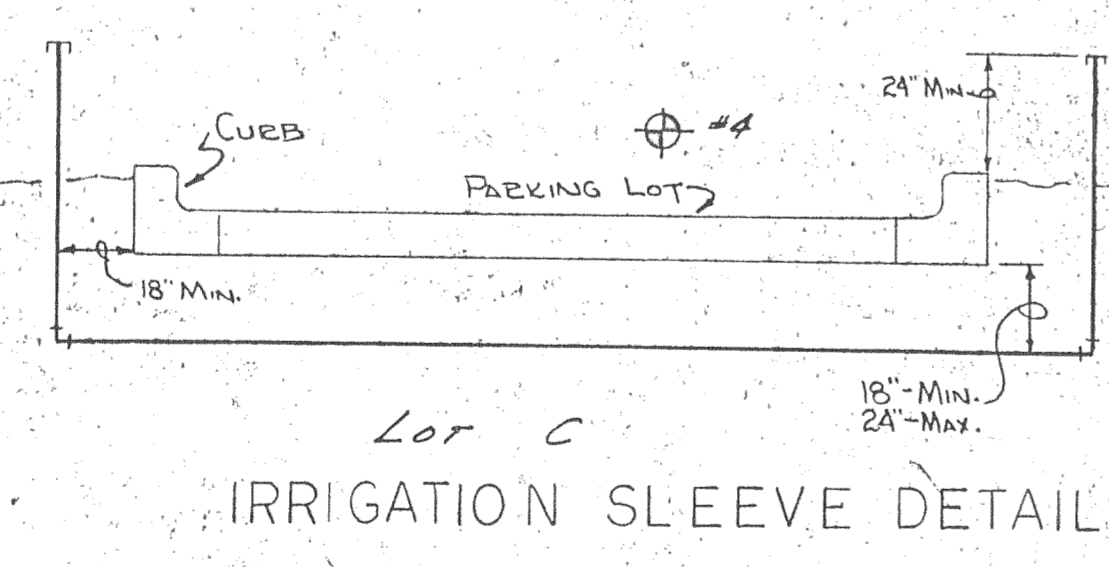
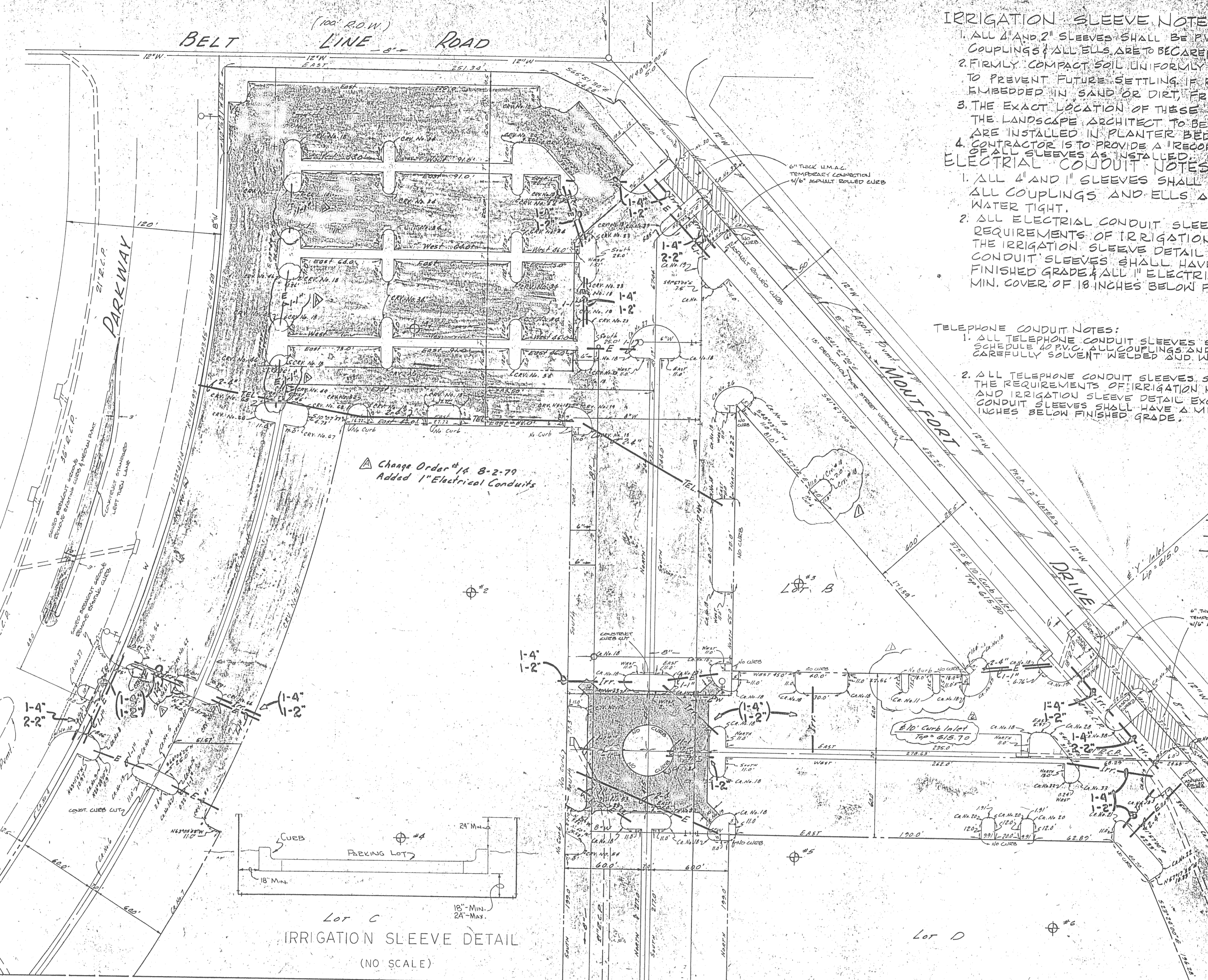

- ### IRRIGATION SLEEVE NOTES:
1. ALL 4" AND 2" SLEEVES SHALL BE PVC PIPE, CLASS 160, SDR 26. ALL COUPLINGS & ALL ELLS ARE TO BE CAREFULLY SOLVENT WELDED AND WATER TIGHT.
  2. FIRMLY COMPACT SOIL UNIFORMLY AROUND PIPE. COMPACT SOIL CAREFULLY TO PREVENT FUTURE SETTLING. IF ROCK IS ENCOUNTERED, ALL PIPING IS TO BE EMBEDDED IN SAND OR DIRT, FREE OF ROCK AND DEBRIS.
  3. THE EXACT LOCATION OF THESE SLEEVES MUST BE CO-ORDINATED WITH THE LANDSCAPE ARCHITECT TO BE SURE THAT THE ENDS OF ALL SLEEVES ARE INSTALLED IN PLANTER BED AREAS.
  4. CONTRACTOR IS TO PROVIDE A "RECORD DRAWING" SHOWING DIMENSIONAL LOCATION OF ALL SLEEVES AS INSTALLED.

- ### ELECTRICAL CONDUIT NOTES:
1. ALL 4" AND 1" SLEEVES SHALL BE SCHEDULE 40 P.V.C.
  2. ALL ELECTRICAL CONDUIT SLEEVES SHALL CONFORM TO THE REQUIREMENTS OF IRRIGATION NOTES 2, 3, & 4 ABOVE ALONG WITH THE IRRIGATION SLEEVE DETAIL EXCEPT THAT ALL 4" ELECTRICAL CONDUIT SLEEVES SHALL HAVE A MIN. COVER OF 42 INCHES BELOW FINISHED GRADE & ALL 1" ELECTRICAL CONDUIT SLEEVES SHALL HAVE A MIN. COVER OF 18 INCHES BELOW FINISHED GRADE.

- ### TELEPHONE CONDUIT NOTES:
1. ALL TELEPHONE CONDUIT SLEEVES SHALL BE 1" DIAM. SCHEDULE 40 P.V.C. ALL COUPLINGS AND ELLS ARE TO BE CAREFULLY SOLVENT WELDED AND WATER TIGHT.
  2. ALL TELEPHONE CONDUIT SLEEVES SHALL CONFORM TO THE REQUIREMENTS OF IRRIGATION NOTES 2, 3, & 4 ABOVE AND IRRIGATION SLEEVE DETAIL EXCEPT THAT ALL TELEPHONE CONDUIT SLEEVES SHALL HAVE A MINIMUM COVER OF 30 INCHES BELOW FINISHED GRADE.

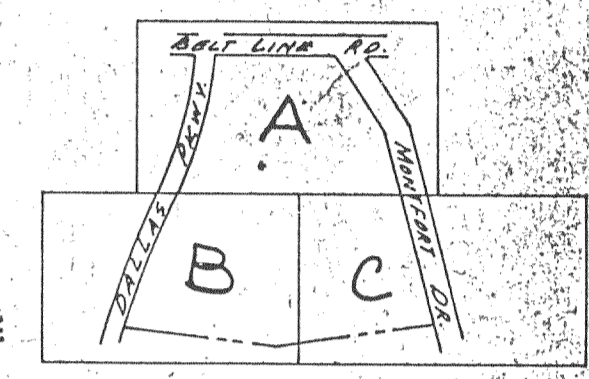

- ### LEGEND
- TEL. TELEPHONE CONDUIT SLEEVE
  - E ELECTRICAL CONDUIT SLEEVE
  - Irr. IRRIGATION CONDUIT SLEEVE

NOTE: THIS DRAWING TO BE USED FOR SLEEVE LOCATIONS ONLY.

- NOTE: ALL DIMENSIONS ARE TO BACK OF CURB.
- ALL CURBS SHALL BE STANDARD OR CONCRETE INTEGRAL CURBS UNLESS OTHERWISE NOTED.
  - BOUNDMATE FINISH
  - HOT MIX ASPHALTIC CONCRETE 1.5" THICK
  - STANDARD REINFORCED CONCRETE PAVEMENT W/ INTEGRAL CURBS
- Change Order # 1-2-79 Shows relocation of entrance @ south side lot B; Addition of island @ N.E. side lot B.
- Change Order # 5 2-16-78 Shows revised elevation for top of inlet on median south of lot B.

Curve No.	Δ	R	T	L
41	41°57'00"	20.0'	7.67'	14.64'
42	131°47'00"	5.0'	11.82'	11.51'
43	86°10'40"	7.0'	6.55'	10.53'
44	93°19'20"	7.0'	7.48'	11.06'
45	82°32'34"	7.0'	6.18'	10.08'
46	97°27'26"	7.0'	7.98'	11.91'
47	02°03'52"	1080.93'	14.88'	38.95'
48	12°40'20"	1080.93'	120.03'	239.07'
49	2°45'09"	1080.93'	7.10'	14.20'
50	89°44'46"	5.0'	4.98'	7.83'

Curve No.	Δ	R	T	L
51	16°47'07"	1128.43'	166.88'	330.58'
52	80°07'27"	10.0'	8.01'	15.78'
53	120°00'00"	5.0'	8.66'	10.47'
54	150°00'00"	5.0'	18.66'	13.09'
55	90°35'16"	10.0'	10.10'	16.81'
56	90°14'43"	5.0'	5.02'	7.88'
57	21°58'05"	1017.43'	197.47'	390.10'
58	89°43'59"	5.0'	4.98'	7.83'
59	47°57'16"	15.54'	6.02'	11.33'
60	89°54'16"	5.0'	4.99'	7.85'

Curve No.	Δ	R	T	L
61	89°35'02"	7.0'	6.95'	10.95'
62	89°43'53"	5.0'	4.98'	7.83'
63	90°21'51"	7.0'	7.04'	11.04'
64	90°16'41"	5.0'	—	—
65	79°38'00"	7.0'	5.84'	9.73'
66	89°43'53"	6.0'	4.98'	7.83'
67	90°30'30"	5.0'	5.04'	7.90'
68	100°07'37"	7.0'	8.36'	12.23'

MATCH LINE SHEET 15

Indicates Soil Boring  
Bench Mark: Standard water dept. bench mark center inlet northwest corner Belt Line Rd. and Dallas Parkway  
ELEV: 632.08

IRRIGATION, TELEPHONE & ELECTRICAL CONDUIT SLEEVE PLAN

VILLAGE ON THE PARKWAY  
VILLAGE PARKWAY VENTURE  
Albert H. Wolff Associates, Inc. Engineers

CITY OF ADDISON, TEXAS

DESIGN	DRAWN	DATE	SCALE	NOTES	FILE	NO.
A.H.H. Assoc.	A.H.H.	April 79	1"=40'	6143		