

Village Parkway Venture July 28, 1978  
 10' Wide Main Extension of Local, The East Side of Dallas Hwy and 100' South of Ball Line Rd.  
 Com'l. Dominions of DALLAS WATER UTILITIES DEPT.  
 1948-1970  
 Prop. Working Space Granted C.O. 78-444 9-12-78  
 Vol. 78-1 Pg. 0720

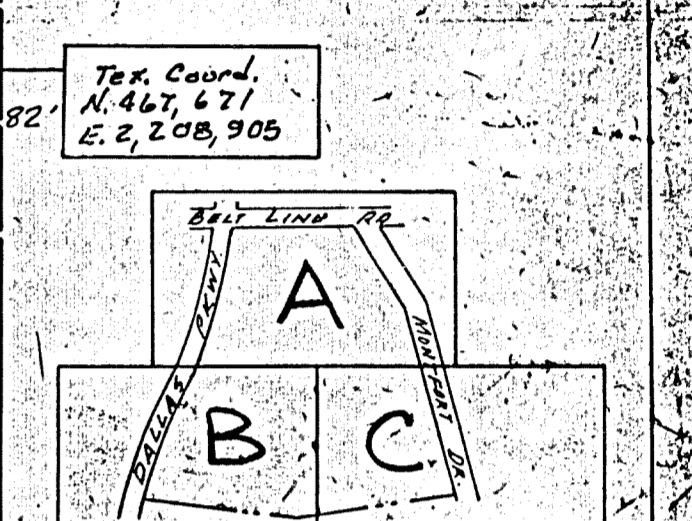

KEY MAP

LOT CORNER COORDINATES

#	Y	X
31	599.786	2448.241
32	716.143	2448.263
33	663.998	1832.0551
34	779.304	1844.281
35	873.083	2072.684
36	1074.196	2072.684
37	1074.196	2199.684
38	863.092	2199.684
39	843.534	2448.284
40	845.835	2477.684
41	1074.196	2477.684
42	1074.196	1803.553
43	899.359	1738.696
44	1074.196	2604.684
45	855.777	2604.684
51	1201.194	2399.684
53	1201.196	2272.684
57	1201.196	1873.314
70	740.099	2143.765
71	624.466	2134.667
72	621.240	2175.541
73	736.883	2184.639
77	724.789	2558.702
78	609.182	2567.765
80	727.989	2599.579
81	729.165	2614.596
84	593.400	2610.113
545	733.150	2614.285

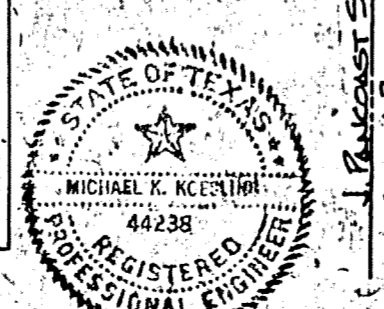
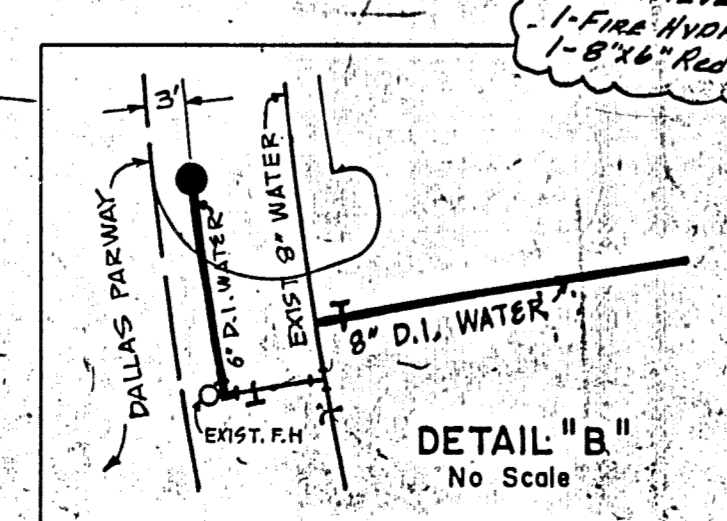
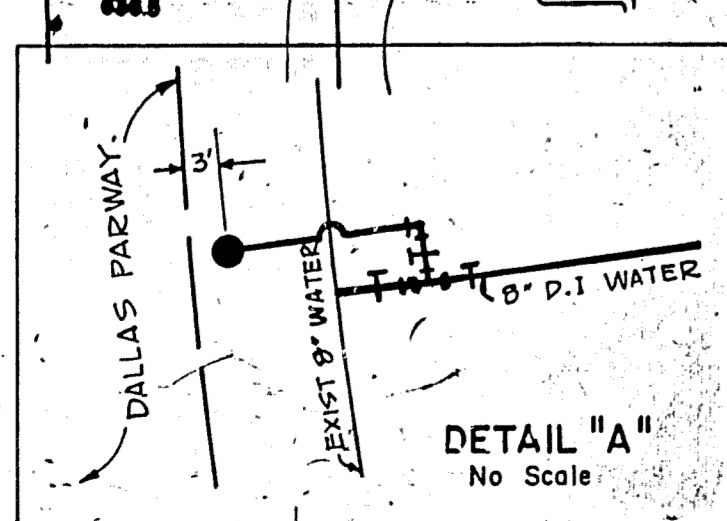

VERDE VALLEY PARKWAY FLAG ADDITION (N+1) BLOCK A B/D  
 BENCHMARK: STANDARD WATER DEPT. BENCHMARK CENTER POINT  
 MAIN CENTER SET LINE RA AND DALLAS PKWY.  
 ELEV. 658.08  
 LOCATION: VILLAGE ON THE PARKWAY - SECOND INSTALLMENT  
 DESIGNED BY: ALBERT H. HALFF ASSOCIATES, INC. DATE: 10-17-78  
 R.O.W. APPROVED BY: DALLAS WATER UTILITIES DEPT. DATE: 10-17-78  
 ENGINEER OF DESIGN: DALLAS WATER UTILITIES DEPT. CONTRACT NO. 78-2319, 78-262P - Shimsion Jan. 25, 1978  
 R. Hal. Approved, Sta. 46 4-12-79 (plh)

DESIGNED BY: ALBERT H. HALFF ASSOCIATES, INC. DATE: 10-17-78  
 R.O.W. APPROVED BY: DALLAS WATER UTILITIES DEPT. DATE: 10-17-78  
 ENGINEER OF DESIGN: DALLAS WATER UTILITIES DEPT. CONTRACT NO. 78-2319, 78-262P - Shimsion Jan. 25, 1978

WATER & SANITARY SEWER PLANS

VILLAGE ON THE PARKWAY  
 VILLAGE PARKWAY VENTURE  
 ALBERT H. HALFF ASSOCIATES, INC. - ENGINEERS  
 CITY OF ADDISON, TEXAS

DESIGN	DRAWN	DATE	SCALE	NOTES	FILE	NO.
ALH	MP	MAR 1978	1"=40'	6148	411G	1960