

MATCHLINE NORTH

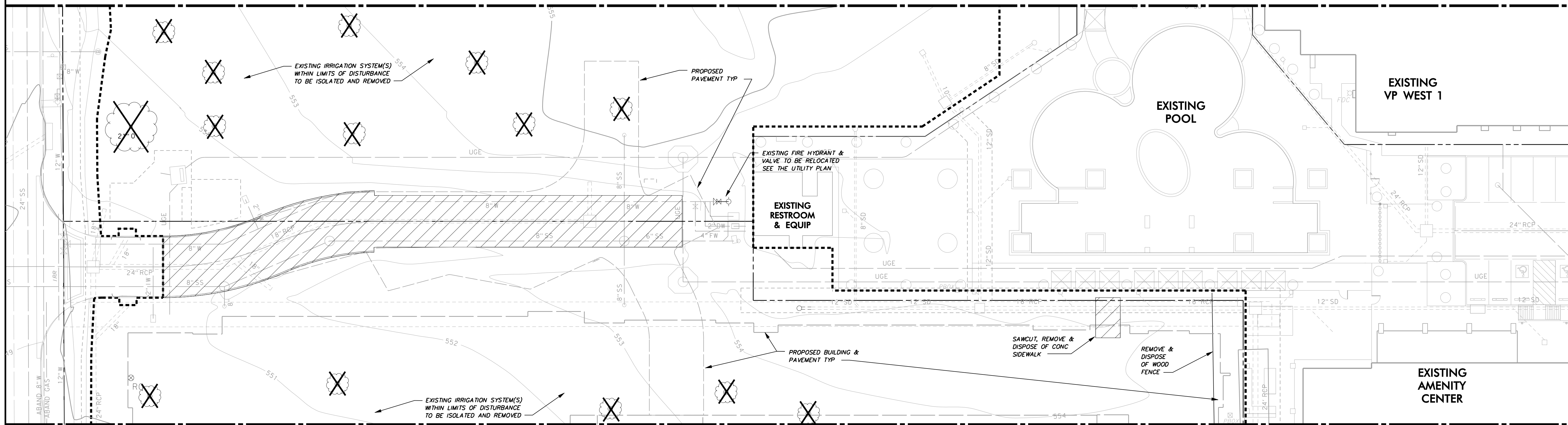

MATCHLINE SOUTH

DEMOLITION NOTES:

- GENERAL CONSTRUCTION NOTES:** REFER TO SHEET C1.00 "GENERAL CONSTRUCTION NOTES, LEGEND AND ABBREVIATIONS" FOR THE GENERAL CONSTRUCTION NOTES FOR THE PROJECT.
- INGRESS AND EGRESS:** THE CONTRACTOR SHALL MAINTAIN INGRESS AND EGRESS TO THE SITE AND ADJACENT PROPERTIES AT ALL TIMES AND CONDUCT HIS OPERATIONS WITH MINIMUM INTERFERENCE TO PUBLIC OR PRIVATE ACCESSES.
- PROTECTION OF EXISTING FACILITIES:** CONTRACTOR SHALL PROVIDE, ERECT, AND MAINTAIN TEMPORARY BARRIERS, FENCING, BRACING AND SHORING, AND SECURITY DEVICES TO PROTECT EXISTING STRUCTURES, UTILITIES, APPURTENANCES, TREES AND LANDSCAPING, AND TO PREVENT MOVEMENT OR SETTLEMENT OF EXISTING STRUCTURES WHICH ARE NOT TO BE DEMOLISHED AND/OR REMOVED.
- STORAGE OF MATERIALS FOR RE-USE:** CONTRACTOR SHALL REMOVE AND STORE ON SITE (WHERE DESIGNATED BY THE DEVELOPER), ALL MATERIALS (SUCH AS ASPHALT AND CONCRETE PAVEMENT & SUITABLE EARTHEN MATERIAL) TO BE SALVAGED OR RE-INSTALLED LATER IN CONSTRUCTION.
- FRANCHISE UTILITY COORDINATION:** THE CONTRACTOR SHALL NOTIFY AND COORDINATE WITH ALL FRANCHISE UTILITY COMPANIES FOR THE REMOVAL AND/OR RELOCATION OF THE RESPECTIVE UTILITY LINES AND APPARATUS USED BY EACH UTILITY. ALL WORK ASSOCIATED WITH FRANCHISE UTILITY REMOVAL RELOCATION AND/OR MODIFICATIONS ARE TO BE PERFORMED ONLY BY THAT UTILITY PROVIDER UNLESS SPECIFICALLY NOTED OTHERWISE.
- TREE REMOVAL:** THE TREES DESIGNATED TO BE REMOVED HAVE A LARGE "X" THROUGH THE TREE SYMBOL. STOCKPILING OF TREES AFTER CUTTING/REMOVAL IS NOT ALLOWED. CONTRACTOR SHALL DISPOSE OF TREE CARCASSES IMMEDIATELY AFTER THEY ARE TAKEN DOWN.
- SAWCUTTING OF EXISTING PAVEMENT:** SAWCUTTING, WHERE INDICATED ON THE DRAWINGS FOR REMOVAL OF EXISTING PAVEMENT, SHALL BE A FULL DEPTH CUT THAT IS NEAT AND TRUE IN ALIGNMENT. SAWCUT LINES SHOWN ARE FOR GENERAL REPRESENTATION ONLY AND MAY VARY DEPENDING ON EXISTING FIELD CONDITIONS OF PAVEMENT JOINTS. CONTRACTOR SHALL REFERENCE GOVERNING AUTHORITY PAVEMENT CUT AND REPAIR STANDARDS MANUAL.
- BACKFILLING:** THE CONTRACTOR SHALL BACKFILL ALL EXCAVATED AREAS CAUSED AS A RESULT OF DEMOLITION, AND PROVIDE POSITIVE DRAINAGE TO PREVENT PONDING OF WATER.
- REMOVAL OF MATERIALS FROM SITE:** ALL MATERIALS TO BE REMOVED FROM THE SITE INCLUDING BUT NOT LIMITED TO UNSUITABLE EARTHEN MATERIAL, UTILITY PIPING, FENCING, ROCK, TRASH, REFUSE AND OTHER DEBRIS SHALL BECOME THE PROPERTY OF THE CONTRACTOR AND SHALL BE LEGALLY DISPOSED OF OUTSIDE THE LIMITS OF THE PROJECT AT THE CONTRACTOR'S EXPENSE. THE CONTRACTOR SHALL COMPLY WITH ALL APPLICABLE LAWS GOVERNING SPILLAGE OF DEBRIS WHILE TRANSPORTING TO A DISPOSAL SITE.
- REPLACEMENT OF DAMAGED FACILITIES:** ALL STRUCTURES, UTILITIES, PAVEMENT, SIDEWALKS, WALLS, FENCES, ETC. NOT DESIGNATED TO BE REMOVED BUT THAT ARE DAMAGED DURING CONSTRUCTION ACTIVITIES SHALL BE REPLACED TO A CONDITION AS GOOD AS OR BETTER THAN THE CONDITIONS PRIOR TO STARTING THE WORK, SOLELY AT THE EXPENSE OF THE CONTRACTOR.
- ACCESS TO PROPERTIES:** DURING THE CONSTRUCTION OF THIS PROJECT, STREET AND SIDEWALK ACCESS TO ADJUTING PROPERTIES MUST BE MAINTAINED AT ALL TIMES.

LEGEND

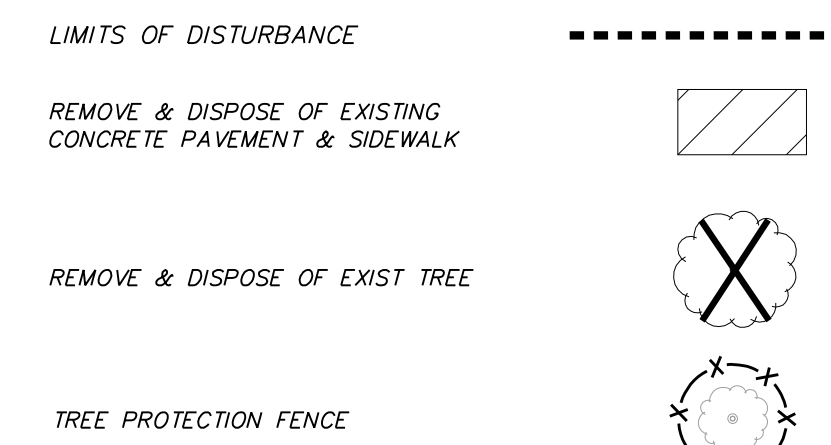

BM #1 REF. ELEVATION = 547.84
 SQUARE CUT IN TOP OF CURB, NORTH MEDIAN END NOSE,
 AT INTERSECTION OF VITRUVIAN WAY AND MARSH LANE.
 BM #2 REF. ELEVATION = 559.47
 SQUARE CUT IN TOP OF CURB, SOUTH MEDIAN END
 NOSE, MARSH LANE 1127' NORTH OF VITRUVIAN WAY.

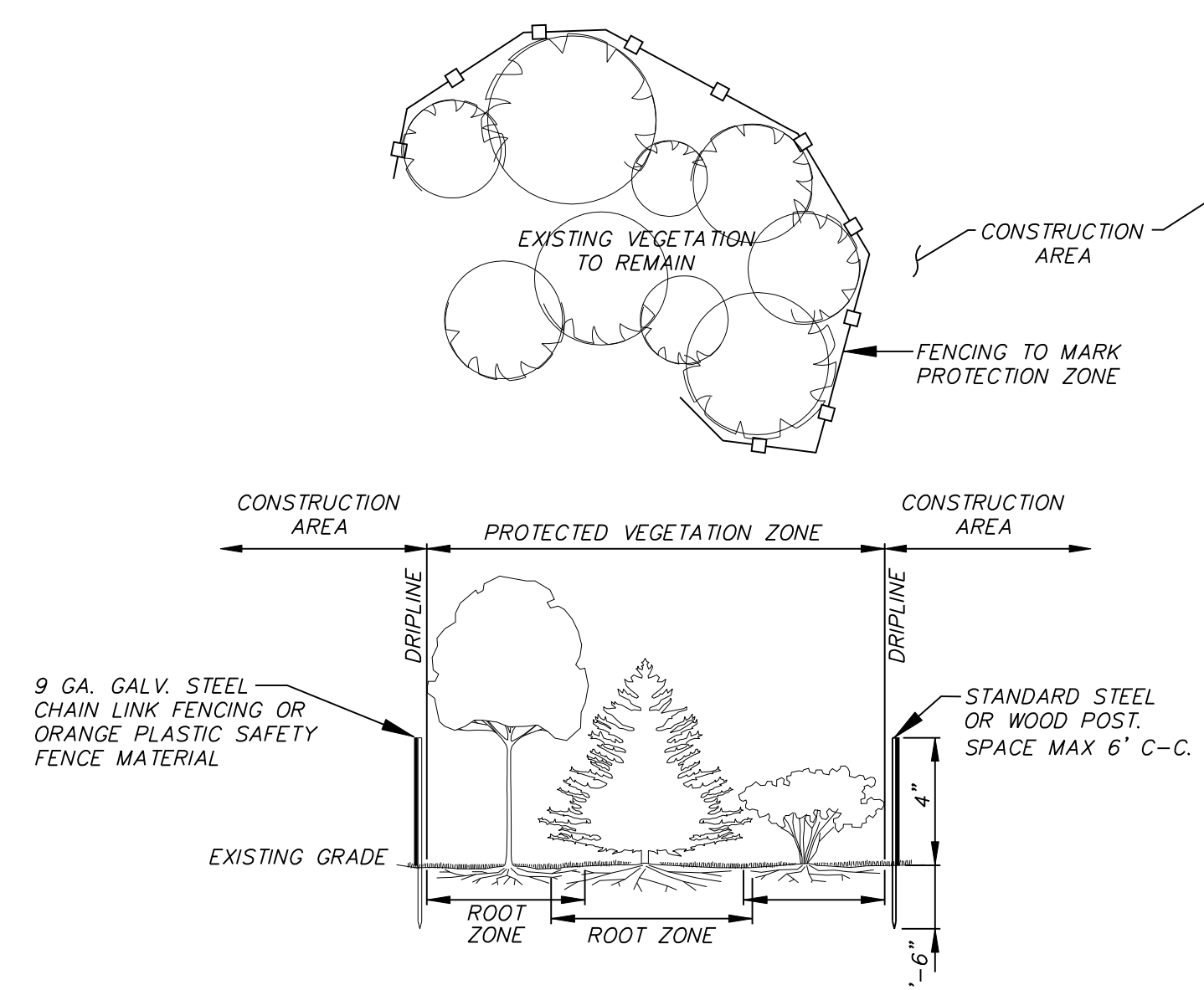
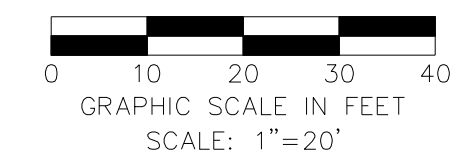

TREE PROTECTION & LIMITS OF DISTURBANCE FENCING DETAIL
NOT TO SCALE

WARNING

CONTRACTOR IS TO CONTACT TEXAS ONE-CALL SYSTEM (1-800-245-4545) OR OTHER UTILITY LOCATING SERVICES AT LEAST 48 HOURS PRIOR TO CONSTRUCTION ACTIVITIES. ICON CONSULTING ENGINEERS, INC. IS NOT RESPONSIBLE FOR KNOWING ALL EXISTING UTILITIES IN THE PROJECT AREA NOR FOR DEPICTING THE EXACT LOCATIONS OF UTILITIES ON THESE DRAWINGS.

| NO. | REVISION | BY | DATE |
|-----|----------|----|------|
| | | | |
| | | | |
| | | | |

icon Consulting Engineers, Inc. 2840 W. Southlake Blvd., Suite 110
 Civil Engineers - Designers - Planners Southlake, Tx 76092 (817) 552-6210
 Engineering Firm Registration Number F-9007

VITRUVIAN WEST 2
VITRUVIAN PARK - TOWN OF ADDISON, TEXAS
3725 VITRUVIAN WAY
DEMOLITION PLAN
CENTER

| DESIGN | DRAWN | DATE | SCALE | NOTES | Sheet No. |
|--------|-------|--------------|----------|-------|-----------|
| ICE | ICE | NOV 17, 2020 | AS NOTED | | C1.01 |