

LIGHTING & CONDUIT NOTES

1. REFER TO SHEET CO-1.00 "GENERAL CONSTRUCTION NOTES, LEGEND AND ABBREVIATIONS" FOR THE GENERAL CONSTRUCTION NOTES FOR THE PROJECT.
2. REFER TO SHEET CO-B.04 (ED(3)-03) FOR ELECTRIC DETAILS - GROUND BOXES. RIGID METAL CONDUIT ELBOWS ARE NOT REQUIRED. CONCRETE APRON IS NOT REQUIRED.
3. WATER, SANITARY SEWER AND STORM DRAIN LINES ARE SHOWN FOR REFERENCE ONLY. CONTRACTOR SHALL LOCATE ALL UTILITY LINES IN THE AREA PRIOR TO DIGGING.
4. INSTALL SCHEDULE 40 PVC UNDERGROUND (24" MIN COVER). ALL STREET AND DRIVEWAY CROSSINGS (36" MIN COVER). ALL BENDS TO BE LONG RADIUS.
5. CONNECTION TO POWER COMPANY CIRCUITS TO BE MADE ONLY BY POWER COMPANY.
6. UNLESS OTHERWISE INDICATED ALL WORK SHALL CONFORM TO THE 2008 NATIONAL ELECTRICAL CODE (NFPA 70) AND THE 2007 NATIONAL ELECTRICAL SAFETY CODE (ANSI C2).
7. ALL EMPTY CONDUIT INSTALLED FOR FUTURE EXTENSION SHALL BE TURNED UP AND EXTENDED UP TO FINISHED GRADE. CAP ENDS OF ALL CONDUITS. ALL EMPTY CONDUIT SHALL CONTAIN A PULL LINE - 200 LB TEST NYLON.
8. REFER TO REFERENCED SHEETS FOR ELECTRICAL DETAILS.

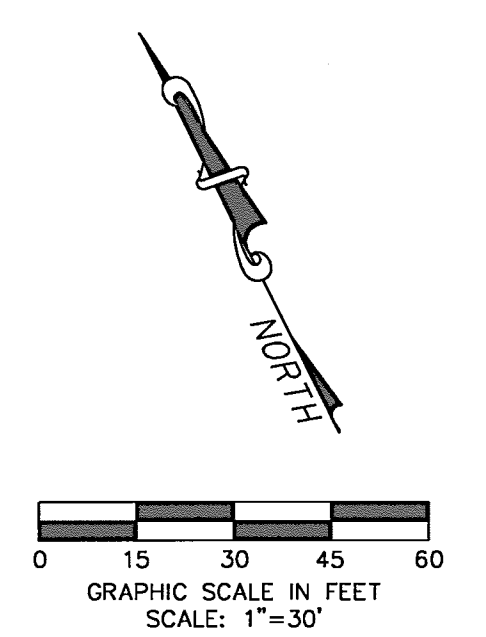

- PULL BOX (GROUND BOX)
- PVC CONDUIT (POWER)
- EXIST PVC CONDUIT (LIGHTING)
- TRANSFORMER ON POLE (PROVIDED BY POWER COMPANY)
- EXIST STREET LIGHT
- PEDOC OUTLET BOX PEDESTAL 30" HEIGHT SINGLE GANG HINGED TOP WITH INTEGRAL BASE
- FUTURE 20A GFCI RECEPTACLE
- COLOR: GREEN
- HUBBLE OFRS3625GW OR EQ

WARNING
CONTRACTOR IS TO CONTACT TEXAS ONE-CALL SYSTEM (1-800-245-4545) OR OTHER UTILITY LOCATING SERVICES AT LEAST 48 HOURS PRIOR TO CONSTRUCTION ACTIVITIES. ICON CONSULTING ENGINEERS, INC. IS NOT RESPONSIBLE FOR KNOWING ALL EXISTING UTILITIES IN THE PROJECT AREA NOR FOR DEPICTING THE EXACT LOCATIONS OF UTILITIES ON THESE DRAWINGS.

BM #1 REF. ELEVATION = 559.47
SQUARE CUT IN TOP OF CURB, SOUTH MEDIAN END NOSE, MARSH LANE 112' NORTH OF VITRUVIAN WAY.
BM #2 REF. ELEVATION = 547.84
SQUARE CUT IN TOP OF CURB, NORTH MEDIAN END NOSE, AT INTERSECTION OF VITRUVIAN WAY AND MARSH LANE.

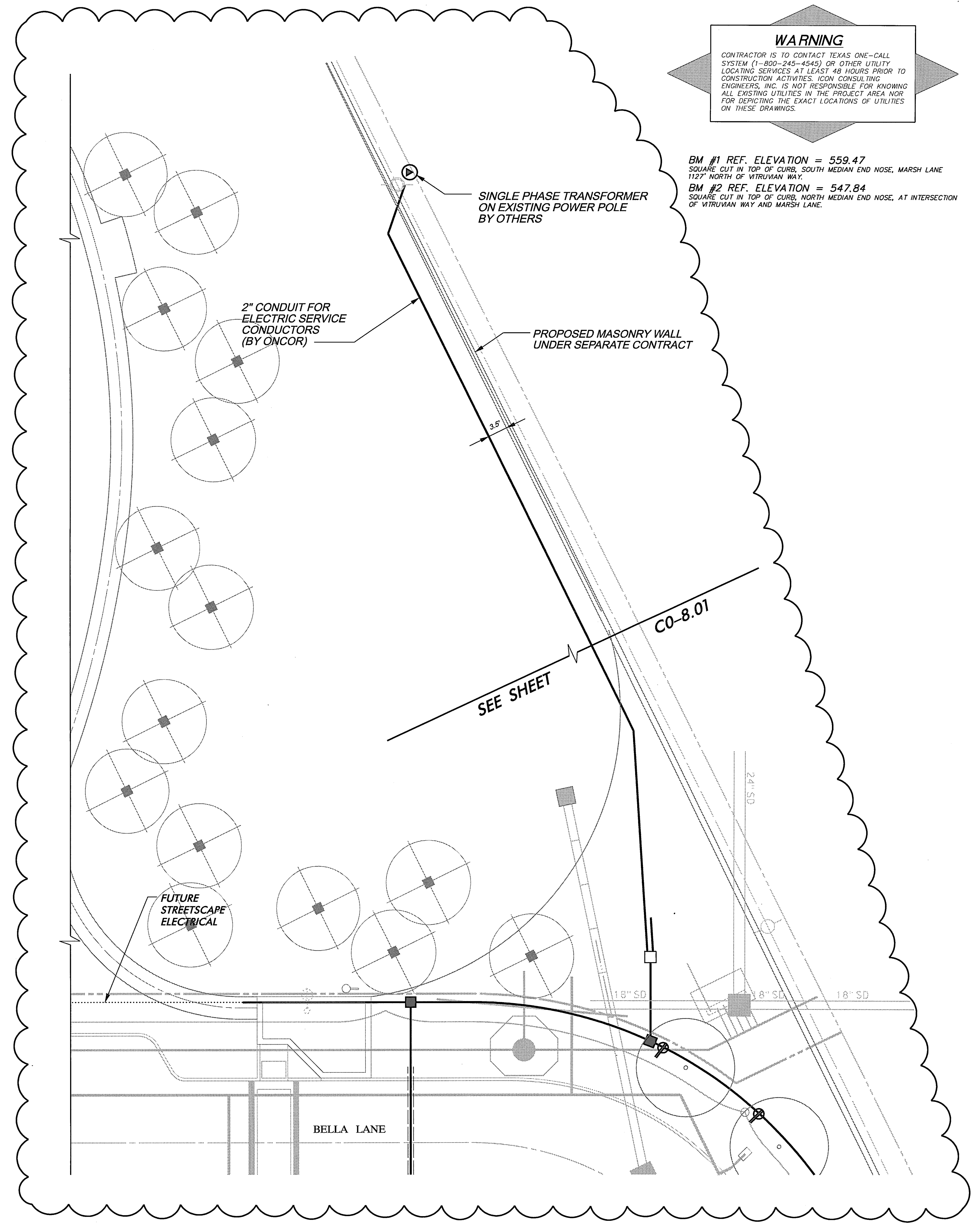

Good Fulton & Farrell Architects
214-303.1607/Tel
214-303.1512/Fax
www.gff.com

2808 Fairmount Street
Suite 300
Dallas, Texas 75201

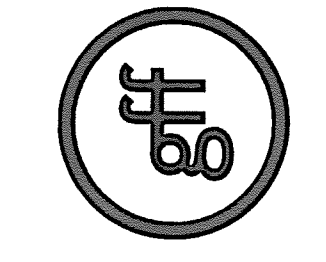

icon
Consulting Engineers, Inc.
Civil Engineers - Designers - Planners

Bicentennial Financial Center
280 W. Southlake Blvd., Suite 117
Southlake, TX 76092
Phone: (817) 552-6210
Fax: (817) 552-3128

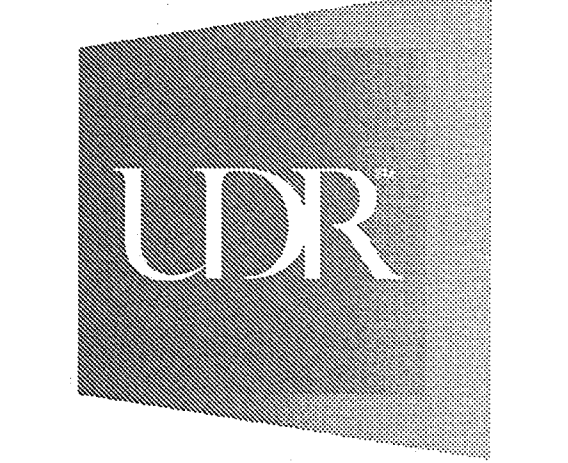

FIORI
ON VITRUVIAN PARK
3990 VITRUVIAN WAY
ADDISON, TX 75001

No.	Date	Item
1	02.05.13	SERVICE LOCATION
2	01.25.13	NORTH OPEN SPACE
REVISIONS		

ICE
Drawn
JAM
Checked
BFD
Approved

BRUCE F. DUNNE
62654
PROFESSIONAL ENGINEER

STREETSCAPE ELECTRICAL PLAN

Project No. 10061.00
Date 08.25.11
Last Revision

CO-8.02B