

PLANS FOR THE CONSTRUCTION OF
WATER, SANITARY SEWER & STORM DRAIN IMPROVEMENTS
BROOKHAVEN CLUB DRIVE, PONTE AVENUE & VITRUVIAN PARK
 FOR

VITRUVIAN PARK PUBLIC INFRASTRUCTURE - PHASE 1A



TOWN OF ADDISON, TEXAS

PUBLIC WORKS # 2008-009

JOE CHOW
MAYOR

ROGER MELLOW
MAYOR PRO TEMPORE

DENNIS KRAFT
DEPUTY MAYOR
PRO TEMPORE

TOM BRAUN
GREGORY HIRSCH
TODD MEIER
JIMMY NIEMANN
COUNCIL MEMBERS

RON WHITEHEAD
CITY MANAGER

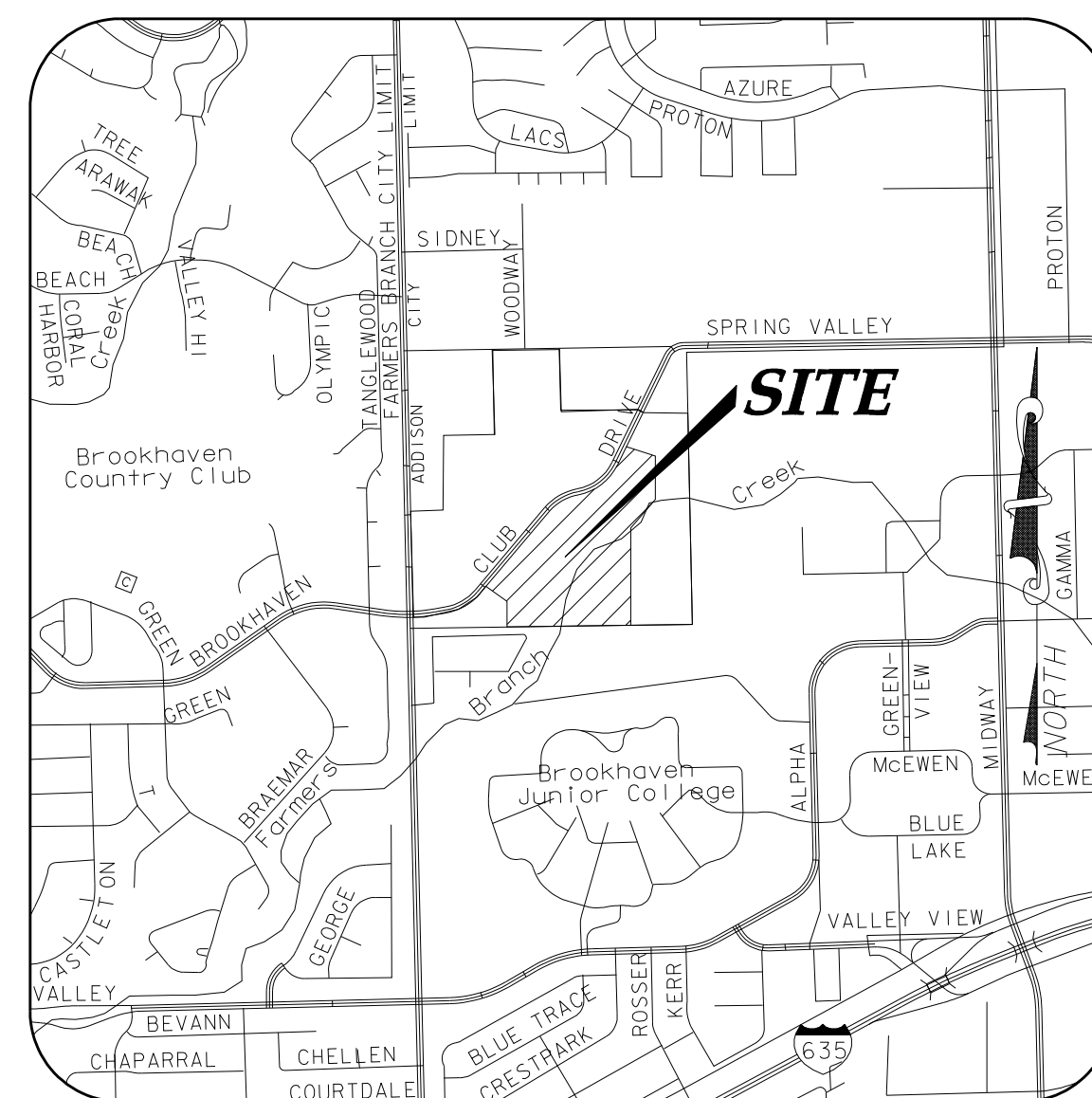

VICINITY MAP

NOT TO SCALE
(MAPSCO GRID 13 & 14)

INDEX OF DRAWINGS

SHEET NO.	DESCRIPTION
1	COVER SHEET
2	PLAT
3	GENERAL CONSTRUCTION NOTES, LEGENDS & ABBREVIATIONS
4	OVERALL WATER LAYOUT
5	WATER PLAN & PROFILE ~ W-A (BCD)
6	WATER PLAN & PROFILE ~ W-B (PONTE AVE)
7	WATER PLAN & PROFILE ~ W-C (PARK)
8	WATER DETAILS
9	WATER DETAILS
10	OVERALL SANITARY SEWER LAYOUT
11	SANITARY SEWER DRAINAGE AREA MAP
12	SANITARY SEWER PLAN & PROFILE ~ SS-B (PARK)
13	SANITARY SEWER PLAN & PROFILE ~ SS-B (PARK)
14	SANITARY SEWER SERVICE PROFILES
15	SANITARY SEWER DETAILS
16	STORM DRAIN PLAN & PROFILE SD-B & INTERIM GRADING PLAN
17	STORM DRAIN DETAILS
18	TRAFFIC CONTROL PLAN - TCP
19	EROSION & SEDIMENT CONTROL PLAN - WEST
20	EROSION & SEDIMENT CONTROL PLAN - EAST
21	EROSION & SEDIMENT CONTROL DETAILS

CIVIL ENGINEER:

ICON CONSULTING ENGINEERS, INC.
250 W. SOUTHLAKE BLVD., SUITE 117
SOUTHLAKE, TEXAS 76092
PH: (817) 552-6210
FAX: (817) 552-3126
CONTACT: BRUCE F. DUNNE, P.E.

SURVEYOR:

LANE'S SOUTHWEST SURVEYING, INC.
2717 MOTLEY DRIVE, SUITE 'B'
MESQUITE, TEXAS 75150
PH: (972) 681-4442
FAX: (972)681-4829
CONTACT: JIM LANE, R.P.L.S.

icon Consulting Engineers, Inc.
Civil Engineers- Designers- Planners

OCTOBER 14, 2008

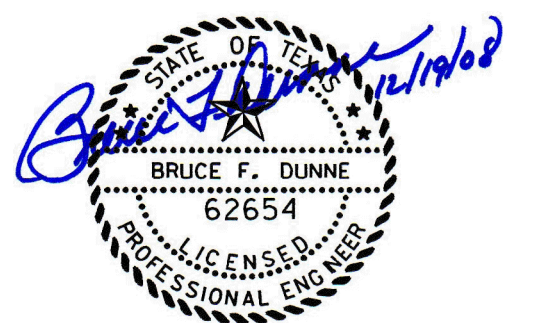

PROJECT 5029-01