

*PLANS FOR THE CONSTRUCTION OF*  
***PAVING, DRAINAGE & UTILITY IMPROVEMENTS***  
*VITRUVIAN WAY & PONTE AVENUE*  
 FOR  
***VITRUVIAN PARK PUBLIC INFRASTRUCTURE-PHASE 1B***  
***TOWN OF ADDISON, TEXAS***

*PUBLIC WORKS # 2009-01*

*Addison!*

**JOE CHOW**  
MAYOR

**ROGER MELLOW**  
MAYOR PRO TEMPORE

**TOM BRAUN**  
**BLAKE CLEMENS**  
**DON DASEKE**  
**KIMBERLY LAY**  
**BIANCA NOBLE**  
COUNCIL MEMBERS

**RON WHITEHEAD**  
CITY MANAGER

**NANCY CLINE, P.E.**  
DIRECTOR OF PUBLIC WORKS

**CLAY BARNETT, P.E.**  
TOWN ENGINEER

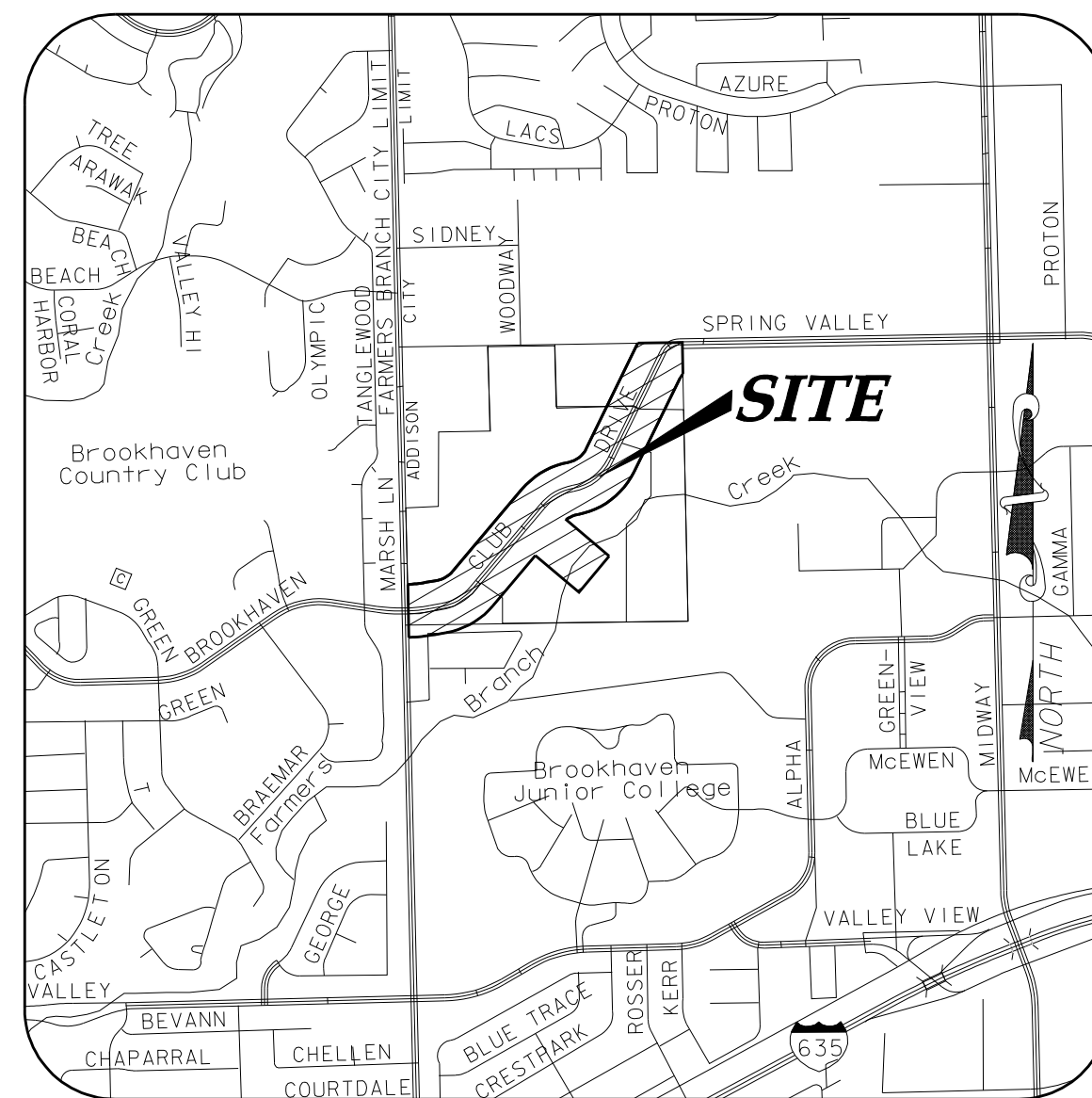

**VICINITY MAP**

NOT TO SCALE  
(MAPSCO GRID 13 & 14)

**CIVIL ENGINEER:**

ICON CONSULTING ENGINEERS, INC.  
250 W. SOUTHLAKE BLVD., SUITE 117  
SOUTHLAKE, TEXAS 76092  
PH: (817) 552-6210  
FAX: (817) 552-3126  
CONTACT: BRUCE F. DUNNE, P.E.

**SURVEYOR:**

LANE'S SOUTHWEST SURVEYING, INC.  
2717 MOTLEY DRIVE, SUITE 'B'  
MESQUITE, TEXAS 75150  
PH: (972) 681-4442  
FAX: (972) 681-4829  
CONTACT: JIM LANE, R.P.L.S.

**STRUCTURAL ENGINEER:**

VIEWTECH STRUCTURAL ENGINEERS, INC.  
4205 BELTWAY DRIVE  
ADDISON, TEXAS 75001  
PH: (972) 661-8187  
FAX: (972) 740-7002  
CONTACT: VICTOR LISSIAK, JR, P.E.

**TRAFFIC ENGINEER:**

LEE ENGINEERING  
3030 LBJ FREEWAY, SUITE 1660  
DALLAS, TEXAS 75234  
PH: (972) 248-3006  
FAX: (972) 248-3855  
CONTACT: JOSEPH SHORT, P.E.

**ELECTRICAL ENGINEER**

SCARBOROUGH ENGINEERING, INC.  
2400 SCOTT AVENUE  
FORT WORTH, TEXAS 76103  
PH: (817) 451-6687  
FAX: (817) 451-0476  
CONTACT: JON D. SCARBOROUGH, P.E.

**LANDSCAPE ARCHITECT:**

KEVIN SLOAN STUDIO  
4145 TRAVIS ST, SUITE 105  
DALLAS, TEXAS 75204  
PH: (214) 379-1061  
FAX: (214) 528-6296  
CONTACT: KEVIN SLOAN

**icon** Consulting Engineers, Inc.  
Civil Engineers- Designers- Planners  
ENGINEERING FIRM REGISTRATION NUMBER F-9007

APRIL 28, 2009



ICON PROJECT #5029-01