

CURVE DATA
 R=200.00'
 DELTA=12° 30' 05"
 L=43.64'

STA 0+00.00-SD-C2
 CONST 18" CONC HDWL
 SEE DETAIL
 CONST 47 SF 5" CONC RIP RAP
 WITH TOE WALL SEE DETAIL
 CONNECT TO EX CONC RIP RAP
 N 7623.52
 E 11149.76

STA 0+00.00-SD-C3
 CONST 42" CONC HDWL
 SEE DETAIL - ROTATE 15°
 CONST 180 SF 5" CONC RIP RAP
 WITH TOE WALL SEE DETAIL
 CONNECT TO EX CONC RIP RAP
 N 7610.88
 E 11198.25

STA 0+87.41-SD-C3
 T-42" X 18" 45° WYE
 N 7610.64
 E 11285.67

STA 0+97.82-SD-C3
 T-42" PLUG
 N 7610.61
 E 11296.08

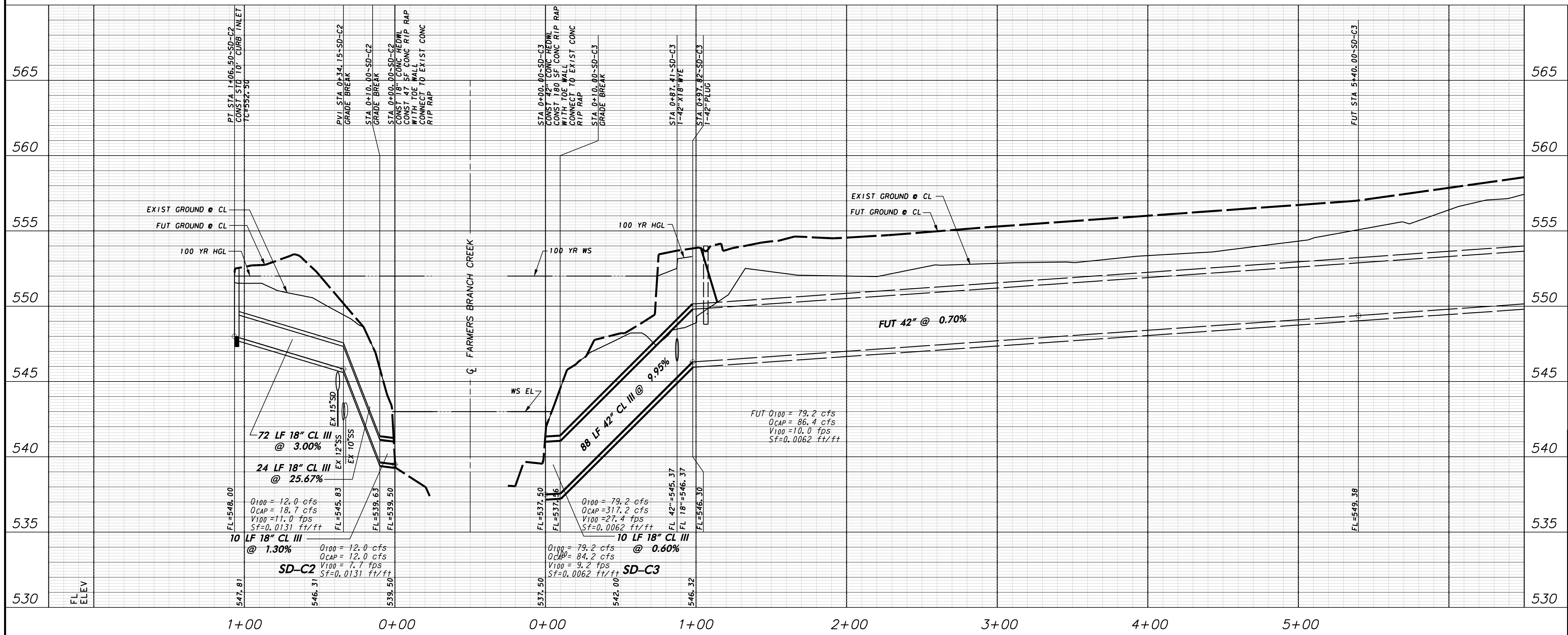

WARNING
 CONTRACTOR IS TO CONTACT TEXAS ONE-CALL SYSTEM (1-800-245-4545) OR OTHER UTILITY LOCATING SERVICES AT LEAST 48 HOURS PRIOR TO CONSTRUCTION ACTIVITIES. ICON CONSULTING ENGINEERS, INC. IS NOT RESPONSIBLE FOR KNOWING ALL EXISTING UTILITIES IN THE PROJECT AREA NOR FOR DEPICTING THE EXACT LOCATIONS OF UTILITIES ON THESE DRAWINGS.

BM #1 REF. ELEVATION = 559.47
 SQUARE CUT IN TOP OF CURB, SOUTH MEDIAN END NOSE, MARSH LANE
 1127' NORTH OF VITRUVIAN WAY.

BM #2 REF. ELEVATION = 547.84
 SQUARE CUT IN TOP OF CURB, NORTH MEDIAN END NOSE, AT INTERSECTION
 OF VITRUVIAN WAY AND MARSH LANE.

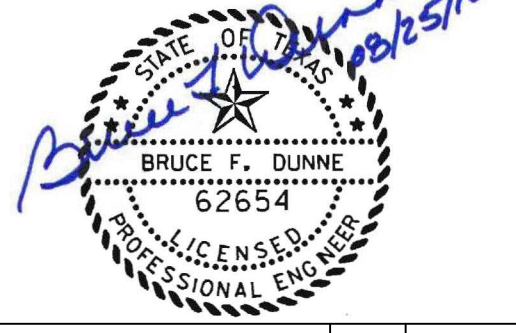
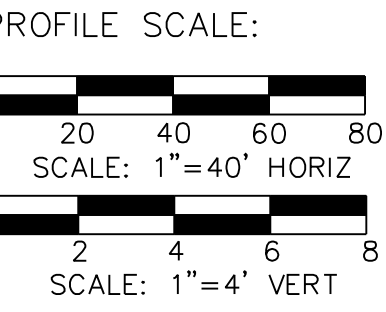

NO.	REVISION	BY	DATE

TOWN OF ADDISON
 DALLAS COUNTY, TEXAS

PAVING, DRAINAGE & UTILITY IMPROVEMENTS
 VITRUVIAN WAY & PONTE AVENUE

STORM DRAIN PLAN & PROFILE-PARK RD LINES C2 & C3

icon Consulting Engineers, Inc. 250 W. Southlake Blvd., Suite 117
 Civil Engineers - Designers - Planners Southlake, Tx 76092 (817) 552-6210

PROJECT	DESIGN	DRAWN	DATE	FILE	SHEET
5029-01	ICE	ICE	MAY 7 2009	PW# 2009-01	40

PAVING, DRAINAGE, & UTILITY IMPROVEMENTS - VITRUVIAN WAY & PONTE AVENUE