

Ø1, Ø3, Ø5, and Ø7 are protected/permissive left turns.

- NOTES:
1. FURNISH AND INSTALL A 10' POLE EXTENSION ON POLE P-3. THE CONTRACTOR SHALL FURNISH AND INSTALL A WIRELESS ETHERNET SUBSCRIBER UNIT ACCORDING TO TOWN OF ADDISON SPECIAL SPECIFICATION A9007 ON THE PROPOSED POLE EXTENSION. CONTRACTOR SHALL AIM THE ETHERNET SUBSCRIBER UNIT AS DIRECTED BY THE ENGINEER.
 2. CONTRACTOR SHALL FURNISH AND INSTALL THE VIDEO SERVER AND HARDENED ETHERNET SWITCH INSIDE THE TRAFFIC SIGNAL CONTROLLER CABINET.
 3. THE VIDEO SERVER SHALL BE INSTALLED BETWEEN THE VIVDS PROCESSOR AND HARDENED ETHERNET SWITCH IN ORDER TO SEND THE VIVDS IMAGES BACK TO THE TRAFFIC MANAGEMENT CENTER.

LEGEND OF SYMBOLS			
	SIGNAL POLE		CONTROLLER CABINET ASSEMBLY
	SIGNAL POLE/MAST ARM ASSEMBLY		
	SIGNAL HEAD IDENTIFICATION		RIGHT OF WAY LINES
	SIGNAL POLE IDENTIFICATION		ELECTRICAL SERVICE PEDESTAL W/METER
	TYPE C GROUND BOX		PHASE NUMBERS
	MAST ARM MOUNTED SIGN		CONDUIT RUN & NUMBERS
	ILLUMINATED STREET NAME SIGN		VIVDS DETECTION CAMERA
	SIGN IDENTIFICATION		VIVDS DETECTOR IDENTIFICATION
	WIRELESS ETHERNET SUBSCRIBER		UNI-DIRECTIONAL OPTICOM DETECTOR

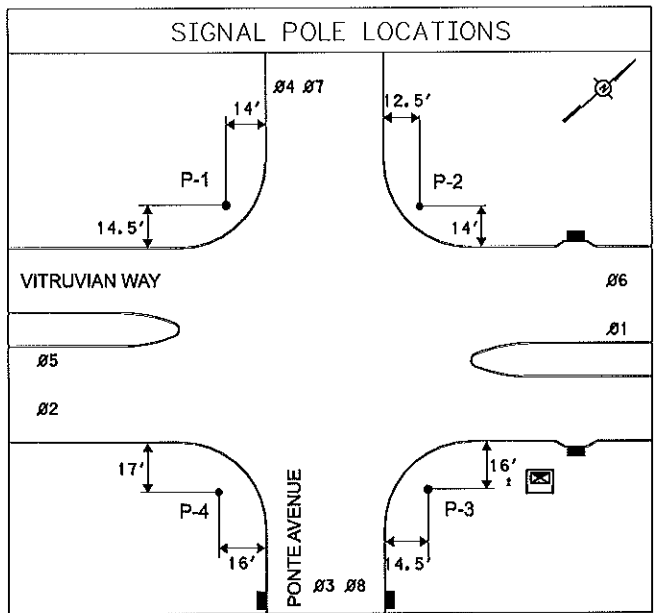
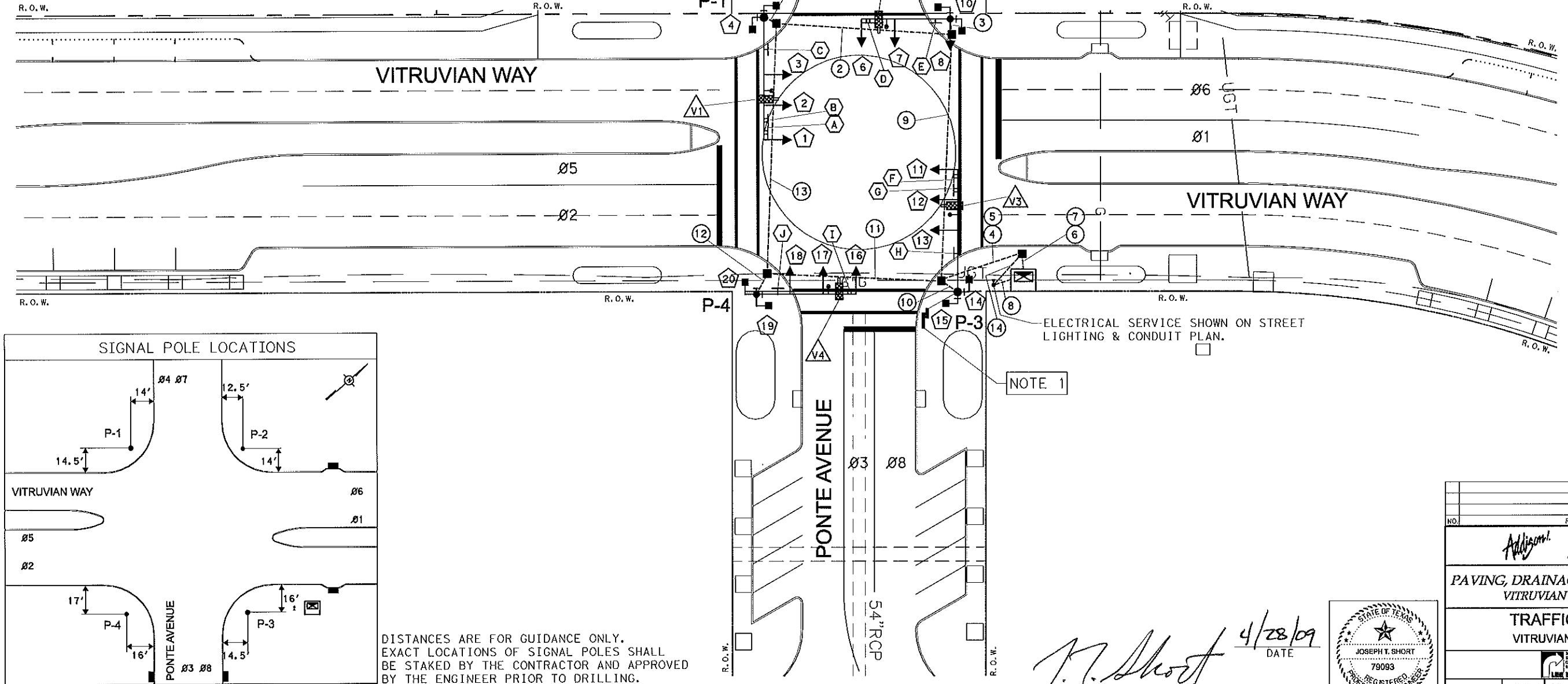
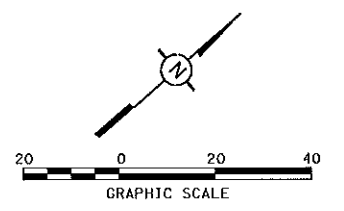

DISTANCES ARE FOR GUIDANCE ONLY. EXACT LOCATIONS OF SIGNAL POLES SHALL BE STAKED BY THE CONTRACTOR AND APPROVED BY THE ENGINEER PRIOR TO DRILLING.

NOTE 1

JOSEPH T. SHORT, P.E.
LEE ENGINEERING, L.L.C., REGISTRATION NO. F-450

Joseph T. Short
DATE 4/28/09



NO.	REVISION	BY	DATE

TOWN OF ADDISON
 DALLAS COUNTY, TEXAS
PAVING, DRAINAGE & UTILITY IMPROVEMENTS
 VITRUVIAN WAY AND PONTE AVENUE
TRAFFIC SIGNAL LAYOUT
 VITRUVIAN WAY AT PONTE AVENUE

PROJECT	DESIGN	DRAWN	DATE	FILE	SHEET
5028-01	CJP	CJP	APR 28, 2009	PW# 2009-01	TS4

PAVING, DRAINAGE & UTILITY IMPROVEMENTS - VITRUVIAN WAY & PONTE AVENUE