

MATCHLINE SHT C304

MATCHLINE SHT C302

MATCHLINE SHT C301

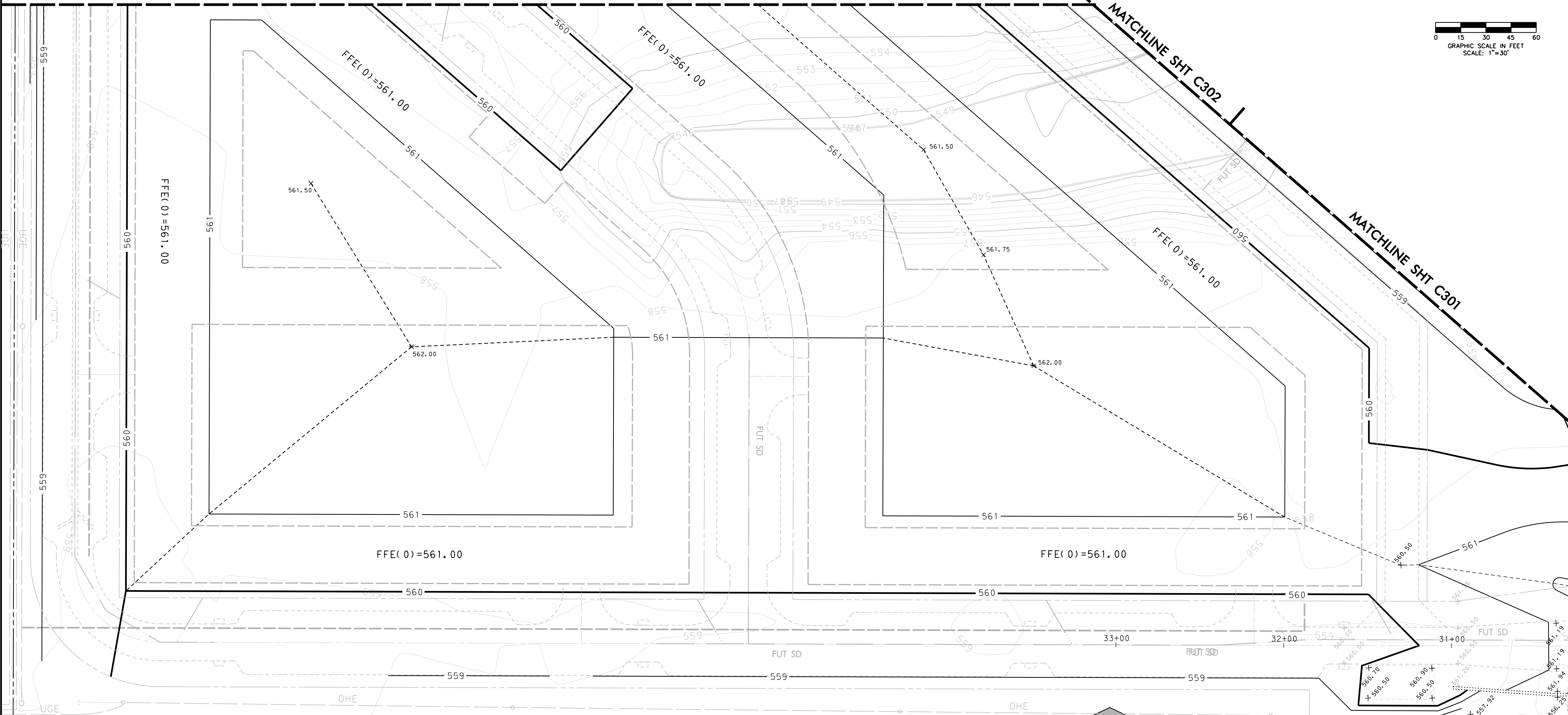
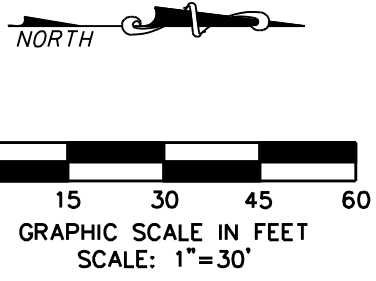

PARISH EPISCOPAL SCHOOL

WARNING

CONTRACTOR IS TO CONTACT TEXAS ONE-CALL SYSTEM (1-800-245-4545) OR OTHER UTILITY LOCATING SERVICES AT LEAST 48 HOURS PRIOR TO CONSTRUCTION ACTIVITIES. ICON CONSULTING ENGINEERS, INC. IS NOT RESPONSIBLE FOR KNOWING ALL EXISTING UTILITIES IN THE PROJECT AREA NOR FOR DEPICTING THE EXACT LOCATIONS OF UTILITIES ON THESE DRAWINGS.

GRADING AND EXCAVATION NOTES:

- REFER TO SHEET C304 "GENERAL GRADING AND EXCAVATION NOTES" FOR THIS PROJECT.
- THE PROPOSED CONTOURS INDICATED ON THE GRADING PLAN ARE FINISHED GRADES AND ARE SHOWN AT ONE-FOOT INTERVALS. SPOT ELEVATIONS SHOWN IN PAVED AREAS ARE TOP OF PAVEMENT, UNLESS NOTED OTHERWISE.
- THE CONTRACTOR SHALL BE RESPONSIBLE FOR MASS GRADING OF THE SITE TO THE FOLLOWING ELEVATIONS:
 - * 12" BELOW FINISHED GRADE FOR ALL AREAS WITHIN THE CONFINES OF THE LAKE AREA FOR PLACEMENT OF CLAY LINER MATERIAL
 - * 6" BELOW FINISHED GRADE FOR ALL HEAVY DUTY SIDEWALK PAVEMENT AREAS.
 - * 4" BELOW FINISHED GRADE FOR ALL STANDARD SIDEWALK PAVEMENT AREAS.
 - * 4" BELOW FINISHED GRADE FOR ALL LANDSCAPE AREAS.
- ALL LANDSCAPE AREAS WITHIN THE LIMITS OF THE PARK PROPERTY NOT DESIGNATED TO BE PAVED OR THAT ARE LOCATED WITHIN THE LIMITS OF THE LAKE AND CREEK AREAS SHALL RECEIVE FOUR (4) INCHES OF TOPSOIL. REFER TO THE LANDSCAPE PLANS FOR LIMITS OF TOPSOIL PLACEMENT.

A TOLERANCE OF +/- 0.10 FEET OF THE FINISHED GRADE WILL BE ALLOWED FOR ALL AREAS UNDER PROPOSED PAVEMENT. ALL LANDSCAPE AREAS ARE TO BE GRADED WITHIN +/- 0.30 FEET OF THE FINISHED GRADE.

BM #1 REF. ELEVATION = 559.47
 SQUARE CUT IN TOP OF CURB, SOUTH MEDIAN
 END NOSE, MARSH LANE
 1127' NORTH OF VITRUVIAN WAY.

BM #2 REF. ELEVATION = 547.84
 SQUARE CUT IN TOP OF CURB, NORTH MEDIAN
 END NOSE, AT INTERSECTION OF
 VITRUVIAN WAY AND MARSH LANE.



NO.	REVISION	BY	DATE

Addison! TOWN OF ADDISON
DALLAS COUNTY, TEXAS

PARK AND STREETSCAPE IMPROVEMENTS
VITRUVIAN PARK

GRADING PLAN
NORTHEAST

icon Consulting Engineers, Inc. 250 W. Southlake Blvd., Suite 117
Civil Engineers - Designers - Planners Southlake, Tx 76092 (817) 552-6210

PROJECT	DESIGN	DRAWN	DATE	FILE	SHEET
5029-01	ICE	ICE	APR 26, 2010	PW# 2009-04	C305