

**LEGEND**

**STANDARD DUTY PAVEMENT:**  
 6" (4200 PSI AT 28 DAYS) CONCRETE PVMT. W/ #3 BARS @ 18" O.C.E.W. ON 6" COMPACTED SUBGRADE TO 95% AT OR ABOVE OPTIMUM MOISTURE CONTENT (ASTM D 698). REFERENCE LANDSCAPE PLANS.

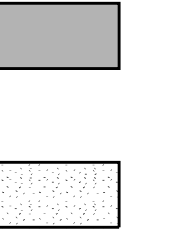

**MISCELLANEOUS & FLATWORK:**  
 4" REINFORCED CONCRETE FLATWORK (3000 PSI AT 28 DAYS) W/ #3 BARS @ 18" O.C.E.W. ON 6" COMPACTED SUBGRADE TO 95% AT OR ABOVE OPTIMUM MOISTURE CONTENT (ASTM D 698). REFERENCE LANDSCAPE PLANS.

**RETAINING WALL:**

**PAVING NOTES**

- REFER TO SHEET C604 FOR "GENERAL PAVING NOTES" FOR THIS PROJECT.

**WARNING**

CONTRACTOR IS TO CONTACT TEXAS ONE-CALL SYSTEM (1-800-245-4545) OR OTHER UTILITY LOCATING SERVICES AT LEAST 48 HOURS PRIOR TO CONSTRUCTION ACTIVITIES. ICON CONSULTING ENGINEERS, INC. IS NOT RESPONSIBLE FOR KNOWING ALL EXISTING UTILITIES IN THE PROJECT AREA NOR FOR DEPICTING THE EXACT LOCATIONS OF UTILITIES ON THESE DRAWINGS.

BM #1 REF. ELEVATION = 559.47  
 SQUARE CUT IN TOP OF CURB, SOUTH MEDIAN  
 END NOSE, MARSH LANE  
 1127' NORTH OF VITRUVIAN WAY.

BM #2 REF. ELEVATION = 547.84  
 SQUARE CUT IN TOP OF CURB, NORTH MEDIAN  
 END NOSE, AT INTERSECTION OF  
 VITRUVIAN WAY AND MARSH LANE.

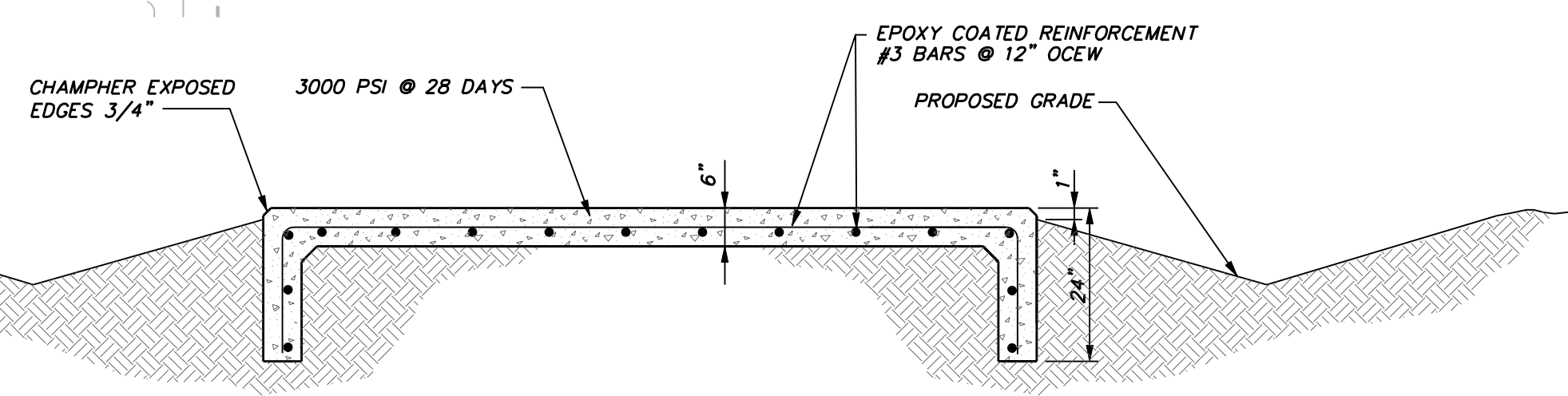

NO.	REVISION	BY	DATE
1	VP102 COORD-TERRACE CLUB WALK REVISION & PONTE WALK REMOVAL	ICE	01/19/11

**Addison!** TOWN OF ADDISON  
 DALLAS COUNTY, TEXAS

PARK AND STREETSCAPE IMPROVEMENTS  
 VITRUVIAN PARK

PAVING PLAN  
 NORTH

**icon** Consulting Engineers, Inc. 250 W. Southlake Blvd., Suite 117  
 Civil Engineers - Designers - Planners Southlake, Tx 76092 (817) 552-6210

PROJECT	DESIGN	DRAWN	DATE	FILE	SHEET
5029-01	ICE	ICE	APR 26, 2010	PW# 2009-04	C601

PARK AND STREETSCAPE IMPROVEMENTS - VITRUVIAN PARK