

01 SOUTH EAST STAIR PLAN  
1/4"=1'-0"

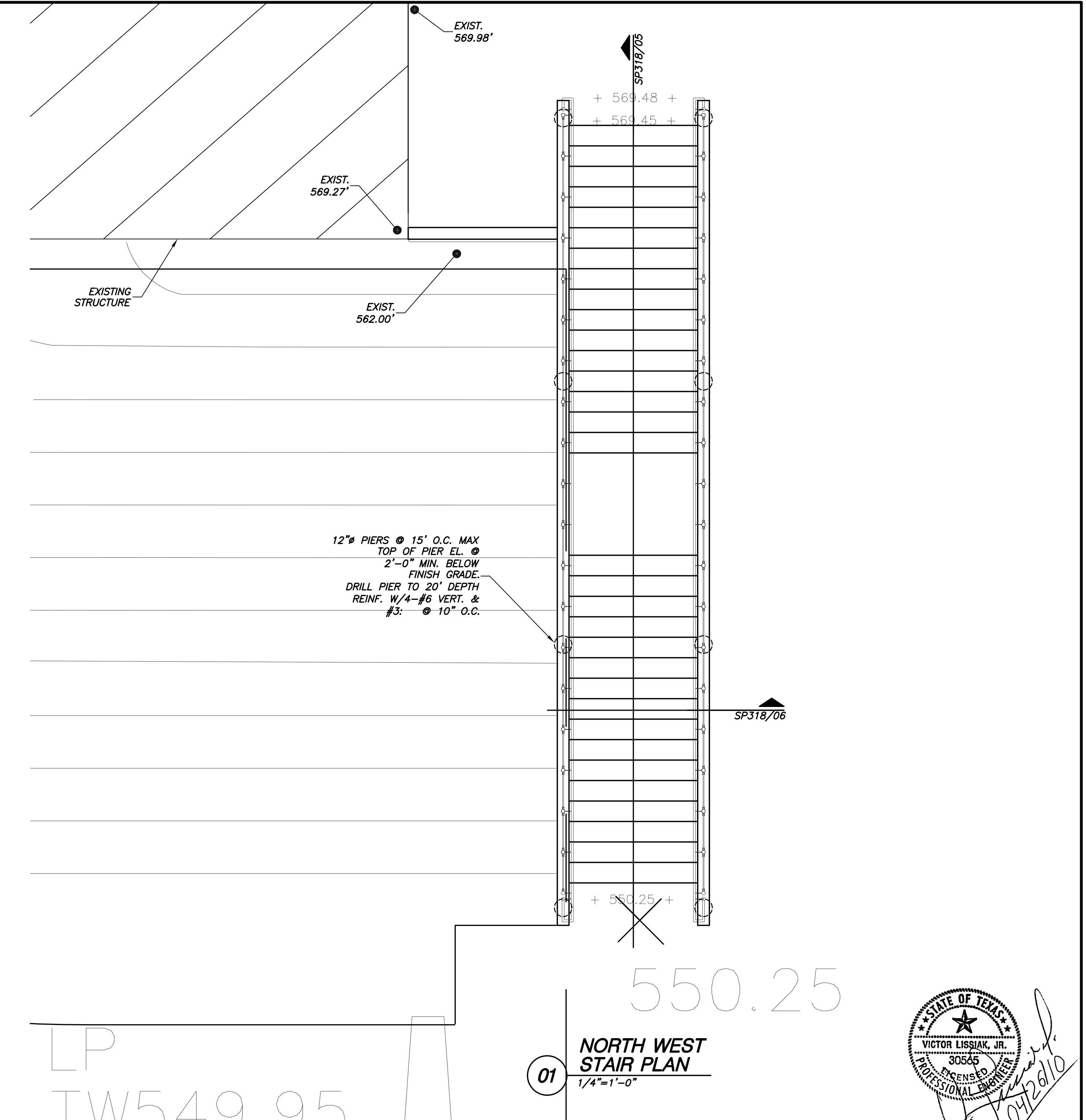

01 NORTH WEST STAIR PLAN  
1/4"=1'-0"

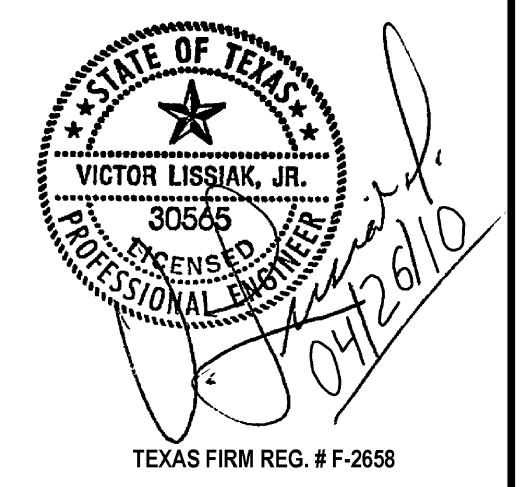

ISSUED FOR CONSTRUCTION 04/26/10

NO.	REVISION	BY	DATE
TOWN OF ADDISON DALLAS COUNTY, TEXAS			
PARK AND STREETScape IMPROVEMENTS VITRUVIAN PARK			
PONTE AVE STAIR PLANS			
<b>VIEWTECH INC.</b> Structural Engineers		4205 Beltway Dr. - Addison, Texas 75001 (972) 661-8187 Fax (972) 661-8172	
PROJECT	DESIGN	DRAWN	DATE
5029-01	VL	NERF	APRIL 26 2010
FILE	SHEET		
PW#2009-04	SP317		