

USER: ah2140  
OFFICE: RCH  
PROJECT: 27379  
FILE: 27379-LOCPLN.dgn  
DATE: 4/29/2010  
TIME: 2:58:54 PM

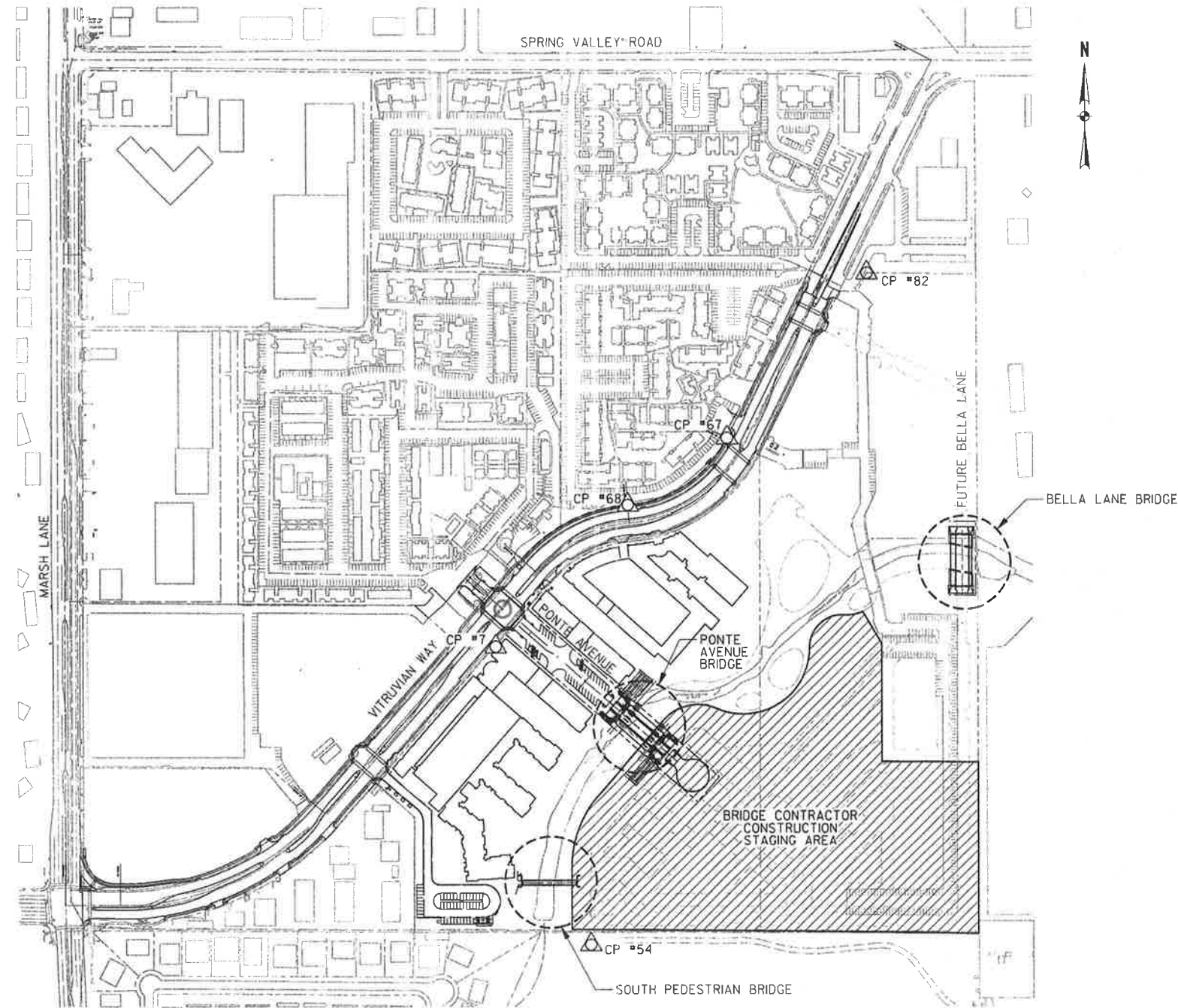

LOCATION PLAN

SCALE: 1" = 200'-0"

CONTROL POINTS

BM #1 REF. ELEVATION = 559.47  
SQUARE CUT IN TOP OF CURB, SOUTH MEDIAN END NOSE, MARSH LANE  
1127' NORTH OF VITRUVIAN WAY.

BM #2 REF. ELEVATION = 547.84  
SQUARE CUT IN TOP OF CURB, NORTH MEDIAN END NOSE, AT INTERSECTION  
OF VITRUVIAN WAY AND MARSH LANE.

CP #7 CPIR 5/8 YC2509 N 8354.44 E 11036.81 ELEV 564.75	CP #54 CPIR 5/8 YC #2509J N 7549.40 E 11283.24 ELEV 549.86	CP #67 IRF 1/2 N 8751.47 E 11411.24 ELEV 570.89
CP #68 IRF 1/2 BENT N 8604.13 E 11117.93 ELEV 569.99	CP #82 IRF 1/2 N 9391.52 E 12074.82 ELEV 573.99	

GENERAL

- S0-00 Cover Sheet
- S0-01 Location Plan and Sheet Index

STRUCTURAL - PONTE AVENUE BRIDGE

- S1-01 Bridge Layout - Plan
- S1-02 Bridge Layout - Elevation
- S1-03 Bridge Layout - Typical Section
- S1-04 Estimated Quantities
- S1-05 Abutment No. 1 Plan and Elevation
- S1-06 Abutment No. 2 Plan and Elevation
- S1-07 Abutment Details - Sections
- S1-08 Abutment Details - Stem Wall Elevation
- S1-09 Abutment Details - Wingwall Details
- S1-10 Abutment Details - Wingwall Details
- S1-11 Abutment Details - Support Wall Details
- S1-12 Abutment Details - Wall Corners & Dr. Shafts
- S1-13 Abutment Details - Bar Bending Diagrams
- S1-14 Abutment Details - Data Tables
- S1-15 Framing Plan
- S1-16 Deck Plan
- S1-17 Deck Details
- S1-18 Miscellaneous Details
- S1-19 Arch Details - Elevation
- S1-20 Arch Details - Lower Arch Segment
- S1-21 Arch Details - Upper Arch Segment
- S1-22 Arch Details - Erection Details
- S1-23 Arch Details - Sections and Details
- S1-24 Arch Details - Embed Details
- S1-25 Temporary Special Shoring

STRUCTURAL - BELLA LANE BRIDGE

- S2-01 Bridge Layout
- S2-02 Bridge Section
- S2-03 Estimated Quantities
- S2-04 Abutment No. 1 Plan and Elevation
- S2-05 Abutment No. 4 Plan and Elevation
- S2-06 Abutment Details - Sections
- S2-07 Abutment Details - Wingwall Details
- S2-08 Bent No. 2 & 3 Details
- S2-09 Bent No. 2 & 3 Details - Sections
- S2-10 Framing Plan
- S2-11 14' Pre Str Conc - Box Beam Unit
- S2-12 Deck Details
- S2-13 Deck Details
- S2-14 Waterline Support Details
- S2-15 Arch Elevation
- S2-16 Beginning Arch Segment
- S2-17 Center Arch Segment
- S2-18 Ending Arch Segment
- S2-19 Arch Details - Sections
- S2-20 Arch Details - Sections
- S2-21 Temporary Special Shoring

STRUCTURAL - SOUTHERN PEDESTRIAN BRIDGE

- S3-01 Bridge Layout
- S3-02 Estimated Quantities
- S3-03 Abutment Details - Elevation and Details
- S3-04 Abutment Details - Sections

\*\* STRUCTURAL - TXDOT STANDARD DRAWINGS

- S4-01 BBND
- S4-02 UBND
- S4-03 BAS-C (MOD)
- S4-04 BB-B28 (MOD) Sheet 1 of 3
- S4-05 BB-B28 (MOD) Sheet 2 of 3
- S4-06 BB-B28 (MOD) Sheet 3 of 3
- S4-07 BBEB
- S4-08 CRR (MOD)
- S4-09 PCP SHEET 1 OF 4
- S4-10 PCP SHEET 2 OF 4
- S4-11 PCP SHEET 3 OF 4
- S4-12 PCP SHEET 4 OF 4
- S4-13 PMDF Sheet 1 of 2
- S4-14 PMDF Sheet 2 of 2
- S4-15 SEJ-A
- S4-16 T401 (MOD) Sheet 1 of 3
- S4-17 T401 (MOD) Sheet 2 of 3
- S4-18 T401 (MOD) Sheet 3 of 3
- S4-19 UBD Sheet 1 of 3
- S4-20 UBD Sheet 2 of 3
- S4-21 UBD Sheet 3 of 3
- S4-22 UBEB (MOD)
- S4-23 UBMS
- S4-24 UBTS

ELECTRICAL

- E0-01 Light Fixture Schedule
- E1-01 Electrical Plan - Ponte Avenue
- E1-02 Electrical Elevation - Ponte Avenue
- E1-03 Electrical Details - Ponte Avenue
- E2-01 Electrical Plan - Bella Lane
- E2-02 Electrical Elevation - Bella Lane
- E2-03 Electrical Details - Bella Lane
- E3-01 Electrical Plan - Southern Pedestrian

LANDSCAPE ARCHITECTURE

- L1-01 Handrail Layout & Profile - Ponte Avenue
- L1-10 Handrail & Paving Layout - Ponte Avenue
- L1-11 Handrail & Paving Layout - Ponte Avenue
- L1-20 Handrail & Paving Layout - Ponte Avenue
- L1-21 Abutment Elevations - Ponte Avenue
- L1-30 Stone Details - Ponte Avenue
- L2-01 Handrail Layout & Profile - Bella Lane
- L2-10 Handrail & Paving Layout - Bella Lane
- L2-11 Handrail & Paving Layout - Bella Lane
- L2-20 Wing Wall Elevations - Bella Lane
- L2-21 Abutment Elevations - Bella Lane
- L2-30 Stone Details - Bella Lane
- L3-01 Handrail Details
- L3-02 Handrail & Paving Details
- L3-03 Stone Details

\*\* THE TXDOT STANDARD SHEETS SPECIFICALLY IDENTIFIED IN THIS SHEET INDEX, HAVE BEEN ISSUED BY ME OR UNDER MY RESPONSIBLE SUPERVISION AS BEING APPLICABLE TO THIS PROJECT.

04-29-10



THE SEAL APPEARING ON THIS DOCUMENT WAS AUTHORIZED BY ERIC S. CHRISTENSEN, P.E. #5412 ON 04-29-2010. ALTERATION OF A SEALED DOCUMENT WITHOUT PROPER NOTIFICATION TO THE RESPONSIBLE ENGINEER IS AN OFFENSE UNDER THE TEXAS ENGINEERING PRACTICE ACT. THE RECORD COPY OF THIS DRAWING IS ON FILE AT THE OFFICES OF HALFF ASSOCIATES, 1201 NORTH BOWSER ROAD, RICHARDSON, TEXAS, 75081, TELE. FIRM #7-312.

NO.	REVISION	BY	DATE
<b>TOWN OF ADDISON</b> DALLAS COUNTY, TEXAS			
<b>VITRUVIAN PARK BRIDGES</b>			
<b>LOCATION PLAN AND SHEET INDEX</b>			
<b>HALFF</b>			
1201 NORTH BOWSER ROAD, RICHARDSON, TEXAS 75081-2275 TEL (214) 346-0200 FAX (214) 736-0095			
PROJECT	DESIGN	DRAWN	DATE
27379	ESC	AHH	APRIL 2010
FILE	SHEET		
	SO-01		