

USER: ah2214

OFFICE: RCH

PROJECT # 27379

FILE: L101-SP-Ponte-27379.dgn

TIME: 5:15:12 PM

DATE: 5/19/2010

+/- 3'-0"  
CONTRACTOR TO FIELD VERIFY AND COORDINATE  
THE EXACT LENGTH OF RAIL REQUIRED. TYP. FOR  
ALL CORNERS

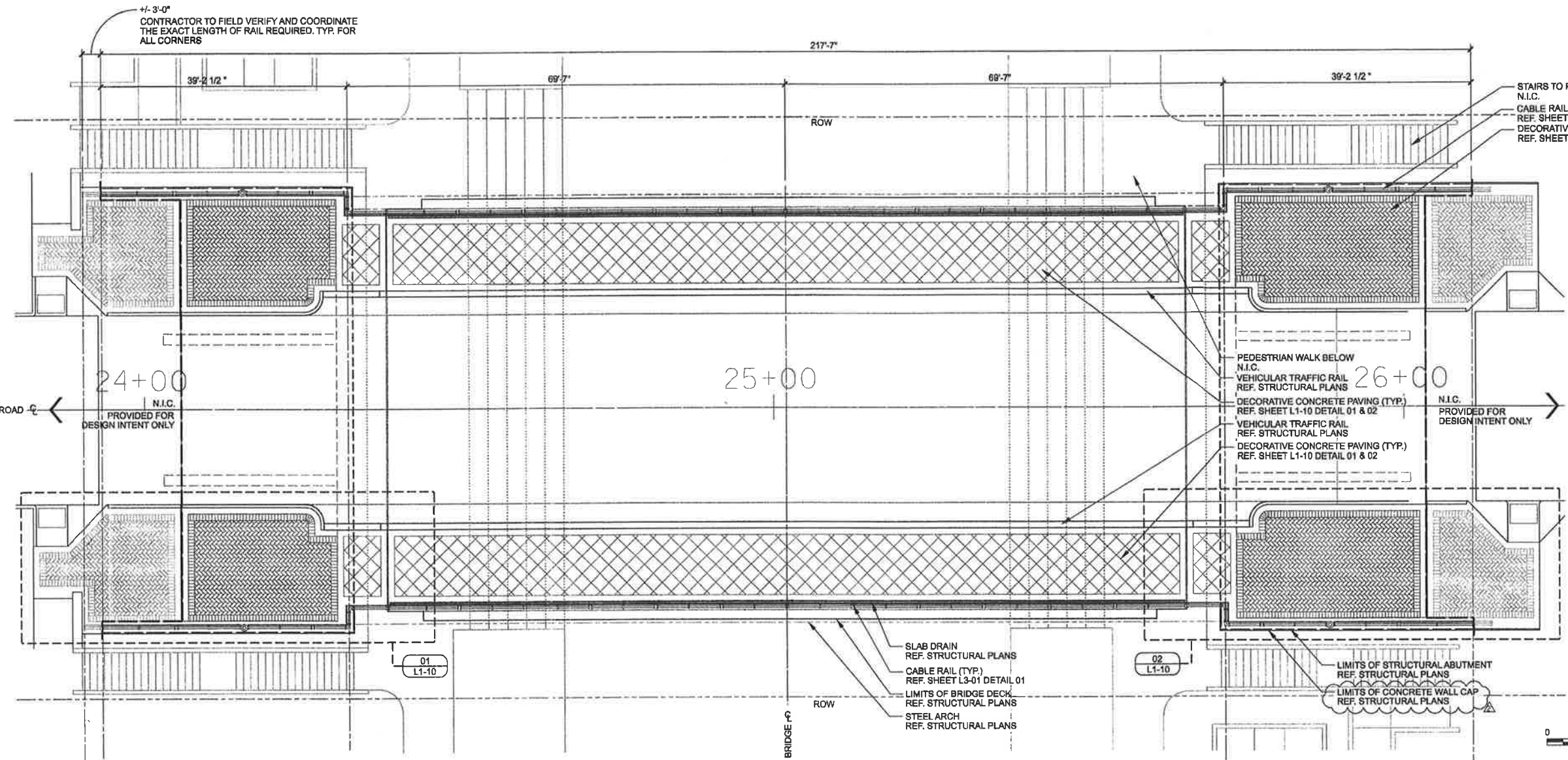

**GENERAL NOTES**

1. REF. STRUCTURAL DRAWINGS FOR ALL BRIDGE DIMENSIONS AND COORDINATES.
2. ALL RAILING SHALL BE SPACED AT TYPICAL 10'-0" INCREMENTS AS SHOWN ON SHEET L3-01 UNLESS OTHERWISE NOTED.
3. ALL WALK DIMENSIONS ARE GIVEN FROM BACK OF CURB UNLESS OTHERWISE NOTED.
4. REF. ELECTRICAL DRAWINGS FOR ALL LIGHT FIXTURE TYPES.
5. ALL ITEMS AND APPURTANANCES N.I.C. TO BE COORDINATED BY THE CONTRACTOR PRIOR TO WORK COMMENCEMENT.
6. ALL DIMENSIONS AND ITEM LOCATIONS ARE TO MIRROR ALONG THE ROAD CENTERLINE UNLESS OTHERWISE NOTED.

**01 CABLE RAIL AND PAVING LAYOUT**  
SCALE: 10"= 1'-0" PLAN

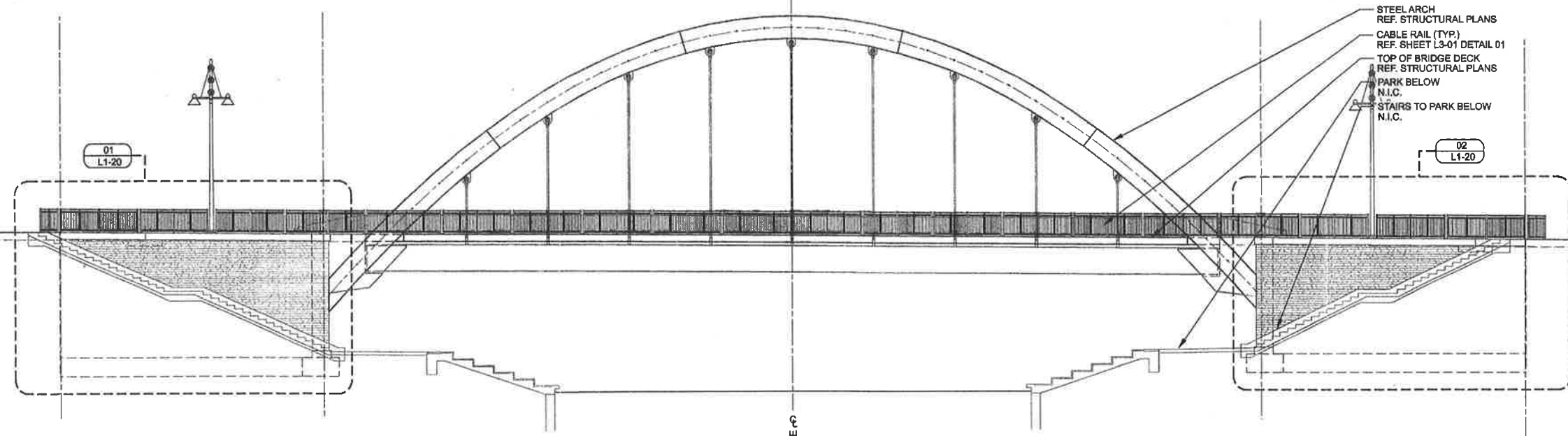

**02 CABLE RAIL AND WALL ABUTMENT LAYOUT**  
SCALE: 10"= 1'-0" ELEVATION

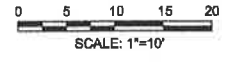

THE SEAL APPEARING ON THIS DOCUMENT WAS AUTHORIZED BY LENNY L. HUGHES, P.E., No. 2087 ON 05-19-2010. ALTERATION OF A SEALED DOCUMENT WITHOUT PROPER NOTIFICATION TO THE RESPONSIBLE LANDSCAPE ARCHITECT IS AN OFFENSE UNDER THE TEXAS ENGINEERING PRACTICE ACT. THE RECORD COPY OF THIS DRAWING IS ON FILE AT THE OFFICES OF HALFF ASSOCIATES, INC., 1201 NORTH BOWSER, RICHARDSON, TEXAS 75081, TEL: 972-346-8200.

ADDENDUM #2	REVISION	JOB NO.	DATE
		05/19/10	
<b>TOWN OF ADDISON DALLAS COUNTY, TEXAS</b>			
<b>VITRUVIAN PARK BRIDGES PONTE AVENUE</b>			
<b>HANDRAIL LAYOUT &amp; PROFILE</b>			
<b>HALFF</b> 1201 NORTH BOWSER ROAD, RICHARDSON, TEXAS 75081-2276 TEL (214) 346-8200 FAX (214) 738-0085			
PROJECT	DESIGN	DRAWN	DATE
27379	JDB	AHH	APRIL 2010
FILE	SHEET		
-	L1-01		