

01 ARCH AT ABUTMENT (TYP.)
 SCALE: 3/4"=1'-0" ELEVATION

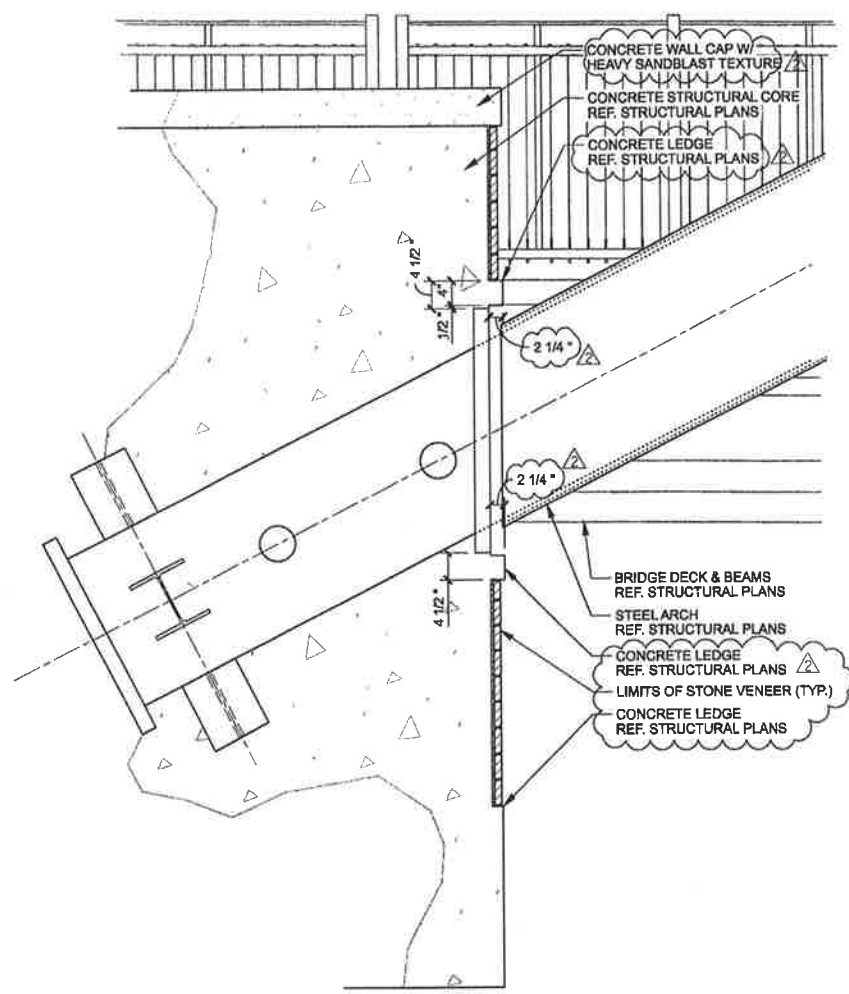

02 ARCH AT ABUTMENT (TYP.)
 SCALE: 3/4"=1'-0" SECTION

GENERAL NOTES

1. REF. STRUCTURAL DRAWINGS FOR ALL BRIDGE DIMENSIONS AND COORDINATES.
2. ALL RAILING SHALL BE SPACED AT TYPICAL 10'-0" INCREMENTS AS SHOWN ON SHEET L3-01 UNLESS OTHERWISE NOTED.
3. ALL WALK DIMENSIONS ARE GIVEN FROM BACK OF CURB UNLESS OTHERWISE NOTED.
4. REF. ELECTRICAL DRAWINGS FOR ALL LIGHT FIXTURE TYPES.
5. ALL ITEMS AND APPURTANANCES N.I.C. TO BE COORDINATED BY THE CONTRACTOR PRIOR TO WORK COMMENCEMENT.
6. ALL DIMENSIONS AND ITEM LOCATIONS ARE TO BE MIRRORED ALONG THE ROAD CENTERLINE UNLESS OTHERWISE NOTED.

DESIGN SELECTION: STRUCTURE

STONE:

BLUE GREEN CHINESE STONE

VENEER THICKNESS: 3 cm
 VENEER HEIGHT: 4"
 VENEER LENGTH: 8", 13" AND 21"
 VENEER FINISH: THERMAL
 VENEER EDGES: ALL FOUR SIDES TO BE SAW CUT
 MORTAR: TO MATCH ON SITE MOCK-UP
 COURSING: TO MATCH ON SITE MOCK-UP

CONCRETE ELEMENTS:

MASK WALL

FINISH: HEAVY SANDBLAST ALL SIDES
 COLOR: NONE

WALL CAP

FINISH: HEAVY SANDBLAST
 COLOR: NONE

STRUCTURE GENERAL NOTES:

1. SEE ON-SITE MOCK-UP FOR ALL REFERENCED CONCRETE AND STONE, COLORS AND TEXTURES. FINAL APPROVAL BY OWNER OR OWNERS REPRESENTATIVE IS REQUIRED PRIOR TO WORK COMMENCEMENT.
2. CONTRACTOR TO PROVIDE A 4' x 4' MOCK-UP OF ALL REFERENCED CONCRETE AND STONE, COLORS AND TEXTURES FOR APPROVAL PRIOR TO WORK COMMENCEMENT.



THE SEAL APPEARING ON THIS DOCUMENT WAS AUTHORIZED BY LENNY L. HUGHES, R.L.A. #2087 ON 05-19-2010. ALTERATION OF A SEALED DOCUMENT WITHOUT PROPER NOTIFICATION TO THE RESPONSIBLE LANDSCAPE ARCHITECT IS AN OFFENSE UNDER THE TEXAS ENGINEERING PRACTICE ACT. THE RECORD COPY OF THIS DRAWING IS ON FILE AT THE OFFICES OF HALFF ASSOCIATES, INC., 1201 NORTH BOWSER, RICHARDSON, TEXAS 75081. TSPC PFM #P-512

| | | | | | |
|---|----------|----------|------------|------|-------|
| ADDENDUM #2 | JOB | 05/19/10 | | | |
| ADDENDUM #1 | JOB | 05/14/10 | | | |
| NO. | REVISION | BY DATE | | | |
| ADDISON TOWN OF ADDISON DALLAS COUNTY, TEXAS | | | | | |
| VITRUVIAN PARK BRIDGES BELLA LANE | | | | | |
| ABUTMENT DETAILS | | | | | |
| HALFF | | | | | |
| 1201 NORTH BOWSER ROAD, RICHARDSON, TEXAS 75081-2276 TEL (214) 346-8200 FAX (214) 736-0095 | | | | | |
| PROJECT | DESIGN | DRAWN | DATE | FILE | SHEET |
| 27379 | JOB | AHH | APRIL 2010 | - | L2-30 |