

01 STONE WALL (TYP.)
SCALE: 1 1/2"=1'-0" SECTION

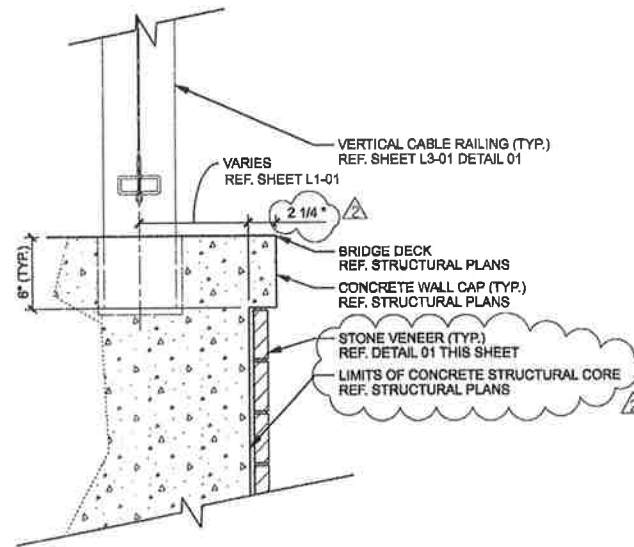

02 STONE VENEER AT WALL CAP (TYP.)
SCALE: 1 1/2"=1'-0" SECTION

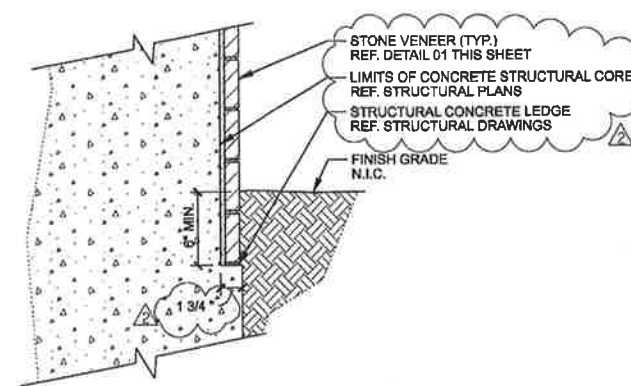

03 VENEER BASE AT CONCRETE LEDGE
SCALE: 1 1/2"=1'-0" SECTION

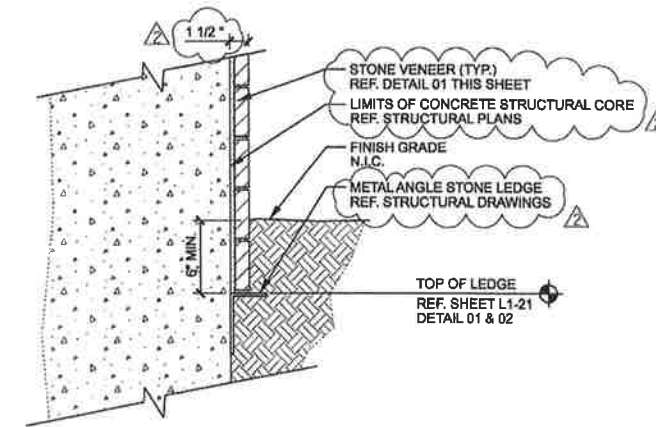

04 VENEER BASE AT STONE LEDGE
SCALE: 1 1/2"=1'-0" SECTION

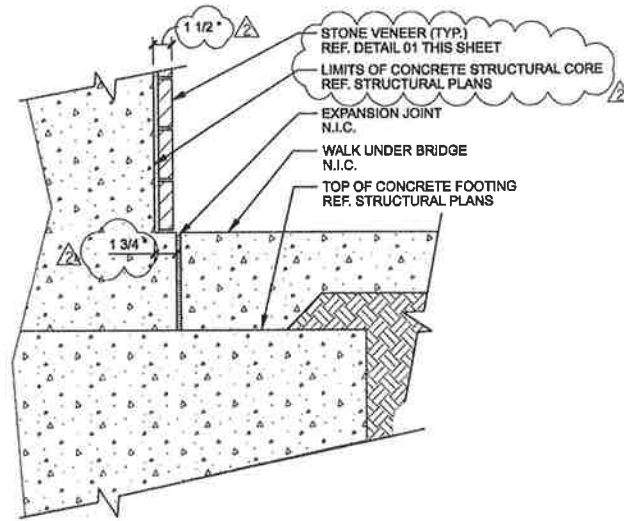

05 VENEER BASE BELOW BRIDGE
SCALE: 1 1/2"=1'-0" SECTION

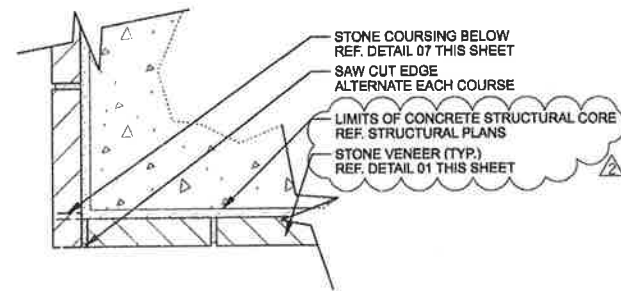

06 CORNER TREATMENT (TYP.)
SCALE: 3"=1'-0" PLAN

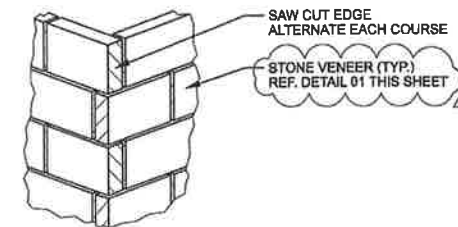

07 CORNER TREATMENT (TYP.)
NOT TO SCALE ISOMETRIC

DESIGN SELECTION: STRUCTURE

STONE:

BLUE GREEN CHINESE STONE

VENEER THICKNESS: 3 cm
VENEER HEIGHT: 4"
VENEER LENGTH: 8", 13" AND 21"
VENEER FINISH: THERMAL
VENEER EDGES: ALL FOUR SIDES TO BE SAW CUT
MORTAR: TO MATCH ON SITE MOCK-UP
COURSING: TO MATCH ON SITE MOCK-UP

CONCRETE ELEMENTS:

MASK WALL

FINISH: HEAVY SANDBLAST ALL SIDES
COLOR: NONE

WALL CAP

FINISH: HEAVY SANDBLAST
COLOR: NONE

STRUCTURE GENERAL NOTES:

- SEE ON-SITE MOCK-UP FOR ALL REFERENCED CONCRETE AND STONE. COLORS AND TEXTURES. FINAL APPROVAL BY OWNER OR OWNERS REPRESENTATIVE IS REQUIRED PRIOR TO WORK COMMENCEMENT.
- CONTRACTOR TO PROVIDE 4' x 4' MOCK-UP OF ALL REFERENCED CONCRETE AND STONE. COLORS AND TEXTURES FOR APPROVAL PRIOR TO WORK COMMENCEMENT.



THE SEAL APPEARING ON THIS DOCUMENT WAS AUTHORIZED BY LENNY L. HUGHES, R.L.A. #2087 ON 06-19-2010. ALTERATION OF A SEALED DOCUMENT WITHOUT PROPER NOTIFICATION TO THE RESPONSIBLE LANDSCAPE ARCHITECT IS AN OFFENSE UNDER THE TEXAS ENGINEERING PRACTICE ACT. THE RECORD COPY OF THIS DRAWING IS ON FILE AT THE OFFICE OF HALFF ASSOCIATES, INC., 1201 NORTH BOWSER, RICHARDSON, TEXAS 75081, TYPE FIRM #F-912

ADDENDUM *2	JDB	05/19/10
ADDENDUM *1	JDB	05/14/10
NO.	REVISION	BY DATE

TOWN OF ADDISON
DALLAS COUNTY, TEXAS

VITRUVIAN PARK BRIDGES

GENERAL DETAILS

HALFF 1201 NORTH BOWSER ROAD, RICHARDSON, TEXAS 75081-2275
TEL (214) 348-6200 FAX (214) 738-0095

PROJECT	DESIGN	DRAWN	DATE	FILE	SHEET
27379	JDB	AHH	APRIL 2010	-	L3-03