

USER: oh2140  
OFFICE: RCH  
PROJECT \* 27379  
FILE: 27379-COVER.dgn  
TIME: 2:14:34 PM  
DATE: 4/29/2010

PLANS FOR THE CONSTRUCTION OF  
**PONTE AVENUE & BELLA LANE VEHICULAR BRIDGES**  
& THE SOUTHERN PEDESTRIAN BRIDGE FOR VITRUVIAN PARK  
KNOWN AS  
**VITRUVIAN PARK PUBLIC INFRASTRUCTURE - PHASE 1D**  
**TOWN OF ADDISON, TEXAS**

**PUBLIC WORKS # 2009-05**

**APRIL 2010**



JOE CHOW  
MAYOR

ROGER MELLOW  
TOM BRAUN  
BLAKE CLEMENS  
DON DASEKE  
KIMBERLY LAY  
BIANCA NOBLE  
COUNCIL MEMBERS

RON WHITEHEAD  
CITY MANAGER

NANCY CLINE, P.E.  
DIRECTOR OF PUBLIC WORKS

CLAY BARNETT, P.E.  
TOWN ENGINEER

LEA DUNN  
CITY SECRETARY

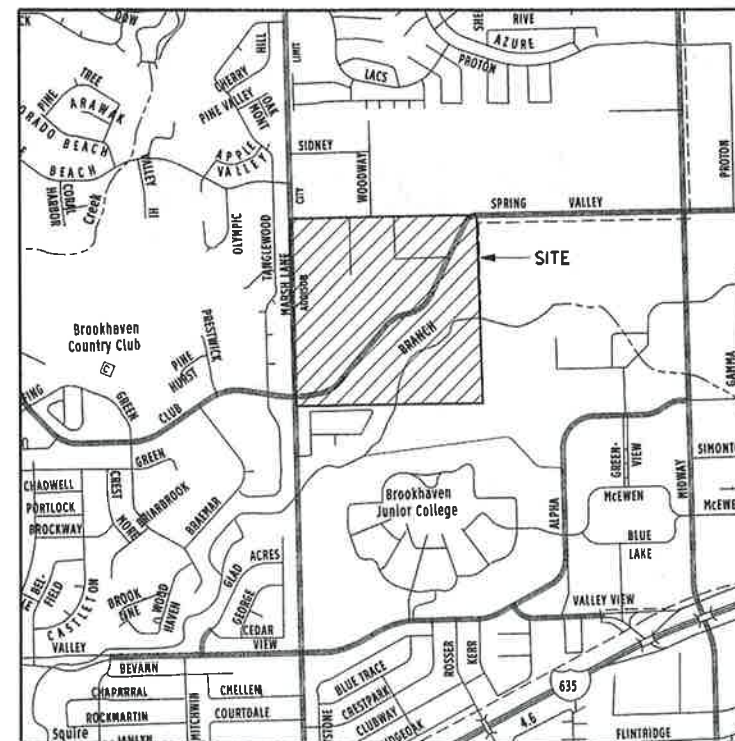

VICINITY MAP  
NOT TO SCALE

CENTERLINE GEOMETRY AND CONTROL POINTS  
PROVIDED BY ICON CONSULTING ENGINEERS, INC.  
ON APRIL 9, 2010.

**APPROVED FOR  
CONSTRUCTION**

Town of Addison  
Public Works Department

APPROVED BY: CLAY BARNETT

DATE: 7-14-2010

All responsibility for the adequacy of these plans remains with the Engineer who prepared them. In approving these plans, the Town of Addison makes no representation of adequacy of the work of the Design Engineer.



1201 NORTH BOWSER ROAD  
RICHARDSON, TEXAS 75081-2275  
TEL (214) 346-6200  
FAX (214) 739-0095