

PLANS FOR
PHASE ONE DEMOLITION IMPROVEMENTS
 TO SERVE
BROOKHAVEN VILLAGE
TOWN OF ADDISON, TEXAS
 PUBLIC WORKS #2007-001

OWNER/DEVELOPER:

UDR
 THREE LINCOLN CENTRE
 5430 LBJ FREEWAY, SUITE 1250
 DALLAS, TEXAS 75240
 PH: (972) 774-0552
 FAX: (972) 991-8120
 CONTACT: JEREMY CYR

CIVIL ENGINEER:

ICON CONSULTING ENGINEERS, INC.
 250 W. SOUTHLAKE BLVD., SUITE 117
 SOUTHLAKE, TEXAS 76092
 PH: (817) 552-6210
 FAX: (817) 552-3126
 CONTACT: BRUCE F. DUNNE, P.E.

SURVEYOR:

LANE'S SOUTHWEST SURVEYING, INC.
 2717 MOTLEY DRIVE, SUITE 'B'
 MESQUITE, TEXAS 75150
 PH: (972) 681-4442
 FAX: (972) 681-4829
 CONTACT: JIM LANE

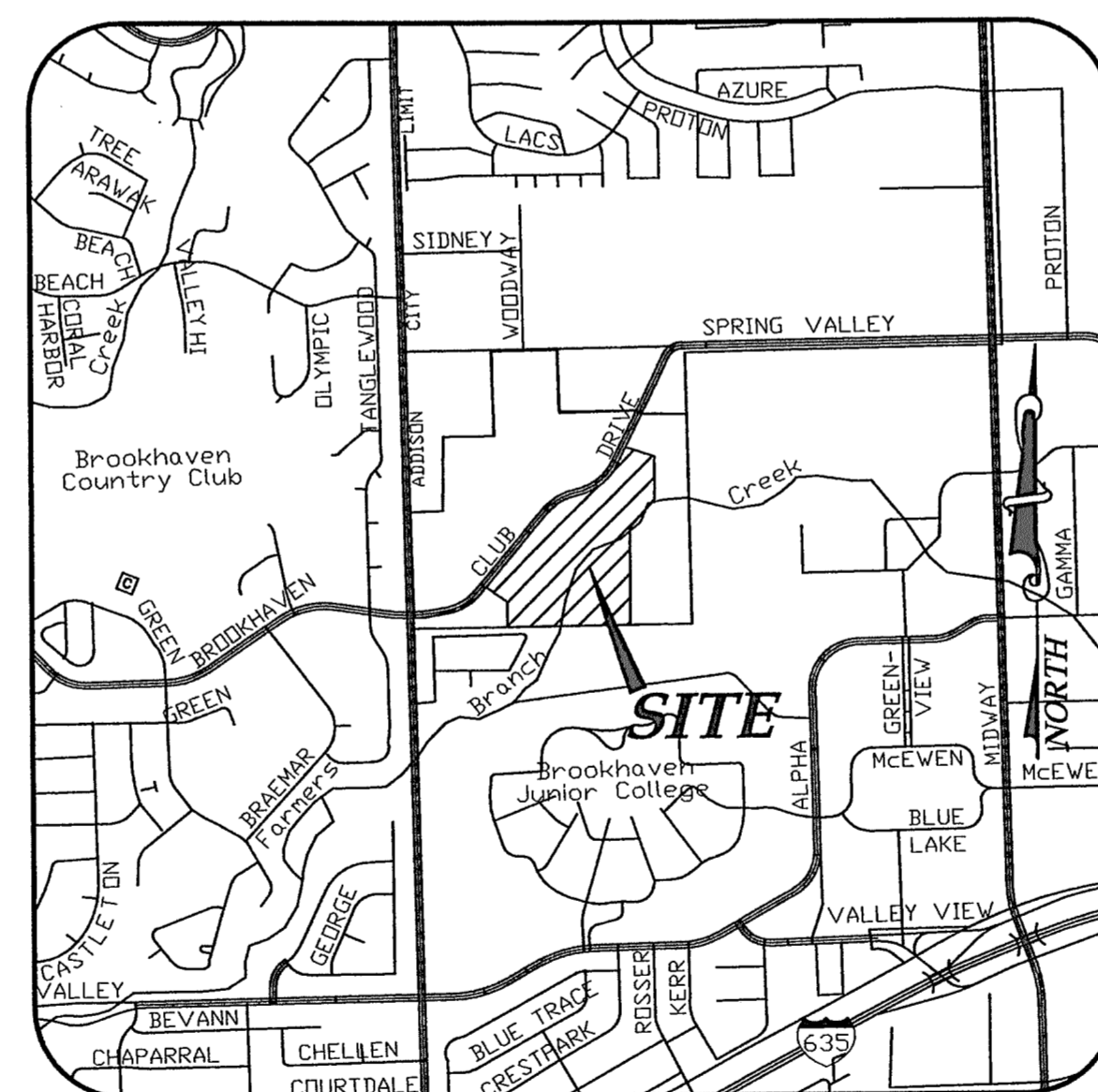

VICINITY MAP

NOT TO SCALE
 (MAPSCO GRID 14J)

APPROVED FOR
 CONSTRUCTION
 Town of Addison
 Public Works Department
 APPROVED BY: CLAY BARNETT
 DATE: 3-31-08

All responsibility for the adequacy of these plans remains with the Engineer who prepared them. In approving these plans, the Town of Addison makes no representation of adequacy of the work of the Design Engineer.

INDEX OF DRAWINGS

SHEET NO.	DESCRIPTION
C0.1	BOUNDARY EXHIBIT
C1.1	GENERAL CONSTRUCTION NOTES, LEGEND & ABBREVIATIONS
C2.1	OVERALL DEMOLITION PLAN
C2.2	DEMOLITION PLAN - NORTHWEST QUADRANT
C2.3	DEMOLITION PLAN - NORTHEAST QUADRANT
C2.4	DEMOLITION PLAN - SOUTHWEST QUADRANT
C2.5	DEMOLITION PLAN - SOUTHEAST QUADRANT
C3.1	EROSION & SEDIMENT CONTROL PLAN
C3.2	EROSION & SEDIMENT CONTROL DETAILS

NOTES:

- DEVELOPER TO CONTACT TOWN OF ADDISON FINANCE DEPARTMENT AT 972-450-7080 TO DISCONNECT WATER SERVICES PRIOR TO DEMOLITION OF ANY BUILDINGS ON EACH SERVICE.
- METHODS OF DEMOLITION, REMOVAL OF PAVEMENT, STAGING OF DEBRIS, ETC. SHALL BE CONDUCTED SUCH THAT FIRE DEPARTMENT ACCESS WILL BE AVAILABLE AT ALL TIMES TO ANY REMAINING BUILDINGS, PARTIALLY DEMOLISHED STRUCTURES OR ACCUMULATIONS OF DEBRIS ON THE SITE.
- FIRE HYDRANTS SERVING THE SITE SHALL REMAIN OPERATIONAL AS LONG AS POSSIBLE AND NO HYDRANT SHALL BE RENDERED INOPERABLE WITHOUT THE PERMISSION OF THE FIRE DEPARTMENT.
- ANY TEMPORARY ACCESS ROADS SERVING THE SITE SHALL BE OF SUFFICIENT DESIGN AND CONSTRUCTION TO ACCOMMODATE A FIRE FIGHTING VEHICLE.

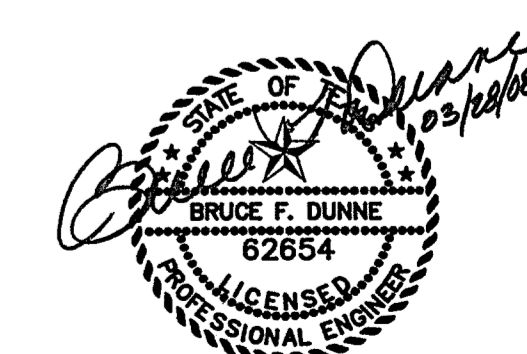

icon Consulting Engineers, Inc.
 Civil Engineers - Designers - Planners

MARCH, 2008