

PLANS FOR THE CONSTRUCTION OF PAVING, DRAINAGE & UTILITY IMPROVEMENTS

PONTE AVENUE CIRCLE

FOR

VITRUVIAN PARK PUBLIC INFRASTRUCTURE - PHASE 2 TOWN OF ADDISON, TEXAS

PUBLIC WORKS # 2011-03

Addison!

TODD MEIER
MAYOR

BLAKE CLEMENS
MAYOR PRO TEMPORE

KIMBERLY LAY
DEPUTY MAYOR PRO TEMPORE

NEIL RESNIK
ROGER MELLOW
BRUCE ARFSTEN
CHRIS DeFRANCISCO
COUNCIL MEMBERS

RON WHITEHEAD
CITY MANAGER

LEA DUNN
DEPUTY CITY MANAGER

NANCY CLINE, P.E.
DIRECTOR OF PUBLIC WORKS

CLAY BARNETT, P.E.
TOWN ENGINEER

CIVIL ENGINEER:

ICON CONSULTING ENGINEERS, INC.
250 W. SOUTHLAKE BLVD., SUITE 117
SOUTHLAKE, TEXAS 76092
PH: (817) 552-6210
FAX: (817) 552-3126
CONTACT: BRUCE F. DUNNE, P.E.

SURVEYOR:

KADLECK & ASSOCIATES
555 REPUBLIC DRIVE, SUITE 115
PLANO, TEXAS, 75074
PH: (972) 881-0771
FAX: (972) 509-1861
CONTACT: LYNN KADLECK, R.P.L.S.

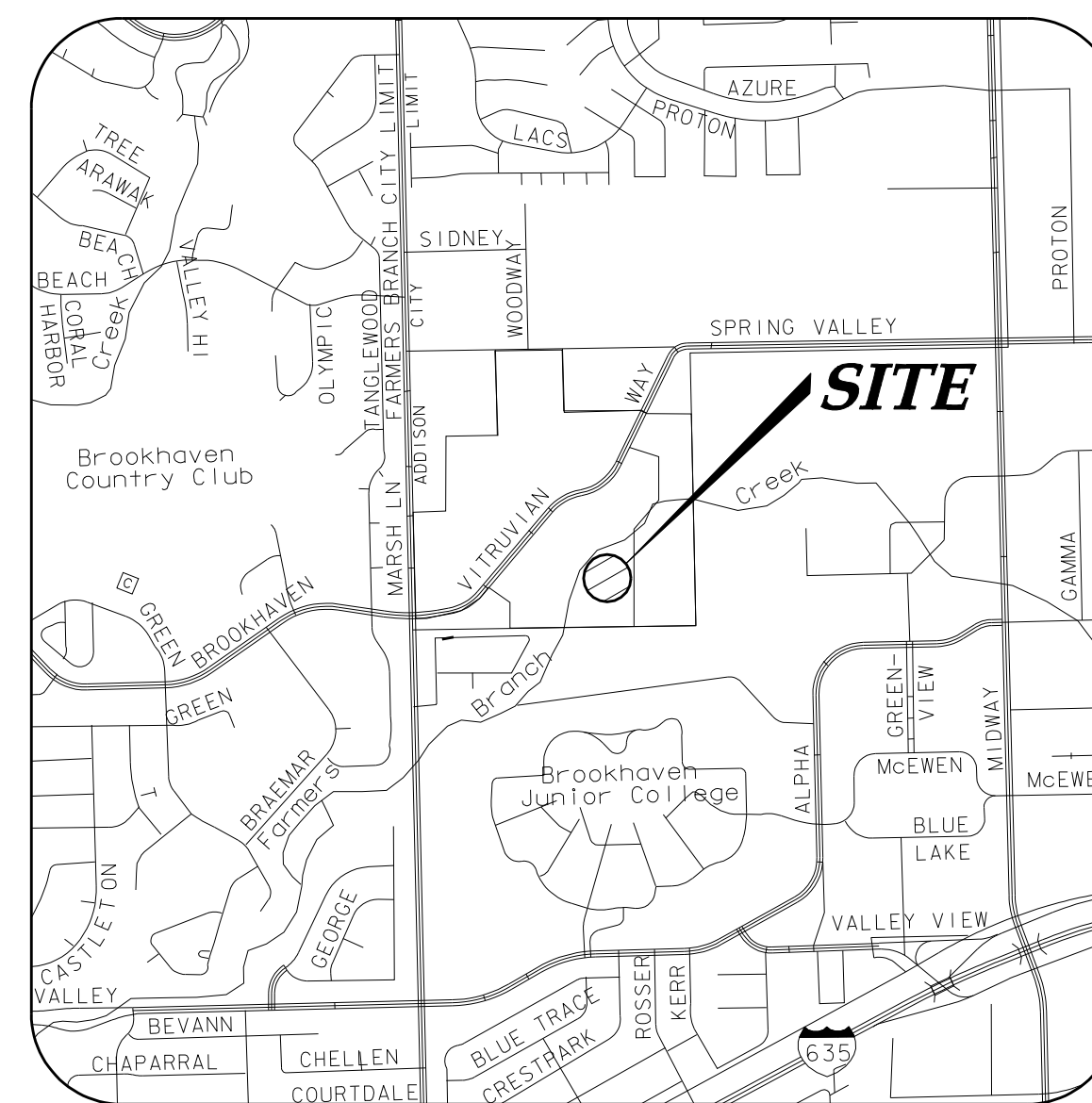

VICINITY MAP

NOT TO SCALE
(MAPSCO GRID 13 & 14)

SHEET INDEX

1	COVER SHEET
2	OVERALL PLAN & PROJECT CONTROL
3	GENERAL CONSTRUCTION NOTES, LEGEND & ABBREVIATIONS
4	OVERALL PAVING PLAN & NOTES
5	PAVING PLAN & PROFILE
6	CIRCLE DETAILS
7	PAVEMENT SECTIONS
8	PAVING DETAILS
9	PEDESTRIAN FACILITIES - PED-05 (1)
10	PEDESTRIAN FACILITIES - PED-05 (2)
11	DRAINAGE AREA MAP & CALCULATIONS
12	STORM DRAIN PLAN & PROFILE - LINE C1
13	STORM DRAIN DETAILS
14	STORM DRAIN DETAILS & GENERAL NOTES
15	PAVEMENT MARKING & SIGNAGE PLAN
16	PAVEMENT MARKING & SIGNAGE DETAILS
17	STREET LIGHT & CONDUIT PLAN
18	ELECTRICAL DETAILS - CONDUIT ED(1)-03
19	ELECTRICAL DETAILS - GROUND BOXES ED(3)-03
20	OVERALL WATER & SANITARY SEWER LAYOUT & NOTES
21	WATER LINE PLAN & PROFILE - LINES W-B & W-C
22	WATER DETAILS
23	SANITARY SEWER PLAN & PROFILE - LINE B
24	SANITARY SEWER DETAILS
25	OVERALL DUCT BANK LAYOUT & NOTES
26	DUCT BANK PLAN & PROFILE - TELEPHONE
27	DUCT BANK PLAN & PROFILE - ELECTRIC
28	DUCT BANK CROSSING PROFILES
29	DUCT BANK ELECTRIC DETAILS
30	EROSION & SEDIMENT CONTROL PLAN
31	EROSION & SEDIMENT CONTROL DETAILS
32	GAS SLEEVE PLAN & PROFILE

icon Consulting Engineers, Inc.
Civil Engineers- Designers- Planners
ENGINEERING FIRM REGISTRATION NUMBER F-9007

JULY 22, 2011

ICON PROJECT #5019-09

RECORD DRAWINGS 06/15/12