

CURVE DATA			
NO	RADIUS	DELTA	LENGTH
1	150.00'	07°07'12"	18.64'
2	563.25'	07°07'12"	69.99'
3	60.97'	49°03'11"	52.20'

PAVEMENT MARKING & SIGNAGE NOTES:

- SIGN LOCATIONS SHOWN ON PLANS ARE DIAGRAMMATIC. SIGNS WILL BE PLACED IN CONFORMANCE WITH THE MANUAL ON UNIFORM TRAFFIC CONTROL DEVICES, LATEST ADDITION.
- REFLECTIVE SHEETING WILL BE DESIGNATED AS:
TYPE A=ENGINEER GRADE
TYPE B=SUPER ENGINEER GRADE
TYPE C=HIGH INTENSITY PRISMATIC
- DO NOT REMOVE EXISTING PAVEMENT MARKINGS OR SIGNAGE PRIOR TO NEW ROADWAY OPENING TO TRAFFIC.
- ALL PAVEMENT MARKINGS TO BE ALKYD THERMOPLASTIC WITH 0.090 INCHES THICKNESS.
- SIGN POSTS AND MOUNTING PER TOWN OF ADDISON REQUIREMENTS.

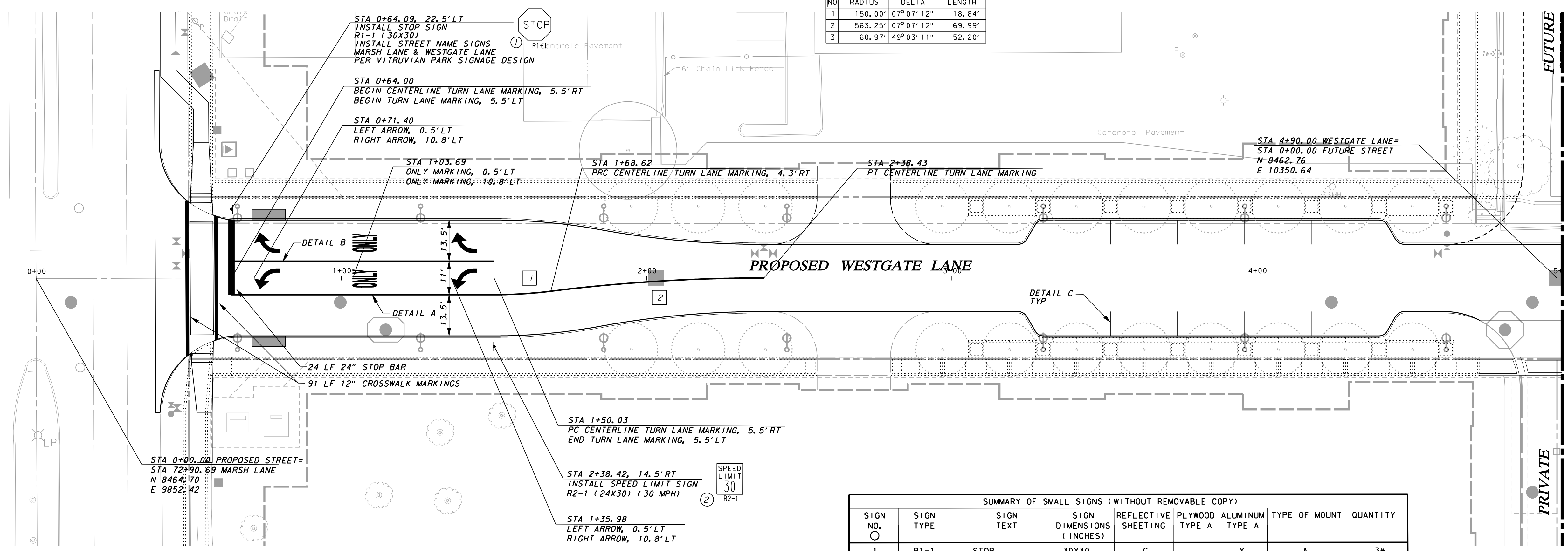

SUMMARY OF SMALL SIGNS (WITHOUT REMOVABLE COPY)								
SIGN NO.	SIGN TYPE	SIGN TEXT	SIGN DIMENSIONS (INCHES)	REFLECTIVE SHEETING	PLYWOOD TYPE A	ALUMINUM TYPE A	TYPE OF MOUNT	QUANTITY
1	R1-1	STOP	30X30	C		X	A	3*
2	R2-1	SPEED LIMIT	24X30	C		X	A	2

* ADDITIONAL STOP SIGN LOCATIONS SHOWN AT OTHER DRIVE APPROACHS ON MARSH LANE & VITRUVIAN WAY

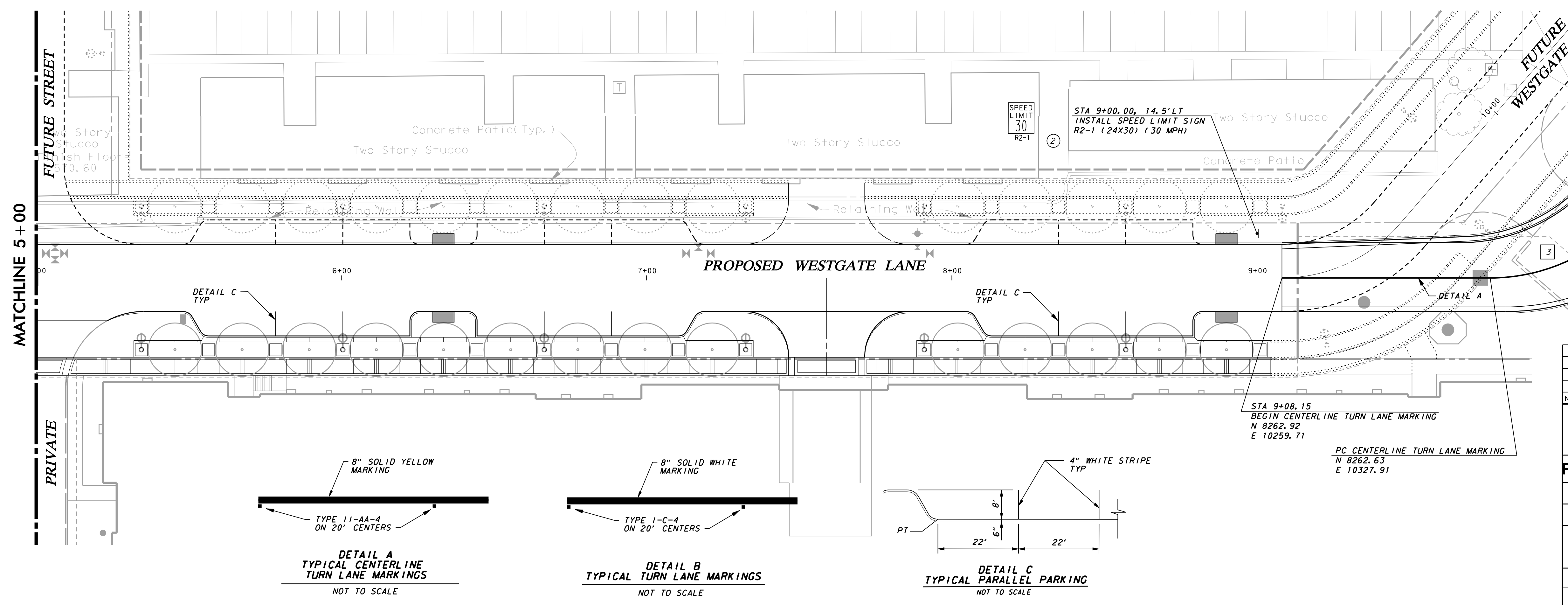
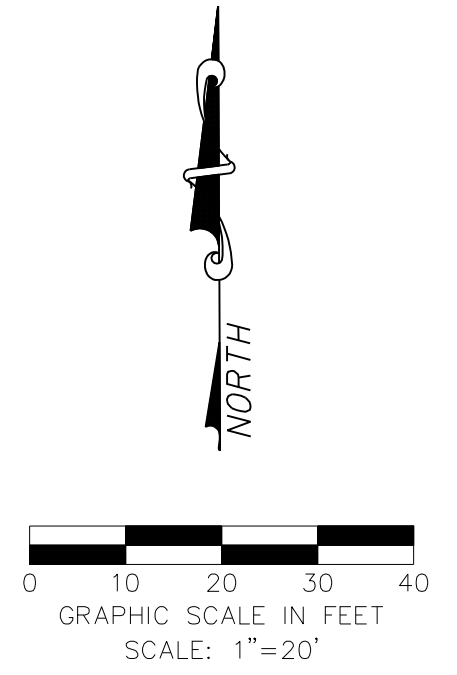

NO.	REVISION	BY	DATE

icon Consulting Engineers, Inc. 2840 W. Southlake Blvd., Suite 110
Civil Engineers - Designers - Planners Southlake, TX 76092 (817) 552-6210
Engineering Firm Registration Number F-9007

PAVING, DRAINAGE & UTILITY IMPROVEMENTS
VITRUVIAN PARK PUBLIC INFRASTRUCTURE BLOCK 200
TOWN OF ADDISON, TEXAS
PAVEMENT MARKING & SIGNAGE PLAN
WESTGATE LANE

DESIGN	DRAWN	DATE	SCALE	NOTES	Sheet No.
ICE	ICE	APR 17, 2019	AS NOTED		31

VITRUVIAN PARK BLOCK 200 PUBLIC INFRASTRUCTURE - PROJECT NO. 5029-04