

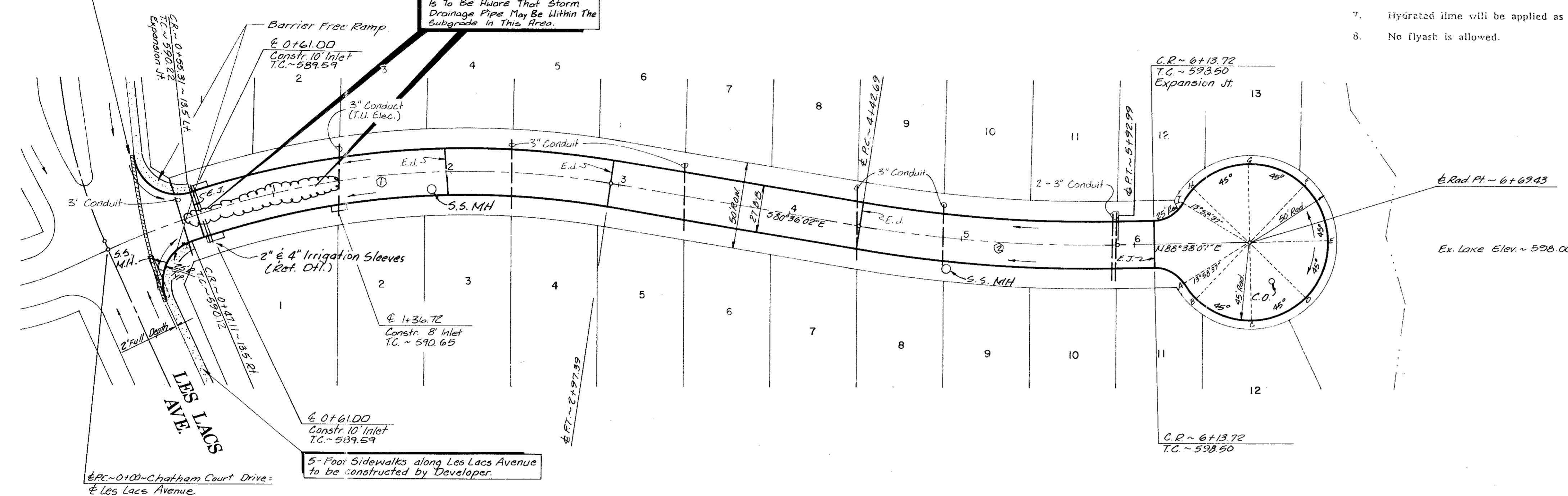

Sawcut & Remove Exist. Concrete Curb & Gutter. Replace w/ Reinf. Conc. Paving.

CAUTION! Paving Contractor is to be aware that Storm Drainage Pipe May Be Within The Subgrade In This Area.



PAVING GENERAL NOTES:

1. Unless otherwise noted all material and construction shall conform to applicable specifications of the Town of Addison with amendments - The North Central Texas Council of Governments "Standard Specifications for Public Works Construction", Parts I and II, latest edition.
2. All curb dimensions are to back of curb.
3. Pavement reinforcing will be grade 60.
4. All on-site concrete pavement will be 6" thick and have a minimum strength of 3000 PSI at 28 days.
5. Construct a barrier-free curb and ramp at all intersections. See Sheet P-2 for details.
6. The Contractor will be responsible for field verifying the location of all existing utilities prior to his operations.
7. Hydrated lime will be applied as a slurry.
8. No Flyash is allowed.

PAVING GENERAL NOTES:

- A. Contraction Joints: Transverse contraction joints shall be sawed joints perpendicular to the centerline and surface of the pavement. Where sawed joints are used, contraction joints at 20-foot intervals shall be sawed as soon as sawing can be accomplished without damage to the pavement.
- B. Expansion Joints: Transverse expansion joints shall be formed perpendicular to the centerline and surface of the pavement and shall be constructed as shown on the plans.

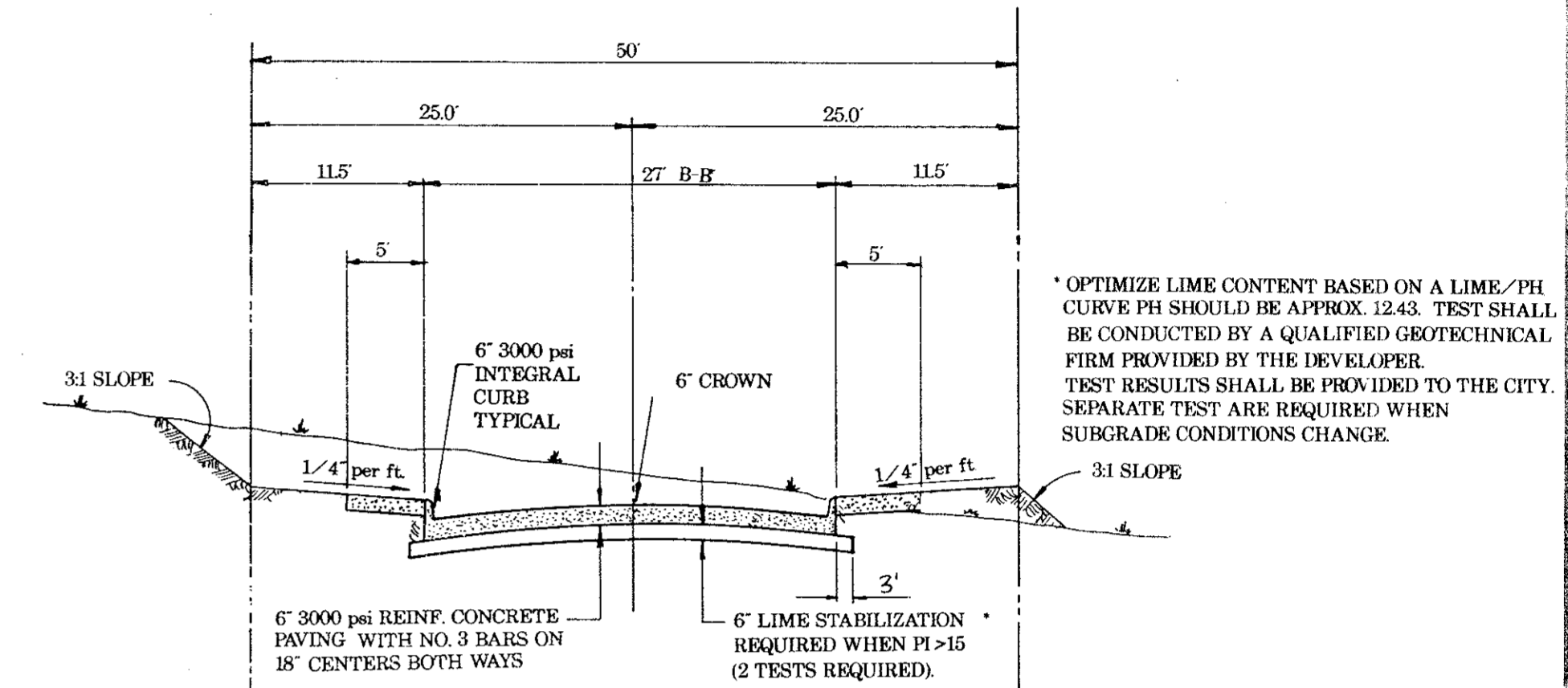

NOTE: SIDEWALKS WILL BE CONSTRUCTED BY HOME BUILDERS.

TYPICAL SECTION

BENCHMARKS

- Cut in the northwest corner of inlet southside of Proton Drive at west of Les Lacs Drive. ELEV. 607.35
- Cut on the north top of curb of Les Lacs Drive at Southeast Addition Corner. ELEV. 593.38
- Center of second inlet west of the East Addition Line and on the north side of Les Lacs. ELEV. 586.17
- In center of the third inlet west of the East Addition Line on the north side of Les Lacs Drive. ELEV. 587.61
- In center of the first inlet south of Beltway Drive and on the east side of Les Lacs Drive. ELEV. 589.88

CHATHAM COURT DRIVE

CURVE DATA

#	A	R	T	L
①	34°04'43"	500.00'	153.24'	297.39'
②	10°45'51"	800.00'	75.37'	150.30'

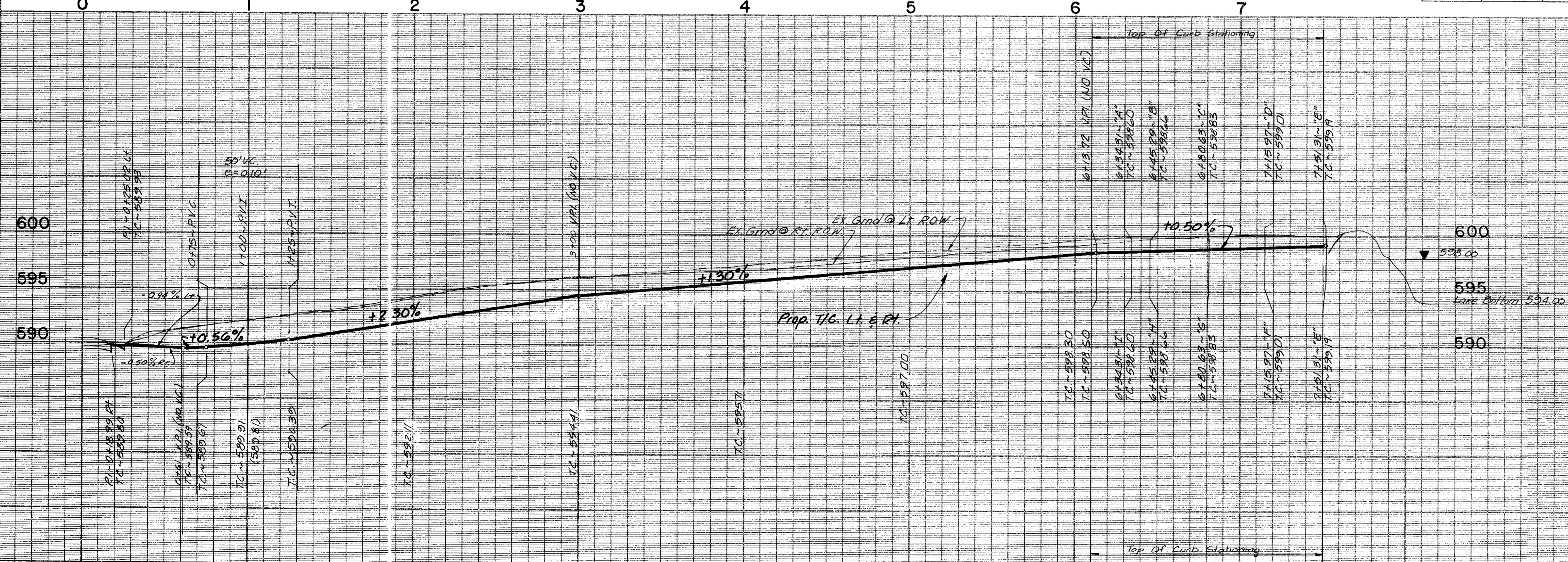

AS BUILTS

I CERTIFY THIS PROJECT WAS CONSTRUCTED IN GENERAL CONFORMANCE WITH THESE CONSTRUCTION PLANS AND WILL FUNCTION AS DESIGNED.



PAVING PLAN & PROFILE
WATERFORD PARK II
 TOWN OF ADDISON, TEXAS
 THE NELSON CORPORATION
 LAND PLANNING • ENGINEERING • SURVEYING
 5999 SUMMERSIDE DRIVE • SUITE 202 • DALLAS, TEXAS 75252 • (214) 380-2605
 DESIGN: TNC DRAWN: TNC DATE: NOV. 1991 SCALE: 1"=40' H 1"=6' V FILE: 90025-6 SHEET NO.: P-1