

Revisions	Date	Description	Drawn By	Checked By

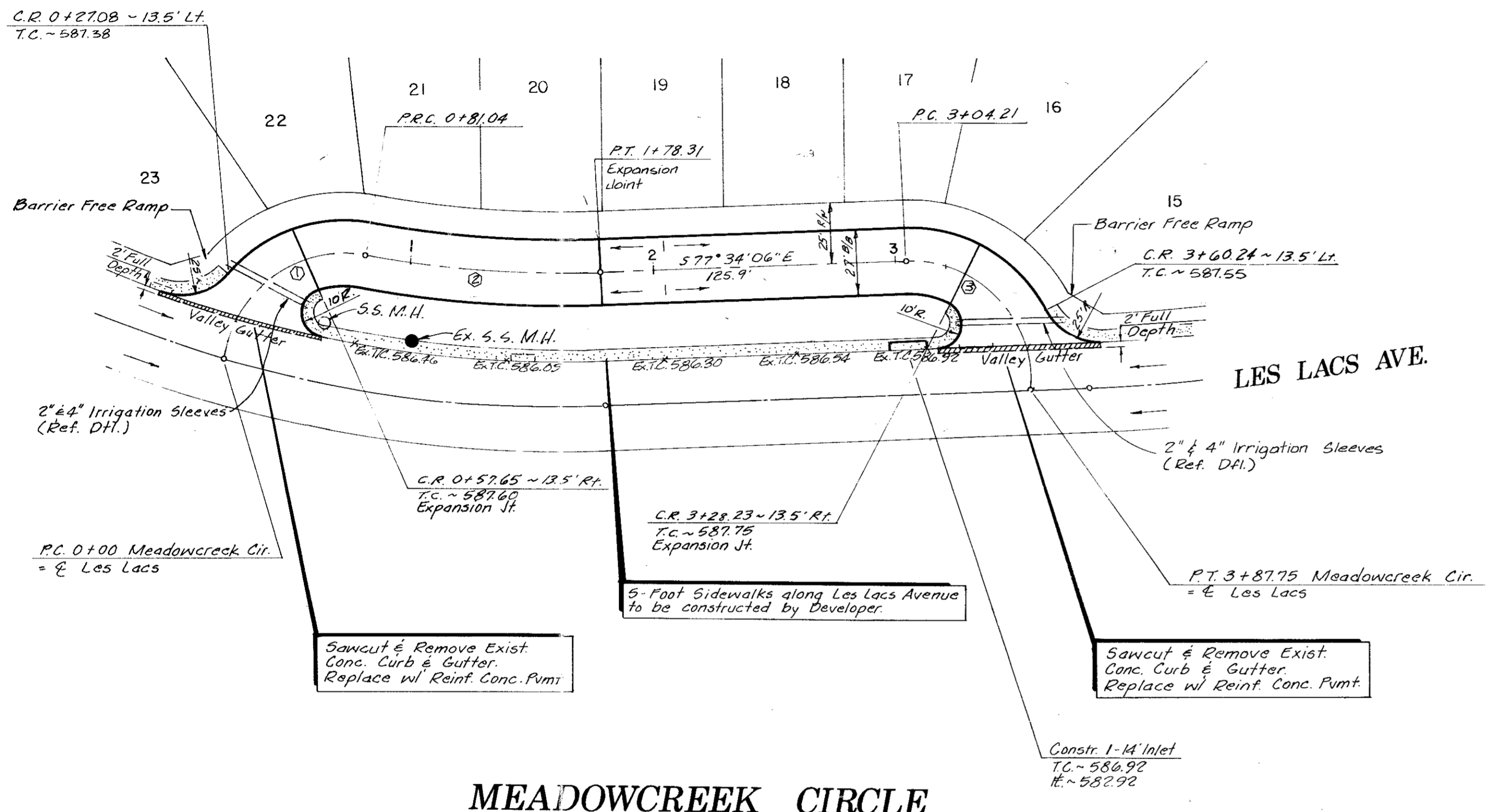
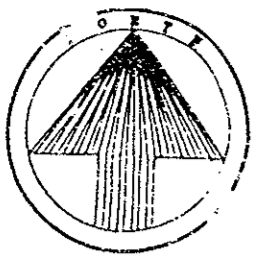

**MEADOWCREEK CIRCLE**

- BENCHMARKS**
- Cut in the northwest corner of inlet southside of Proton Drive at west of Les Lacs Drive. ELEV. 607.35
  - Cut on the north top of curb of Les Lacs Drive at Southeast Addition Corner. ELEV. 593.38
  - Center of second inlet west of the East Addition Line and on the north side of Les Lacs. ELEV. 586.17
  - In center of the third inlet west of the East Addition Line on the north side of Les Lacs Drive. ELEV. 587.61
  - In center of the first inlet south of Beltway Drive and on the east side of Les Lacs Drive. ELEV. 589.88

CURVE DATA

#	A	R	T	L
①	92°51'57"	50.00'	52.57'	81.04'
②	12°31'28"	445.00'	48.83'	97.27'
③	95°44'21"	50.00'	55.28'	83.55'

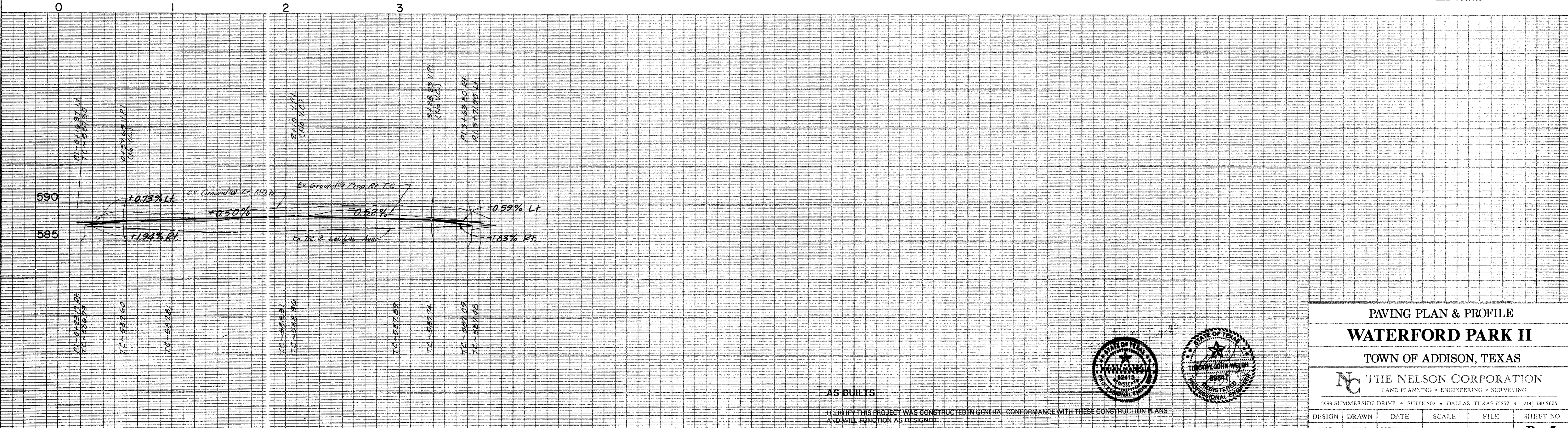

**AS BUILTS**

I CERTIFY THIS PROJECT WAS CONSTRUCTED IN GENERAL CONFORMANCE WITH THESE CONSTRUCTION PLANS AND WILL FUNCTION AS DESIGNED.



**PAVING PLAN & PROFILE**  
**WATERFORD PARK II**  
 TOWN OF ADDISON, TEXAS

**THE NELSON CORPORATION**  
 LAND PLANNING • ENGINEERING • SURVEYING

5999 SUMMERSIDE DRIVE • SUITE 202 • DALLAS, TEXAS 75252 • (214) 380-2605

DESIGN	DRAWN	DATE	SCALE	FILE	SHEET NO.
TNC	TNC	NOV. 1991	1"=40'H 1/2"=6'V	90025 - 6	<b>P - 5</b>